

ASM Reference Guide for Warranty Extension Program (WEP) ZH6 - Covered Components: *if Frame Replacement is Needed*

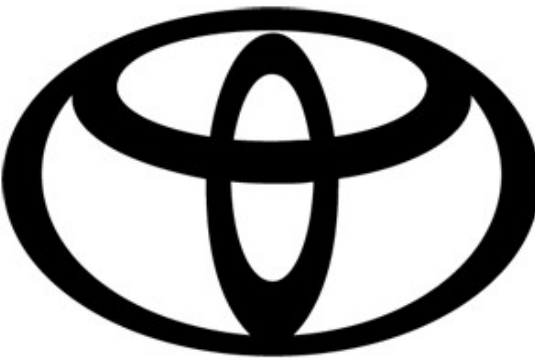

Primary Parts

Frame, Skid Plate, Spare Tire Carrier, and Body Supports

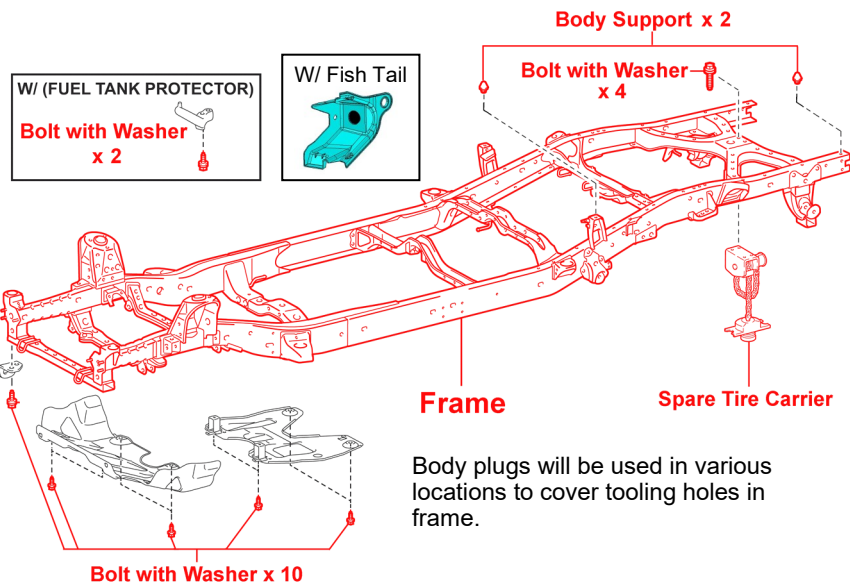

Frame Mounted Brake Lines
(Access cab w/o VSC shown for reference)

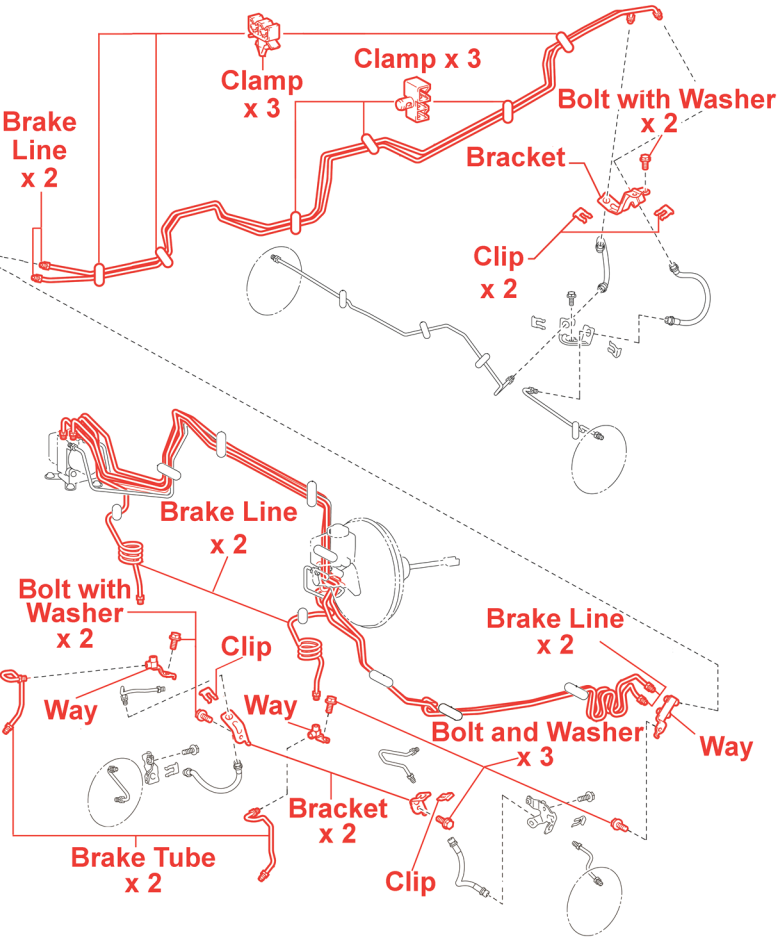

Attachment Hardware

Exhaust System
(V6 shown for reference)

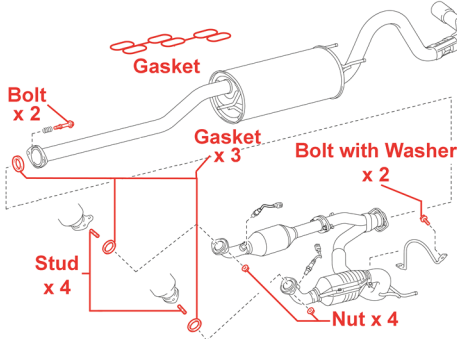

Rear Suspension
(2WD Only)

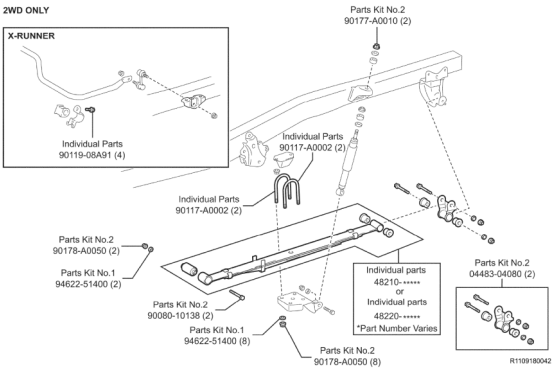

Power Steering
(V6 shown for reference)

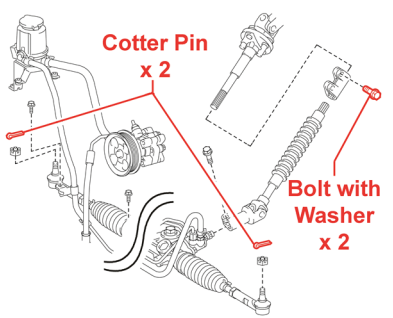

Front End
(4WD shown for reference)

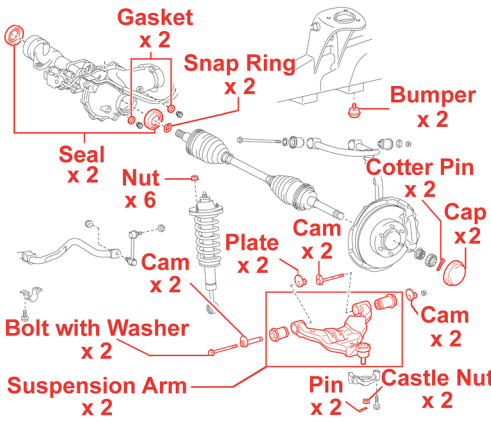

Engine Mount

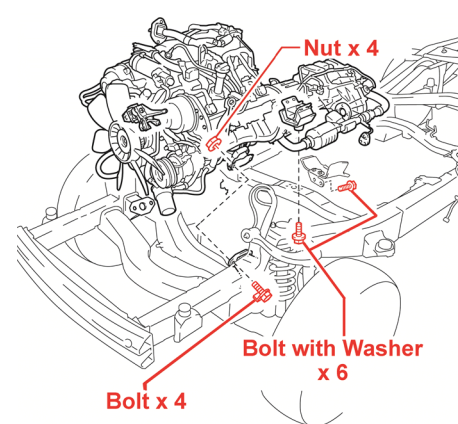

Fuel Tank

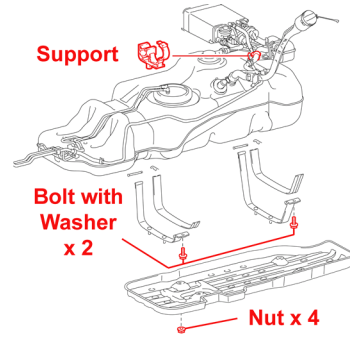

Supplemental Parts

Radiator / Air Conditioning

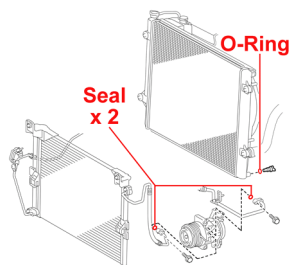

Shift Lever—Rod Type Only

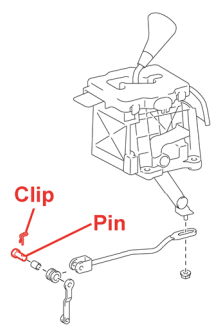

Molding

(X-Runners have a different style of molding)

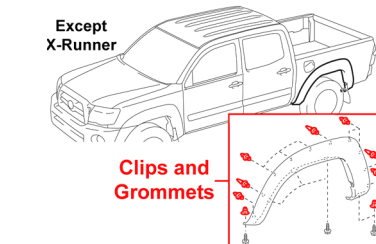

Not all clips and grommets shown will require replacement.

Rear Wheel House Liner

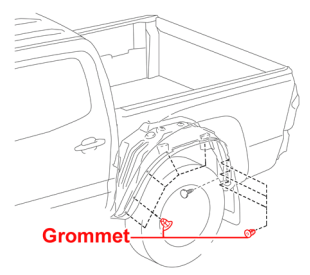

Not all grommets shown will require replacement.

Front and Rear Bumper

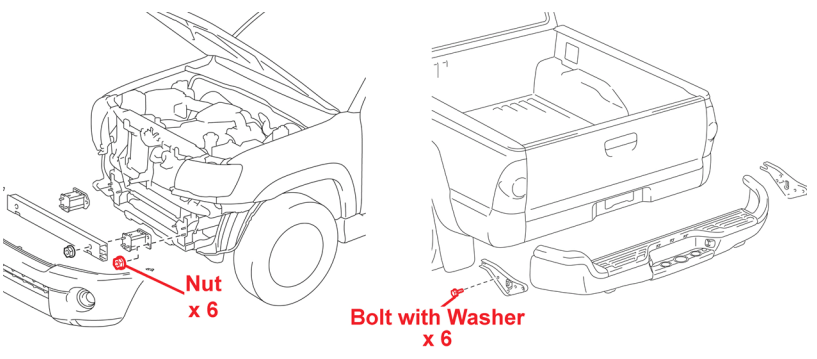

Wire Harness Clamps

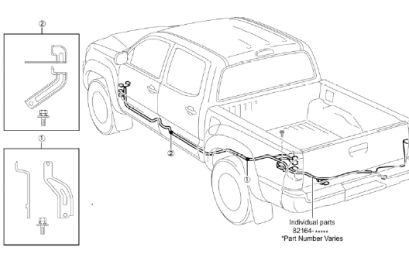

Maintenance Items for Customer Consideration

During frame replacement, it may be advantageous for you to have other maintenance and repairs performed. Examples include:

- Shocks
- Drive Belts
- Brake Pads/Linings
- Ball Joints/Tie Rod Ends
- Etc.

Note:

- Quantities and individual components can vary slightly based on model year and model configuration (e.g. 2WD vs. 4WD, regular cab vs. double cab, etc.).
- Parts provided under the campaign are in red.