



SERVICE BULLETIN

Classification: RA17-004	Reference: NTB17-107	Date: September 26, 2017
-----------------------------	-------------------------	-----------------------------

2016-2017 MAXIMA AND ALTIMA; POP/CLUNK NOISE FROM REAR WHEN DRIVING OVER BUMPS

APPLIED VEHICLES: 2016 – 2017 Altima (L33) **SR Only**
2016 – 2017 Maxima (A36)

APPLIED VIN // DATE: 2016 Maxima and Altima; All VINs and Dates

2017 Altima built before:

1N4(*)L3AP(*)HN 359754 // May 16, 2017

1N4(*)L3AP(*)HC 265139 // May 16, 2017

2017 Maxima built before:

1N4AA6AP(*)HC 431432 // May 16, 2017

IF YOU CONFIRM

A pop or clunk noise from the rear of the vehicle, especially when driving over bumps,

AND

The rear suspension connecting rod nuts are found to be loose on the left and/or right side.

ACTION

Replace the connecting rod and nuts on the left and/or right side with the ones listed in Parts Information.

IMPORTANT: The purpose of ACTION (above) is to give you a quick idea of the work you will be performing. You **MUST** closely follow the entire SERVICE PROCEDURE as it contains information that is essential to successfully completing this repair.

Nissan Bulletins are intended for use by qualified technicians, not 'do-it-yourselfers'. Qualified technicians are properly trained individuals who have the equipment, tools, safety instruction, and know-how to do a job properly and safely. NOTE: If you believe that a described condition may apply to a particular vehicle, DO NOT assume that it does. See your Nissan dealer to determine if this applies to your vehicle.

SERVICE PROCEDURE

1. Remove the connecting rod nuts on the affected side.
2. Remove the connecting rod.
3. Install the new connecting rod and nuts.
 - New connecting rods and nuts are listed in the Parts Information.

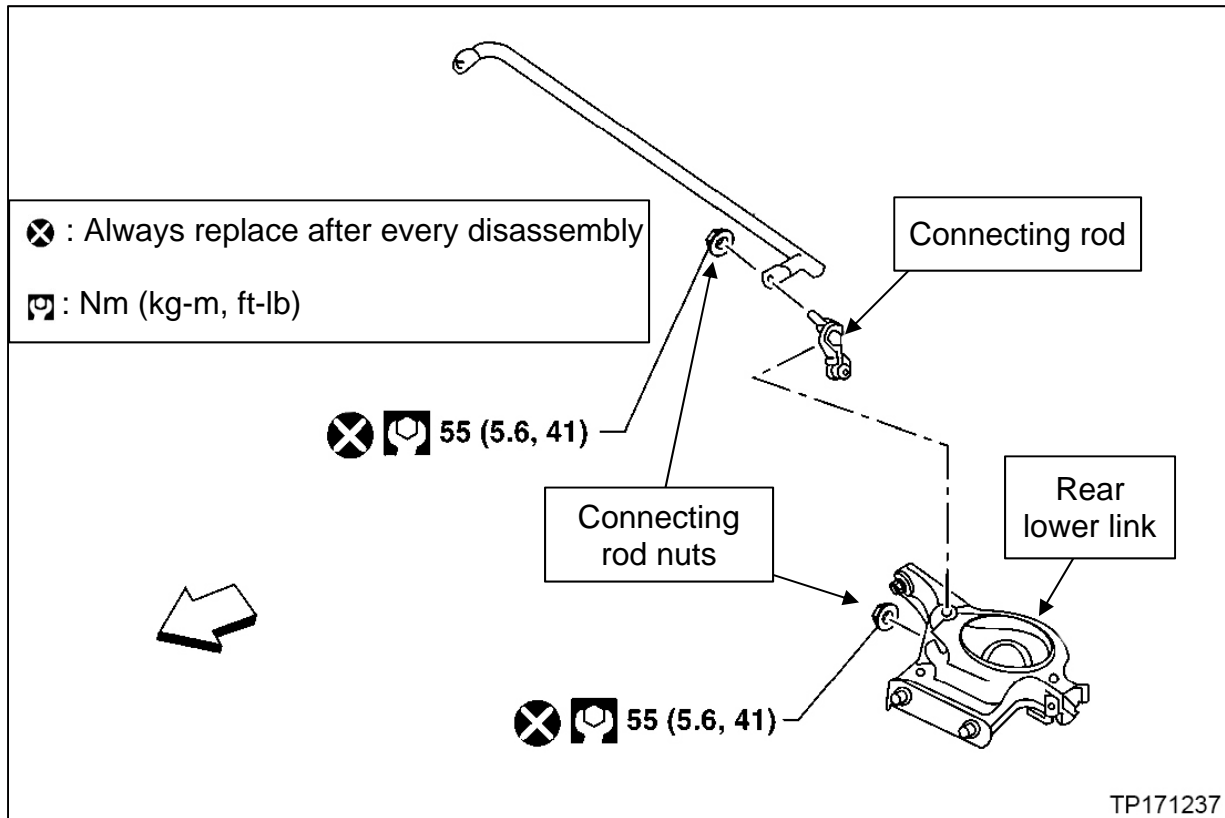

Figure 1

PARTS INFORMATION

DESCRIPTION	PART NUMBER	QUANTITY (PER SIDE AS NEEDED)
ROD-CONN,STAB RH	56261 - 3TA0C	1
ROD-CONN,STAB LH	56261 - 3TA0D	1
CONNECTING ROD NUTS	01225 – N0031	2

CLAIMS INFORMATION

Submit a Primary Part (PP) type line claim using the following claims coding:

DESCRIPTION	PPF	OP CODE	SYM	DIA	FRT
Replace Connecting Rod (1 Side)	(1)	NH62AA	ZL	32	(2)
Replace Connecting Rod (Both Sides)		NH63AA			

- (1) Reference the Parts Information table above, and use 56261-XXXXX as the Primary Failed Part (PPF).
- (2) Reference the current Nissan Warranty Flat Rate Manual and use the indicated Flat Rate Time (FRT).

