 HYUNDAI NEW THINKING. NEW POSSIBILITIES.	GROUP CAMPAIGN	NUMBER 17-01-002
	DATE JANUARY 2017	MODEL(S) SANTA FE SPORT (AN)
Technical Service Bulletin		
SUBJECT: FUEL FILLER CAP REPLACEMENT (SERVICE CAMPAIGN T1Q)		

*** IMPORTANT**

***** Dealer Stock and Retail Vehicles *****

Dealers must perform this Service Campaign on all affected vehicles prior to customer retail delivery and whenever an affected vehicle is in the shop for any maintenance or repair.

When a vehicle arrives at the Service Department, access Hyundai Motor America's "Warranty Vehicle Information" screen via WEBDCS to identify open Campaigns.

Description:

Some 2017MY Santa Fe Sport (AN) vehicles may have the condition where the fuel filler cap seal may not provide proper sealing and trigger the Check Engine Light with the following DTC(s).

- P0442: Evaporative Emission System - Leak detected (Small Leak)
- P0456: Evaporative Emission System - Leak detected (Very Small Leak)

This bulletin provides the procedure to replace the fuel filler cap to correct this condition.

Applicable Vehicles: Certain 2017 Santa Fe Sport (AN)

Parts Information:

Part Name	Part Number	Qty.	Figure
Fuel Filler Cap	31010-3L600	1	

Warranty Information:

Model	Op. Code	Operation	Op. Time	Causal Part	Nature	Cause
Santa Fe Sport (AN)	60CG45R0	Fuel Filler Cap Replacement	0.3 M/H	310103L600	I3T	ZZ3

NOTE 1: Submit Claim on Campaign Claim Entry Screen.

NOTE 2: If a part is found in need of replacement while performing Service Campaign T1Q and the affected part is still under warranty, submit a separate warranty claim using the same Repair Order. If the affected part is out of warranty, submit a Prior Approval Request for goodwill consideration prior to performing the work.

Circulate To: General Manager, Service Manager, Parts Manager, Warranty Manager, Service Advisors, Technicians, Body Shop Manager, Fleet Repair

Service Procedure:

1. Open the fuel door.

Unclip the fuel filler cap lanyard (A) from the fuel door.

Unscrew the fuel cap from the vehicle.

Install a new fuel cap in the reverse order of removal.

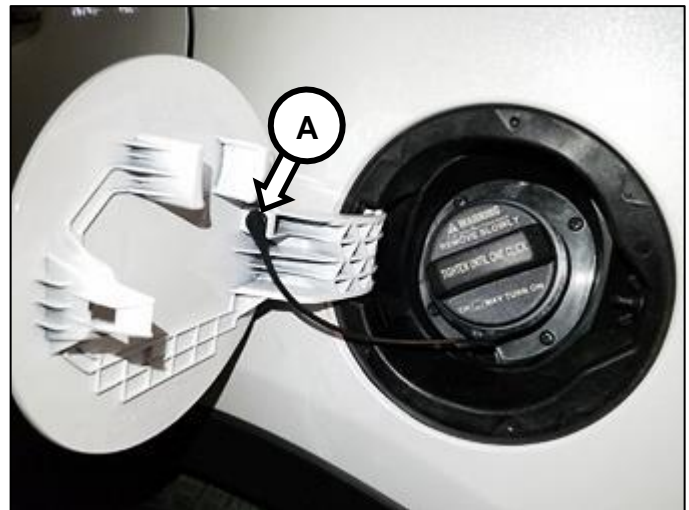

2. Clear any DTCs in the ECM using GDS.

Clear any DTCs in the BlueLink system per instructions of TSB 12-BE-005-2.

Verify repair.