



DATE: 1-26-17

APPLIES TO: This service bulletin applies to transit bus chassis cabs altered by Spartan Motors, USA Inc. built between September 12, 2015 and August 9, 2016.

CONDITION: Air dryer is constantly purging

CORRECTION: Plumb air dryer correctly

LABOR ALLOCATION: .5 hrs.

CLASSIFICATION: E3

PARTS NEEDED:

| <u>QTY</u> | <u>Part Number</u> | <u>Description</u> |
|------------|--------------------|----------------------|
| 1 | CSB16-330-001 | Instruction Document |
| 1 | CSB16-330-002 | Instruction Document |

GENERAL INSTRUCTIONS:

Thoroughly review entire service bulletin before starting work. If there are questions or concerns with steps defined in this service bulletin, contact Spartan Motors USA, Inc. Customer & Product Support Group.

All applicable industry safety standards must be followed when performing work identified in this procedure.

Service Bulletins are intended for use by Professional Technicians only. They are written to guide Professional Technicians in performing service to vehicles of specific nature in conjunction with industry standards. Professional Technicians should be appropriately trained on industry standards and have the tools and equipment to perform procedures safely and properly.



STEP-BY-STEP INSTRUCTIONS:

1. Inspect to determine if airline (item 19) from compressor outlet coupling (item 12) is connected to "IN" port of air dryer (item 1). Refer to FIG. 2-1.

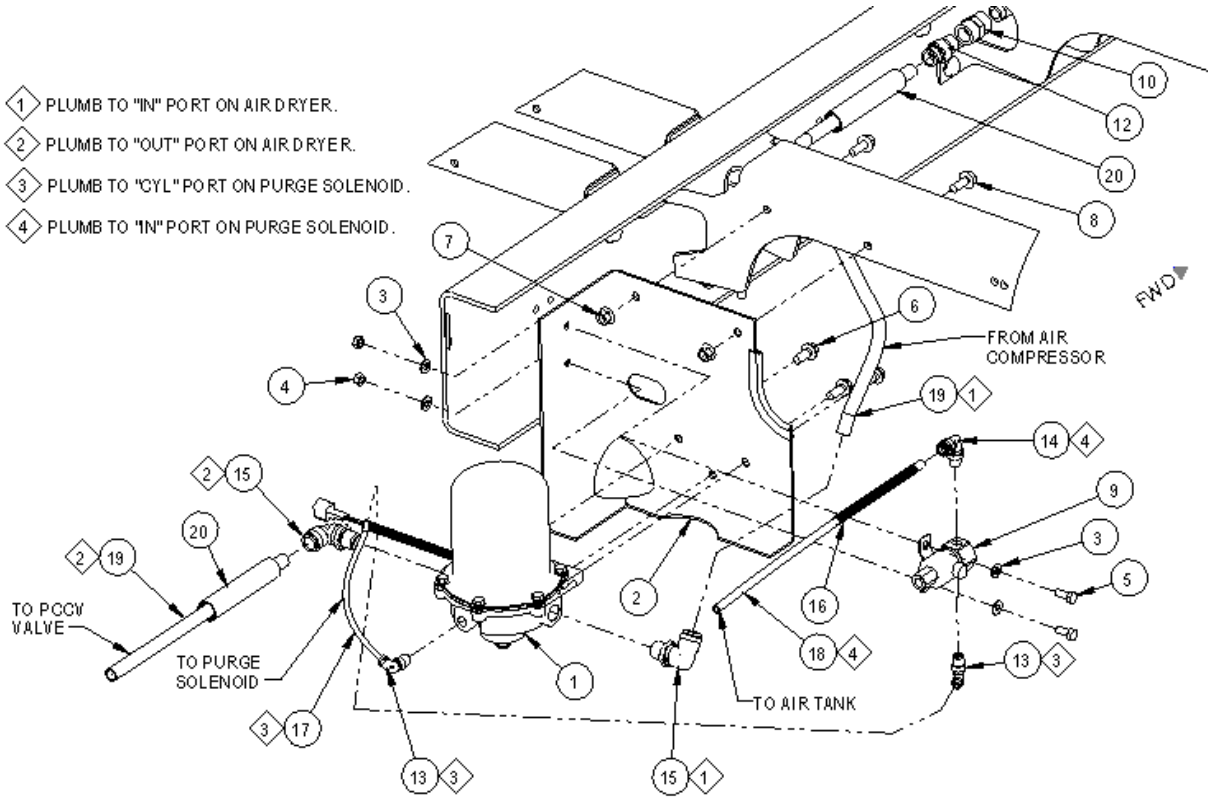

FIG. 2-1

2. If airline inspected in step 1 is connected to "IN" port of air dryer, no repair is required. Photograph installation as found in step 1 and submit with repair invoice and proceed to step 5. If airline inspected in step 1 is not connected to "IN" port of air dryer, proceed to step 3.
3. Drain air tanks of air.
4. Reverse lines on air dryer inlet/outlet such that airline (item 19) from compressor outlet coupling (item 12) is connected to "IN" port of air dryer (item 1), and airline (item 19) from pressure control check valve (PCCV) on air tank is connected to "OUT" port of air dryer (item 1). Refer to FIG. 2-1. Photograph installation for submission with repair invoice.

Service Bulletins are intended for use by Professional Technicians only. They are written to guide Professional Technicians in performing service to vehicles of specific nature in conjunction with industry standards. Professional Technicians should be appropriately trained on industry standards and have the tools and equipment to perform procedures safely and properly.



5. Once plumbing has been confirmed to be correct:
 - a. Operate engine to build air system pressure.
 - b. Confirm no leaks exist.
 - c. Operate suspension controls to dump and re-inflate suspension three times.
 - d. Confirm air compressor builds pressure and air dryer purges properly.
 - e. If air compressor fails to build air pressure or air dryer fails to purge correctly, contact Spartan Motors USA, Inc. Customer & Product Support Group at 1-800-543-4334 for further technical assistance.

Service Bulletins are intended for use by Professional Technicians only. They are written to guide Professional Technicians in performing service to vehicles of specific nature in conjunction with industry standards. Professional Technicians should be appropriately trained on industry standards and have the tools and equipment to perform procedures safely and properly.