

WH03 - Replacing Emergency Release Module for Driver's Door (Workshop Campaign)

Revision: **This revisions amends WH03 as follows:**

Under "Parts Info" the parts ordering information was revised.

Model Year: **2017**

Important: **CRITICAL WARNING** - This campaign includes steps where control unit(s) in the vehicle will be programmed. The vehicle voltage must be maintained between 13.5 volts and 14.5 volts during this programming. Failure to maintain this voltage could result in damaged control unit(s). Damage caused by inadequate voltage during programming is not a warrantable defect. The technician must verify the actual vehicle voltage before starting the campaign and also document the actual voltage on the repair order. Please refer to Equipment Information EQ1401 for a list of suitable battery chargers/power supplies which should be used to maintain vehicle voltage.

Model Line: **Panamera (971)**

Subject: **Emergency release for driver's door**

Information: **An emergency release module, in which the material composition of the axial shaft for the emergency release actuator does not meet the required torsional rigidity, was installed in the driver's door on the affected vehicles.**

As a result, the vehicle cannot be opened using the emergency key.

Remedial Action: Replace emergency release module in the driver's door.



Information

To find out which campaign scope is assigned to the respective vehicle for **replacing the emergency release module**, see PIWIS Vehicle Information.

- Scope 1: Left-hand drive vehicles (I-no. LOL)
- Scope 2: Not For USA

The **part numbers** of the **parts required** for the respective vehicle are specified in the **assigned scope for "Replacing emergency release module for driver's side"**.

For an overview of the campaign scopes, see: ⇒ *Technical Information 'WH0300 Warranty processing'*

Affected Vehicles: Only the vehicles assigned to the campaign (see also PIWIS Vehicle information). This campaign affects 674 vehicles in North America.

Required tools

- Tools:
- Plastic wedge
 - Torque wrench, 2 - 10 Nm (1.5 - 7.5 ftlb.), e.g. **V.A.G 1783 - Torque wrench, 2-10 Nm (1.5-7.5 ftlb.)** or equivalent
 - Torque wrench, 20-100 Nm (15-74 ftlb.), e.g. **VAS 5820 - Torque wrench, 20-100 Nm (15-74 ftlb.)** or equivalent

Parts Info: **Ordering Required Parts**

Parts for this campaign will be automatically allocated to dealerships. Parts will then remain open to normal ordering with no PTEC required once initial allocation has been used.

Preparatory work



Information

Before removing the door panel, make sure that the door window is fully closed.

- Work Procedure:
- 1 Remove front door panel trim ⇒ *Workshop Manual '706119 Removing and installing trim for front door panel'*.
 - 2 Remove front door warning light ⇒ *Workshop Manual '961619 Removing and installing door warning light'*.
 - 3 Remove front door panel (on driver's side) ⇒ *Workshop Manual '705919 Removing and installing front door panel'*.
 - 4 Loosen door lock (do not remove completely) ⇒ *Workshop Manual '571719 Removing and installing door lock - section on "Removing"*.
 - 5 Remove door handle ⇒ *Workshop Manual '571119 Removing and installing door handle - section on "Removing"*.

Replacing emergency release module for driver's side

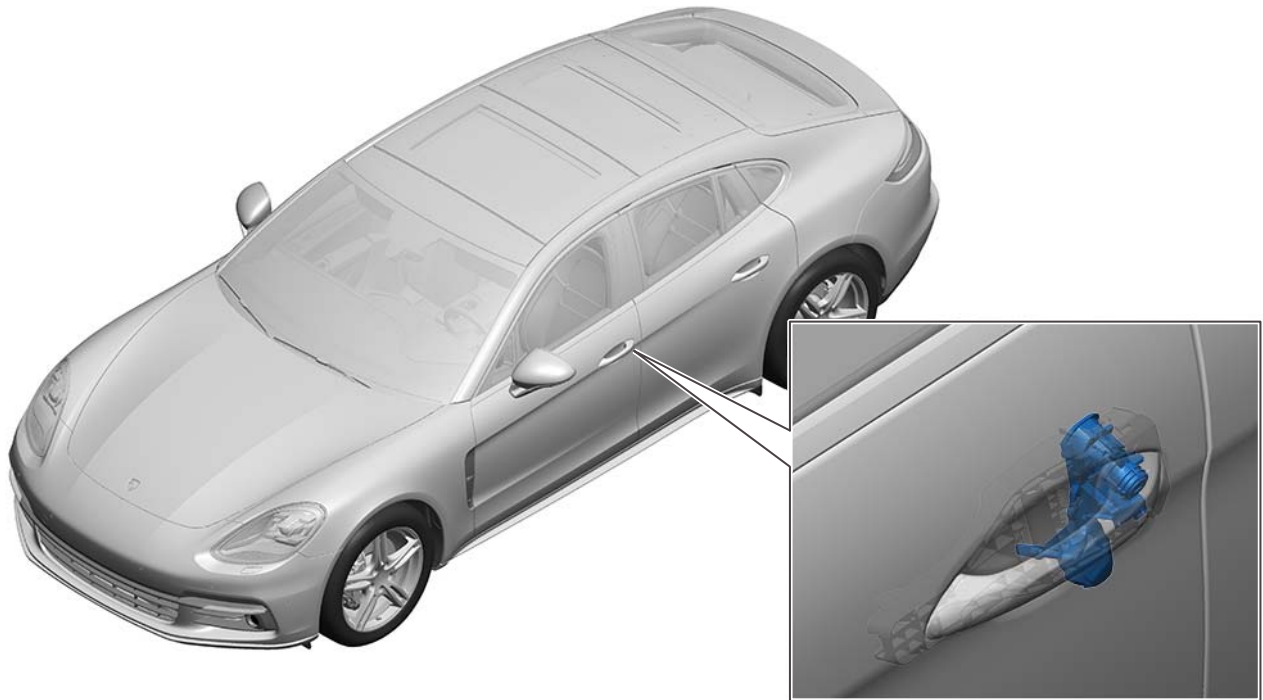

Installation position of emergency release module for driver's side

Work Procedure: 1 **Remove emergency release module**

- 1.1 Unscrew fastening screw ⇒ *Removing anti-theft protection -1-* and unclip anti-theft protection cover ⇒ *Removing anti-theft protection -2-* (⇒ *Removing anti-theft protection -arrow-*).

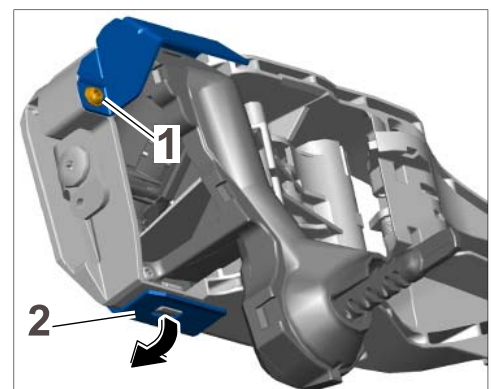

Removing anti-theft protection

- 1.2 Unscrew both fastening screws ⇒ *Loosening emergency release module -2-* on the emergency release module.
- 1.3 Unscrew fastening screw ⇒ *Loosening emergency release module -1-* from the lock cylinder.

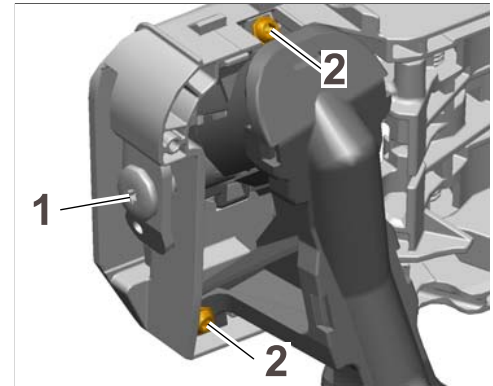

Loosening emergency release module

- 1.4 Unclip both locking lugs on the emergency release module ⇒ *Removing emergency release module -1-* at the top and bottom ⇒ *Removing emergency release module -arrows A-* and remove the emergency release module from the supporting bow ⇒ *Removing emergency release module -2-* (⇒ *Removing emergency release module -arrow B-*).

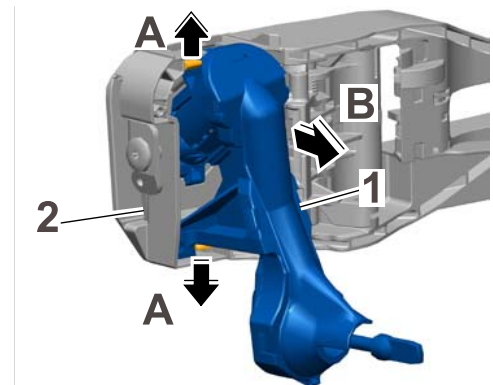

Removing emergency release module

2 Convert lock cylinder

- 2.1 Release locking lugs on the lock cylinder ⇒ *Removing lock cylinder -1-* (⇒ *Removing lock cylinder -arrows A-*) and pull the lock cylinder out of the emergency release module ⇒ *Removing lock cylinder -2-* (⇒ *Removing lock cylinder -arrow B-*).

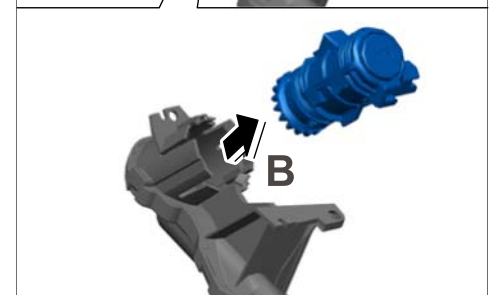
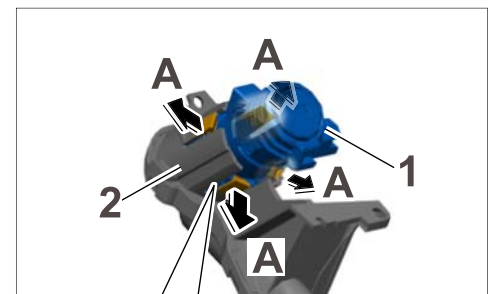

Removing lock cylinder



Information

Before clipping the lock cylinder into the new emergency release module, check whether the assembly aid is clamped on the paddle.

- 2.2 Clip lock cylinder ⇒ *Installing lock cylinder -2-* into the new emergency release module ⇒ *Installing lock cylinder -3-* (⇒ *Installing lock cylinder -arrow-*).

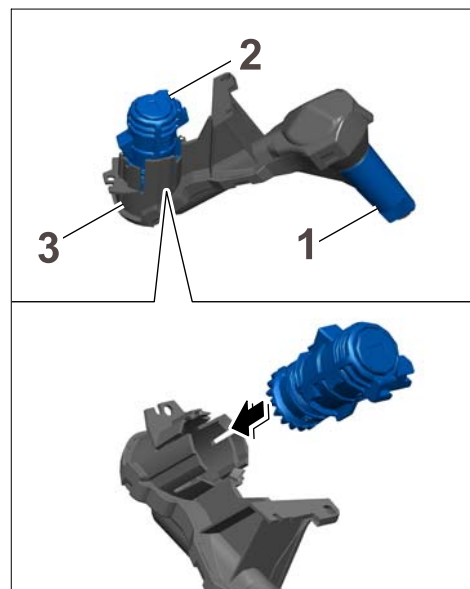

Installing lock cylinder

- 2.3 Pull assembly aid ⇒ *Removing assembly aid -1-* out of the emergency release module ⇒ *Removing assembly aid -2-* (⇒ *Removing assembly aid -arrow-*) and dispose of it.

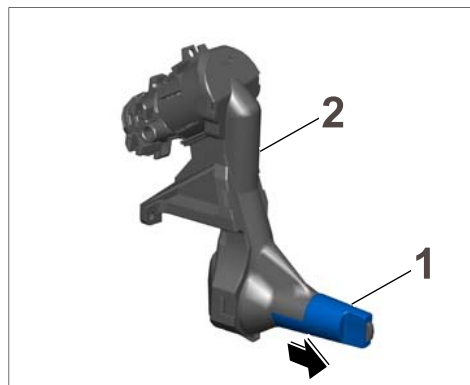

Removing assembly aid

- 2.4 Perform a function test on the lock cylinder.
- 2.4.1 Remove emergency key ⇒ *Performing function test on lock cylinder -1-* from the driver's key.
- 2.4.2 Insert emergency key into the lock cylinder ⇒ *Performing function test on lock cylinder -2-* (⇒ *Performing function test on lock cylinder -arrow A-*) and turn it to the right and left ⇒ *Performing function test on lock cylinder -arrow B-*.
- 2.4.3 Pull out emergency key ⇒ *Performing function test on lock cylinder -1-* again and check that the paddle is at the 12 o'clock position as shown ⇒ *Performing function test on lock cylinder.*
If the paddle is not at the 12 o'clock position, repeat Steps 5 to 7.

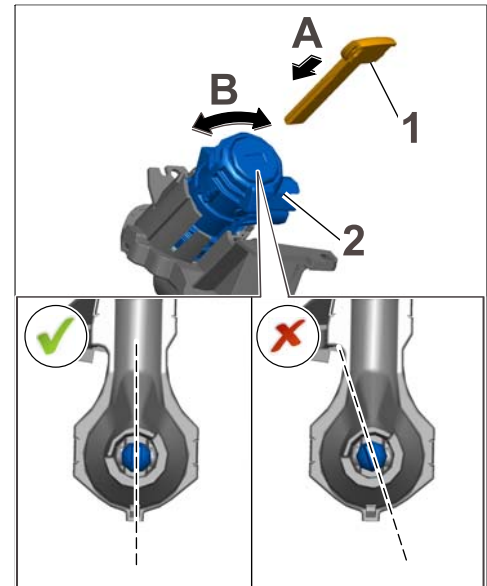

Performing function test on lock cylinder



Information

Before installing the emergency release module, check that the supporting bow is in the preassembly position as shown ⇒ *Checking release mechanism -arrow-*. Press the reversing lever ⇒ *Checking release mechanism -1-* inwards ⇒ *Checking release mechanism -arrow A-* if necessary and lock it with the locking plate ⇒ *Checking release mechanism -2-* (⇒ *Checking release mechanism -arrow B-*).

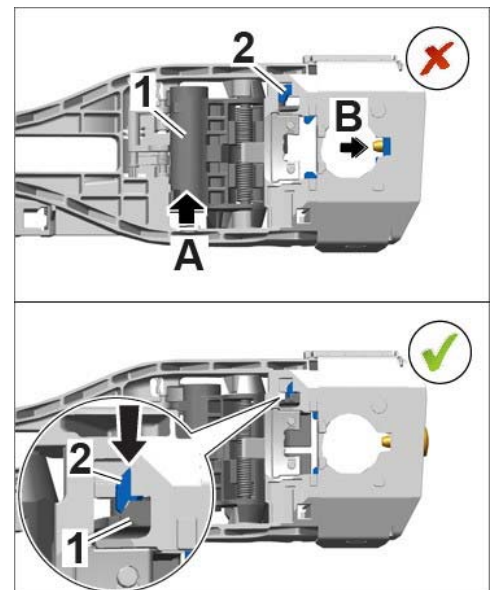

Checking release mechanism

3 Install new emergency release module

3.1 Position emergency release module ⇒ *Installing emergency release module -1-* on the supporting bow ⇒ *Installing emergency release module -2-* and press it in ⇒ *Installing emergency release module -arrow-* until the locking lugs engage.

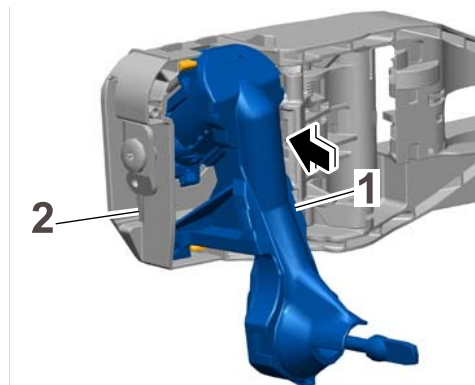

Installing emergency release module

3.2 Secure the emergency release module with the fastening screws ⇒ *Securing emergency release module -1-*.

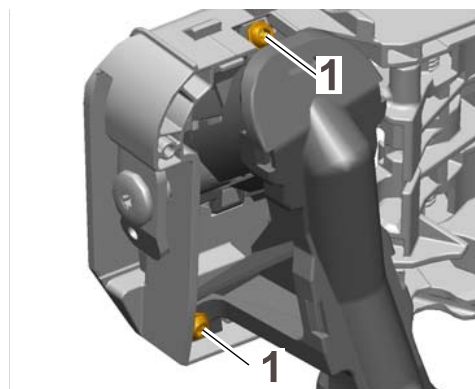

Securing emergency release module

3.3 Fit anti-theft protection cover ⇒ *Installing anti-theft protection cover -2-* (⇒ *Installing anti-theft protection cover -arrow-*) and secure with the fastening screw ⇒ *Installing anti-theft protection cover -1-*.

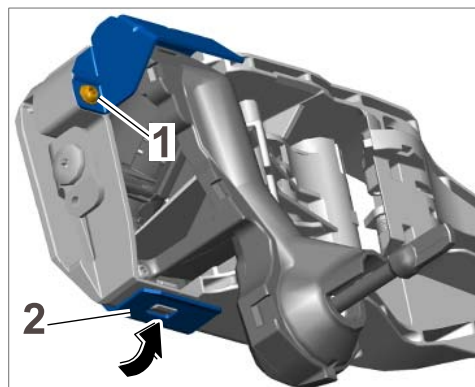

Installing anti-theft protection cover

Concluding work

- Work Procedure: 1 Install door handle ⇒ *Workshop Manual '571119 Removing and installing door handle - section on "Removing"*.
- 2 Secure door lock ⇒ *Workshop Manual '571719 Removing and installing door lock - section on "Removing"*.
- 3 Perform function test on emergency release for driver's door using the emergency key.
- 3.1 Lock the vehicle using the radio key (press once).
- 3.2 Wait at least 1 minute until the door control unit is in standby mode.
On vehicles with Porsche Entry & Drive, keep the radio key a sufficient distance away (at least 6 feet/2 meters).
- 3.3 Pull and hold the door handle ⇒ *Checking emergency release for driver's door -1-*.
- 3.4 Unlock the vehicle by turning the emergency key ⇒ *Checking emergency release for driver's door -2-* counter-clockwise ⇒ *Checking emergency release for driver's door -arrow-*.
If the vehicle cannot be unlocked using the emergency key, check the installation position of the supporting bow ⇒ *Checking emergency release for driver's door -3-* with respect to the door lock ⇒ *Checking emergency release for driver's door -4-*.
- 4 Install front door panel (on driver's side) ⇒ *Workshop Manual '705919 Removing and installing front door panel'*.
- 5 Install front door warning light ⇒ *Workshop Manual '961619 Removing and installing door warning light'*.
- 6 Install front door panel trim ⇒ *Workshop Manual '706119 Removing and installing trim for front door panel'*.
- 7 Enter the campaign in the Warranty and Maintenance booklet.

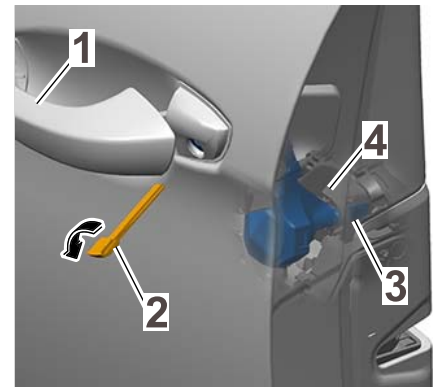

*Checking emergency release
for driver's door*

Warranty processing



Information

The working times specified were determined especially for the performance of this campaign and may deviate from the working times published in the catalog of operations contained in PIWIS.

Scope 1: **Replacing emergency release module for driver's side**

Working time:

Replacing emergency release module for driver's side Labor time: **147 TU**

- Includes:
- Removing and installing trim for front door panel
 - Removing and installing front door warning light
 - Removing and installing front door panel (driver's side)
 - Loosening and securing door lock
 - Removing and installing door handle
 - Function test on emergency release for driver's door

Parts required:

000 043 306 65	Emergency release repair kit (left-hand drive)	1 ea.
9A7 004 084 00	Anti-theft screw	1 ea.
AKL 437 D40	Seal	1 ea.
WHT 003 688	Combination screw	2 ea.

⇒ **Damage Code WH03 066 000 2**

Important Notice: Technical Bulletins issued by Porsche Cars North America, Inc. are intended only for use by professional automotive technicians who have attended Porsche service training courses. They are written to inform those technicians of conditions that may occur on some Porsche vehicles, or to provide information that could assist in the proper servicing of a vehicle. Porsche special tools may be necessary in order to perform certain operations identified in these bulletins. Use of tools and procedures other than those Porsche recommends in these bulletins may be detrimental to the safe operation of your vehicle, and may endanger the people working on it. Properly trained Porsche technicians have the equipment, tools, safety instructions, and know-how to do the job properly and safely. If a particular condition is described, do not assume that the bulletin applies to your vehicle, or that your vehicle will have that condition. See your authorized Porsche Dealer for the latest information about whether a particular technical bulletin applies to your vehicle. Part numbers listed in these bulletins are for reference only. Always check with your authorized Porsche dealer to verify the current and correct part numbers. The work procedures updated electronically in the Porsche PIWIS diagnostic and testing device take precedence and, in the event of a discrepancy, the work procedures in the PIWIS Tester are the ones that must be followed.

© Porsche Cars North America, Inc.

Dr. Ing. h.c. F. Porsche AG is the owner of numerous trademarks, both registered and unregistered, including without limitation the Porsche Crest®, Porsche®, Boxster®, Carrera®, Cayenne®, Cayman®, Macan®, Panamera®, Speedster®, Spyder®, Tiptronic®, VarioCam®, PCM®, PDK®, 911®, RS®, 4S®, 718®, 918 Spyder®, FOUR UNCOMPROMISED®, and the model numbers and distinctive shapes of the Porsche automobiles such as, the federally registered 911 and Boxster automobiles. The third party trademarks contained herein are the properties of their respective owners. Porsche Cars North America, Inc. believes the specifications to be correct at the time of printing. However, specifications, standard equipment and options are subject to change without notice. Some options may be unavailable when a car is built. Some vehicles may be shown with non-U.S. equipment. Please ask your authorized Porsche dealer for advice concerning the current availability of options and verify the optional equipment that you ordered. Porsche recommends seat belt usage and observance of traffic laws at all times.

Printed in the USA