



Reliability Driven®

Service Bulletin No. 3099

<small>MODEL</small> D / J4500	<small>TYPE</small> Service Information	<small>SECTION/GROUP</small> 8-Engine	<small>DATE</small> March 1, 2017
<small>SUBJECT</small> EXHAUST SYSTEM TORCA ACCUSEAL CLAMP			
<small>CONDITIONS</small> Service Information Only			

Description:

MCI is releasing this Service Information bulletin to inform customers about the maintenance procedure for the Torca Accuseal clamp utilized on the connection between the after-treatment system (selective catalyst reduction device) and the tailpipe.

The Torca Accuseal clamp is a one time usage clamp. A new clamp must be utilized after any service or maintenance is performed in which the existing clamp was loosened or removed. New clamps must be torqued to 35-46 ft-lbs.

WARNING

In the event that a new clamp is not utilized after any service or maintenance, the potential may exist whereas the tailpipe may become loose or disengaged from the assembly allowing exhaust gas to be dispersed in an uncontrolled manner. Exhaust gas temperatures can exceed 900°F or 482°C.

This Service Information bulletin is applicable to D series and J4500 model coaches equipped with a Cummins ISL, ISX and Detroit Diesel DD13 engines.

NOTICE

Refer to Figures 1 to 4 for typical illustrations showing the Torca Accuseal clamp installation on D series and J4500 model coaches.



Parts

Qty.	New P/N	Description
a/r	08-20-1561	Clamp, Torca, 5 inch Dia., ISX diesel, ISL and ISX CNG, DD13
a/r	08-20-1566	Clamp, Torca, 4 inch Dia., ISL diesel

Service Information:

1. New parts will be available for service replacement.

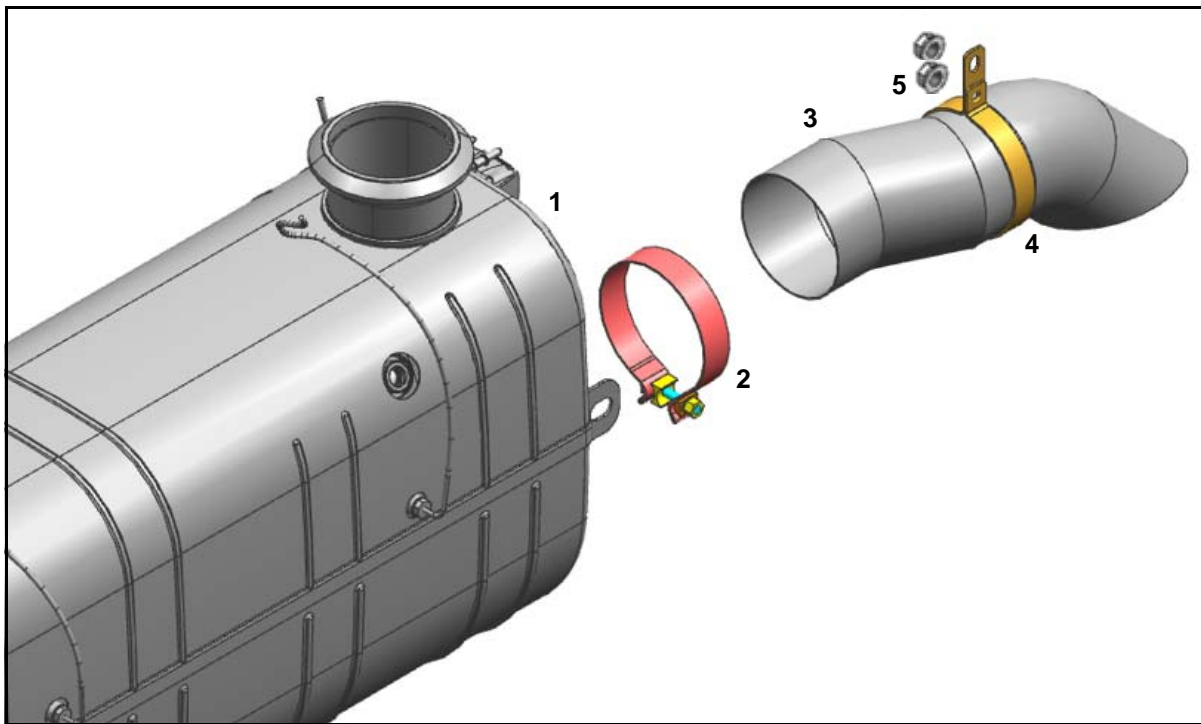

Figure 1. Reference illustration of typical J4500 installation with a DD13 engine.

Item	Figure 1 Description
1	After treatment system
2	Torca, Accuseal Clamp. Torque to 35-46 ft-lbs.
3	Tail pipe
4	Clamp, Intake pipe
5	In the event of intake pipe clamp removal, torque lower locknut to 33-37 ft-lbs.

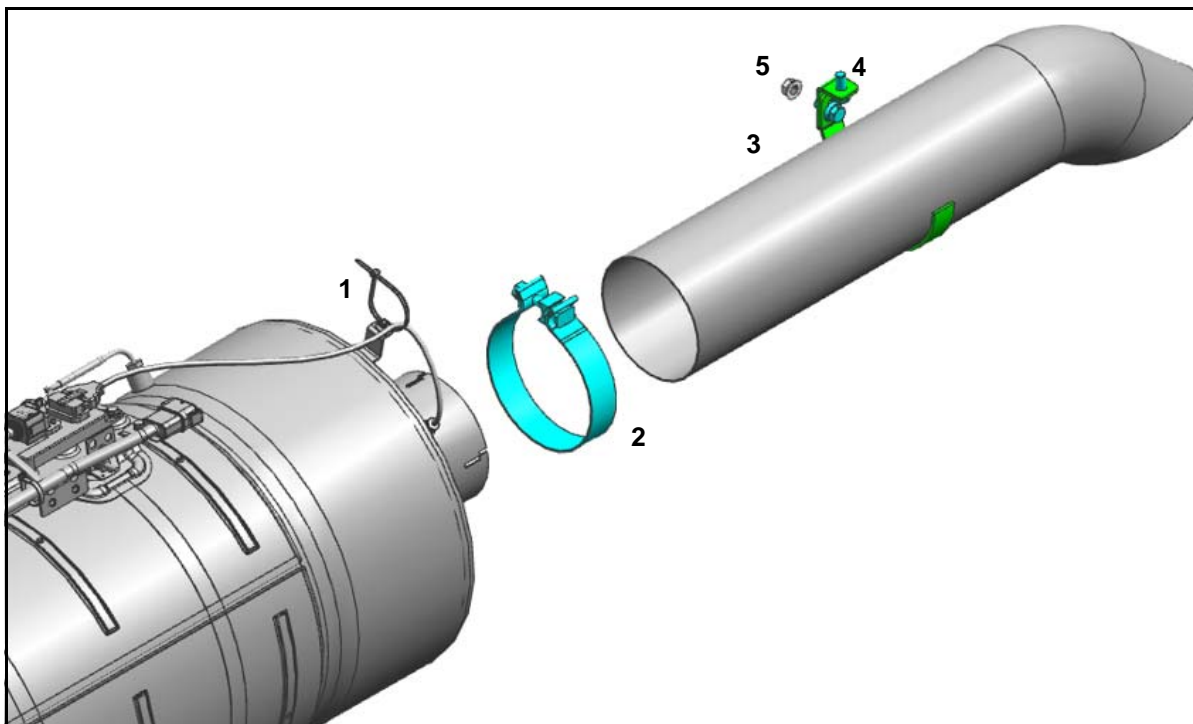

Figure 2. Reference illustration of typical J4500 installation with an ISX engine.

Item	Figure 2 Description
1	After treatment system
2	Torca, Accuseal Clamp. Torque to 35-46 ft-lbs
3	Tail pipe
4	Clamp, Intake pipe
5	In the event of intake pipe clamp removal, torque lower locknut to 33-37 ft-lbs.

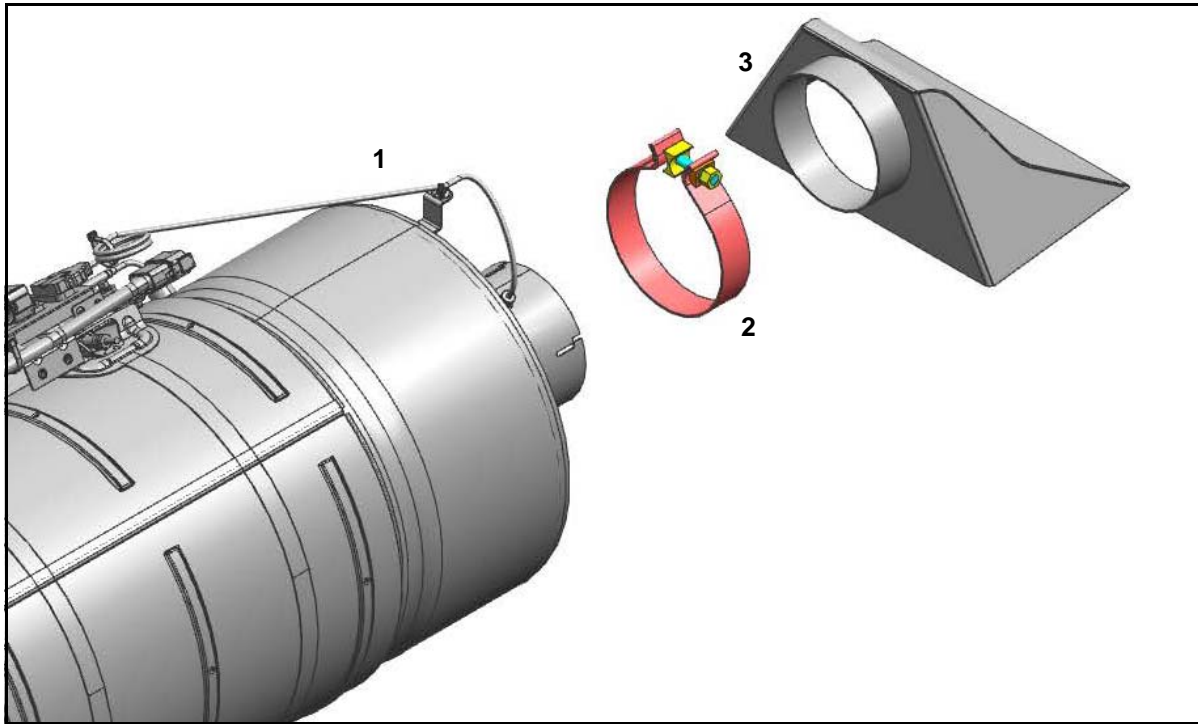

Figure 3. Reference illustration of typical D series installation with an ISX diesel engine.

Item	Figure 3 Description
1	After treatment system
2	Torca, Accuseal Clamp. Torque to 35-46 ft-lbs
3	Tail pipe

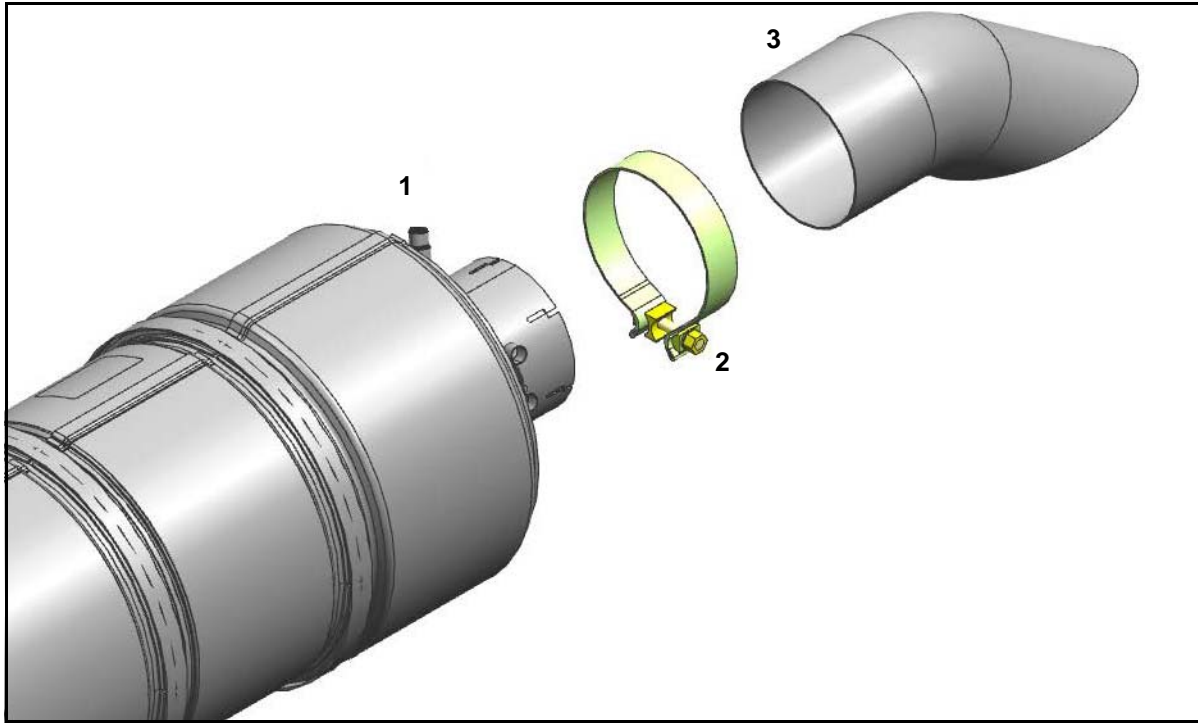

Figure 4. Reference illustration of typical D series installation with an ISX CNG engine.

Item	Figure 4 Description
1	After treatment system
2	Torca, Accuseal Clamp. Torque to 35-46 ft-lbs
3	Tail pipe

Procedure Complete.