



Service Bulletin

TECHNICAL

Subject: Transmission May Not Shift Out of Park, Shifter Knob Indicators May Not Illuminate, DIC Messages May Say to Service Transmission, Service Transmission Now, Unable to Shift Soon

Brand:	Model:	Model Year:		VIN:		Engine:	Transmission:
		from	to	from	to		
Buick	LaCrosse	2017	2017				
Cadillac	XT5						
Chevrolet	Bolt EV	2017	2017				

Involved Region or Country	North America and N.A. Export Regions
Condition	<p>Some customers may comment on one or more of the following conditions:</p> <ul style="list-style-type: none"> • Transmission may not shift out of park. • DIC messages say to Service Transmission and/or Service transmission now, Unable to Shift Soon. • The shift indicator knob doesn't illuminate. <p>The Technician may find one or more of the following DTCs set:</p> <ul style="list-style-type: none"> • P07B4 • P07BA • P07BB • P17A4 • P17A5 • P17A8 • P26C8 • U0077 • U156D
Cause	<p>This may be caused by the following conditions:</p> <ul style="list-style-type: none"> • Transmission Control Lever Knob assembly not fully seated onto the shifter. • Electrical connector not fully engaged into the Automatic Transmission Electronic Control.

Correction

Do not immediately replace any parts until the transmission control lever knob assembly has been validated to be fully installed onto the shifter and operating correctly.

If the shifter knob has been found to be fully seated, the Automatic Transmission Electronic Control electrical connector must be checked for proper connection.

Service Procedure

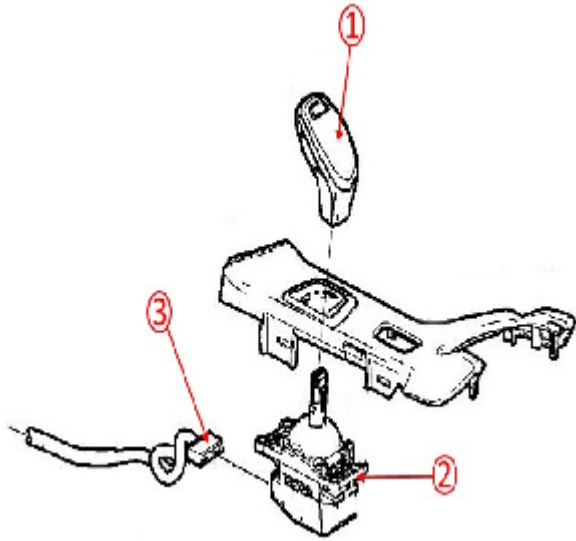

1. While pressing downward on the shifter knob (1) firmly with both hands, validate any movement felt and the bottoming out of the knob to shifter (2).
 - If movement was confirmed while pressing downward on the shifter knob, an audible click may be heard.
 - Verify the shift knob lighting is illuminated and the shifter assembly moves freely.
2. Clear the codes set in the Chassis Control Module and test drive the vehicle.
 - If the codes did not return, no further repairs are needed.
 - If the codes return, validation of the wiring harness connector (3) for the transmission electronic control (2) needs to be done.
3. Remove the Transmission Electronic Control. Refer to *Transmission Electronic Control Replacement* in SI.
4. Press the electrical connector firmly into the Transmission Electronic Control.
5. Validate that the CPA is in the locked position on the connector.
6. Install the Transmission Electronic Control. **Tighten** the bolts to 9 Y (80 lb in).
7. Verify the shift knob lighting is illuminated and the shifter assembly moves freely.

If the above inspections were unable to repair the concern, further diagnostics for the code may be necessary.

Warranty Information

For vehicles repaired under warranty, use:

Labor Operation	Description	Labor Time
8480208*	Inspect and Verify Transmission Control Lever Knob Installation	0.3 hr
Add	Inspect and Verify Automatic Transmission Electronic Control Electrical Connector	0.5 hr

*This is a unique Labor Operation for Bulletin use only.

Version	4
---------	---

Modified	June 6, 2016 - Added more P-Codes under Condition section. Oct. 19, 2016 - Added LaCrosse to Model section. Jan. 26, 2017 - Added Bolt EV to Model section.
-----------------	---

GM bulletins are intended for use by professional technicians, NOT a "do-it-yourselfer". They are written to inform these technicians of conditions that may occur on some vehicles, or to provide information that could assist in the proper service of a vehicle. Properly trained technicians have the equipment, tools, safety instructions, and know-how to do a job properly and safely. If a condition is described, DO NOT assume that the bulletin applies to your vehicle, or that your vehicle will have that condition. See your GM dealer for information on whether your vehicle may benefit from the information.



WE SUPPORT VOLUNTARY TECHNICIAN CERTIFICATION