

PREVOST

Instruction Sheet

IS-16103A

563430 Slide-Out Module Replacement

H3-45 VIP: from 4-4908 up to 7-0771

XLII MTH: from 5-8385 up to 6-8805

REVISION : A
07-04-2017

THIS INSTRUCTION SHEET SUPERSEDES PREVIOUS VERSION.
EFFECTIVITY WAS FROM 3-4417 FOR MODEL H3-45 VIP AND
WAS FROM 2-7781 FOR MODEL XLII MTH.

MATERIAL

Kit #060481 includes the following parts for **one** module replacement:

| Part No. | Description | Qty |
|----------|-----------------------------------|-------|
| 060575 | BASE | 1 |
| 060579 | KEYPAD SUPPORT | 2 |
| 5000355 | SCR MA PAN PH SS 6-32X3/16 | 4 |
| 5001137 | WSH FL SS .203X.438X.06 | 4 |
| 5001996 | SCR MA PAN PH N500 M4-0.7X12 | 8 |
| 500539 | NUT HEX NYRT NX500 M4-0.7 | 8 |
| 502556 | WSH FL SS 4.3X9X.8 | 20 |
| 502841 | NUT HEX NYRT NX500 M5-0.8 | 4 |
| 560348 | KEYPAD FOR PRAN MODULE | 1 |
| 560349 | PRAN MODULE | 1 |
| 560351 | WIRING FOR PRAN SLIDE OUT MODULE | 1 |
| 5060120 | GROMMET EDGING ADHESIVE .036-.062 | 12 in |
| IS-16103 | Instruction Sheet | 1 |
| FI-16103 | Feuille d'instructions | 1 |

NOTE

Material can be obtained through regular channels.

PROCEDURE



DANGER

Park vehicle safely, apply parking brake, stop engine. Prior to working on the vehicle, set the ignition switch to the OFF position and trip the main circuit breakers equipped with a trip button. On Commuter type vehicles, set the battery master switch (master cut-out) to the OFF position.

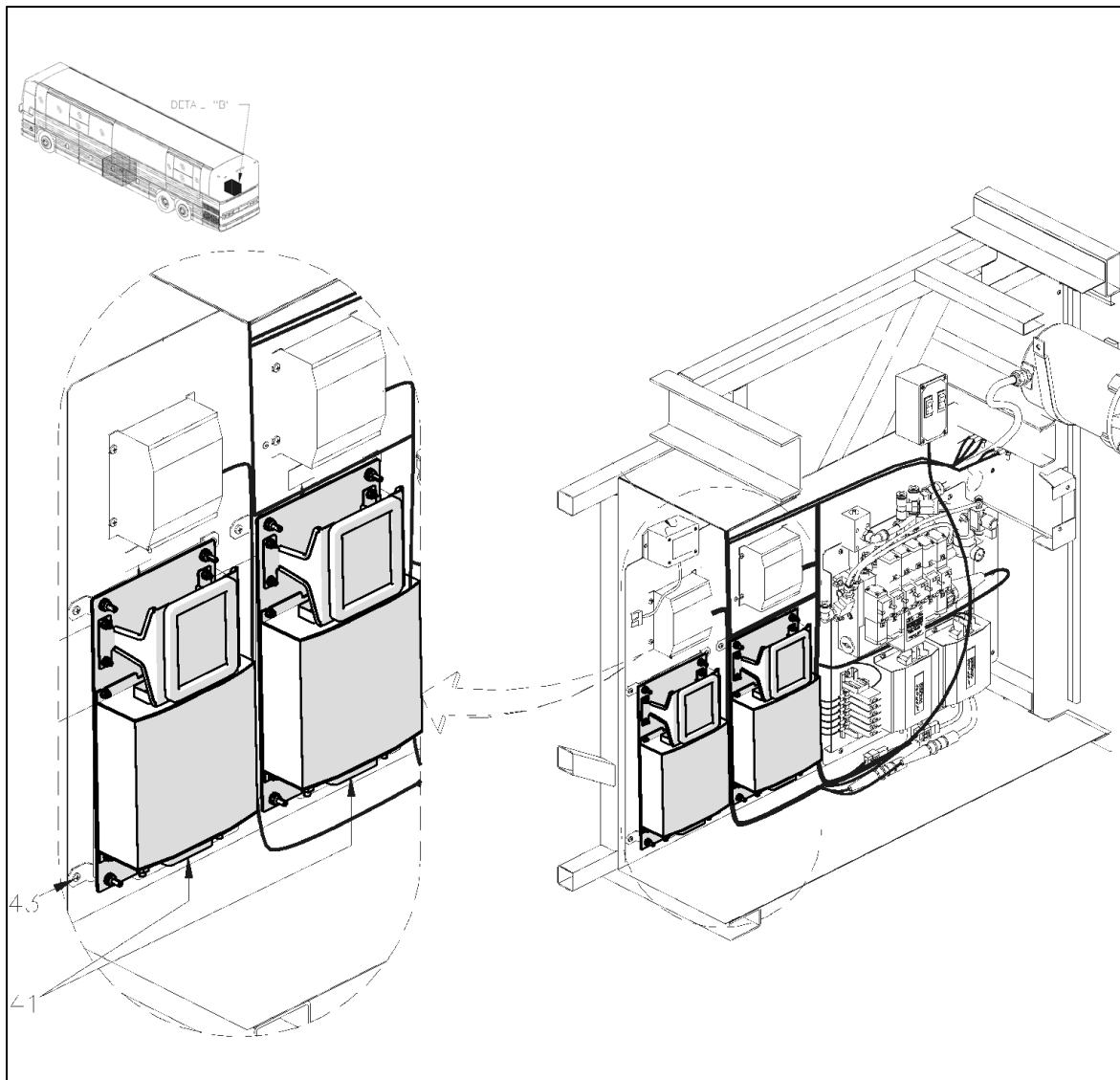

FIGURE 1: FINAL RESULT OVERVIEW (XLII MTH SHOWN)

Follow these steps to replace one existing slide-out module on your vehicle.



CAUTION

Before proceeding, make sure the slide-outs are retracted in and safety pins are applied.

Pre-Assembly:

1. On a table or bench, first install module 560349 on base 060575 with following hardware:

- 4X 5001996 M4 x 12 screw
- 8X 502556 4mm Washer
- 4X 500539 M4 nut

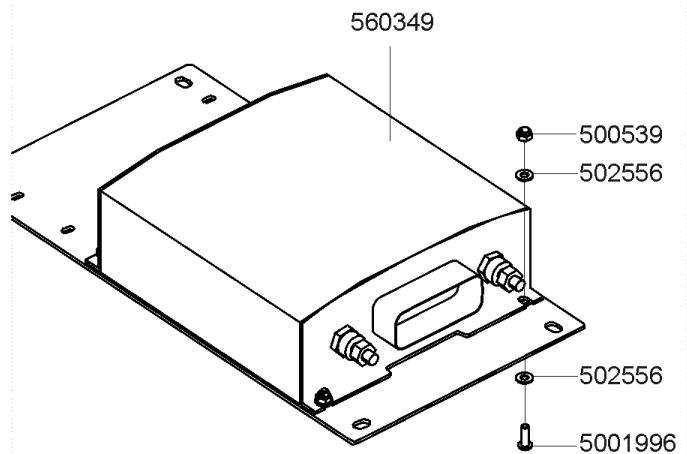

2. Pre-assemble keypad supports 060579 on keypad 560348 with hardware:

- 4x 5000355 6-32 screw
- 4x 502556 4mm washer

Next, cut 5060120 grommet edging in 4 pieces of 3 inch each and place along the support edges.

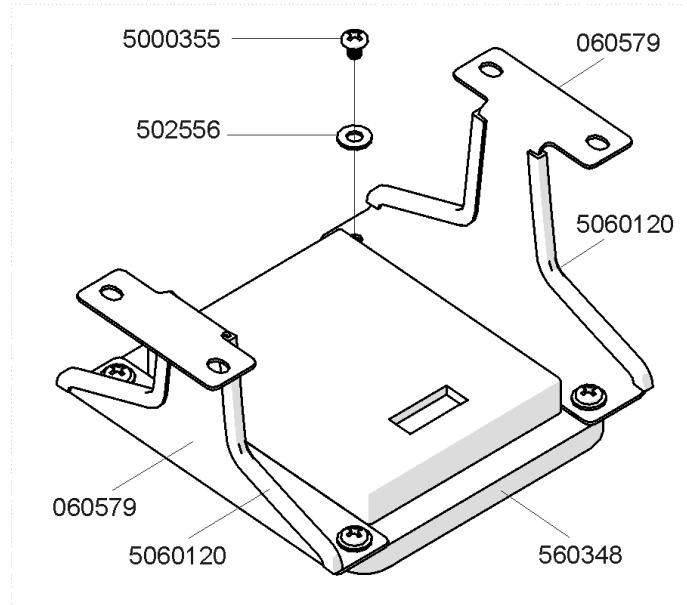

3. Take new wiring harness 560351 and connect output plugs *Gray and Black* to module *before installing the keypad*.

4. Connect keypad to harness.

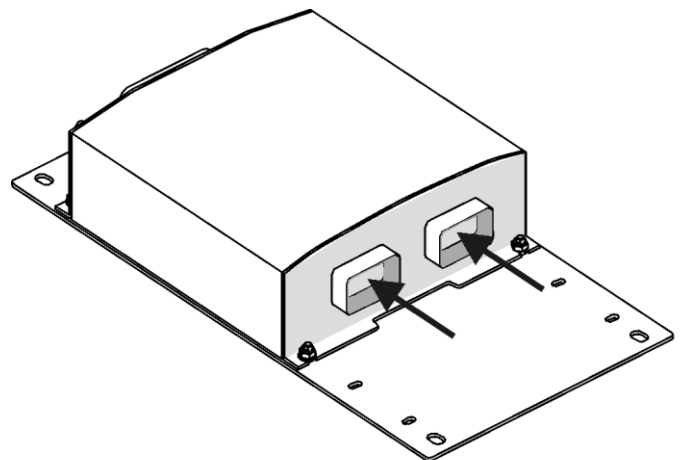

5. Install keypad on base with following hardware:

- 4X 5001996 M4 x 12 screw
- 8X 502556 4mm Washer
- 4X 500539 M4 nut

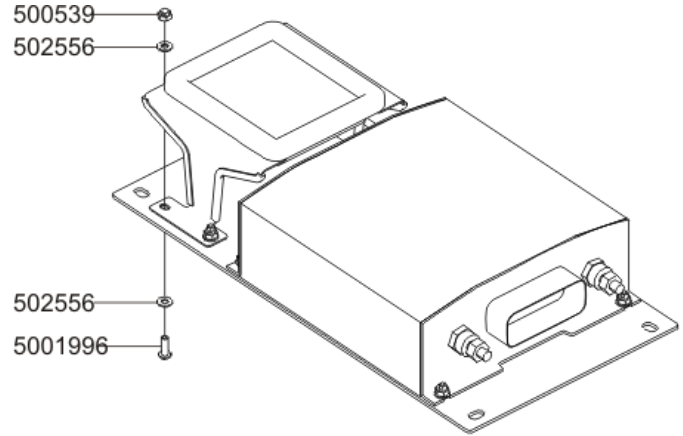

6. Connect big input plug on new module.

7. Connect 2 RED wire VBAT on 2 studs of new module

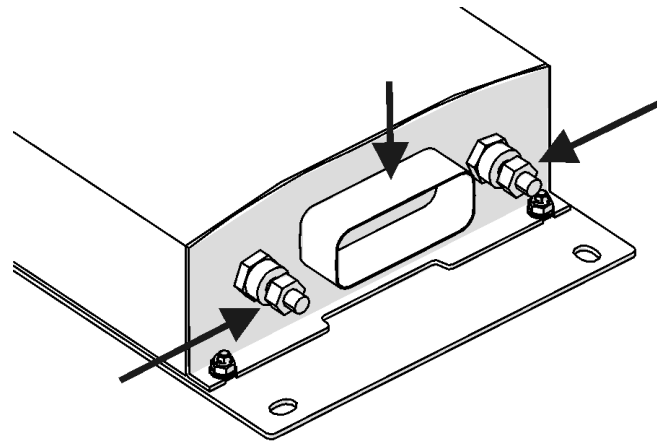

8. On vehicle, unplug old module and remove from vehicle. Keep standoff brackets.
9. Install module(s) with the following hardware on standoff bracket studs:
 - 4X 5001137 3/16" washer
 - 4X 502841 M5 nut
10. Connect new harness 560351 to vehicle harness.

Front Slide Out module connections:

- J1 on CH36
- J2 on CH37
- J3 on CH38
- J4 on CH39

Rear Slide Out module connections:

- J1 on CH40
- J2 on CH41
- J3 on CH42
- J4 on CH43

11. Confirm proper operation of slide-out.

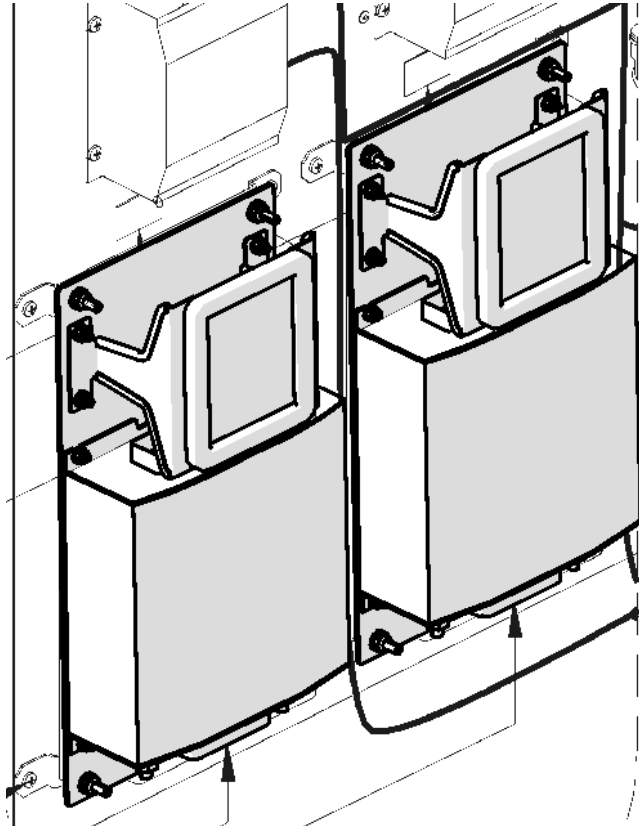

PARTS / WASTE DISPOSAL

Discard waste according to applicable environmental regulations (Municipal/State[Prov.]/ Federal)