

August 18, 2017

06361 Version 1

Second-Row Center Seat Cup Holder Is Loose or Broken

AFFECTED VEHICLES

Year	Model	Trim	VIN Range
2011–17	Odyssey	ALL	ALL

SYMPTOM

The second-row center seat cup holder is loose or broken.

POSSIBLE CAUSES

The cup holder is coming out from the center seat due to insufficient strength of the hooks and clips that secure the tray to the seat frame.

CORRECTIVE ACTION

Remove the second-row center seat, install the new bracket kit, then replace the cup holder.

PARTS INFORMATION

Part Name	Part Number	Quantity
Bracket Kit	81900-TK8-305	1
Cup Holder (NH686L Warm Gray)	81999-TK8-A21ZA	1
Cup Holder (NH767L Truffle)	81999-TK8-A21ZB	1
Cup Holder (YR400L Sienna Beige)	81999-TK8-A21ZC	1

WARRANTY CLAIM INFORMATION

The normal warranty applies.

Operation Number	Flat Rate Time	Description	Color	Defect Code	Symptom Code	Template ID	Failed Part Number
0441A2	0.3 hr	Remove the second-row center seat, replace the cup holder, and install the new bracket kit.	NH686L Warm Gray	01801	05701	A17031A	81999-TK8-A21ZA
			NH767L Truffle			A17031B	
			TR400L Sienna Beige			A17031C	

Skill Level: Repair Technician

CUSTOMER INFORMATION: The information in this bulletin is intended for use only by skilled technicians who have the proper tools, equipment, and training to correctly and safely maintain your vehicle. These procedures should not be attempted by “do-it-yourselfers,” and you should not assume this bulletin applies to your vehicle, or that your vehicle has the condition described. To determine whether this information applies, contact an authorized Honda automobile dealer.

REPAIR PROCEDURE

NOTE: Remove any child or booster seats that may be installed in the second row center seat and place it in the cargo area for the customer to reinstall.

1. Remove the headrest, then fold the second-row center seat-back down, and remove the seat from the vehicle.
2. Release the hooks from the armrest, then remove the armrest beverage holder.

NOTE

- Take care not to tear or damage the seat covers.
- Use the appropriate tool from the KTC trim tool set to avoid damage when removing the cup holder.

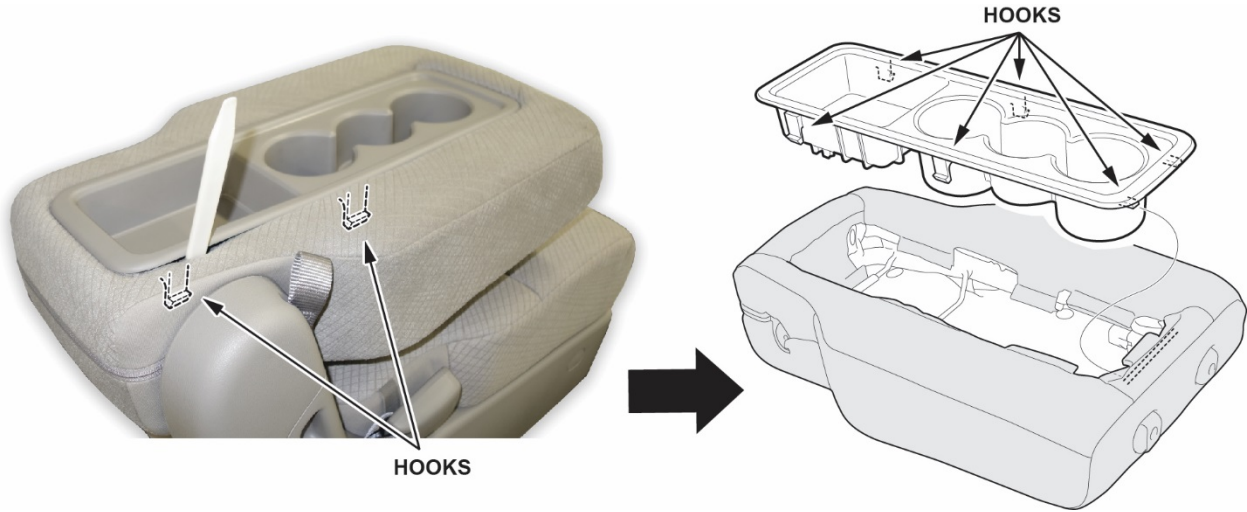

3. Release the left headrest lock guide, then move it up and out of the way.

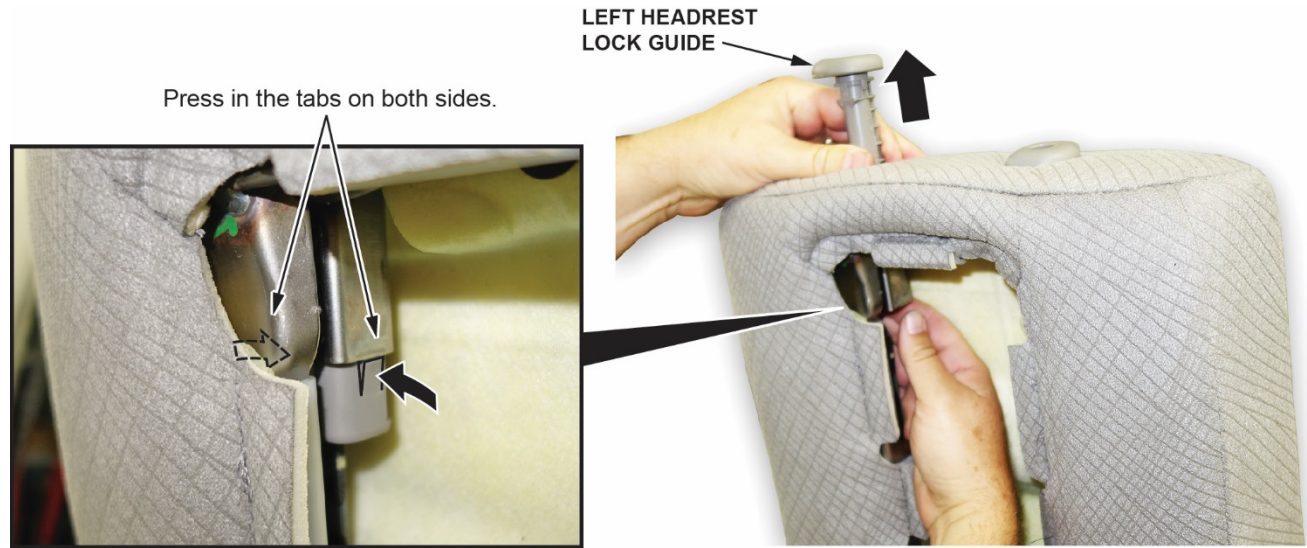

4. Disconnect the six J-clips on the sides of the seat cover.

NOTE: Leave the top and bottom hooks connected.

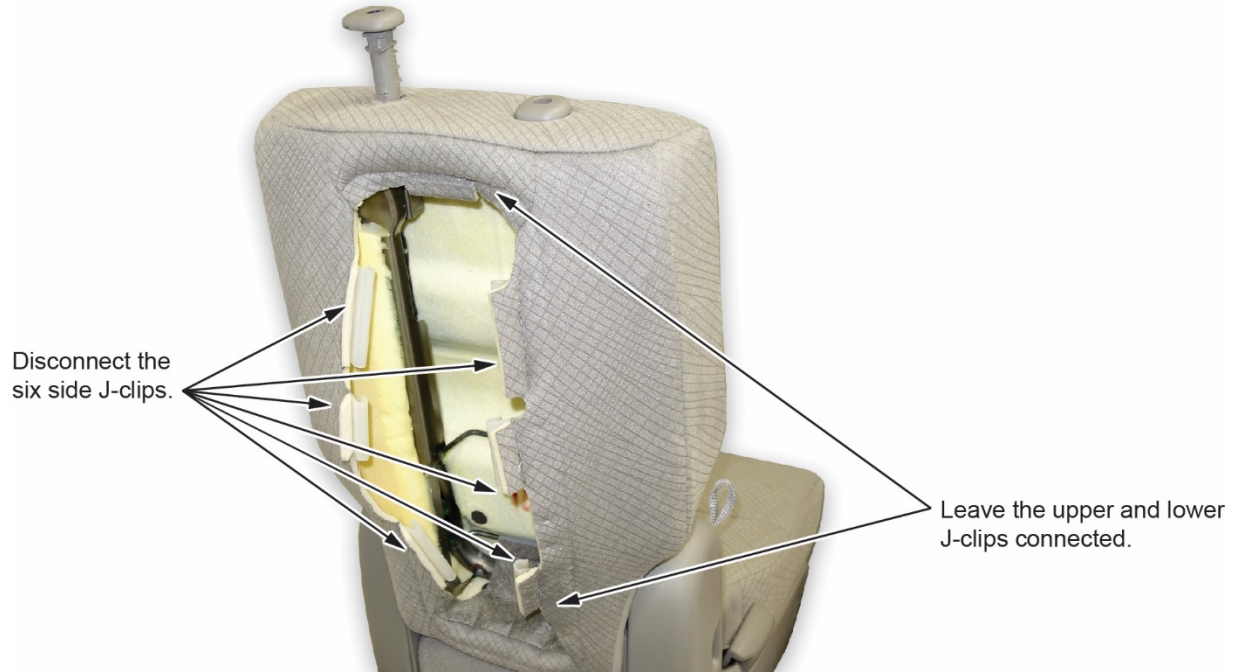

5. Loosen the upper and lower 10 mm bolts to remove the damper from the seat frame.



6. Clean the bracket with isopropyl alcohol, then tape the 5 mm nut to the bracket, and align the threads with the hole in the bracket as shown.

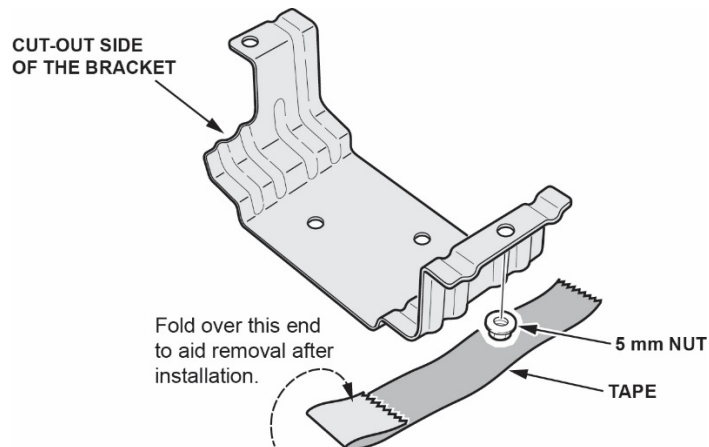

7. Place the bracket on top of the foam with the legs under the frame and the damper cutout on the left side.

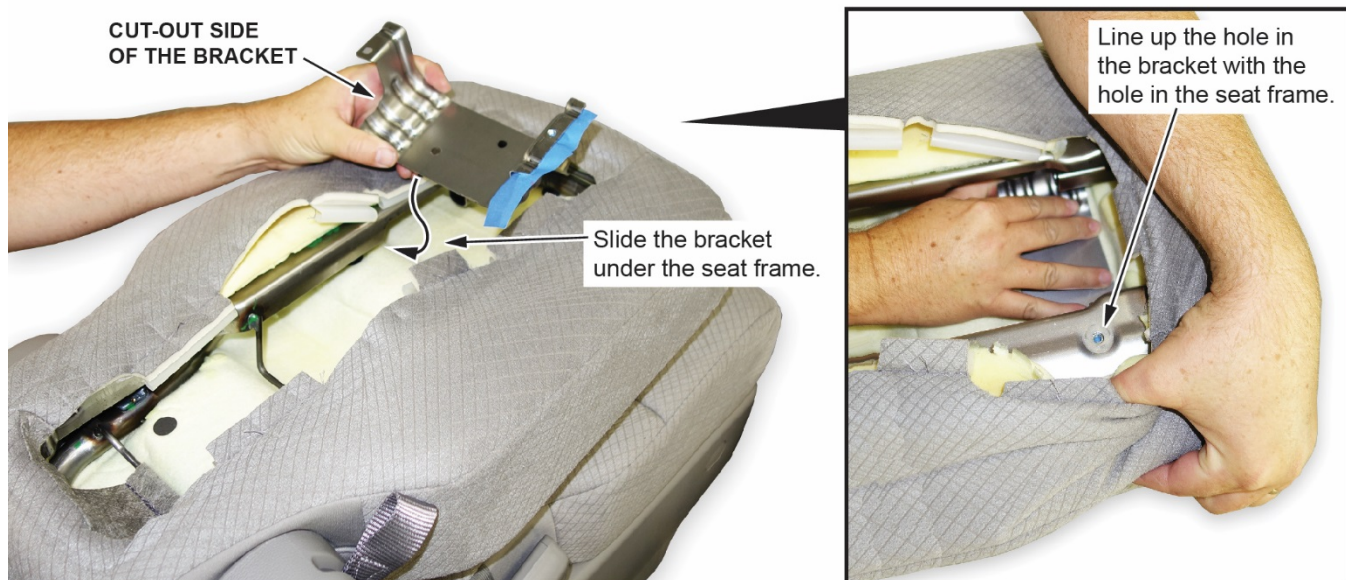

8. Line up the right side of the bracket with the hole in the seat.
9. Install the 8 mm bolt/washer from the kit into the nut taped on the back of the bracket. Hand-tighten the bolt, and remove the tape.

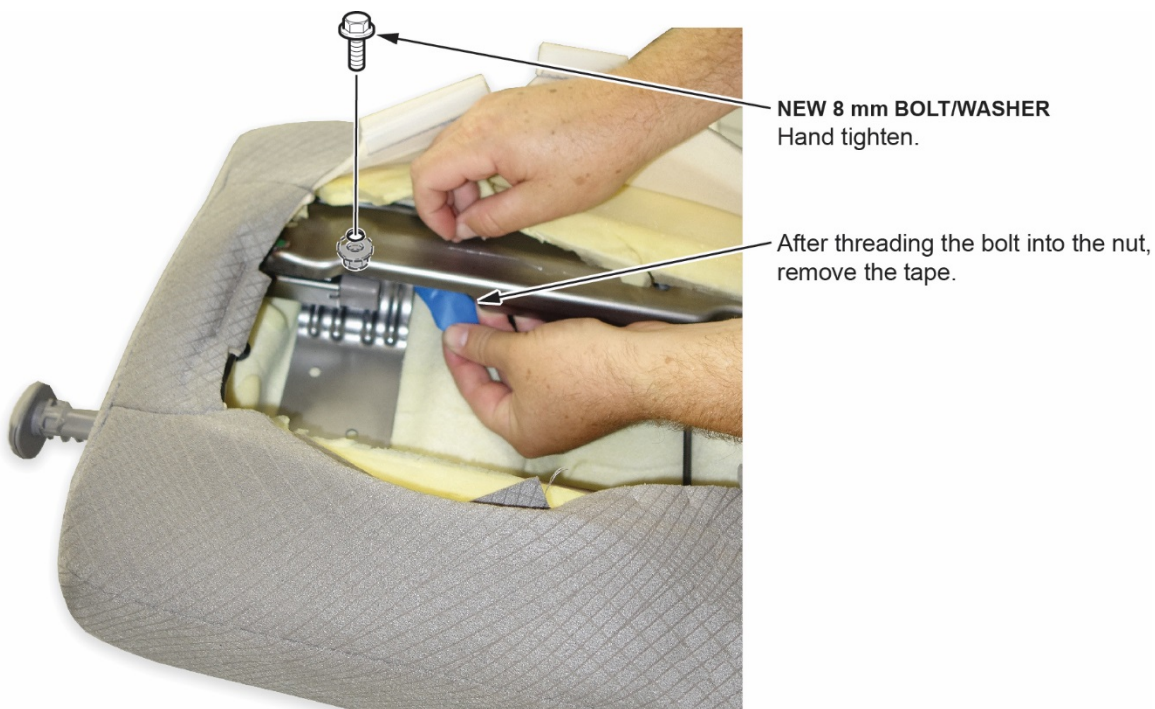

10. Recline the seat to the full recline position.



11. Line up the hole in the bracket with the hole in the seat frame, then install the new longer 10 mm bolt from the kit.

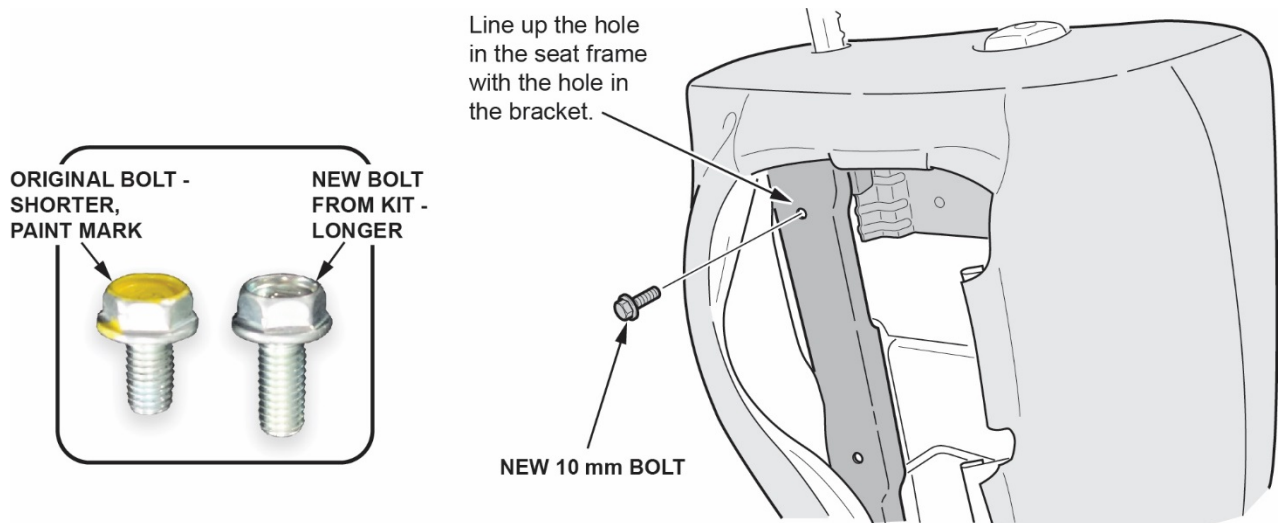

12. Slip the new 6 mm washer from the kit over the end of the 10 mm bolt.

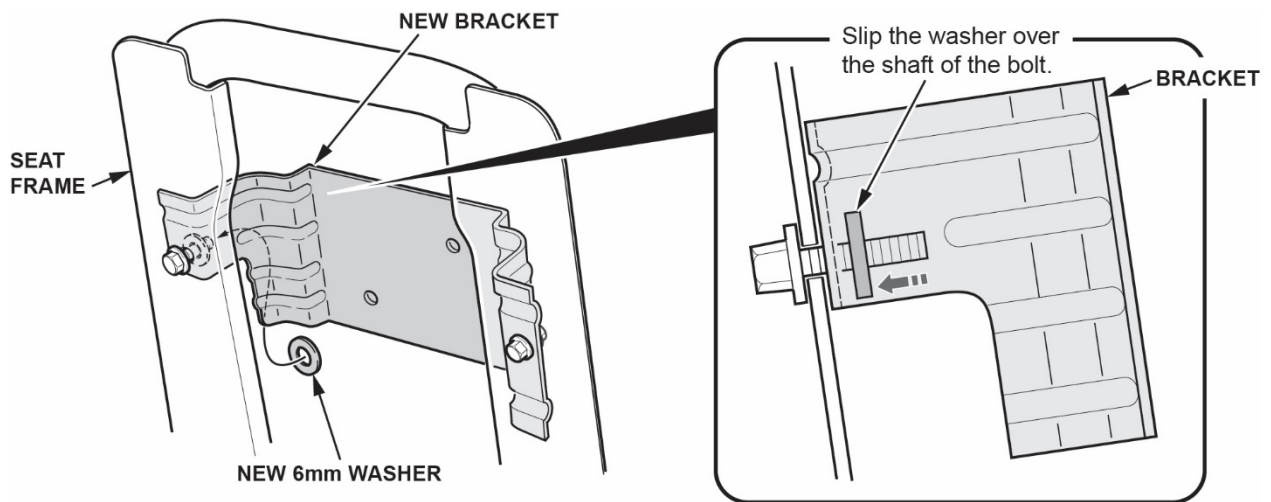

13. Install the damper, and start the upper bolt into the nut welded to the damper bracket.

NOTE: Do not tighten the bolt at this time.

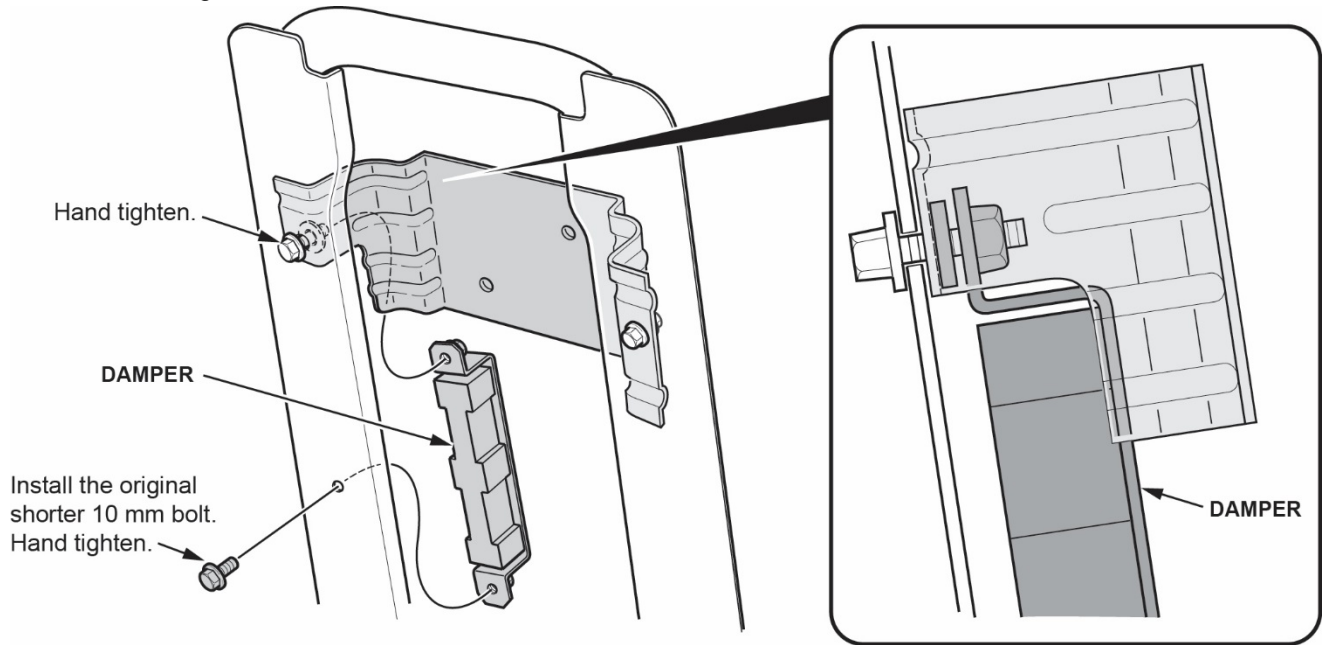

14. Insert the original 10 mm bolt through the lower seat frame hole and into the nut welded on the damper.

15. Tighten the two damper bolts to **12.3 N·m (9 lb-ft)** and the bracket bolt to **7.6 N·m (5.5 lb-ft)**.

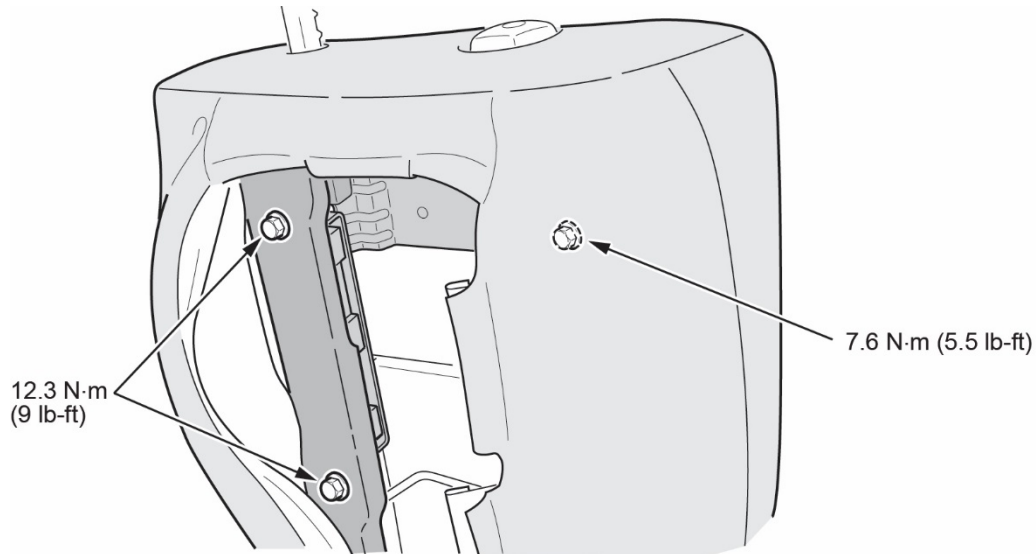

16. Install the left headrest lock guide.

17. Install the J-clips as shown.

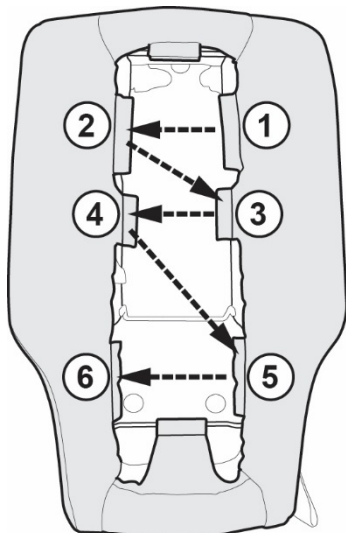

18. Smooth out both flat surfaces by hand as shown.

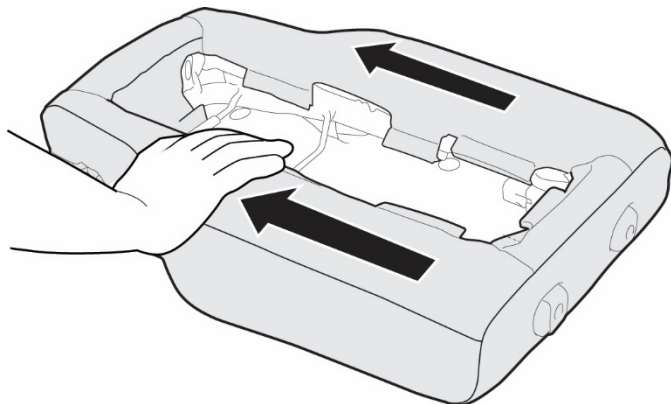

19. Install the cup holder front side first. Angle the cup holder at 45 degrees, then rotate down.

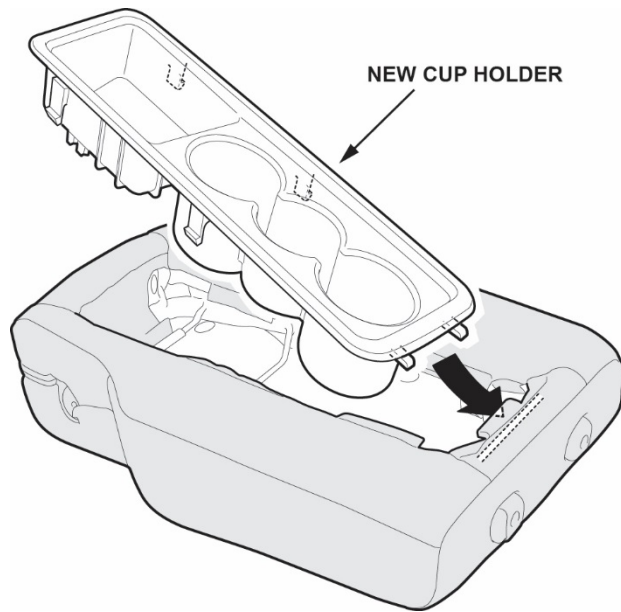

20. Install the headrest.

21. Hook the front of the seat to the floor first, then push down the rear of the seat-back and make sure it latches in place.



22. Return the seat-back to the upright position and confirm the seat locks properly.

END