

August 12, 2017

07187 Version 3

AWD Indicator Comes On and Sets DTC C1858-73

Supersedes 15-016, dated December 4, 2015, to revise the information highlighted in **yellow**.

AFFECTED VEHICLES

Year	Model	Trim	VIN range
2012–13	CR-V	ALL with AWD	ALL with AWD
2014	CR-V	ALL with AWD	5J6RM4...EL000001 thru 5J6RM4...EL037745
			2HKRM4...EH500001 thru 2HKRM4...EH632239

REVISION SUMMARY

- Added 2014 CR-V under AFFECTED VEHICLES

SYMPTOM

The electric differential pressure solenoid (EDPS) in the rear differential has excessive oil pressure, causing the AWD indicator to come on and DTC C-1858-73 (differential fluid pressure deviation high) to set.

POSSIBLE CAUSES

There is abnormal wear on the EDPS solenoid plunger.

CORRECTIVE ACTION

Replace the EDPS solenoid.

PARTS INFORMATION

Part Name	Part Number	Quantity
Solenoid Assembly	48350-5TG-003	1
Bolt (12-point, 8 mm x 21 mm)	90113-S10-000	4
Flange Bolt (8 mm x 14 mm)	95701-08014-08	2
Drain Washer (20 mm)	94109-20000	1
Drain Washer (18 mm)	90471-PX4-000	1
O-Ring (7.7 mm x 2.3 mm)	91301-PC9-003	1
O-Ring (28.4 mm x 2.4 mm)	91306-R7L-003	1
Clip	91540-STK-003	1
Liquid Gasket	08718-0004	1
Honda Dual Pump Fluid II	08200-9007	2

CUSTOMER INFORMATION: The information in this bulletin is intended for use only by skilled technicians who have the proper tools, equipment, and training to correctly and safely maintain your vehicle. These procedures should not be attempted by “do-it-yourselfers,” and you should not assume this bulletin applies to your vehicle, or that your vehicle has the condition described. To determine whether this information applies, contact an authorized Honda automobile dealer.

WARRANTY CLAIM INFORMATION

The normal warranty applies.

Operation Number	Description	Flat Rate Time	Template ID	Failed Part Number
2191Y0	Replace the EDPS solenoid.	1.4 hrs	15-016A	48350-R7L-013

Defect Code: 03217

Symptom Code: 03214

Skill Level: Repair Technician

REPAIR PROCEDURE

1. Raise the vehicle on a lift and make sure it is securely supported.
2. Shift into Neutral.
3. Remove the oil filler plug and sealing washer from the rear differential.

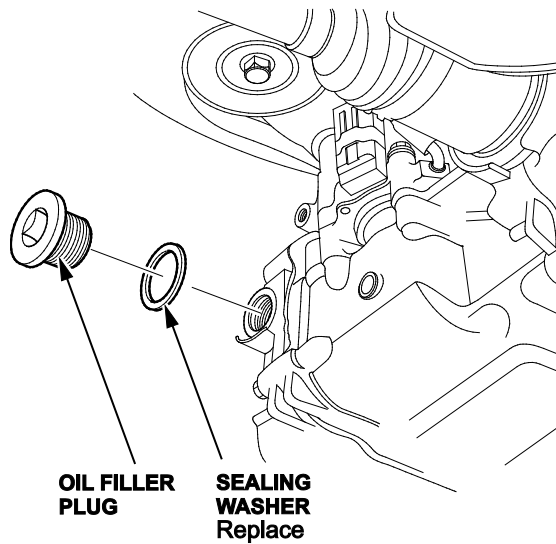

4. Remove the drain plug and sealing washer, then drain the rear differential fluid.

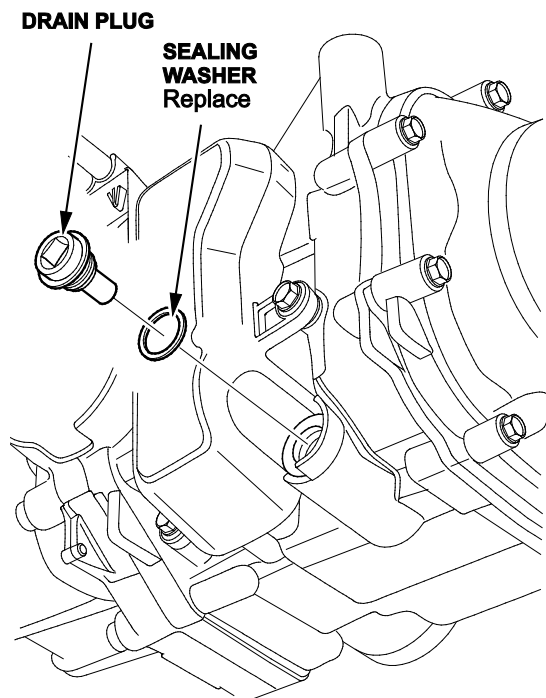

5. Remove the No. 1 propeller shaft protector.

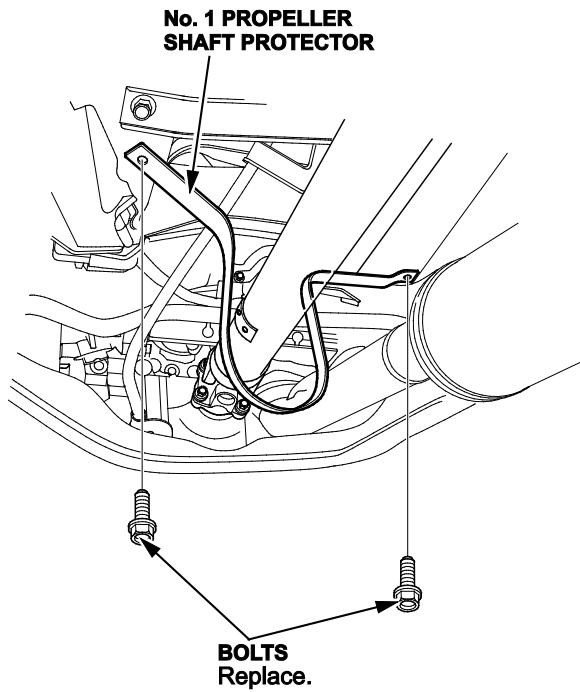

6. Disconnect the propeller shaft from the rear differential:

- Make a reference mark across the No. 2 propeller shaft and the transfer companion flange.
- Remove the propeller shaft flange bolts.
- Separate the propeller shaft from the rear differential.
- Tie off the propeller shaft with an appropriate size nylon strap.

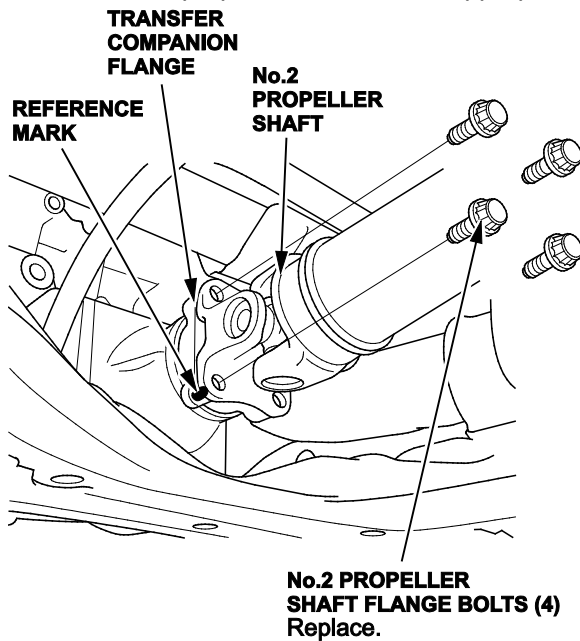

7. Support the rear differential with a jack. Remove the mounting bolts and lower the differential about 1 inch.

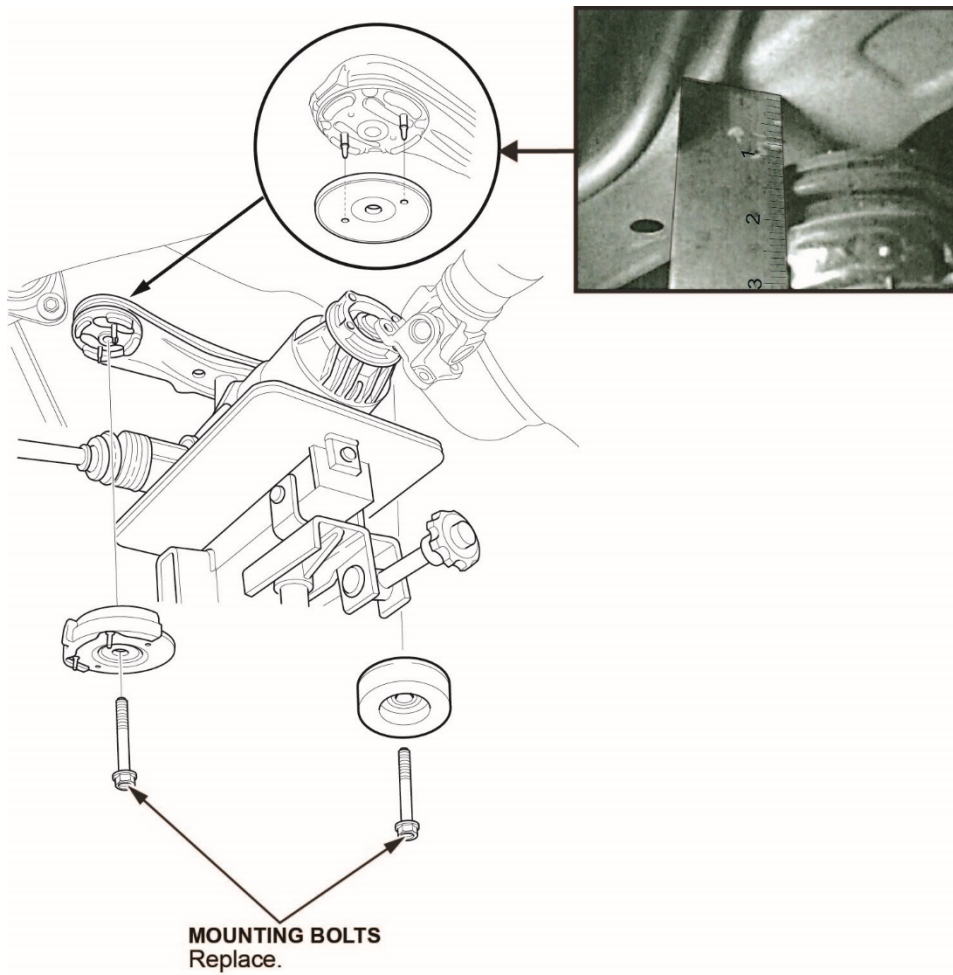

8. Disconnect the breather hose from the pump motor breather pipe, then remove the harness bracket.

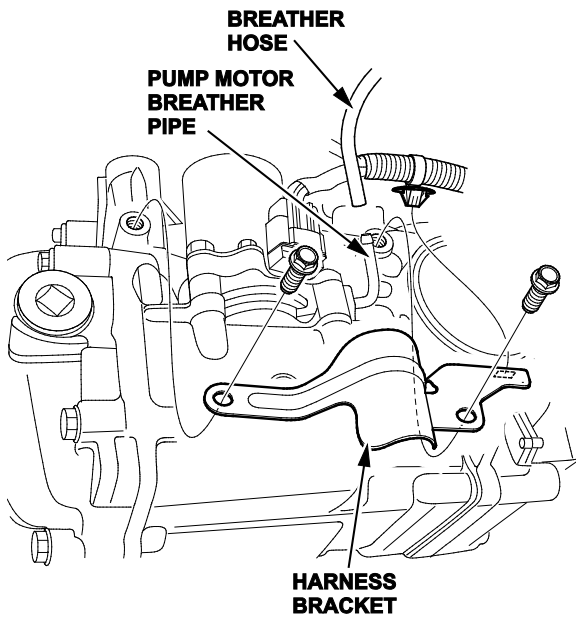

9. Disconnect the connector.

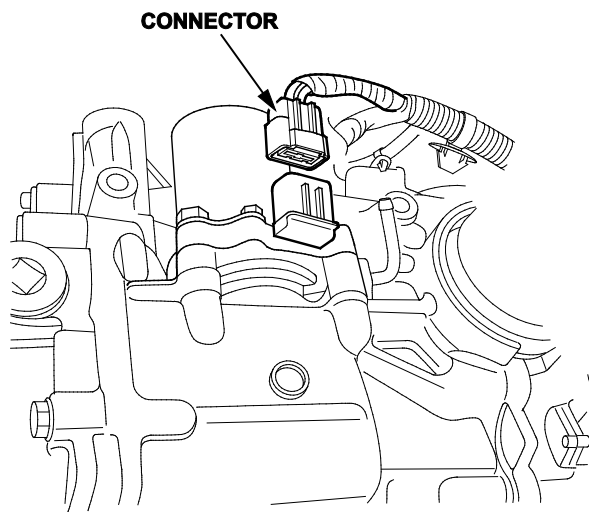

10. Remove the rear differential pump motor and the O-ring.

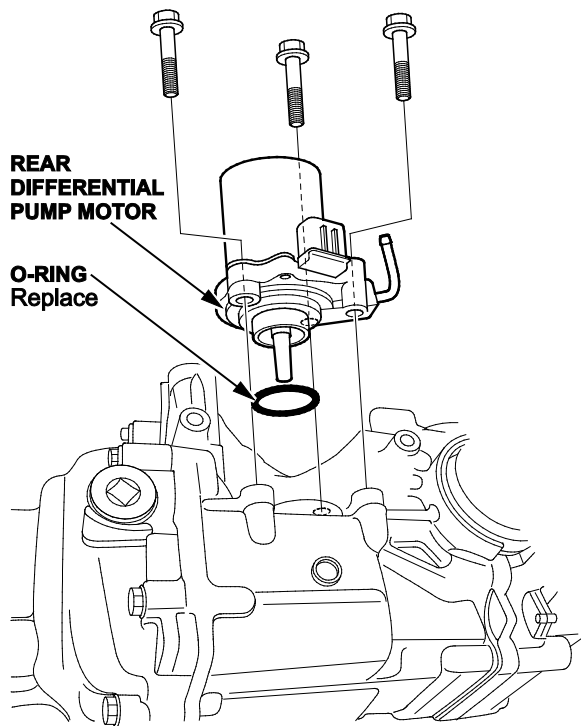

11. Remove the connector cover.



12. Disconnect the EPDS connector, then remove the solenoid connector.

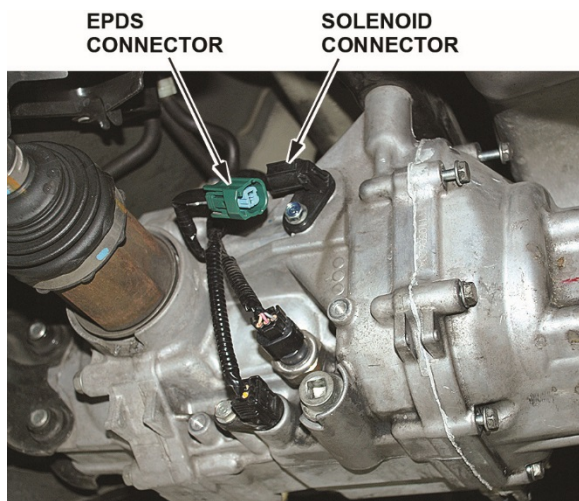

13. Remove the bolts, then remove the torque control differential assembly.

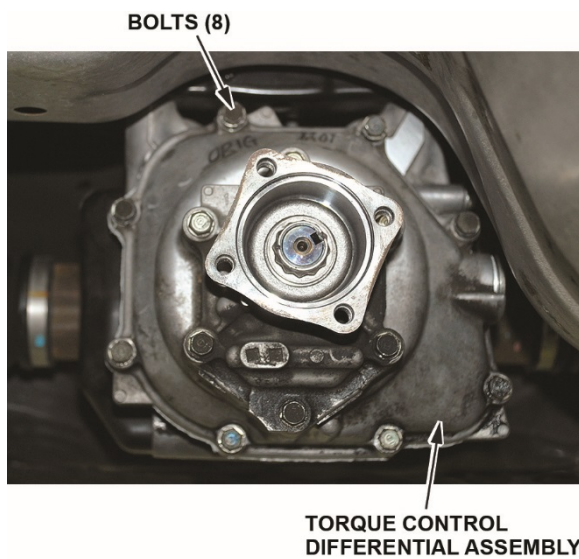

14. Remove the three shims from the pump housing assembly and note the order from which they were removed.

NOTE: Make sure the large 101.5 mm shim fits into the tabs on reassembly. If the shims are removed or fall out while doing the repair, note the orientation of the shims and reinstall in the order shown.

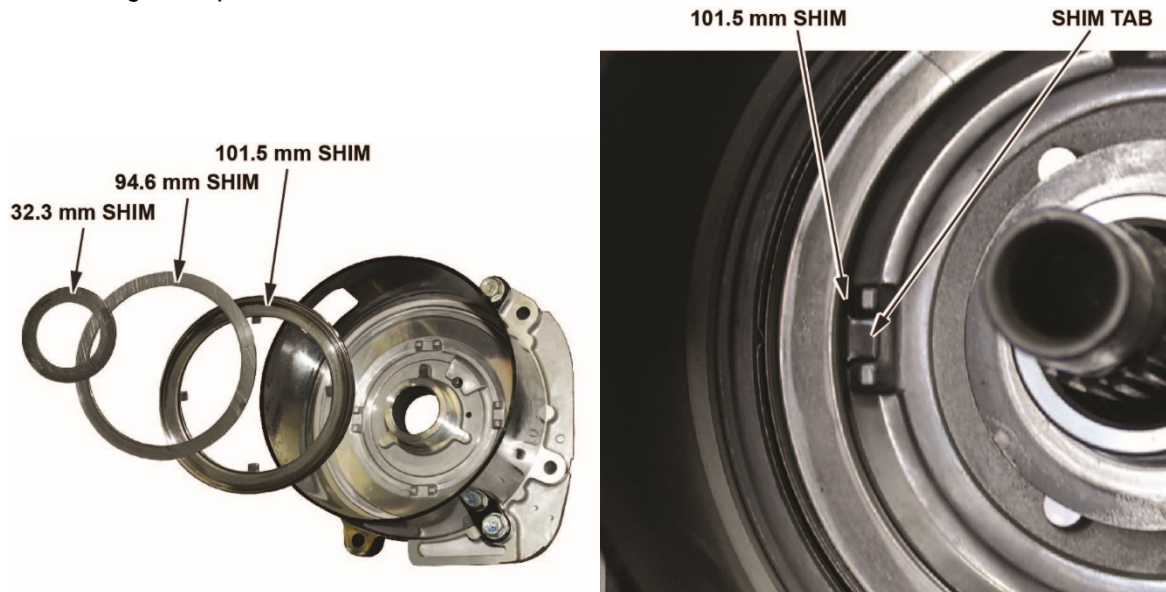

15. Remove the four bolts from the pump housing assembly to remove it.

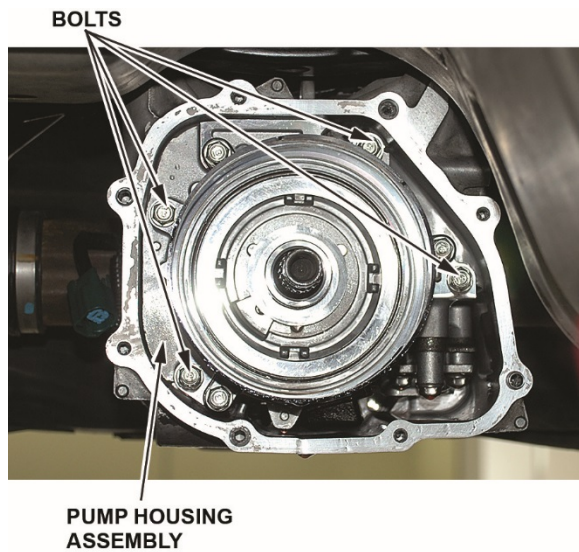

16. Remove the EPDS solenoid.

NOTE: If Service Bulletin 14-047, *Noise From the Rear Differential*, was done, make sure the intermediate drive joint does not fall out when handling the pump housing.

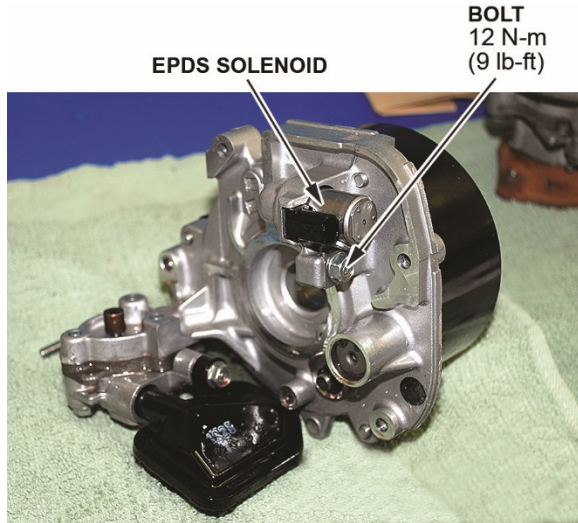

17. Install the new EPDS solenoid and torque the bolts to **12 N·m (9 lb-ft)**.

18. Replace the O-ring with a new one.



19. Install the pump housing assembly and torque the bolts to **12 N·m (9 lb-ft)**.

20. Install the shims in the order of removal and make sure the tabs are in place.

21. Remove the old gasket and any dirt and oil from the mating surface.

22. Apply liquid gasket evenly to the entire sealing surface and install the component within 5 minutes of applying it.

NOTE: Allow the liquid gasket to cure for 30 minutes after assembly before filling the differential with the recommended fluid.

23. Install the torque control differential assembly and torque the bolts to **12 N·m (9 lb-ft)**.

24. Install the solenoid connector and the EPDS connector.

25. Install the connector cover.

26. Install the rear differential pump motor with a new O-ring and torque the bolts to **12 N·m (9 lb-ft)**.

27. Connect the connector.

28. Install the harness bracket and the breather hose to the pipe.

29. Install the new mounting bolts and torque them to **44 N·m (32 lb-ft)**.

30. Install the propeller shaft:
 - Attach the propeller shaft to the rear differential companion flange by aligning the reference mark you made in step 6.
 - Install the new bolts and torque them to **32 N·m (24 lb-ft)**.
31. Install the propeller shaft protector and torque the bolts to **22 N·m (16 lb-ft)**.
32. Clean the drain plug, and install it with a new sealing washer, then torque it to **47 N·m (35 lb-ft)**.
33. Refill the differential to the proper level.
34. Install the oil filler plug with a new sealing washer and torque the plug to **47 N·m 35 lb-ft)**.
35. Connect the HDS to the DLC.
36. Turn the ignition to ON.
37. Make sure the HDS communicates with the vehicle. If it does not communicate, go to the DLC circuit troubleshooting.
38. Select **REAL TIME AWD SYSTEM, ADJUSTMENT**, and **AIR BLEEDING**.

NOTE: See the HDS Help menu for specific instructions.

END