

Technical Service Bulletin

Mazda North American Operations
Irvine, CA 92618-2922



© 2017 Mazda Motor of America, Inc.

Subject: CHECK ENGINE LIGHT ON WITH P0451:00 IN COLD WEATHER	Bulletin No.: 01-003/17
	Last Issued: 03/29/2017

BULLETIN NOTES

This bulletin supercedes the previously issued bulletin(s) listed below. The changes are noted in Red.

Previous TSBs:	Date(s) Issued:
01-003/17	01/20/2017

APPLICABLE MODEL(S)/VINS

2014-2016 Mazda3 vehicles with VINs starting with JM1

2014-2016 Mazda3 vehicles with VINs starting with 3MZ

DESCRIPTION

When the engine is started for the first time after parking overnight in cold weather (below freezing), some vehicles may exhibit the check engine light on with DTC P0451:00 (Fuel tank pressure sensor: sensor characteristic malfunction) stored in memory. This concern may be caused by an increase in discharge resistance due to water accumulated and frozen in the canister vent hose.

Customers having this concern should have their vehicle repaired using the following repair procedure.

REPAIR PROCEDURE

1. Verify the customer concern.
2. Safely lift the vehicle up on a hoist.
3. Check if the Canister Vent Hose is clogged with frozen water.
 - If the hose is clogged with frozen water, go to the next step.
 - If the hose is not clogged with frozen water, refer to MS3 online instructions to diagnose DTC P0451:00.

CONSUMER NOTICE: The information and instructions in this bulletin are intended for use by skilled technicians. Mazda technicians utilize the proper tools/equipment and take training to correctly and safely maintain Mazda vehicles. These instructions should not be performed by "do-it-yourselfers." Customers should not assume this bulletin applies to their vehicle or that their vehicle will develop the described concern. To determine if the information applies, customers should contact their nearest authorized Mazda dealership. Mazda North American Operations reserves the right to alter the specifications and contents of this bulletin without obligation or advance notice. All rights reserved. No part of this bulletin may be reproduced in any form or by any means, electronic or mechanical---including photocopying and recording and the use of any kind of information storage and retrieval system ---without permission in writing.

4. For 4-door sedan

a. Cut the Evaporative Hose No.1 (A) diagonally to enlarge the cross section as shown (C = cut point) to avoid water from accumulating and freezing. (F = vehicle front, F(B) = Vehicle front (view from bottom))

NOTE: Use of a utility knife or pliers with cutters is recommended to cut the hose.

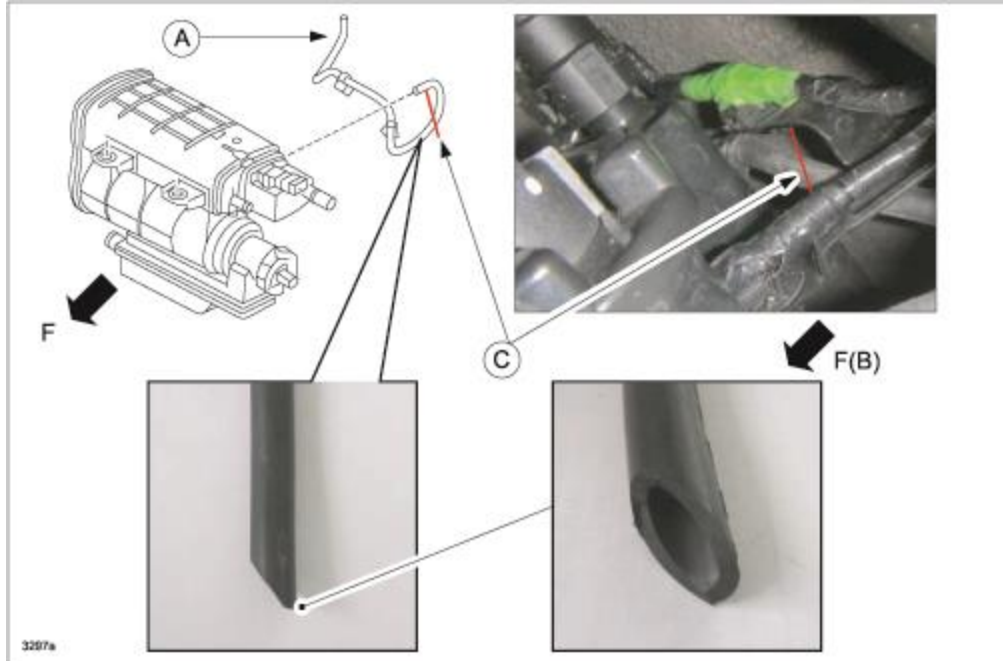

For 5-door hatchback

a. Pull out the Evaporative Hose No.1 (A) from the Charcoal Canister outlet.

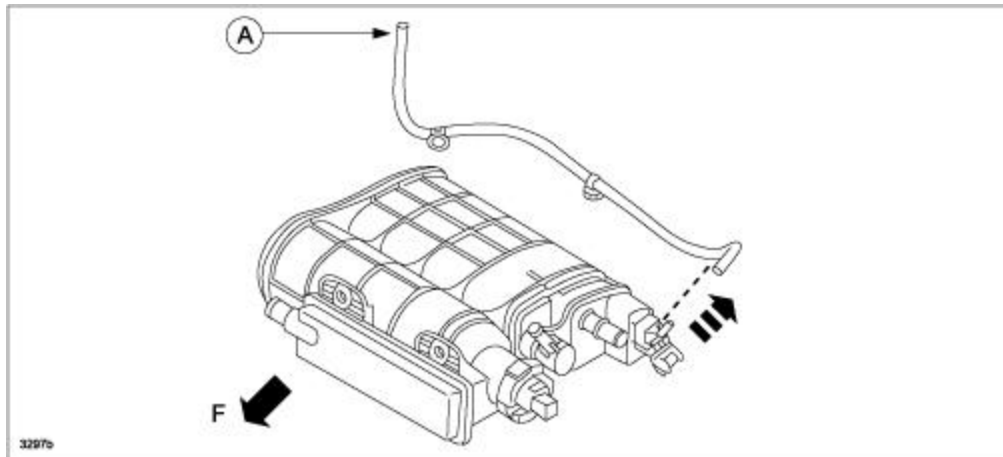

b. Install the Canister Hose (PE01-13-971) (B) to the Charcoal Canister outlet.

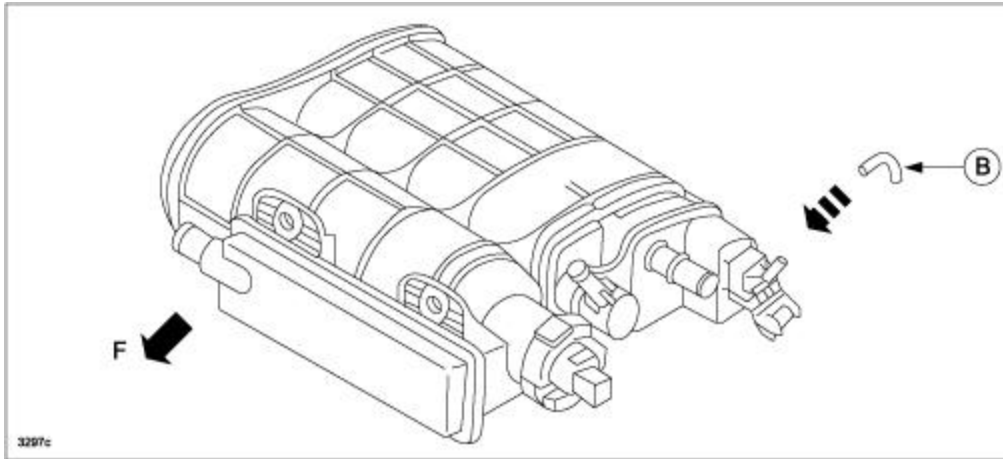

c. Tie the Evaporative Hose No.1 (A) and the Canister Hose (PE01-13-971) (B) with a tie-wrap (C) as shown.

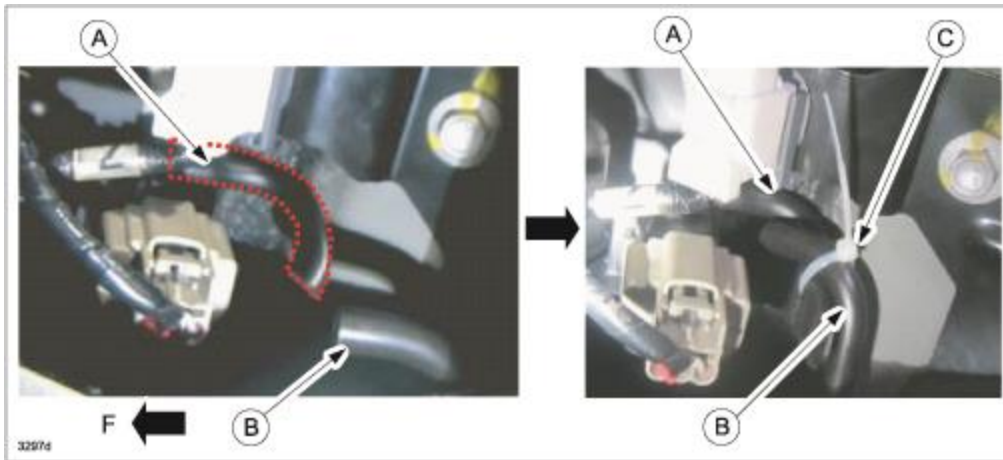

- 5. Lower the vehicle.
- 6. Clear the DTC.
- 7. Verify the repair.

PARTS INFORMATION

Part Number	Description	Qty.	Notes
PE01-13-971	Hose, Canister	1	5-door hatchback only

WARRANTY INFORMATION

NOTE:

- This warranty information applies only to verified customer complaints on vehicles eligible for warranty repair.
- This repair will be covered under Mazda's New Vehicle Limited Warranty or CA PZEV Emission Warranty (2.0L AT/MT, 2.5L AT) / CA Emission Warranty short term (2.5L MT) where applicable.
- Additional diagnostic time cannot be claimed for this repair.

	4-door sedan	5-door hatchback
Warranty Type	A	
Symptom Code	6X	
Damage Code	9W	
Part Number Main Cause	PE8V-13-97XA (Hose, Canister)	PE5J-13-97XA (Hose, Canister)
Quantity	0	0
Operation Number / Labor Hours:	XXMBZXRX / 0.5 Hrs.	

Note: For 5-door hatchback case only, claim PE01-13-971 as a related part, quantity 1.