	GROUP BOD	MODEL 2014-2015MY Optima (QF) Sorento (XMa)
	NUMBER 167	DATE April 2017
TECHNICAL SERVICE BULLETIN		
SUBJECT: EXTERIOR EMBLEM REPLACEMENT		

This bulletin provides the procedure to replace the front and rear Kia emblems on some 2014-2015MY Optima (QF) and replace the front and if necessary, the rear emblems on some 2014-2015MY Sorento (XMa) vehicles, which may exhibit peeling or delamination of the emblem coating. Follow the procedures outlined in this bulletin to correct the concern of peeling or delaminating emblems.

Model	Concern	Action
Optima (QF)	Front Emblem	Replace Front <u>and</u> Rear
	Rear Emblem	
Sorento (XMa)	Front Emblem	Replace
	Rear Emblem	Inspect and replace if necessary



Delaminated Emblem

File Under: <Body>

Circulate To: General Manager Service Manager Parts Manager
 Service Advisors Technicians Body Shop Manager Fleet Repair

Optima (QF) Service Procedure:

1. With masking tape, apply two (2) to three (3) layers of protection to the bumper cover at the surrounding areas (A) of the emblem.

**CAUTION**

Do NOT use a heat gun as it may damage the vehicle paint and components.



2. Using a non-marring trim removal tool, start at the edge of the emblem (B) and carefully pry around the emblem towards the center to remove it.

**CAUTION**

Use a non-marring trim removal tool (such as Snap-on® Part Number PBN5 or equivalent) to avoid damaging trim pieces.



3. Remove the adhesive residue from the painted surface (C) and clean the painted surface with an adhesive cleaner.

**CAUTION**

Do NOT use an adhesive eraser wheel tool as it may damage the vehicle paint and components.

Use the adhesive cleaner on an inconspicuous location before using it on the bumper. Do NOT use brake cleaner on any body components and surfaces.

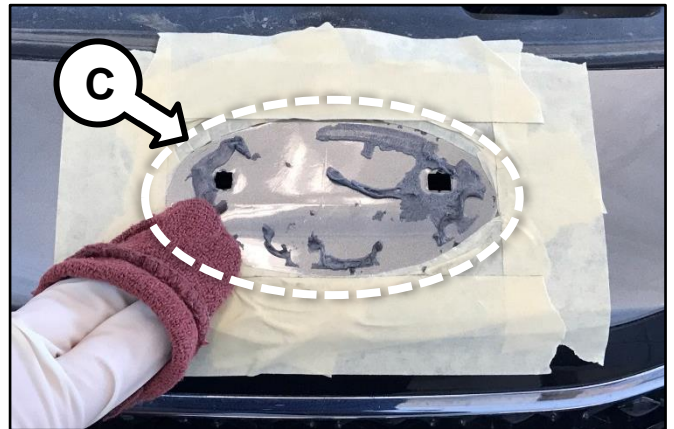

4. Remove the masking tape then carefully align and install the new emblem.



5. Repeat steps 1 to 4 for the rear emblem.

SUBJECT:

EXTERIOR EMBLEM REPLACEMENT

Sorento (XMa) Service Procedure:

1. Open the hood.
2. Remove the two (2) upper radiator cover retaining bolts and four (4) retaining clips.

**Tightening torque for retaining bolts:
26.04 in.lb (2.94 Nm, 0.3 kgf.m)**



3. Carefully and partially pull and hold the radiator upper cover to gain access behind the cover.

**CAUTION**

Use caution not to pull the radiator cover too far as damage to the radiator cover and/or bumper cover may result.



4. With cutter pliers, cut the three (3) emblem retaining clips (B) and remove the emblem.

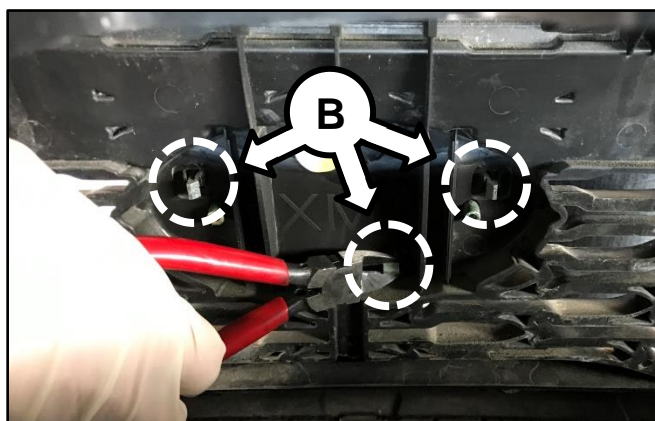

5. Clean the front grill at the emblem area (C) and ensure it is free of dirt or foreign substances before installation of the new emblem.



6. Install the new emblem.



7. Reinstall all removed components in the reverse order of removal.

8. Inspect the rear emblem for peeling or delamination.

If peeling or delamination IS evident, proceed to the next step.

If peeling or delamination is NOT evident, no further action is required.



Rear Emblem Delaminated

9. Remove the tailgate back panel (garnish) (D) by referring to the “Body (Interior and Exterior) → Exterior → Tail Gate → Repair Procedure” chapter in the applicable Shop Manual on KGIS.

*** NOTICE**

Removal of the inner taillights may be necessary for easier removal of the tailgate garnish.



10. Place the tailgate garnish on a soft, flat, protected surface with the retaining screws (E) facing up. Remove the two (2) emblem retaining screws (E) and remove the emblem.

*** NOTICE**

Replace any garnish clips that may have broken during removal of the tailgate garnish.

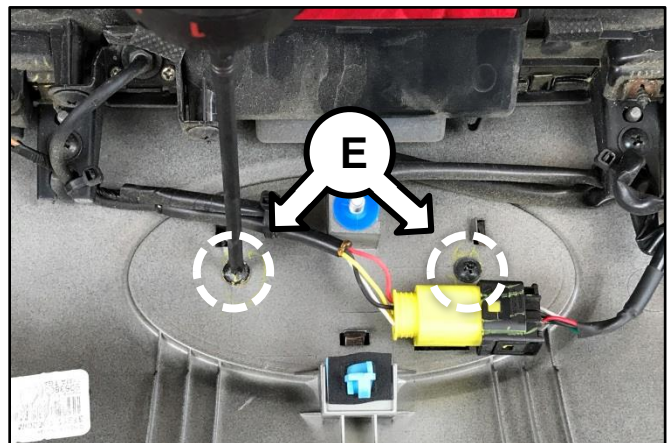

SUBJECT:

EXTERIOR EMBLEM REPLACEMENT

11. Clean the garnish at the emblem area (F) and ensure it is free of dirt or foreign substances before installation of the new emblem.

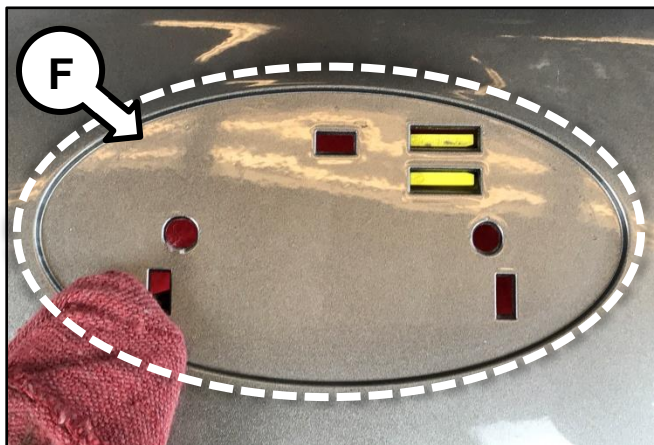

12. Install the new emblem.



13. Reinstall all removed components in the reverse order of removal.

SUBJECT:

EXTERIOR EMBLEM REPLACEMENT

AFFECTED VEHICLE RANGE:

Model	Production Date Range
Optima (QF)	August 28, 2013 to October 31, 2014
Sorento (XMa)	January 02, 2013 to October 31, 2014

REQUIRED PART:

Model	Part Name	Part Number	Figure
Optima (QF)	Ornament – Kia (Front)	86318 3R500	
	Logo – Kia (Rear)	86320 2T500	
Sorento (XMa)	Emblem – Kia (Front)	86320 2P560	
		86320 3E500	
	Logo Assy – Kia (Rear)	86353 1F500	
	Garnish Clips	87756 2E000	
			Qty.
			11

WARRANTY INFORMATION:

N Code: B16 C Code: ZZ2

Model	Claim Type	Causal P/N	Qty.	Repair Description	Labor Op Code	Op Time	Replacement P/N	Qty.
QF	W	86318 3R500	0	Emblem Replacement (Front & Rear)	86320F01	0.5 M/H	86318 3R500	1
							86320 2T500	1
XMa		86320 2P560		Emblem Replacement (Front) & Inspection (Rear)	86320F03	0.6 M/H	86320 2P560	1
							86320 3E500	
		86320 2P560		Emblem Replacement (Front & Rear)	86320F02	0.8 M/H	86320 2P560	1
							86320 3E500	
						86353 1F500	1	