	GROUP ELE	MODEL 2016MY Optima (JFa)
	NUMBER 130	DATE March 2017
<b>TECHNICAL SERVICE BULLETIN</b>		
<b>SUBJECT: SERVICE ACTION: ANTENNA INSPECTION AND/OR REPLACEMENT (SA272)</b>		

This bulletin provides the procedure to inspect and/or replace the antenna assembly on some 2016MY Optima (JFa) vehicles, produced from September 28, 2015 to June 1, 2016, which may experience an antenna cover separation/loss or looseness. Follow the procedure outlined in this bulletin to inspect and/or replace the antenna assembly. Before conducting the procedure, verify that the vehicle is included in the list of affected VINs.

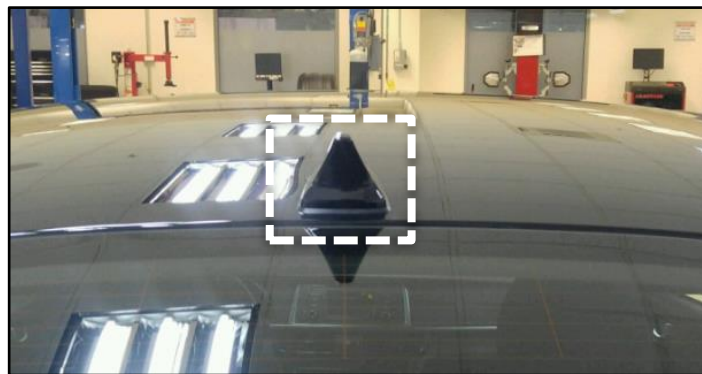

**\* NOTICE**

A Service Action is a repair program without customer notification that is performed during the warranty period. Any dealer requesting to perform this repair outside the warranty period will require DPSM approval.

Repair status for a VIN is provided on WebDCS (Service → Warranty Coverage → Warranty Coverage Inquiry → Campaign Information). Not completed Recall / Service Action reports are available on WebDCS (Consumer Affairs → Not Completed Recall → Recall VIN → Select Report), which includes a list of affected vehicles.

This issue number is SA272.

File Under: <Electrical>

- General Manager     
 Service Manager     
 Parts Manager  
 Service Advisors     
 Technicians     
 Body Shop Manager     
 Fleet Repair

**Inspection Procedure:**

1. With medium force, push the antenna from side to side to verify that the antenna cap is not broken. If a cracking noise is heard or if the cap comes loose, replacement of the antenna assembly is necessary. If cap is found to be structurally sound, no further action is required.

[Click here to view a video tutorial of the antenna inspection.](#)

**Service Procedure:**

1. Record the customer's radio presets.
2. Disconnect the negative (-) battery terminal.
3. Lower the headliner (roof trim) assembly (A) by referring to the "Body (Interior and Exterior) → Roof Trim → Roof Trim Assembly → Repair procedures" chapter in the applicable Shop Manual on KGIS.

**NOTE:** For this procedure, the headliner **DOES NOT** need to be removed from the vehicle; carefully and evenly lower the headliner assembly only, to access the roof antenna connectors and retaining nut.

**DO NOT** remove the components listed below.

- Front seats (Slide back both front seat assemblies and recline both front seat backs to MAX positions.)
- Floor console assembly

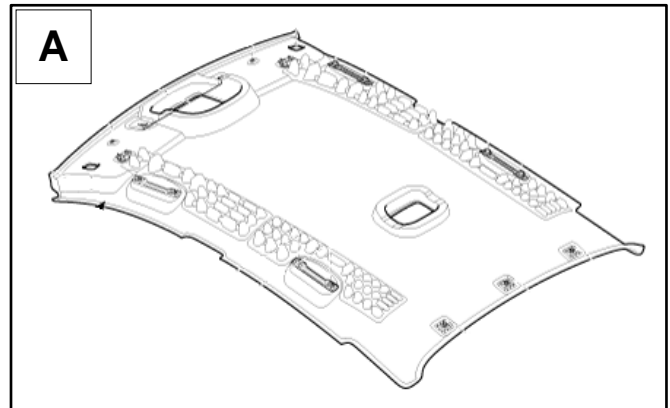
**CAUTION**

Use caution not to damage or fold the headliner. Wear gloves to prevent leaving fingerprints on trim.

SUBJECT:

## ANTENNA INSPECTION AND/OR REPLACEMENT (SA272)

- Disconnect the two (2) antenna connectors (B).

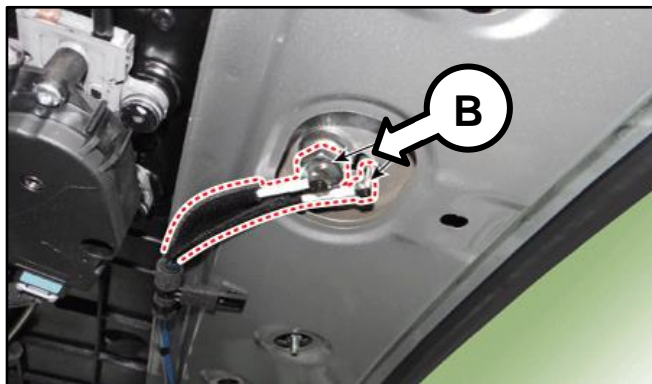

- Remove the antenna retaining nut (C) then remove the antenna assembly (D).

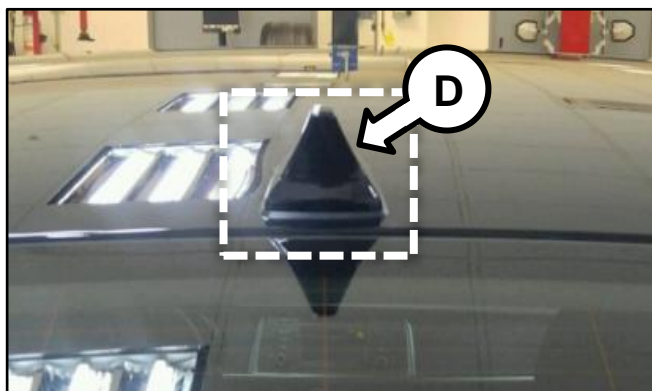
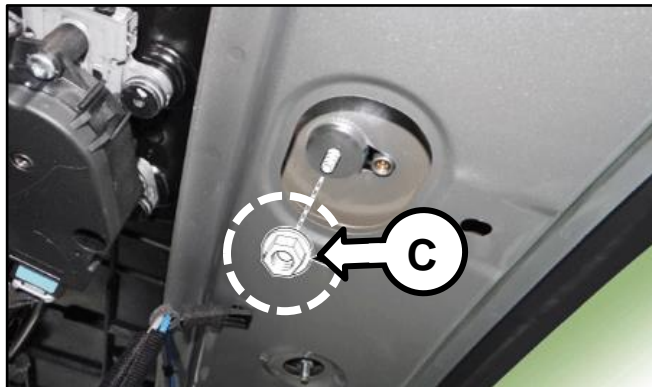

- Install the new antenna. Reinstall all removed components in the reverse order of removal.

**CAUTION**

Use caution to ensure the antenna connectors (B) are completely inserted and locked prior to reinstalling the roof trim.

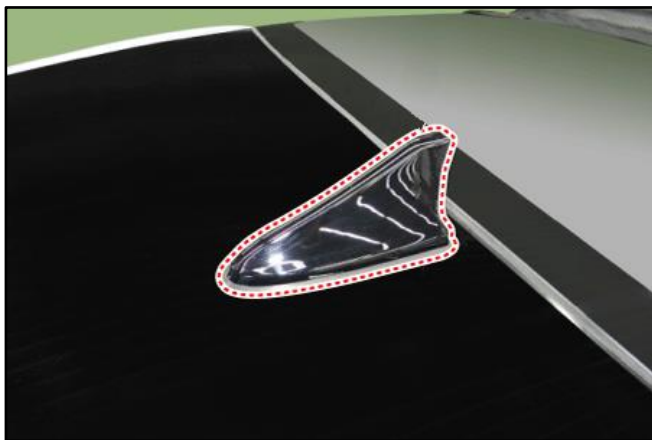

- Verify proper operation of the radio and reprogram the customer's radio presets if necessary.

SUBJECT:

## ANTENNA INSPECTION AND/OR REPLACEMENT (SA272)

AFFECTED VEHICLE RANGE:

Model	Production Date Range
Optima (JFa)	September 28, 2015 to June 1, 2016

REQUIRED PART: **NOTE: For certain colors, the total quantity of affected vehicles in this Service Action is extremely low, and for those the initial replacement antenna stock is also very limited.**

**Due to that limited parts availability, do NOT order parts unless you have an affected in-stock or customer vehicle that has been confirmed to actually requires the replacement.**

Part Name	Part Number
AVN Antenna Assembly (W/O NAVI) Platinum Graphite	96210 D5400ABTQK
AVN Antenna Assembly (W/O NAVI) Ebony Black	96210 D5400EBQK
AVN Antenna Assembly (W/O NAVI) Titanium Silver	96210 D5400IMQK
AVN Antenna Assembly (W/O NAVI) Sparkling Silver	96210 D5400KCSQK
AVN Antenna Assembly (W/O NAVI) Sangria	96210 D5400M2RQK
AVN Antenna Assembly (W/O NAVI) Moss Grey	96210 D5400M5GQK
AVN Antenna Assembly (W/O NAVI) Horizon Blue	96210 D5400M5UQK
AVN Antenna Assembly (W/O NAVI) Snow White Pearl	96210 D5400SWPQK
AVN Antenna Assembly (W/O NAVI) Remington Red	96210 D5400TR3QK
AVN Antenna Assembly NAVI Platinum Graphite	96210 D5500ABTQK
AVN Antenna Assembly NAVI Ebony Black	96210 D5500EBQK
AVN Antenna Assembly NAVI Titanium Silver	96210 D5500IMQK
AVN Antenna Assembly NAVI Sparkling Silver	96210 D5500KCSQK
AVN Antenna Assembly NAVI Sangria	96210 D5500M2RQK
AVN Antenna Assembly NAVI Moss Grey	96210 D5500M5GQK
AVN Antenna Assembly NAVI Horizon Blue	96210 D5500M5UQK
AVN Antenna Assembly NAVI Snow White Pearl	96210 D5500SWPQK
AVN Antenna Assembly NAVI Remington Red	96210 D5500TR3QK

WARRANTY INFORMATION:

N CODE: N99 C CODE: C99

Claim Type	Causal P/N	Qty.	Repair Description	Labor Op Code	Op Time	Replacement P/N	Qty.
V	96210 D5400	0	(SA272) Antenna Inspection	170A03R0	0.2 M/H	N/A	0
			(SA272) Antenna Inspection & Replacement	170A03R1	2.0 M/H	See Required Parts Table	1

**\* NOTICE**

**VIN inquiry data for this repair is provided for tracking purposes only. Kia retailers should reference SA272 when accessing the WebDCS system.**