

December 22, 2016

04595 Version 1

## Squeal During Electric Parking Brake Operation

### AFFECTED VEHICLES

Year	Model	Trim	VIN range
2014–16	RLX	ALL	All

### SYMPTOM

There is a squeal during electric parking brake (EPB) operation.

### POSSIBLE CAUSES

There is insufficient lubrication in the brake caliper.

### CORRECTIVE ACTION

Replace the applicable caliper body subassembly.

### PARTS INFORMATION

Part Name	Part Number	Quantity
Right Rear Caliper Body Subassembly	43016-TY2-A00	1
Left Rear Caliper Body Subassembly	43017-TY2-A00	1
Sealing Washer	46472-568-000	4
Actuator Seal Kit (Includes 1 seal and 2 bolts)	43012-TY2-A00	2

### WARRANTY CLAIM INFORMATION

The normal warranty applies.

Operation Number	Description	Defect Code	Symptom Code	Flat Rate Time	Template ID	Failed Part Number
411107	Replace the <b>right side</b> caliper body subassembly.	07409	04212	0.7 hr	16-049N	43016-TY2-A00
411105	Replace the <b>left side</b> caliper body subassembly.	07409	04212	0.7 hr	16-049P	43047-TY2-A00
411102	Replace <b>both sides</b> rear caliper body subassemblies.	07409	04212	1.2 hrs	16-049Q	43016-TY2-A00

Skill Level: Repair Technician

**CLIENT INFORMATION:** The information in this bulletin is intended for use only by skilled technicians who have the proper tools, equipment, and training to correctly and safely maintain your vehicle. These procedures should not be attempted by "do-it-yourselfers," and you should not assume this bulletin applies to your vehicle, or that your vehicle has the condition described. To determine whether this information applies, contact an authorized Acura automobile dealer.

## REPAIR PROCEDURE

1. Set the parking brake to determine which caliper is making the noise.
2. Raise the vehicle on a lift and make sure the parking brake is released.
3. Remove the rear wheel.
4. Disconnect the electric parking brake actuator connector, remove the banjo bolt, and disconnect the brake hose from the caliper body.

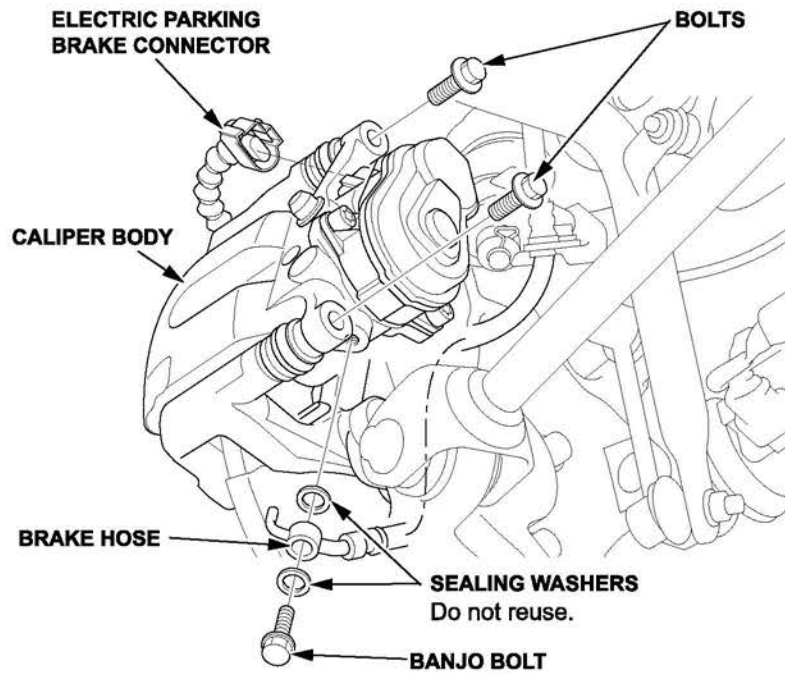

5. Remove the caliper body.

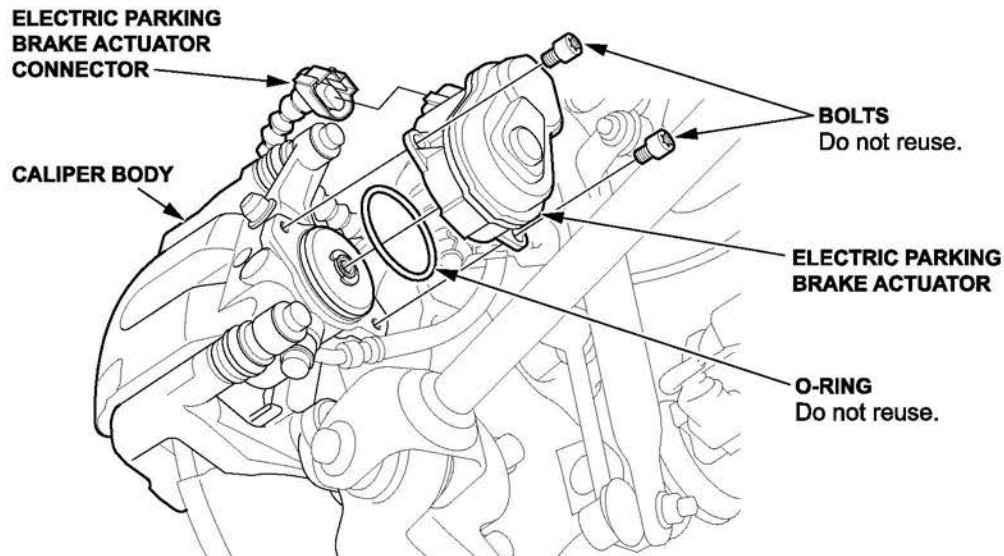

6. Remove the electric parking brake actuator and the O-ring from the caliper body.

7. Install the new O-ring onto the new caliper body. Install the electric parking brake actuator to the new caliper body with new mounting bolts and torque the bolts to **12 N·m (9 lb-ft)**.

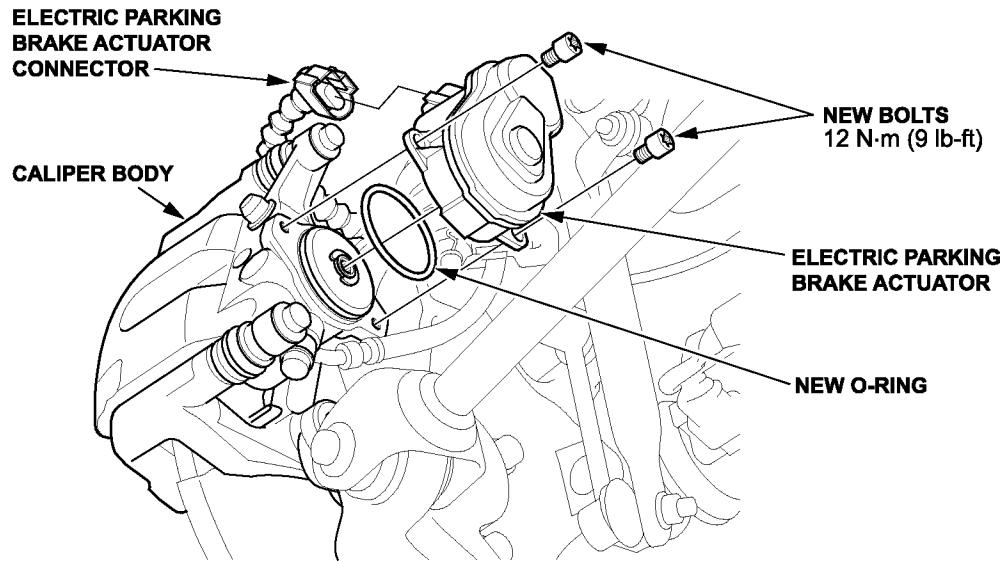

8. Install the caliper body and torque the bolts to **35 N·m (26 lb-ft)**. Connect the brake hose to the caliper body with the banjo bolt and new sealing washers, then torque the bolt to **35 N·m (26 lb-ft)**.

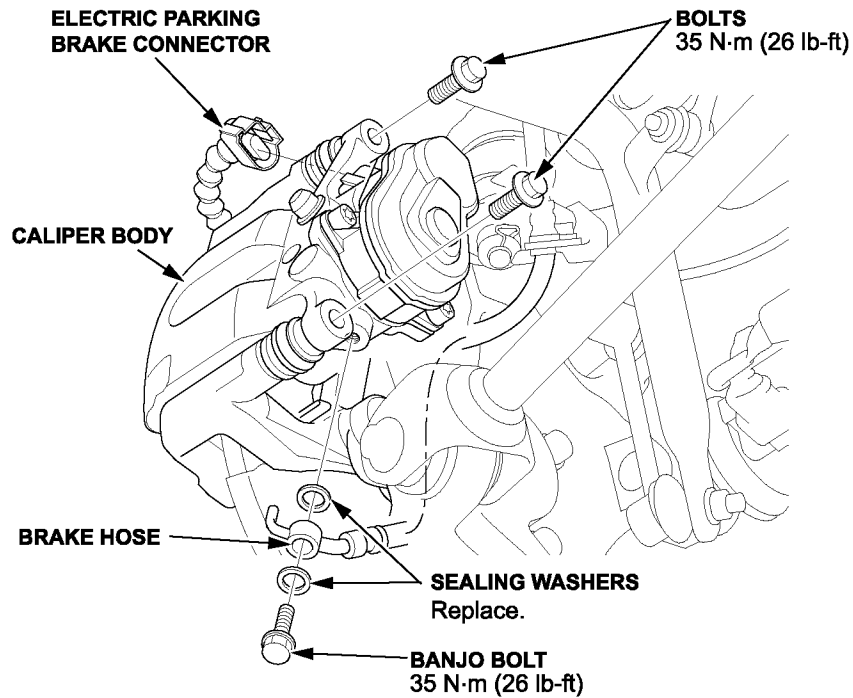

9. Connect the electric parking brake actuator connector.
10. Install the rear wheel and torque the nuts to **127 N·m (94 lb-ft)**.
11. Bleed the brake system according to the service information.
12. Repeat steps 2 thru 10 on the opposite side if needed.

END