

TECHNICAL BULLETIN
 LTB00955NAS2
 15 JUL 2016



© Jaguar Land Rover North America, LLC

NOTE: The information in Technical Bulletins is intended for use by trained, professional Technicians with the knowledge, tools, and equipment required to do the job properly and safely. It informs these Technicians of conditions that may occur on some vehicles, or provides information that could assist in proper vehicle service. The procedures should not be performed by 'do-it-yourselfers'. If you are not a Retailer, do not assume that a condition described affects your vehicle. Contact an authorized Land Rover service facility to determine whether this bulletin applies to a specific vehicle.

This reissue replaces all previous versions. Please destroy all previous versions.

Changes are highlighted in gray

SECTION: 412-00

Air Conditioning Service Port Valve Leaks

AFFECTED VEHICLE RANGE:

Discovery Sport (LC)

Model Year: 2015-2016
VIN: 500429-629372
Assembly Plant: Halewood

Range Rover Evoque (LV)

Model Year: 2012-2016
VIN: 000447-159476
Assembly Plant: Halewood

MARKETS:

NAS

CONDITION SUMMARY:

Situation: The Air Conditioning (A/C) system may exhibit poor performance.

Cause: This may be caused by a leaking A/C charge port valve.

Action: Should a customer express this concern, follow the Service Instruction below.

PARTS:



NOTE: Parts will vary depending on the use of Internal Heat Exchanger (IHX) and non-IHX Air Conditioning (A/C) pipes. Refer to the Service Information to correctly identify the required part.



NOTE: If required, an allowance of \$7.60 may be claimed using 'ZZZ001' for a M8 x 1.0 mm threaded Schrader air conditioning valve core removal tool.

LR088548	A/C Charge Port Valve (Post 16MY)	1
LR002940	A/C Charge Port Valve (Pre 16MY)	1

TOOLS:

Refer to Workshop Manual for any required special tools.

WARRANTY:



NOTE: Repair procedures are under constant review, and therefore times are subject to change; those quoted here must be taken as guidance only. Always refer to TOPIX to obtain the latest repair time.



NOTE: DDW requires the use of causal part numbers. Labor only claims must show the causal part number with a quantity of zero.

DESCRIPTION	SRO	TIME (HOURS)	CONDITION CODE	CAUSAL PART
Air conditioning - Port Valve - Renew - Pair	82.10.61	0.5	07	LR088548



NOTE: Normal Warranty procedures apply.

SERVICE INFORMATION:

- All with Internal Heat Exchanger (IHX) Air Conditioning pipes:** install LR088548.

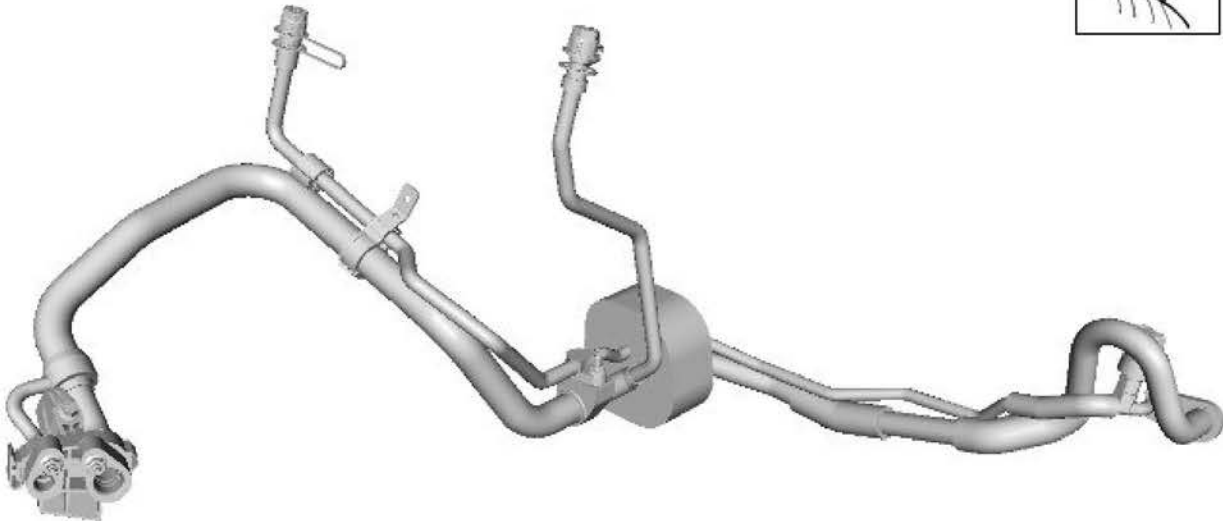

E192164

- Pre 16MY with Non-Internal Heat Exchanger (IHX) Air Conditioning pipes:** - install LR002940.

- Discovery Sport (L550) up to VIN 544576
- Range Rover Evoque (L538) up to VIN 077911

- Post 16MY with Non-Internal Heat Exchanger (IHX) Air Conditioning pipes:** - install LR088548.

- Discovery Sport (L550) from VIN 544577
- Range Rover Evoque (L538) from VIN 077912

- Post 16MY with Non-Internal Heat Exchanger (IHX) Air Conditioning pipes:** - install LR088548.

- Discovery Sport (L550) from VIN 544577
- Range Rover Evoque (L538) from VIN 077912

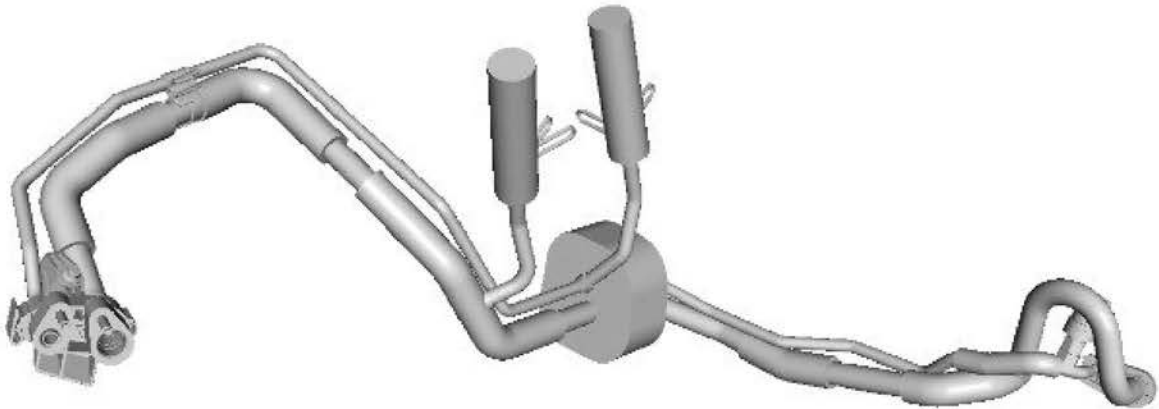
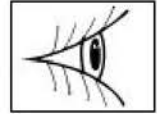

E192165

SERVICE INSTRUCTION:

1. Recover the Air Conditioning system (see TOPIx Workshop Manual section 412-00: General Procedures - Air Conditioning (A/C) System Recovery, Evacuation and Charging GTDi 2.0L Petrol/GTDi 2.0L Petrol - SULEV).
2.  **NOTE: Repeat this step on both Air Conditioning charge port Schrader valves.**
Using a suitable tool, remove and discard the Air Conditioning charge port Schrader valve (turn anticlockwise).



3.  **NOTE: Repeat this step on both Air Conditioning charge port Schrader valves.**

Using a suitable tool, install a new Air Conditioning (A/C) charge port Schrader valves (turn clockwise).

- Torque: 2.4 Nm



4. Charge the Air Conditioning system (see TOPIx Workshop Manual section 412-00: General Procedures - Air Conditioning (A/C) System Recovery, Evacuation and Charging GTDi 2.0L Petrol/GTDi 2.0L Petrol - SULEV).