

TECHNICAL BULLETIN
LTB00997NAS1
20 OCT 2016



© Jaguar Land Rover North America, LLC

NOTE: The information in Technical Bulletins is intended for use by trained, professional Technicians with the knowledge, tools, and equipment required to do the job properly and safely. It informs these Technicians of conditions that may occur on some vehicles, or provides information that could assist in proper vehicle service. The procedures should not be performed by 'do-it-yourselfers'. If you are not a Retailer, do not assume that a condition described affects your vehicle. Contact an authorized Land Rover service facility to determine whether this bulletin applies to a specific vehicle.

SECTION: 501-05

Sill Treadplate Retaining Clip Change

AFFECTED VEHICLE RANGE:

Range Rover Evoque (LV)

Model Year: 2016 Onwards

VIN: 137551 Onwards

Folding Top

Assembly Plant: Halewood

MARKETS:

NAS

CONDITION SUMMARY:

Situation: A sill treadplate may be loose.

Cause: This may be due to sill treadplate clips being single-use only.

Action: Should a customer express this concern, follow the Service Instruction below.

PARTS:



NOTE: The sill treadplate retaining clips should be used only once and not refitted.

LR094454	Clip	8
LR094958	Seal	8

WARRANTY:



NOTE: Repair procedures are under constant review, and therefore times are subject to change; those quoted here must be taken as guidance only. Always refer to TOPIX to obtain the latest repair time.



NOTE: DDW requires the use of causal part numbers. Labor only claims must show the causal part number with a quantity of zero.

DESCRIPTION	SRO	TIME (HOURS)	CONDITION CODE	CAUSAL PART
Fit clips to treadplate	76.49.17	0.1	33	LR077272



NOTE: Normal Warranty procedures apply.

SERVICE INSTRUCTION:



NOTE: The sill treadplate retaining clips should be used only once and not refitted.



1. NOTE: The treadplate may also be referred to as scuff plate trim panel.

Remove the treadplate (see TOPIX Workshop Manual section 501-05: Interior Trim and Ornamentation - Front Scuff Plate Trim Panel).

2. Remove and discard all retaining clips from the treadplate.

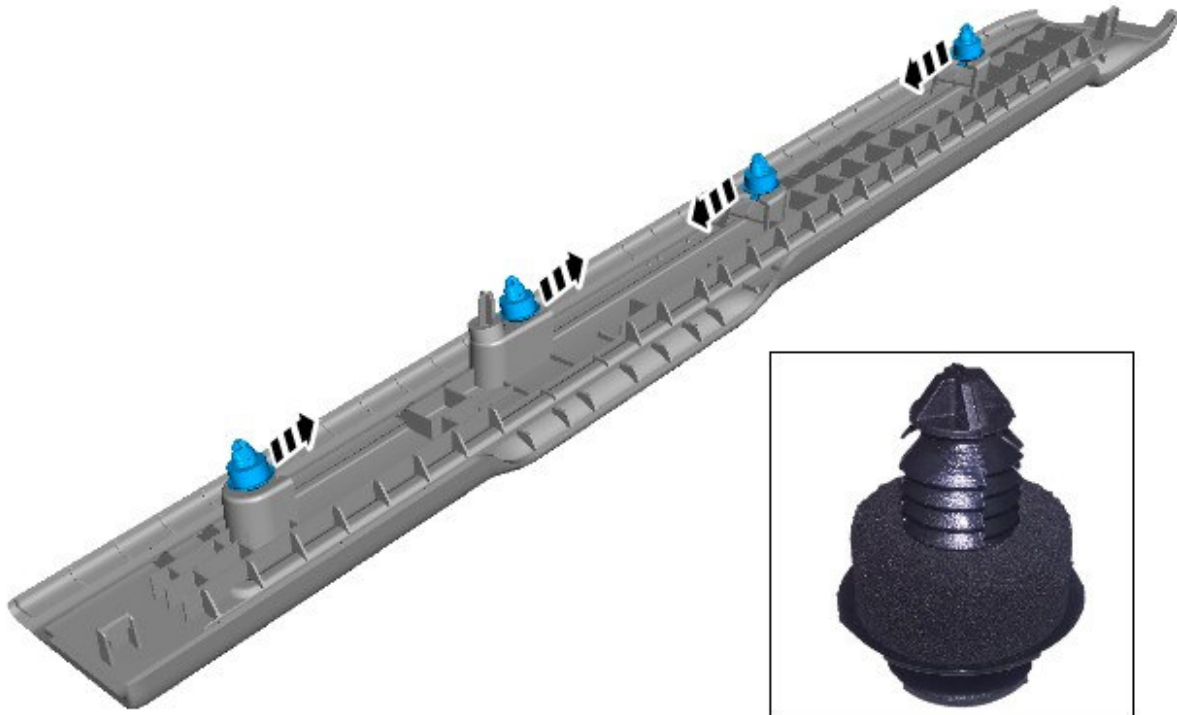

E196647

3. Assemble the new retaining clip and washer together as shown.

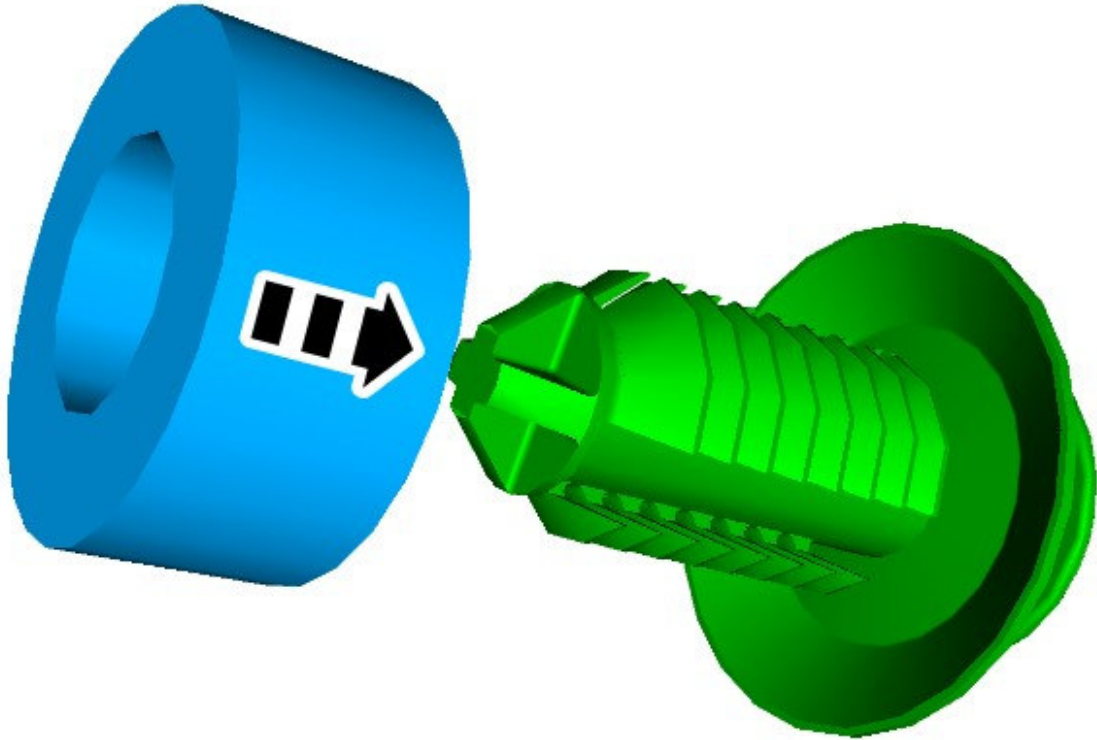

E196790

4. Install the new retaining clips to the treadplate.

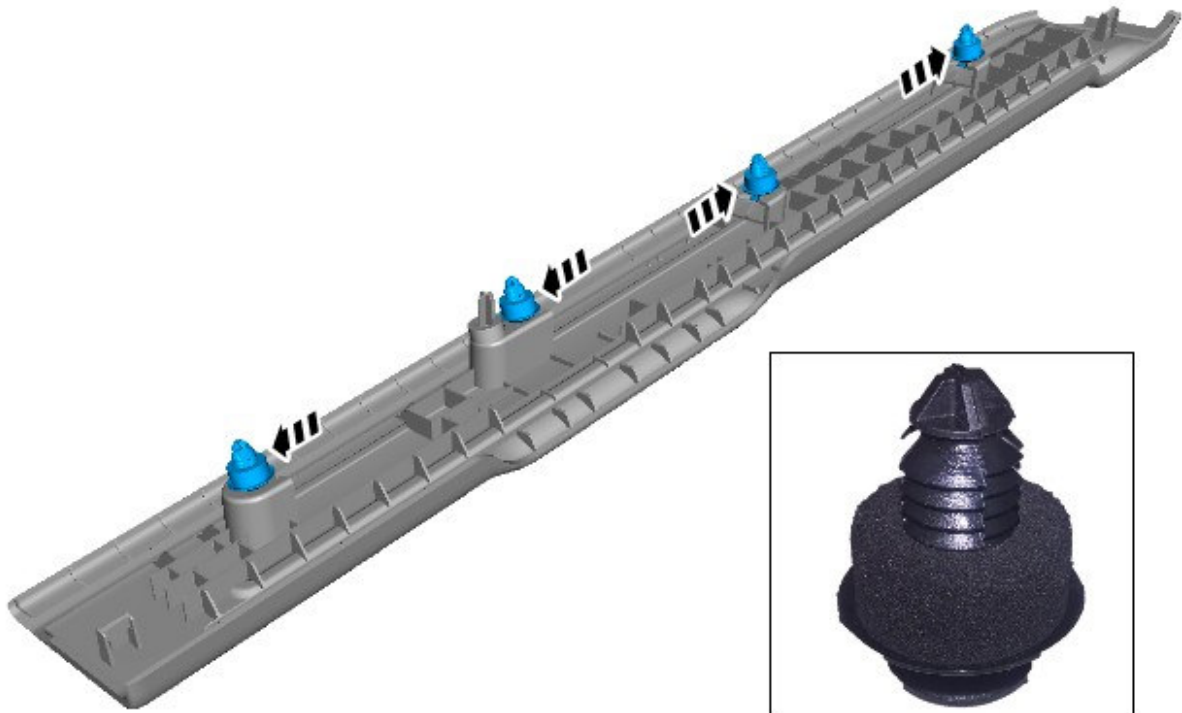

E196646

5. Install the treadplate (see TOPIx Workshop Manual section 501-05: Interior Trim and Ornamentation - Front Scuff Plate Trim Panel).