

TECHNICAL BULLETIN

LTB00861NAS2
10 OCT 2016



© Jaguar Land Rover North America, LLC

NOTE: The information in Technical Bulletins is intended for use by trained, professional Technicians with the knowledge, tools, and equipment required to do the job properly and safely. It informs these Technicians of conditions that may occur on some vehicles, or provides information that could assist in proper vehicle service. The procedures should not be performed by 'do-it-yourselfers'. If you are not a Retailer, do not assume that a condition described affects your vehicle. Contact an authorized Land Rover service facility to determine whether this bulletin applies to a specific vehicle.

This reissue replaces all previous versions. Please destroy all previous versions.

Changes are highlighted in gray

SECTION: 501-08

Roof Moulding Loose / Adrift

AFFECTED VEHICLE RANGE:

Range Rover Sport (LW)

Model Year: 2014 Onwards
VIN: 001154 Onwards
Assembly Plant: Solihull

Range Rover (LG)

Model Year: 2013 Onwards
VIN: 001204 Onwards
Assembly Plant: Solihull

MARKETS:

NAS

CONDITION SUMMARY:

Situation: The roof moulding(s) may be loose / adrift.

Cause: This may be caused by incorrect installation of the roof moulding.

Action: Should a customer express this concern, follow the Service Instruction below.

PARTS:

LR078295	Adhesive kit	1
LR056666	Roof moulding fixing kit - Non-Panoramic Roof - Range Rover Sport (L494)	1
LR075337	Roof moulding fixing kit - Right - No sunroof - Range Rover Sport (L494)	1
LR075339	Roof moulding fixing kit - Left - No sunroof - Range Rover Sport (L494)	1
LR072887	Roof moulding fixing kit - Right - Range Rover Sport (L494)	1
LR072889	Roof moulding fixing kit - Left - Range Rover Sport (L494)	1
LR056667	Roof moulding fixing kit - Panoramic Roof - Range Rover Sport (L494)	1
LR052896	Roof moulding fixing kit - Non-Panoramic Roof - Range Rover (L405)	1
LR072882	Roof moulding fixing kit - Right - Range Rover (L405)	1
LR072883	Roof moulding fixing kit - Left - Range Rover (L405)	1
LR075344	Roof moulding fixing kit - Right - Range Rover (L405)	1
LR075165	Roof moulding fixing kit - Left - Range Rover (L405)	1
LR075166	Roof moulding fixing kit - Long Wheelbase - Right - Range Rover (L405)	1
LR075291	Roof moulding fixing kit - Long Wheelbase - Left - Range Rover (L405)	1
LR052895	Roof moulding fixing kit - Panoramic Roof - Range Rover (L405)	1

WARRANTY:

 **NOTE:** Repair procedures are under constant review, and therefore times are subject to change; those quoted here must be taken as guidance only. Always refer to TOPIx to obtain the latest repair time.

 **NOTE:** DDW requires the use of causal part numbers. Labor only claims must show the causal part number with a quantity of zero.

DESCRIPTION	SRO	TIME (HOURS)	CONDITION CODE	CAUSAL PART
Roof moulding - Left - Repair	76.42.89.32	0.2	07	RZM500041
Roof moulding - Right - Repair	76.42.89.33	0.2	07	RZM500041
Roof moulding - Both sides - Repair	76.42.89.34	0.4	07	RZM500041

 **NOTE:** Normal Warranty procedures apply.

SERVICE INSTRUCTION:

1.  **NOTE:**
Range
Rover
(L405)
non-
panoramic
roof
shown; all
others
similar.

Location of
components.

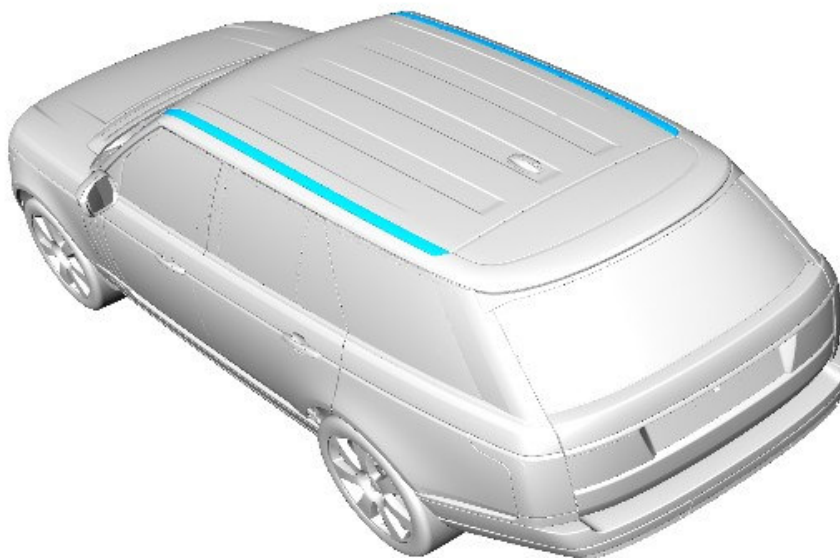

E183616

2.  **NOTE:** If required, repeat this step on both sides of the vehicle.

Remove the roof moulding (see TOPIx Workshop Manual section 501-08: Exterior Trim and Ornamentation - Roof Moulding).

3.  **NOTE:**
Use a
suitable
degreaser
to clean
any
residue
from the
foam pads.

 **NOTE:**
Inspect the
roof
moulding
for
damage.

 **NOTE:**
If required,
repeat this
step on
both sides

of the
vehicle.

Remove and
discard the
foam pads.

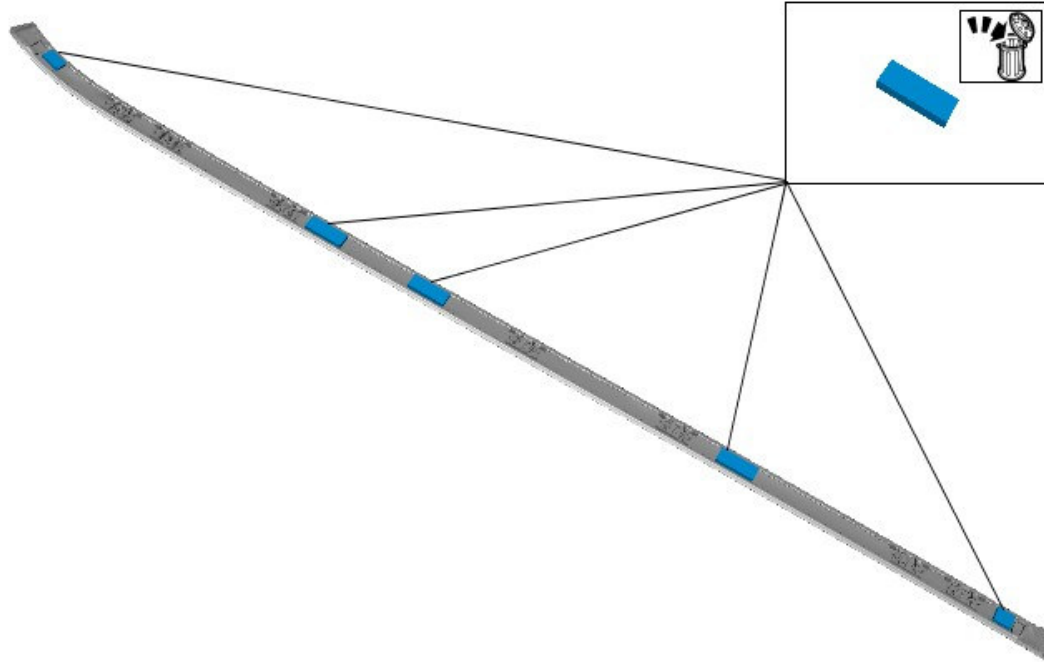

E183735

4.  **NOTE:**
If
required,
repeat this
step on
both sides
of the
vehicle.

Remove the
roof
moulding
adhesive
pad.

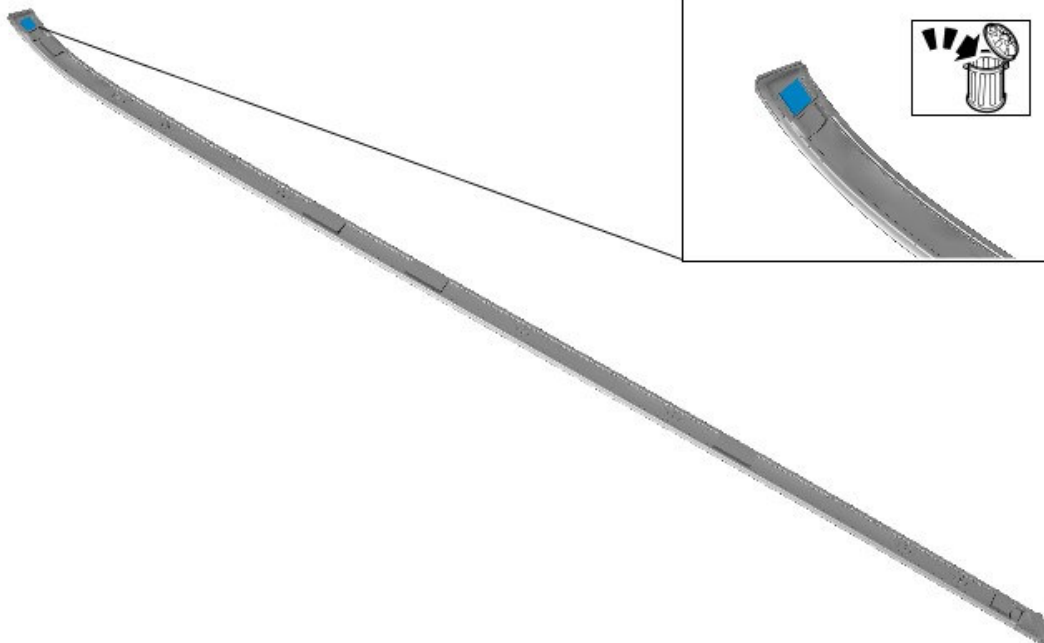

E183737

5.  **CAUTION:**
The roof
moulding
clips are a
one time
installation
only.

 **NOTE:**
If required,

repeat this step on both sides of the vehicle.

Remove the roof moulding clips.

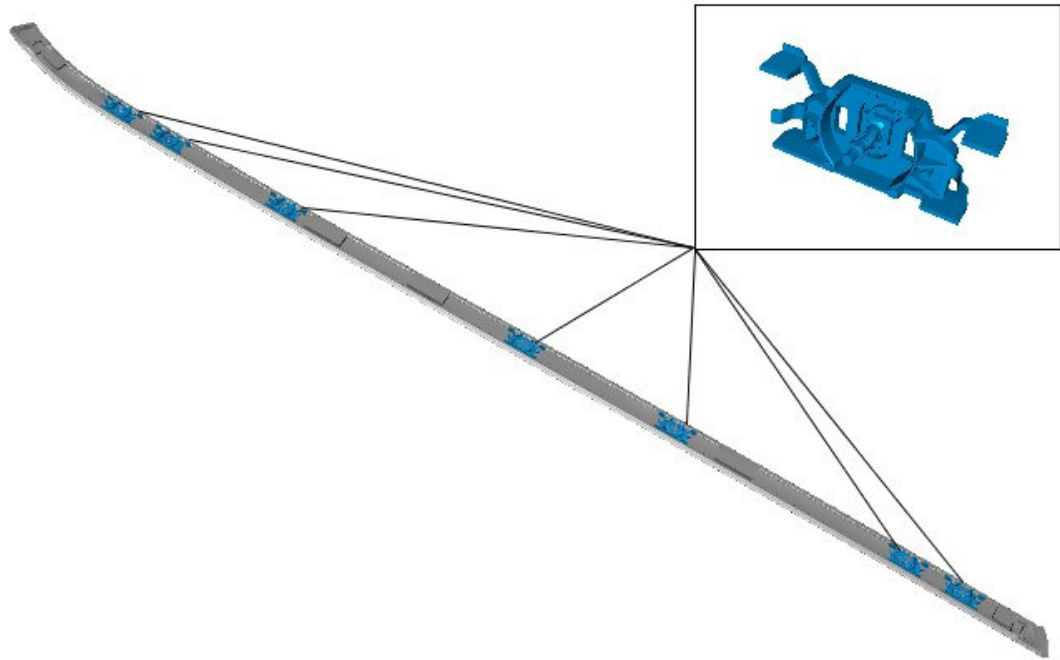

E183736

6.  **NOTE:**
If required, repeat this step on both sides of the vehicle.

 **NOTE:**
Repeat this step on all roof moulding clips.

Remove and discard the original clips from the plastic retaining clips.

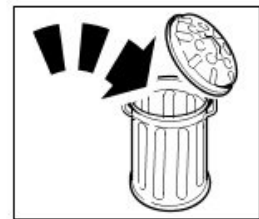
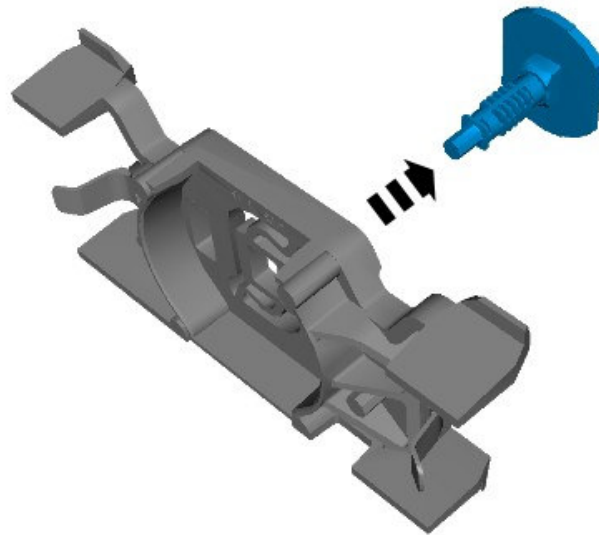

E183739

7.  **NOTE:**
If required, repeat this step on both sides of the vehicle.

 **NOTE:**
Repeat this

**step on all
roof
moulding
clips.**

Install the
new clips
into the
plastic
retaining
clips.

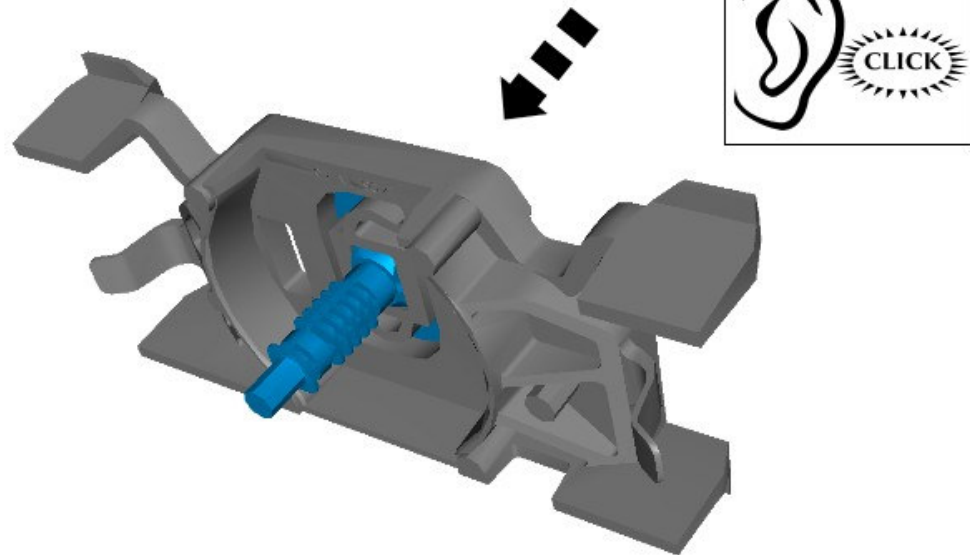

E183740

8.  **NOTE:**
If
required,
repeat this
step on
both sides
of the
vehicle.

Install the
roof
moulding
clips into the
roof
moulding.

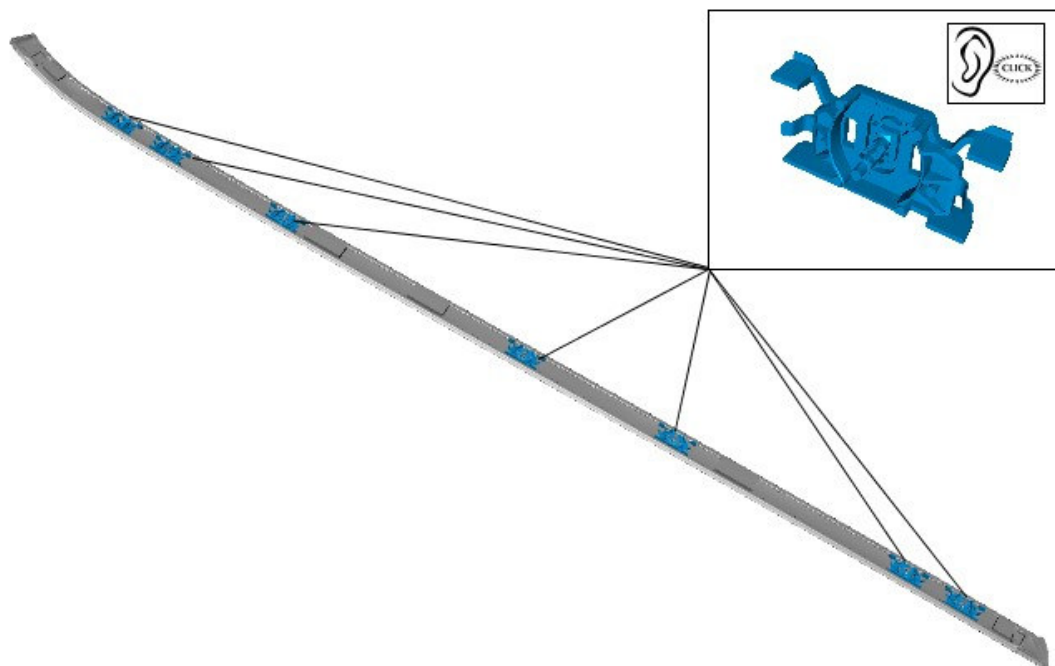

E183738

9.  **NOTE:**
If
required,
repeat this
step on
both sides
of the
vehicle.

Install the
new roof
moulding

foam pads in the same location they were removed from.

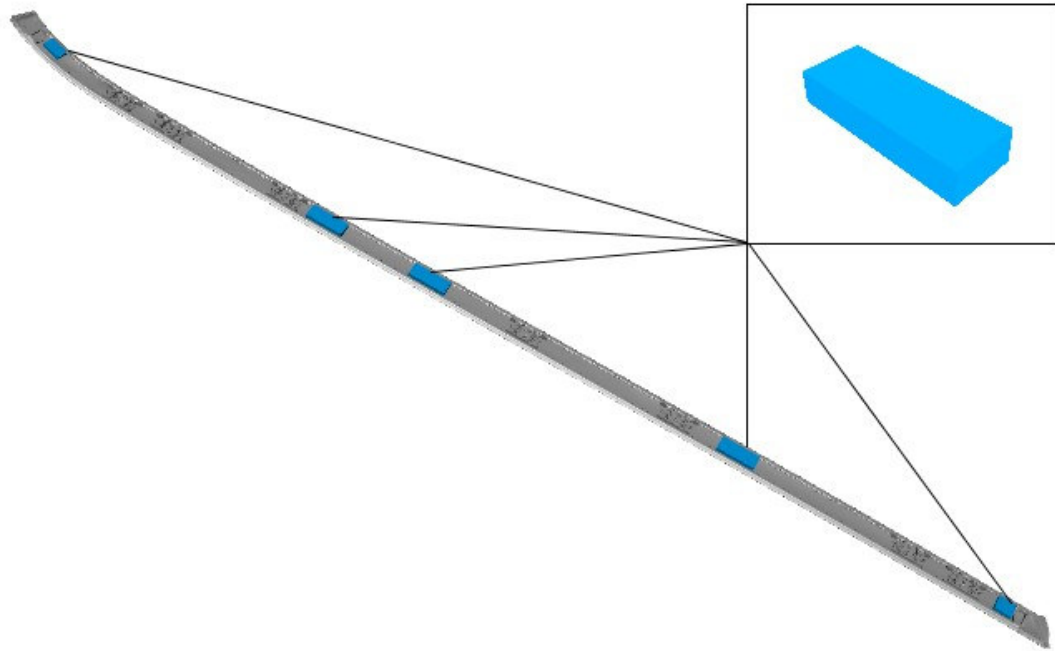

E185099

10. 

NOTE: If required, repeat this step on both sides of the vehicle.

Clean the vehicle with a suitable cleaner in the area shown.

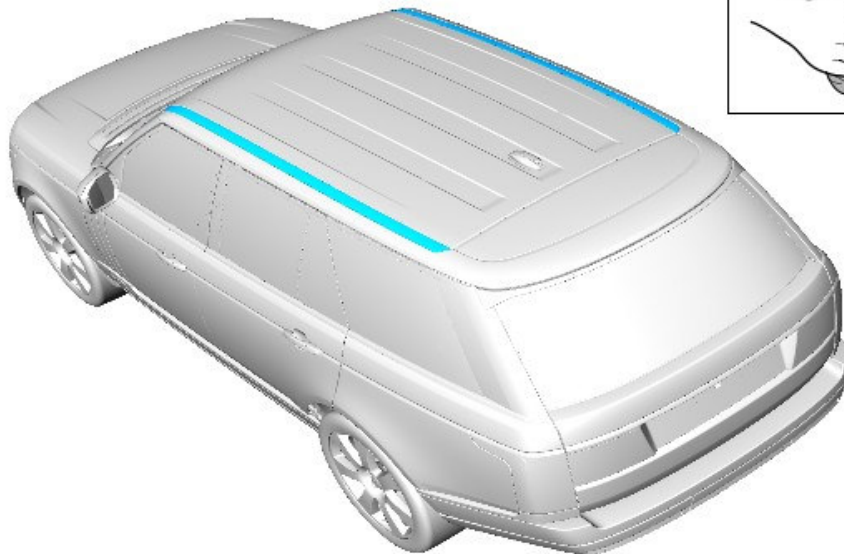

E183621

11. 

NOTE: Repeat this step on both sides of the vehicle.

Apply the sealer in the area shown.

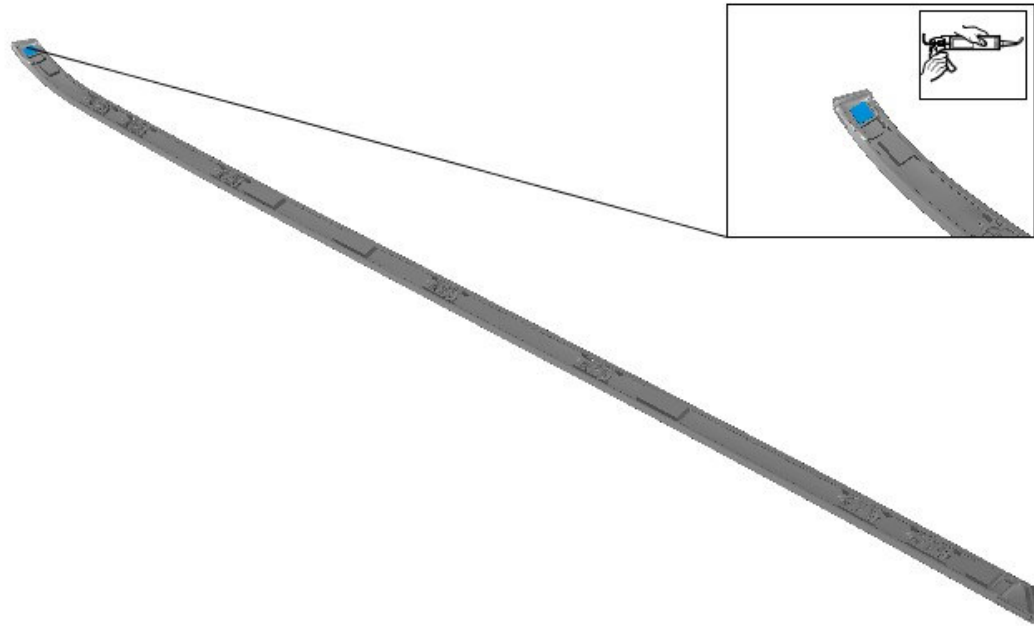

E185128

12. **NOTE: If required, repeat this step on both sides of the vehicle.**

Install the roof moulding (see TOPIX Workshop Manual section 501-08: Exterior Trim and Ornamentation - Roof Moulding).

13. **NOTE: If required, repeat this step on both sides of the vehicle.**

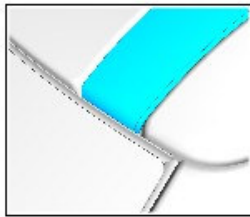

- NOTE:**
The roof moulding must fit under the windshield aperture seal.

- NOTE:**
Remove the securing tape and any residue from the tape with a suitable cleaner when the sealer has fully cured.

E183630

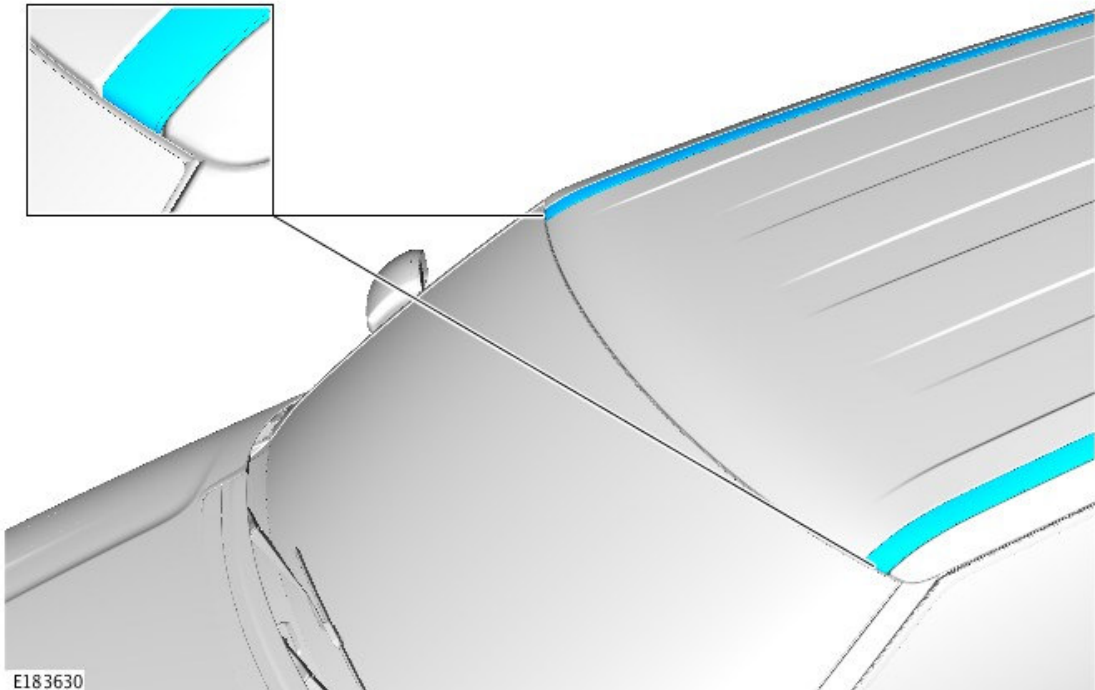

Make sure the roof moulding is correctly installed.

- Use a suitable tape to

hold
down the
roof
moulding
in the
area
shown.