

# ***SERVICE MANUAL BULLETIN***

This Service Manual Bulletin is prepared by the Publications Department of New Flyer Industries Canada ULC. Refer to details below.

## **SMB-163**

**ISSUE DATE: Oct 12 2016**

APPLICABILITY					
VEHICLE LENGTH	<input type="checkbox"/> 30ft.	<input type="checkbox"/> 35ft.	<input type="checkbox"/> 40ft.	<input type="checkbox"/> 60ft.	<input checked="" type="checkbox"/> ALL
VEHICLE TYPE	<input checked="" type="checkbox"/> Xcelsior®	<input type="checkbox"/> MiDi®	<input type="checkbox"/> Invero®	<input type="checkbox"/> ALL	
	<input checked="" type="checkbox"/> Low Floor	<input type="checkbox"/> High Floor			
FUEL TYPE	<input checked="" type="checkbox"/> Diesel	<input checked="" type="checkbox"/> Diesel/Electric	<input type="checkbox"/> CNG	<input type="checkbox"/> LNG	<input type="checkbox"/> ALL
	<input type="checkbox"/> Fuel Cell	<input type="checkbox"/> Trolley/Electric	<input type="checkbox"/> Battery/Electric		
SUBJECT	Exhaust Clamp Replacement				
SECTION TITLE	PM - PREVENTIVE MAINTENANCE				
DETAILS	This bulletin provides information on the procedure to replace the Seal Clamp on the exhaust system of your New Flyer vehicle. The Seal Clamp P/N 089275, located at the SCR to tailpipe connection, must be replaced any time it has been loosened or every four years or 150,000 miles, whichever occurs first.				
	This information supersedes any prior information on this subject already provided in your New Flyer Service Manuals. Make this Service Bulletin available to service personnel to inform them of changed information.				

## 1. Introduction

The seal clamp used at the connection between the Selective Catalytic Reduction Unit (SCR) and tailpipe is designed for one-time use and has a finite life. The seal clamp must be replaced any time that it has been loosened or every four years or 150,000 miles, whichever occurs first.



### WARNING

To avoid personal injury, DO NOT work on a hot exhaust system. Allow sufficient time for the engine and exhaust system to cool before working on the exhaust system.

### 1.1. Replacement



### DANGER

Use work platforms or scaffolding whenever working on the vehicle rooftop. Ensure maintenance personnel use an approved safety harness.

1. Gain access to the rooftop and remove the SCR access panel. See "Fig. 1: SCR Access Panel" on page 2.

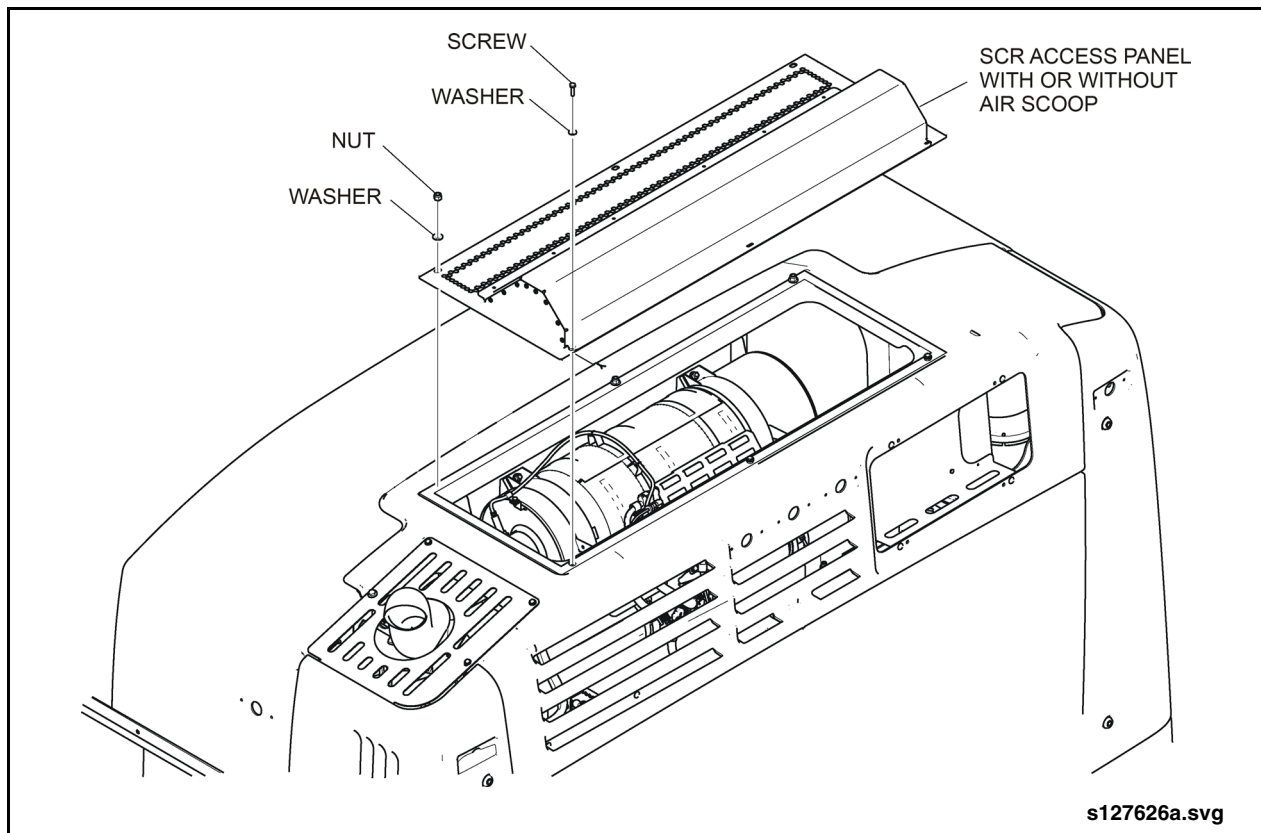

Fig. 1: SCR Access Panel

2. Remove the tailpipe seal clamp and discard the clamp and fasteners. See "Fig. 2: Seal Clamp Replacement" on page 3.
3. Install a new seal clamp as follows:
  - a. Obtain a new seal clamp, New Flyer P/N 08927, complete with new fasteners.
  - b. Lightly grease the contact surface of the clamp and joint area to prevent binding during tightening.
  - c. Position the clamp so as to completely cover the slots on the SCR outlet.
  - d. Insert foil gasket between mating bars.
  - e. Tighten the fasteners alternately and uniformly take up the slack.



**DO NOT overtighten the clamp fasteners, otherwise damage to the clamp or fasteners may occur. Typical installation torque should be approximately 50 ft-lbs. (68 Nm), but not to exceed 75 ft-lbs. (105 Nm).**

- f. Continue to tighten the clamp until the mating bars' surfaces are fully touching and the foil gasket is fully compressed.
- g. Wipe away any excess grease and wipe down area with a degreaser.
4. Check mounting clamps on the SCR device and tailpipe to ensure parts are securely mounted and will not cause loosening of the seal clamp.
5. Reinstall the SCR access panel.

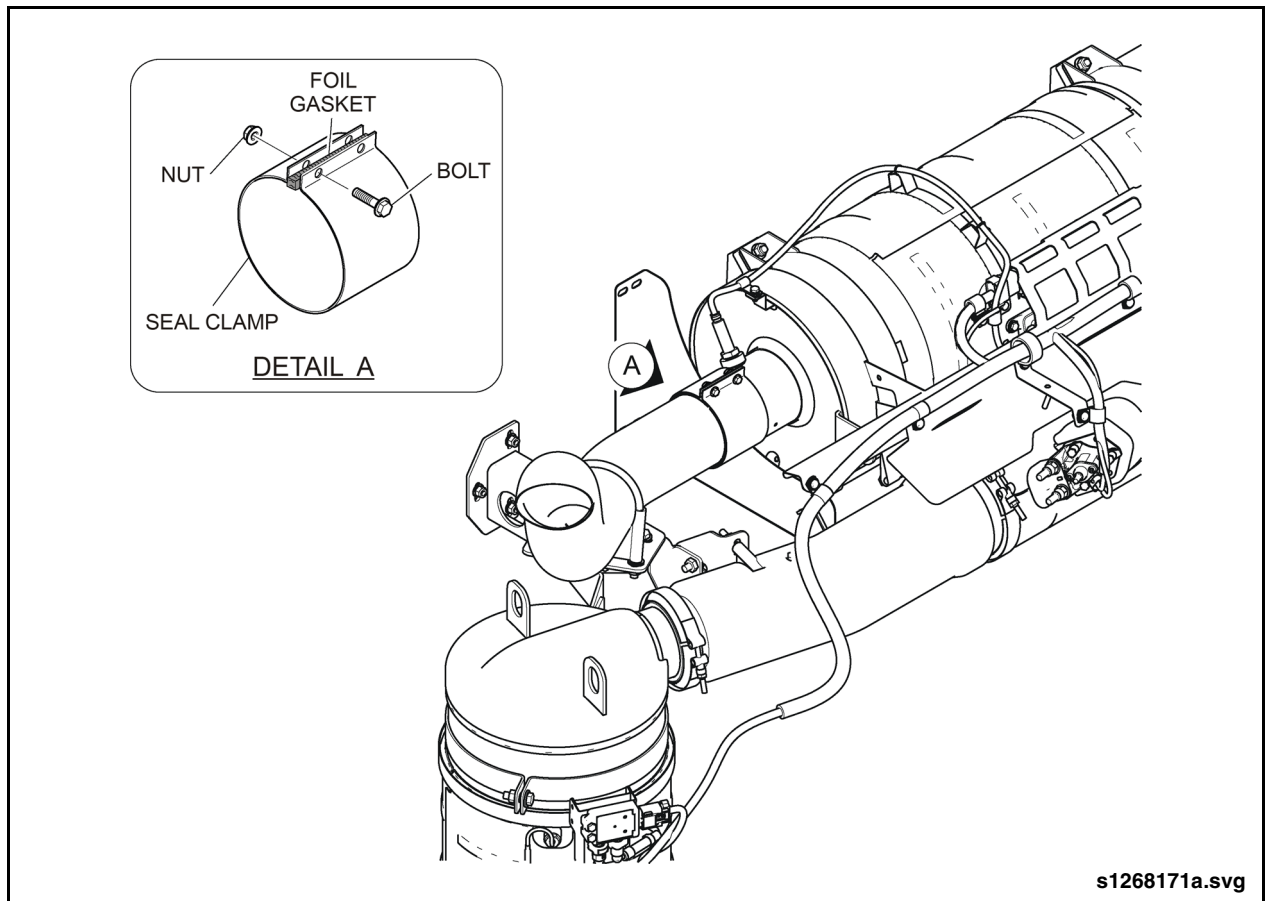

Fig. 2: Seal Clamp Replacement