

Technical Service Bulletin



24 Changeover valve for intake manifold flap N316, DTC P2015

24 16 54 2044003/2 May 24, 2016. Supersedes Technical Service Bulletin Group 24 number 16-53 dated April 19, 2016 for reasons listed below.

Model(s)	Year	VIN Range	Vehicle-Specific Equipment
A3, A4, A5, A5 Cabriolet, TT	2010	All	2.0L engine
A3, A4, A5, A5 Cabriolet, Q5, TT	2011	All	2.0L engine
A3, A4, A5, A5 Cabriolet, A6, A7, Q5, TT	2012 - 2013	All	2.0L engine
A4, A5, A5 Cabriolet, A6, A7, Q5, TT	2014	All	2.0L engine
A4, A5, A5 Cabriolet, A6, A7, Q3, Q5, TT	2015	All	2.0L engine
A4, A5, A5 Cabriolet, Q3, Q5	2016	All	2.0L engine

Condition

REVISION HISTORY		
Revision	Date	Purpose
2	-	Revised <i>Warranty</i> (Changed Damage Code; updated time for Q3 and TT)
1	4/19/2016	Initial publication

- Engine warning lamp on.
- **DTC P201500** (Intake manifold runner position sensor/switch circuit range/performance) is stored in the engine control module (ECM), J623 (address word 01).

Technical Background

Corrosion in valve for intake manifold flap N316.

Production Solution

Not applicable.

Service

1. Check the intake manifold flap valve N316 with Guided Fault Finding.
2. If the intake manifold flap valve N316 is faulty, replace it with part number **06H 906 283 B**. This new valve has an additional connection for the fresh air line (Figure 1).

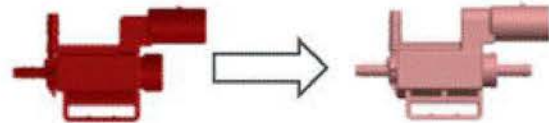

Figure 1. New valve with part number 06H 906 283 B (right) has an additional connection for the fresh air line.

3. Install fresh air line with part number **06H 133 583 F** by first routing it along the cylinder head cover, then securing it with the included clips on the high pressure fuel line and activated charcoal filter cable (Figure 2).
 - **On in-line engines:** Loosen the securing bolt for engine wiring between the second and third cylinder and secure the fresh air line with this bolt (Figure 3).
 - **On transverse engines:** The M6 x 14 bolt with part number **N 107 732 01** (thread-cutting) must be used in addition. Tighten the bolt with 9 Nm +/- 1 Nm.

When routing the clean air line to the intake manifold flap valve, ensure that the clean air line is routed between the cylinder head cover and the vacuum unit lever for the intake manifold flap (Figure 4).

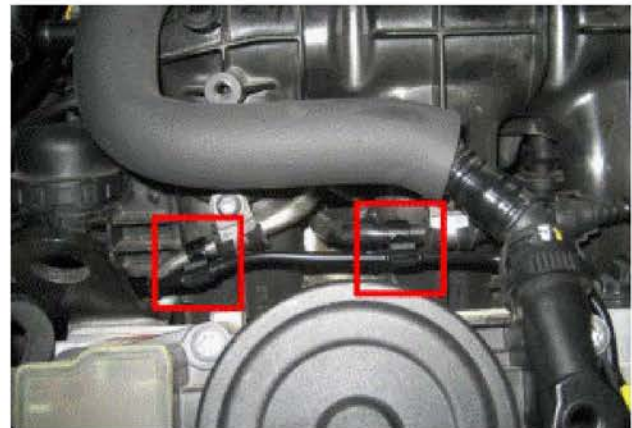

Figure 2. Routing of fresh air line.



Figure 3. Securing bolt for engine wiring in in-line engine.

Technical Service Bulletin



Figure 4. Routing of clean air line to intake manifold flap valve.

Warranty

Claim Type:	Use applicable claim type. If vehicle is outside any warranty, this Technical Service Bulletin is informational only.		
Service Number:	2466		
Damage Code:	0028		
Labor Operations:	For all vehicles <u>except</u> A3, Q3, and TT:		
	Remove and install intake manifold flap valve	2466 1913	30 TU
	Install clean air line for solenoid valve	2466 2399	20 TU
	Charge battery	2706 8950	10 TU
	For Q3 and TT only:		
	Remove and install intake manifold flap valve	2466 1913	40 TU
	Install clean air line for solenoid valve	2466 2399	20 TU
	Charge battery	2706 8950	10 TU
	For A3 only:		
	Remove and install intake manifold flap valve	2466 1937	30 TU
	Install clean air line for solenoid valve	2466 2399	20 TU
	Charge battery	2706 8950	10 TU

Technical Service Bulletin



Diagnostic Time:	Guided Fault Finding/Guided Function	0150 0000	Time stated on diagnostic protocol (Max 30 TU)
	Road test prior to service procedure	No allowance	0 TU
	Road test after service procedure	No allowance	0 TU
	Technical diagnosis at dealer's discretion (Refer to Section 2.2.1.2 and Audi Warranty Online for DADP allowance details)		
Claim Comment:	As per TSB #2043894/2		

All warranty claims submitted for payment must be in accordance with the *Audi Warranty Policies and Procedures Manual*. Claims are subject to review or audit by Audi Warranty.

Required Parts and Tools

Part Number	Part Description	Quantity
06H906283B	Solenoid valve	1
06H133583F	Connecting hose	1
N 10773201	M6 x 14 bolt (transverse engine only)	1

Additional Information

All parts and service references provided in this TSB (2043894) are subject to change and/or removal. Always check with your Parts Department and service manuals for the latest information.