

© 2016 Mazda Motor of America, Inc.

Subject: DIFFICULT TO ANCHOR CHILD SEAT ON THE REAR SEAT	Bulletin No: 09-042/16
	Last Issued: 7/1/2016

APPLICABLE MODEL(S)/VINS



2016 CX-3 vehicles with VINs lower than JM1 DK ***** 134520 (produced before February 01, 2016)

DESCRIPTION

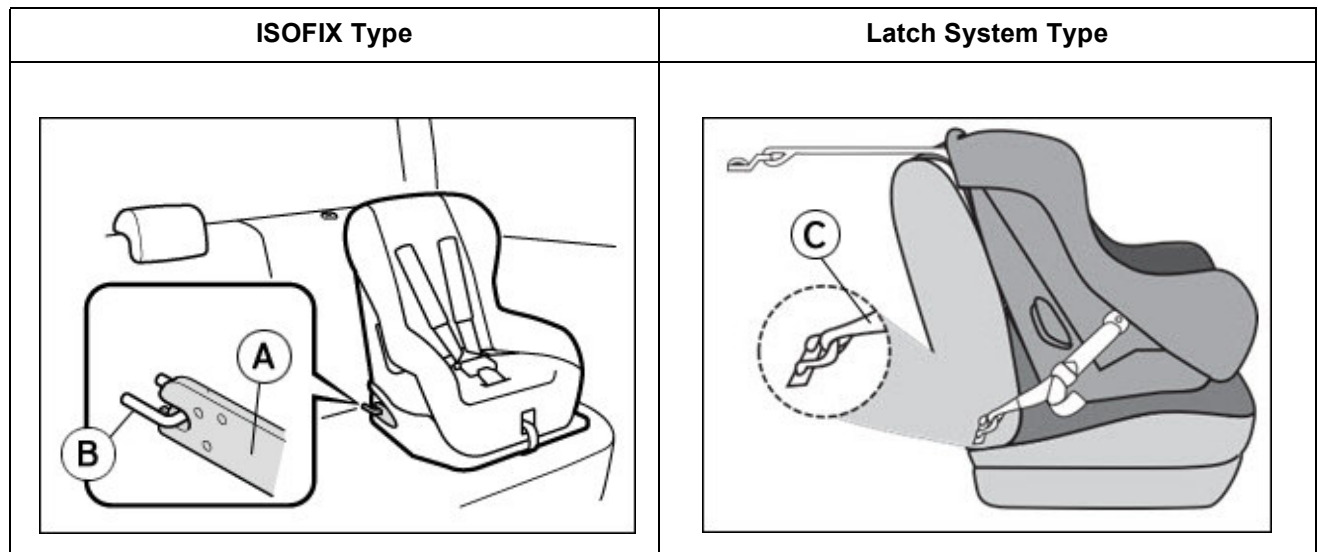
Some customers may complain that it is difficult to locate the anchors to install an ISOFIX type or Latch System type child seat on the rear seat. The ISOFIX connector(s) (A) or Latch System tether strap (C) of the child seat does/do not catch the anchor(s) (B) in the vehicle. The anchor(s) is/are obstructed by the rear seat cushion. The rear edge trimming material (D) of the rear seat cushion is positioned incorrectly obstructing the anchor(s).

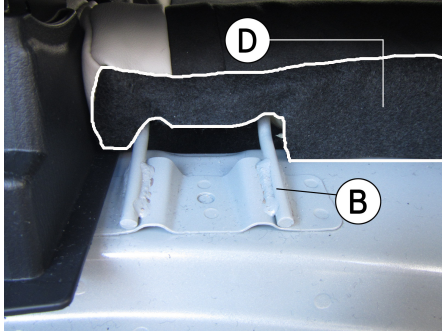

CONSUMER NOTICE: The information and instructions in this bulletin are intended for use by skilled technicians. Mazda technicians utilize the proper tools/equipment and take training to correctly and safely maintain Mazda vehicles. These instructions should not be performed by "do-it-yourselfers." Customers should not assume this bulletin applies to their vehicle or that their vehicle will develop the described concern. To determine if the information applies, customers should contact their nearest authorized Mazda dealership. Mazda North American Operations reserves the right to alter the specifications and contents of this bulletin without obligation or advance notice. All rights reserved. No part of this bulletin may be reproduced in any form or by any means, electronic or mechanical---including photocopying and recording and the use of any kind of information storage and retrieval system ---without permission in writing.

NG		Good	
Rear edge trimming material (D) is positioned <u>under</u> Anchor (B).		Rear edge trimming material (D) is positioned <u>on top of</u> Anchor (B).	
Front 			

NOTE: Seat Belt “Automatic Locking Mode” may be used to secure the child seat to the rear seat prior to vehicle repair. Refer to Owner’s Manual “Essential Safety Equipment” > “Child Restraint” > “Installing Child-Restraint Systems” > “Using Automatic Locking Mode” for instructions.



Customers having this concern should have their vehicle repaired using the following repair procedure.

REPAIR PROCEDURE

1. Verify customer concern.
2. To access the four anchors (B) and the rear edge trimming material of the rear seat cushion, remove the trunk box. Refer to MS3 online or Workshop Manual (section 09-17 TRUNK BOARD REMOVAL/INSTALLATION). Then fold rear seatbacks forward.

After removing Trunk Box

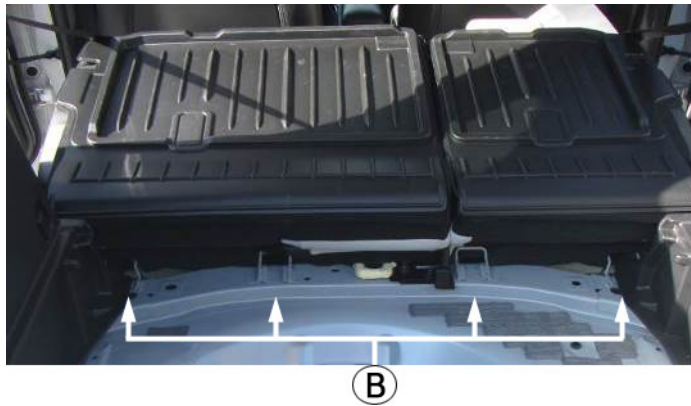

3. Adjust the position of the rear edge trimming material so that it is located on top of each of the four anchors.



4. Open the slot (E) (4 positions) in the rear seat cushion (F). Verify that all the four anchors (B) are directly visible and not being obstructed by anything.

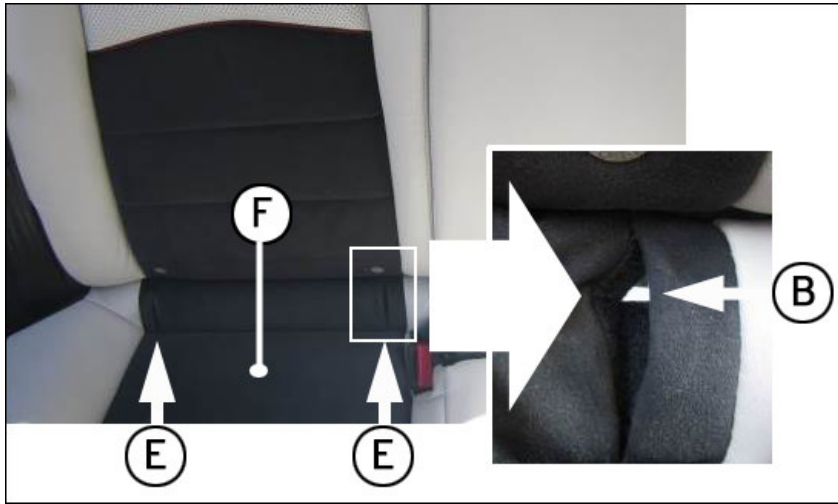

5. Install the removed parts in the reverse order of removal.

WARRANTY INFORMATION

NOTE:

- This warranty information applies only to verified customer complaints on vehicles eligible for warranty repair.
- This repair will be covered under Mazda's New Vehicle Limited Warranty term.
- Additional diagnostic time cannot be claimed for this repair.

Warranty Type	A
Symptom Code	43
Damage Code	9G
Part Number Main Cause	**** 57 200* (Use GEPC and VIN to look up applicable part number of the rear seat cushion)
Quantity	0
Operation Number / Labor Hours:	XXM31ARX / 0.2 Hrs.