

April 29, 2016

03346 Version 2

Product Update: 2006 Ridgeline Inner Door Handle Cable End Clip**(Supersedes 06-012, dated March 21, 2006; See REVISION SUMMARY)****AFFECTED VEHICLES**

Year	Model	Trim	VIN Range
2006	Ridgeline	ALL	Check the iN VIN status for eligibility

REVISION SUMMARY

Under PARTS INFORMATION AND REPAIR PROCEDURE, the clip has been replaced by the inner handle assembly because the clip is no longer available.

BACKGROUND

Because of a weak clip, the inner door handle cable can disconnect from the door handle. If this happens, the door cannot be opened from the inside.

NOTE: There is a clip available for 2007–14 Ridgeline vehicles. The hole in the original 2006 Ridgeline handle is too large and the 2007–14 model year service clip will come out if you try to use it for this campaign.

CUSTOMER NOTIFICATION

All owners of affected vehicles were mailed a notification of this campaign. A copy of the customer notification is at the end of this service bulletin.

Do an iN VIN status inquiry to make sure the vehicle is shown as eligible.

Some vehicles affected by this campaign may be in your used vehicle inventory. These vehicles should be repaired before they are sold.

CORRECTIVE ACTION

Replace the inner door handle on all four doors.

PARTS INFORMATION

Part Name	Part Number	Quantity
Front Left (Driver's Side) Inner Door Handle: Warm Gray (NH574L) (use with interior type A) Dark Gray (NH607L) (use with interior type C)	72160-SJC-A02ZA 72160-SJC-A02ZB	1
Front Right (Passenger's Side) Inner Door Handle: Warm Gray (NH574L) (use with interior type A) Dark Gray (NH607L) (use with interior type C)	72120-SJC-A02ZA 72120-SJC-A02ZB	1
Rear Left (Driver's Side) Inner Door Handle: Warm Gray (NH574L) (use with interior type A) Dark Gray (NH607L) (use with interior type C)	72660-SJC-A02ZA 72660-SJC-A02ZB	1
Rear Right (Passenger's side) Inner Door Handle Warm Gray (NH574L) (use with interior type A) Dark Gray (NH607L) (use with interior type C)	72620-SJC-A02ZA 72620-SJC-A02ZB	1

CUSTOMER INFORMATION: The information in this bulletin is intended for use only by skilled technicians who have the proper tools, equipment, and training to correctly and safely maintain your vehicle. These procedures should not be attempted by "do-it-yourselfers," and you should not assume this bulletin applies to your vehicle, or that your vehicle has the condition described. To determine whether this information applies, contact an authorized Honda automobile dealer.

WARRANTY CLAIM INFORMATION

Operation Number	Description	Flat Rate Time	Template ID	Defect Code	Symptom Code	Failed Part Number
817106	Replace the inner door handle on all 4 doors (Warm gray/interior type A).	0.5 hr	06-012B	5DU00	Q0200	72149-SLA-003

Operation Number	Description	Flat Rate Time	Template ID	Defect Code	Symptom Code	Failed Part Number
817106	Replace the inner door handle on all 4 doors. (Dark gray/interior type C).	0.5 hr	06-012C	5DU00	Q0200	72149-SLA-003

Skill Level: Repair Technician

REPAIR PROCEDURE

1. Remove the inner door handle. Refer to the service information.
2. Remove the cable bracket screw and detach the inner handle cable from the inner handle (right rear inner handle is shown).

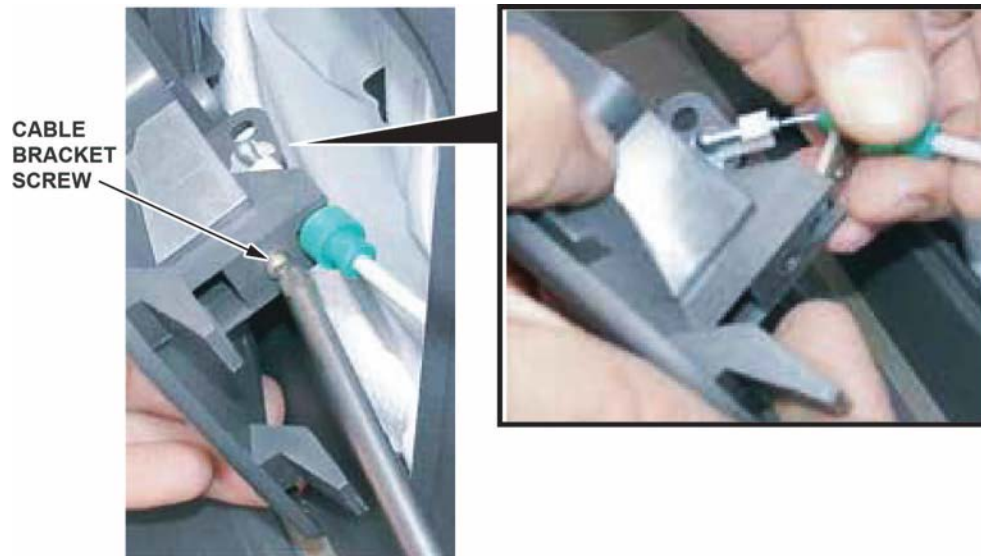

3. Separate the cable end from the clip (snap).

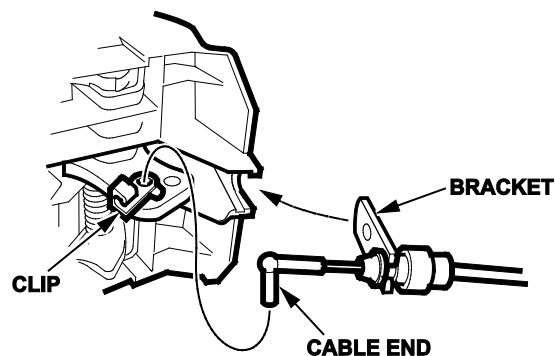

4. Install the cable end into the new handle and secure the clip to the cable end.
5. Reinstall all parts in reverse order of removal.
6. Repeat steps 1 through 5 for the remaining three doors.

END

Example of customer letter

Spring 2006

Product Update: 2006 Ridgeline Inner Door Handle Cable End Clip

Dear Ridgeline Owner:

This notice has been sent to inform you of a potential problem with your vehicle and what you should do to resolve it.

What is the problem?

The inner door handle cable can become disconnected from the door handle because of a weak clip. If this happens, you will not be able to open the door from the inside.

What should you do?

Call any authorized Honda dealer, and make an appointment to have your vehicle updated. The dealer will replace the clips. This work will be done free of charge. Please plan to leave your vehicle at the dealer for half a day to allow them flexibility in scheduling.

What to do if you feel this notice is in error.

Our records show that you are the current owner or lessee of a 2006 Ridgeline involved in this product update. If this is not the case, or the name/address information is incorrect, please fill out and return the included, postage-paid Information Change Card. We will then update our records.

If you have questions.

If you have questions about this notice, or need assistance with contacting a Honda dealer, please call Automobile Customer Service at (800) 999-1009.

We apologize for any inconvenience this product update may cause you.

Sincerely,

**American Honda Motor Co., Inc.
Honda Automobile Division**