

AF03 - Replacing Fuel Rails (Recall Campaign)

Revision: **July 26, 2016**
 This revision amends AF03 as follows:
 Under "Invoicing" time units were increased to 461 TU.

Model Year: **As of 2011 up to 2012**

Vehicle Type: **Cayenne S Hybrid (92A)**

Equipment: 3.0-liter V6 engine (engine types M06EC/CGEA/CGFA/CJT)

Concerns: **Fuel rails**

Information: **There is a possibility that a leak can occur at the fuel rails in the fuel injection system on the affected vehicles.**
 As a result, a small amount of fuel can leak out. The customer may get a smell of fuel in these rare cases.

Action Required: Replace both fuel rails and replace the support piece and the support ring and sealing ring on the fuel injectors. Also replace the coolant regulator.

Affected Vehicles: The VIN(s) can be checked by using PIWIS Vehicle Information link to verify if the campaign affects the vehicle. This campaign is scope specific to the VIN! Failure to verify in PIWIS may result in an improper repair. This campaign affects 1,166 vehicles in North America.

Parts Info: **NOTE: PARTS FOR THIS RECALL WILL BE AUTOMATICALLY ALLOCATED FOR UP TO 50% OF THE VEHICLES THAT ARE SERVICED AT YOUR DEALERSHIP. ONCE YOUR DEALERSHIP IS OUT OF STOCK AND REQUIRES ADDITIONAL PARTS, YOU SHOULD SUBMIT A PTEC/PAV.**

Part No.	Designation - Use	Qty.
000.043.303.51	⇒ Fuel rail set comprising: - Fuel rail, left (1 ea.) - Fuel rail, right (1 ea.)	1 ea.
000.043.303.49	⇒ Gasket set - Fuel injector	6 ea.

000.043.303.50	⇒ Support piece – Fuel injector	6 ea.
000.043.303.57	⇒ Union fitting (adapter) – Fuel rail	2 ea.
000.043.303.52	⇒ Breather pipe – Crankcase to compressor	1 ea.
000.043.303.56	⇒ Seal – Intake manifold, top	6 ea.
000.043.303.58	⇒ Seal – Intake manifold, bottom	6 ea.
000.043.303.59	⇒ Thermostat housing with coolant regulator	1 ea.
000.043.303.53	⇒ Seal – Coolant pipe, center	1 ea.
000.043.303.54	⇒ Seal – Coolant pipe, left and right	2 ea.

Materials: 000.043.301.48 ⇒ Antifreeze (20-liter container) approx. 1.5 liters required

Tools:

- **T10060 A - Staking mandrel**
- Spring band clamp pliers, e.g. **VAS 6890 - Spring band clamp pliers**
- Hose clamps, up to 25 mm, e.g. **3094 - Hose clamp** (2 ea.)
- Hand vacuum pump **VAS 6213 - Hand vacuum pump VAS 6213**
- Filling Device **9696 - Filling device**
- Torque wrench, 6 - 50 Nm (4.5 - 37 ftlb.), e.g. **V.A.G 1331 - Torque wrench, 6-50 Nm (4.5-37 ftlb.)**
- Torque wrench, 2 - 10 Nm (1.5 - 7.5 ftlb.), e.g. **V.A.G 1783 - Torque wrench, 2-10 Nm (1.5-7.5 ftlb.)**
- Open-end insert, a/f 17 for torque wrench
- Open-end insert, a/f 19 for torque wrench
- Open-end insert, a/f 27 for torque wrench
- Drip tray

Work Procedure: See Attachment "A".

Claim Submission: See Attachment "B".

Attachment "A": **Work Procedure**

- 1 Remove engine guard ⇒ *Workshop Manual '108019 Removing and installing engine guard'*.
- 2 Drain coolant ⇒ *Workshop Manual '193817 Draining and filling coolant (includes bleeding)'*.
- 3 Remove engine cover.
- 4 Remove poly-V-belt for compressor ⇒ *Workshop Manual '137819 Removing and installing drive belt'*.
- 5 Remove compressor ⇒ *Workshop Manual '211419 Removing and installing compressor'*.
- 6 Remove front coolant pipe ⇒ *Front coolant pipe*.

- Blue** – Front coolant pipe
- 1** – Hose clamp
- 2** – Electric plug connection on coolant temperature sensor
- 3** – Screw securing coolant pipe to thermostat housing
- arrows** – Fastening screws for coolant pipe

The procedure for removing the front coolant pipe is described in ⇒ *Workshop Manual '196120 Removing and installing coolant pipes'*.

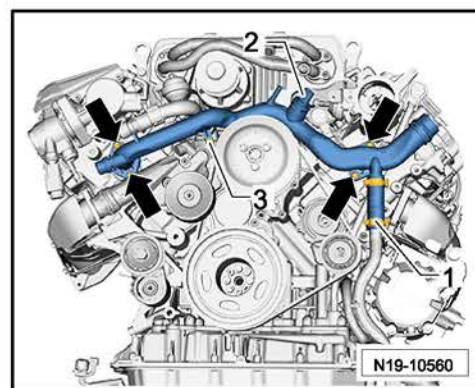

Front coolant pipe



Information

Only the sections "Removing front left coolant pipes" and "Removing front coolant pipe" in the Workshop Manual specified above are relevant for removing the front coolant pipe.

The front left coolant pipes must not be removed completely, but should only be loosened as far as required to allow access for removing and installing the front coolant pipe.

- 7 Replace coolant regulator ⇒ *Removing and installing coolant regulator*.
For instructions, see ⇒ *Workshop Manual '195819 Removing and installing coolant regulator (thermostat)'*.



Removing and installing coolant regulator

8 Install front coolant pipe ⇒ *Workshop Manual '196120 Removing and installing coolant pipes'*.

9 Remove lower part of intake manifold for cylinders 1-3 and 4-6 together with the fuel rail.

For instructions, see ⇒ *Workshop Manual '244719 Removing and installing intake manifold'*, **as well as** the next step:

- Before loosening the fastening screws and nuts on lower part of intake manifold for cylinders 4-6, loosen the fuel pressure sensor at the fuel rail.



Information

The vacuum actuators for intake manifold flap control remain on the lower parts of the intake manifold. The description for replacing the vacuum actuators, which is also included in the Workshop Manual, is not relevant in this case.

10 **Replace both fuel rails.**



Information

The steps described below - unless explicitly described for one specific lower part of intake manifold - must be carried out on lower part of intake manifold for cylinders 1-3 **and** on lower part of intake manifold for cylinders 4-6.

- 10.1 Unscrew fastening screw ⇒ *Assembly overview - lower part of intake manifold -12-* on retaining bar for the fuel rail ⇒ *Assembly overview - lower part of intake manifold -13-* and remove retaining bar from lower part of intake manifold ⇒ *Assembly overview - lower part of intake manifold -17-*.
- 10.2 Remove fuel rail ⇒ *Assembly overview - lower part of intake manifold -15-* from lower part of intake manifold.
- 10.3 Screw new union fittings, Part No. 000.043.303.57 ⇒ *Assembly overview - lower part of intake manifold -14-*, hand-tight into the new fuel rails from the parts kit 000.043.303.51.
Check that the union fittings are fitted at the correct position. Do not tighten union fittings until lower part of intake manifold has been installed.
- 10.4 Screw in fuel pressure sensor ⇒ *Assembly overview - lower part of intake manifold -5-* on the new fuel rail for cylinders 4-6 hand-tight.
Do not tighten fuel pressure sensor until lower part of intake manifold has been installed.
- 10.5 Position new fuel rails on the relevant lower part of intake manifold.
- 10.6 Fit retaining bar for fuel rail ⇒ *Assembly overview - lower part of intake manifold -13-* on lower part of intake manifold and only screw in the fastening screw ⇒ *Assembly overview - lower part of intake manifold -12-* as far as required so that the fuel rail can still be moved.

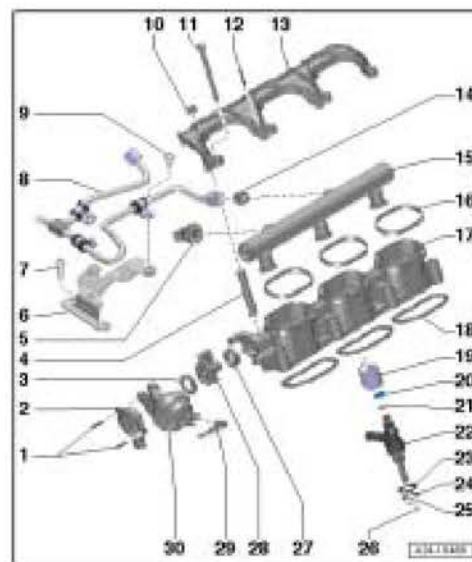

Assembly overview - lower part of intake manifold

11 **Replace support piece as well as the support ring and sealing ring on all six fuel injectors** ⇒ *Overview of fuel injector.*

- 1 – Fuel injector (**remains in the cylinder head**)
- 2 – Support ring (**replace**, contained in gasket set 000.043.303.49)
- 3 – Sealing ring (**replace**, contained in gasket set 000.043.303.49)
- 4 – Support piece (**replace**, Part No. 000.043.303.50)
- 5 – Sealing ring (replace only if the fuel injector was pulled out of the cylinder head; contained in gasket set 000.043.303.49)

The support piece ⇒ *Overview of fuel injector -4-* as well as the support ring and sealing ring ⇒ *Overview of fuel injector -2 and 3-* can be replaced when the fuel injector is installed. There is no need to remove the fuel injectors ⇒ *Overview of fuel injector -1-* to do this. The support piece can be pulled up off the installed fuel injector.

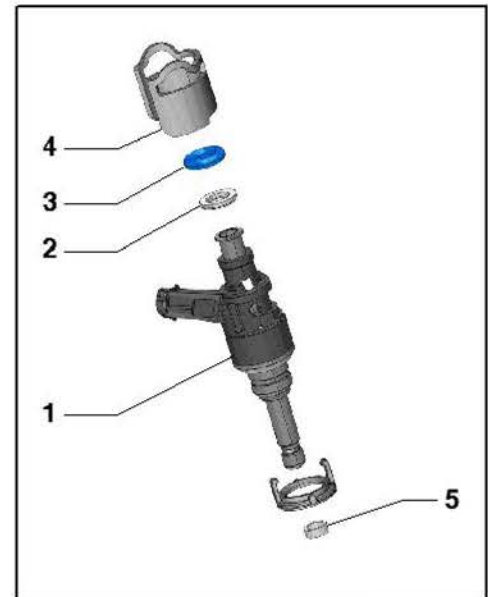

Overview of fuel injector

12 Coat the pockets ⇒ *Fuel rails -arrows-* on the new fuel rails ⇒ *Fuel rails -1-* with clean engine oil before installing lower parts of intake manifold.

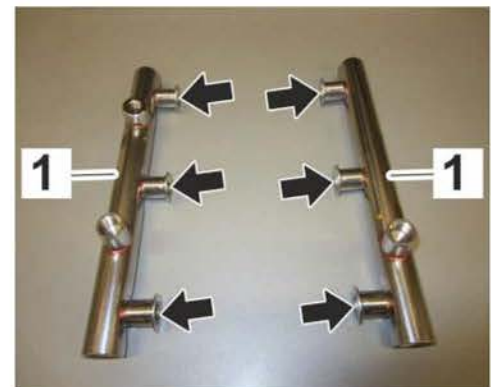

Fuel rails

- 13 Install lower part of intake manifold for cylinders 1-3 and 4-6 together with the new fuel rail.
For instructions, see ⇒ *Workshop Manual '244719 Removing and installing intake manifold'* and **also** pay particular attention to the following points:

- **After** fitting the fuel rails on the fuel injectors but **before** securing lower part of intake manifold, tighten the fastening screw ⇒ *Assembly overview - lower part of intake manifold -12-* on the retaining bar for the fuel rails for cylinders 1-3 and 4-6 to prevent strain on the components. **Tightening torque 2.5 Nm (2 ftlb.)**
- Before re-fitting the fuel high-pressure lines ⇒ *Assembly overview - lower part of intake manifold -8-*, tighten the union fittings ⇒ *Assembly overview - lower part of intake manifold -14-* on the fuel rails using a suitable open-end insert (a/f 19) for torque wrench. **Tightening torque 40 Nm (30ftlb.)**
- Tighten fuel pressure sensor ⇒ *Assembly overview - lower part of intake manifold -5-* at the fuel rail for cylinders 4-6 using a suitable open-end insert (a/f 27) for torque wrench. **Tightening torque 22 Nm (16 ftlb.)**
- For other tightening torques, see ⇒ *Workshop Manual '1001IN Tightening torques, tightening sequences, assembly overviews'*.

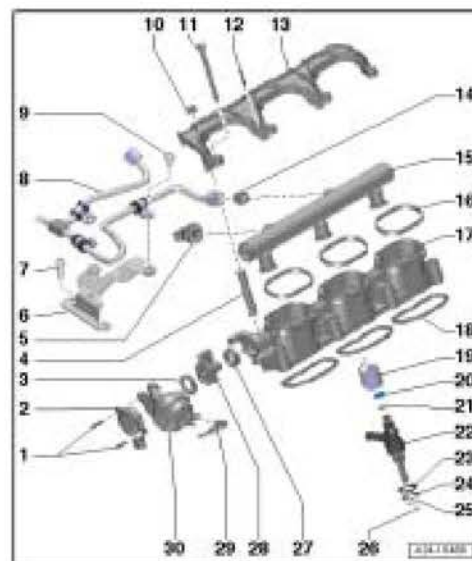

Assembly overview - lower part of intake manifold

- 14 Install compressor ⇒ *Workshop Manual '211419 Removing and installing compressor'*.
- 15 Install poly-V-belt for compressor ⇒ *Workshop Manual '137819 Removing and installing drive belt'*.
- 16 Fill and bleed the cooling system ⇒ *Workshop Manual '193817 Draining and filling coolant (includes bleeding)'*.
- 17 Install engine cover.
- 18 Install engine guard ⇒ *Workshop Manual '108019 Removing and installing engine guard'*.
- 19 Enter the recall campaign in the Warranty and Maintenance booklet.

References: ⇒ *Workshop Manual '1001IN Tightening torques, tightening sequences, assembly overviews'*
 ⇒ *Workshop Manual '108019 Removing and installing engine guard'*
 ⇒ *Workshop Manual '137819 Removing and installing drive belt'*
 ⇒ *Workshop Manual '211419 Removing and installing compressor'*

- ⇒ *Workshop Manual '196120 Removing and installing coolant pipes'*
- ⇒ *Workshop Manual '195819 Removing and installing coolant regulator (thermostat)'*
- ⇒ *Workshop Manual '244719 Removing and installing intake manifold'*
- ⇒ *Workshop Manual '193817 Draining and filling coolant (includes bleeding)'*

Attachment "B": **Claim Submission** - Recall Campaign AF03

Warranty claims should be submitted via WWS/PQIS.

Open campaigns may be checked by using either the PIWIS Vehicle Information system or through PQIS Job Creation.

Labor, parts, and sublet will be automatically inserted when Technician is selected in WWS/PQIS. If necessary, the required part numbers will need to be manually entered into warranty system by the dealer administrator.

Scope 1: **Not valid for these vehicle types**

Scope 2: **Cayenne S Hybrid**

Working time:

Replacing both fuel rails and replacing support piece as well as the support ring and sealing ring on the fuel injectors; also replacing the coolant regulator

Labor time: **461 TU**

Includes:

- Removing and installing engine guard
- Removing and installing engine cover
- Removing poly-V-belt for compressor
- Removing and installing compressor
- Removing and installing front coolant pipe
- Removing and installing lower part of intake manifold for cylinders 1-3 and 4-6
- Draining and filling coolant

Parts required:

000.043.303.51	Fuel rail set	1 ea.
000.043.303.49	Gasket set	6 ea.
000.043.303.50	Support piece	6 ea.
000.043.303.57	Union fitting	2 ea.
000.043.303.52	Breather pipe	1 ea.
000.043.303.56	Seal	6 ea.
000.043.303.58	Seal	6 ea.
000.043.303.59	Thermostat housing	1 ea.

000.043.303.53	Seal	1 ea.
000.043.303.54	Seal	2 ea.
Additional materials required:		
000.043.301.48	Antifreeze, 20-liter container	0.08 ea. (= approx. 1.5 liters)
⇒ Damage code AF03 099 000 2		

Important Notice: Technical Bulletins issued by Porsche Cars North America, Inc. are intended only for use by professional automotive technicians who have attended Porsche service training courses. They are written to inform those technicians of conditions that may occur on some Porsche vehicles, or to provide information that could assist in the proper servicing of a vehicle. Porsche special tools may be necessary in order to perform certain operations identified in these bulletins. Use of tools and procedures other than those Porsche recommends in these bulletins may be detrimental to the safe operation of your vehicle, and may endanger the people working on it. Properly trained Porsche technicians have the equipment, tools, safety instructions, and know how to do the job properly and safely. If a particular condition is described, do not assume that the bulletin applies to your vehicle, or that your vehicle will have that condition. See your authorized Porsche Dealer for the latest information about whether a particular technical bulletin applies to your vehicle. Part numbers listed in these bulletins are for reference only. Always check with your authorized Porsche dealer to verify the current and correct part numbers. The work procedures updated electronically in the Porsche PIWIS diagnostic and testing device take precedence and, in the event of a discrepancy, the work procedures in the PIWIS Tester are the ones that must be followed.

© Porsche Cars North America, Inc.

Dealership	Service Manager	Shop Foreman	Service Technician
Distribution			
Routing	Asst. Manager	Warranty Admin.	Service Technician

Dr. Ing. h.c. F. Porsche AG is the owner of numerous trademarks, both registered and unregistered, including without limitation the Porsche Crest®, Porsche®, Boxster®, Carrera®, Cayenne®, Cayman®, Macan®, Panamera®, Speedster®, Spyder®, 918 Spyder®, Tiptronic®, VarioCam®, PCM®, PDK®, 911®, RS®, 4S®, FOUR, UNCOMPROMISED®, and the model numbers and the distinctive shapes of the Porsche automobiles such as, the federally registered 911 and Boxster automobiles. The third party trademarks contained herein are the properties of their respective owners. Porsche Cars North America, Inc. believes the specifications to be correct at the time of printing. Specifications, performance standards, standard equipment, options, and other elements shown are subject to change without notice. Some options may be unavailable when a car is built. Some vehicles may be shown with non-U.S. equipment. The information contained herein is for internal authorized Porsche dealer use only and cannot be copied or distributed. Porsche recommends seat belt usage and observance of traffic laws at all times.

Printed in the USA