



Service Bulletin

PRELIMINARY INFORMATION

Subject: Back Up Alarm Inoperative And Needs To Be Connected During PDI

Models: 2014 Chevrolet Silverado 1500
2015-2017 Chevrolet Silverado
2014 GMC Sierra 1500
2015-2017 GMC Sierra
Equipped with Back Up Alarm (RPO 8S3)

This PI was superseded to update model years. Please discard PIT5386A.

The following diagnosis might be helpful if the vehicle exhibits the symptom(s) described in this PI.

Condition/Concern

During the PDI it may be noticed that the backup alarm is inoperative. On trucks equipped with the Back Up Alarm (RPO 8S3), the alarm will be intentionally left disconnected from the assembly plant.

Recommendation/Instructions

The alarm is located on the right rear of the frame, and the chassis harness alarm connector is located on the left rear of the frame. Route the harness up and over the spare tire hoist tube and connect to the backup alarm.

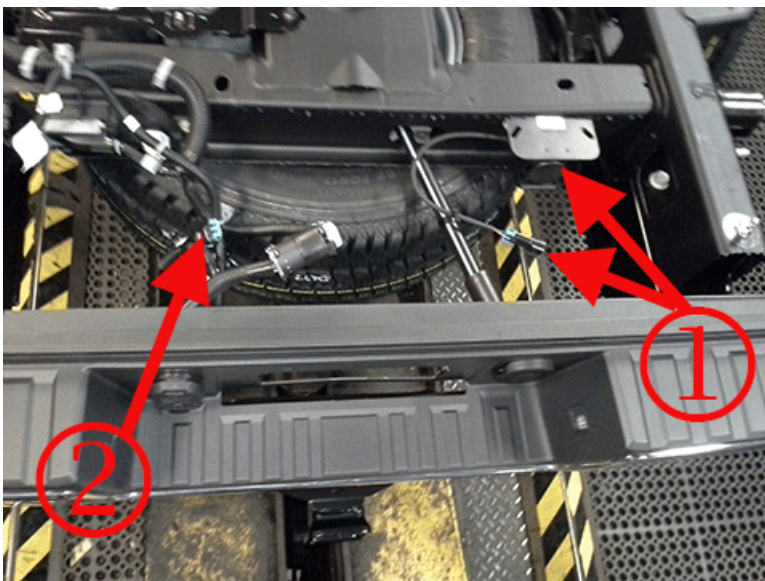

1. Back Up Alarm/Connector
2. Chassis Harness Alarm Connector

Warranty Information

For vehicles repaired under warranty use:

Labor Operation	Description	Labor Time
0590032	PDI - Dealer Installed - Factory Invoiced Options	Use Published Labor Operation Time

Please follow this diagnostic or repair process thoroughly and complete each step. If the condition exhibited is resolved without completing every step, the remaining steps do not need to be performed.

Additional SI Keywords

backup reverse shift

GM bulletins are intended for use by professional technicians, NOT a "do-it-yourselfer". They are written to inform these technicians of conditions that may occur on some vehicles, or to provide information that could assist in the proper service of a vehicle. Properly trained technicians have the equipment, tools, safety instructions, and know-how to do a job properly and safely. If a condition is described, DO NOT assume that the bulletin applies to your vehicle, or that your vehicle will have that condition. See your GM dealer for information on whether your vehicle may benefit from the information.



WE SUPPORT VOLUNTARY TECHNICIAN CERTIFICATION