



INSTRUCTION TO SERVICE

ITS: 6213	
SECTION:	286 Instrument & Switch Panels
WRITTEN BY:	Michael Rooney
SUBJECT:	Add mode selector harness retention bracket.

ITS6213

THIS DOCUMENT AND THE CONTENTS DISCUSSED HEREIN ARE THE CONFIDENTIAL AND PROPRIETARY INFORMATION OF NEW FLYER INDUSTRIES CANADA ULC AND NEW FLYER OF AMERICA INC. AND ARE DISCLOSED BY NEW FLYER IN CONFIDENCE. THIS DOCUMENT AND THE CONTENTS HEREIN ARE NOT TO BE DISCLOSED BY THE INTENDED RECIPIENT WITHOUT THE PRIOR WRITTEN AUTHORIZATION OF NEW FLYER. ANY UNAUTHORIZED DISCLOSURE, REPRODUCTION OR OTHER DISTRIBUTION OF THIS DOCUMENT OR INFORMATION IS STRICTLY PROHIBITED AND MAY RESULT IN ACTION BEING TAKEN AGAINST THE PARTY MAKING THE UNAUTHORIZED DISCLOSURE. THIS DOCUMENT AND ALL COPIES HEREOF MUST BE RETURNED TO NEW FLYER UPON REQUEST.

PROCEDURE:

1. Turn the main battery disconnect switch to the “OFF” position.
2. Tilt the steering wheel away from the instrument panel.
3. Remove the instrument bezel by prying it away from the instrument panel. Figure 1.

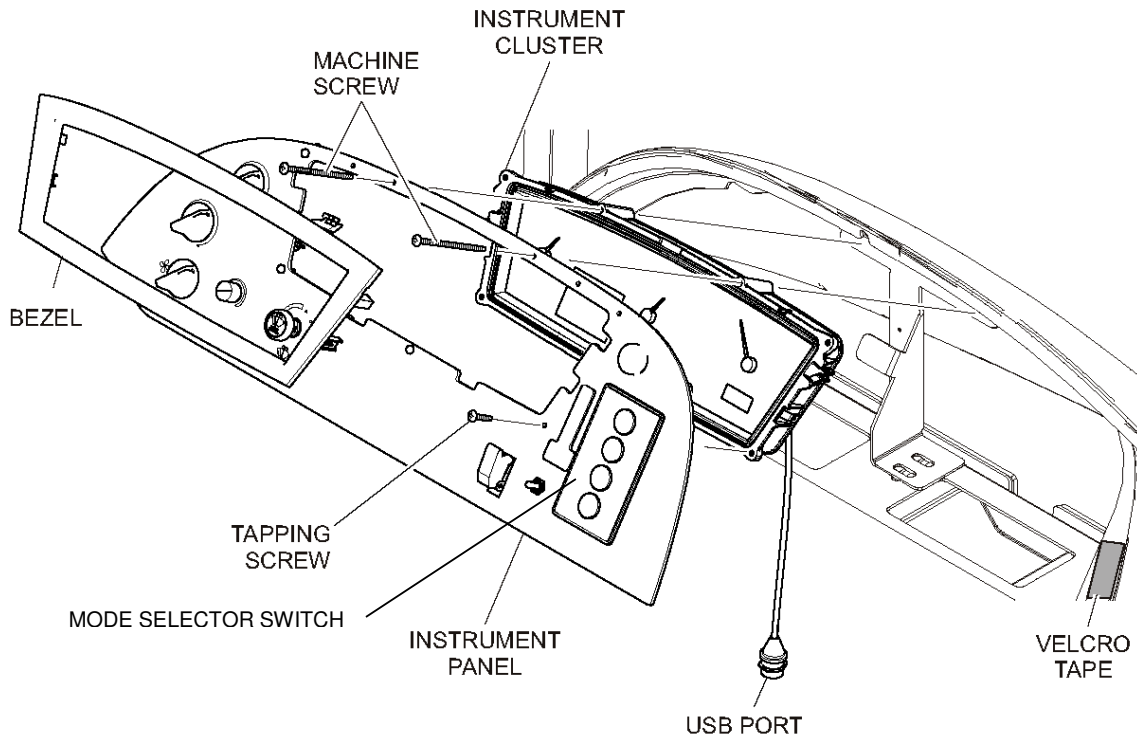

Figure 1: Instrument Panel Assembly.

4. Remove the two machine screws at the top of the instrument panel.
5. Disconnect the USB port below the instrument panel.
6. Pull the instrument panel away to access the connectors on the back side of the panel.

NOTE: The lower corners of the instrument panel are secured with Velcro tape.

7. Disconnect all electrical plugs and connectors from the instrument panel. Tag all wire connectors.
8. Disconnect all cables from defroster controls.
9. Remove the instrument panel from the dash.
10. Loosen and remove the four nuts and washers that secure the mode selector unit to the instrument panel and set them aside for re-use.
11. Install the new mode selector switch bracket NF P/N 620906 on the backside of the instrument panel over the top side of the mode selector unit and secure the switch bracket with two of the nuts and washers removed previously. Figure 2.



NEW FLYER

12. Install the new mode selector switch bracket NF P/N 621463 on the backside of the instrument panel over the bottom side of the mode selector unit and secure the switch bracket with two of the nuts and washers removed previously. Figure 2.

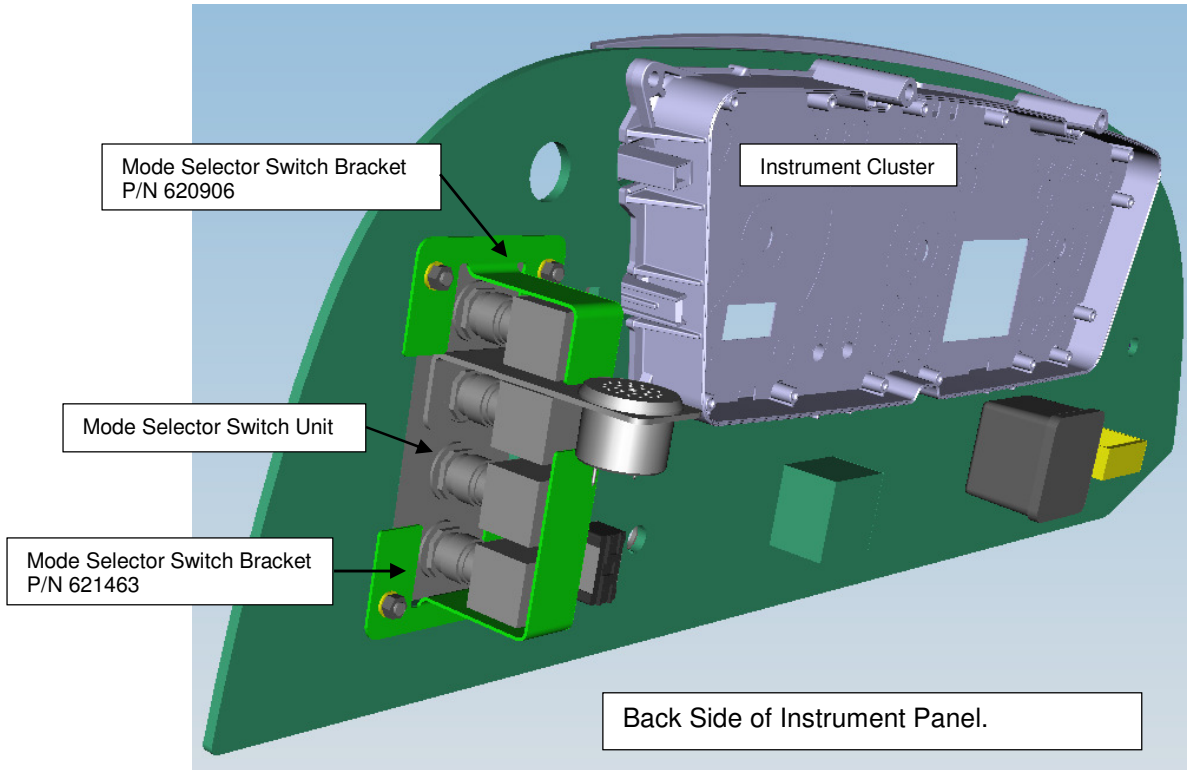

Figure 2: Mode Selector Switch Brackets.

13. Remove the existing Velcro tape and clean the contact areas. Apply new Velcro tape to the left and right side on dash panel.
14. Place the instrument panel in front of the dash and reconnect all electrical and mechanical connections.
15. Reconnect the USB port below the dash panel.
16. Attach the instrument panel to the dash using the machine screws.
17. Turn the main battery disconnect switch to the "ON" position.
18. Start the vehicle and check the operation of instrumentation and controls.



NEW FLYER

LABOUR ESTIMATE

	Operation	Men	Hours	Labour Time M X HR
1	Add mode selector harness retention bracket.	1	0.5	0.5

PARTS REQUIRED

Item	Part Number	Description	Qty. per Coach	Units	Notes
1	6465769	KIT – ASSY FOR ITS - 6213	1	EA	

SPECIAL TOOLS REQUIRED

Item	Part Number	Description	Qty. per Coach	Units	Notes
1		No Special Tools Required			