



DATE: 5-4-16

APPLIES TO: This service bulletin applies to certain 2015 and 2016 model year, K3 model motor homes chassis, built between December 01, 2012 and August 18, 2015 by Spartan Motors USA, Inc.

Bulletin # TSB16-210-001 is superseded by bulletin TSB16-210-001A due to a clarification of a part number description. Any vehicle repaired under bulletin TSB16-210-001 will not require any additional work.

CONDITION: ABS Valve Assembly is dislodging from cross member on Bridge Units.

CORRECTION: Replace current hardware with service kit below

LABOR ALLOCATION: 1 hr.

CLASSIFICATION: M1

PARTS NEEDED:

<u>QTY</u>	<u>Part Number</u>	<u>Description</u>
1	S-2520-001B	ABS Valve Mounting

Kit # S-2520-001B Contains:

<u>QTY</u>	<u>Part Number</u>	<u>Description</u>
4	04200750H8Y	Bolt-1.4-20X7.50LG HEX GR8 YEL
8	04FWSAE8Y	Washer-1/4 FLAT SAE YEL
4	0420LN8Y	Nut-1/4-20 LOCK GR8 YEL
1	TSB16-210-001A	Instruction Document

GENERAL INSTRUCTIONS:

Thoroughly review entire service bulletin before starting work. If there are questions or concerns with steps defined in this service bulletin, contact Spartan Motors USA, Inc. Customer & Product Support Group.

All applicable industry safety standards must be followed when performing work identified in this procedure.

Service Bulletins are intended for use by Professional Technicians only. They are written to guide Professional Technicians in performing service to vehicles of specific nature in conjunction with industry standards. Professional Technicians should be appropriately trained on industry standards and have the tools and equipment to perform procedures safely and properly.



STEP-BY-STEP INSTRUCTIONS:

1. Inspect for loose ABS modulator on frame cross bar above drive axle. If loose remove current fasteners and pull ABS module clear from cross member.
2. With 1/4" drill bit, drill out all four zerts i.d.'s clear through opposite side of cross member. Refer to FIG. 2-1.

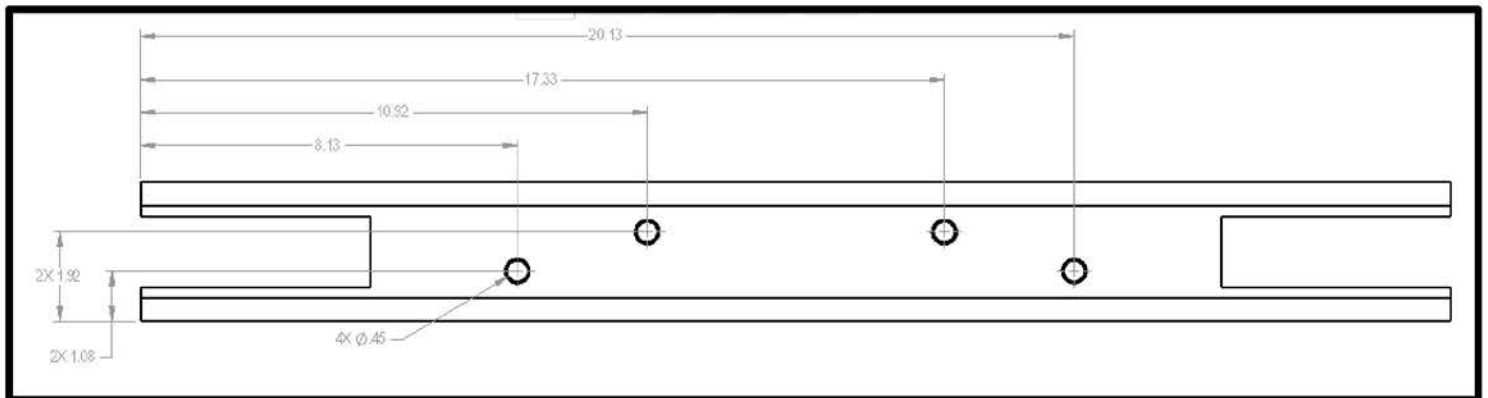

FIG. 2-1

3. Acquire S-2520-001B hardware; install ABS module assembly with all four according to the enclosed document references.

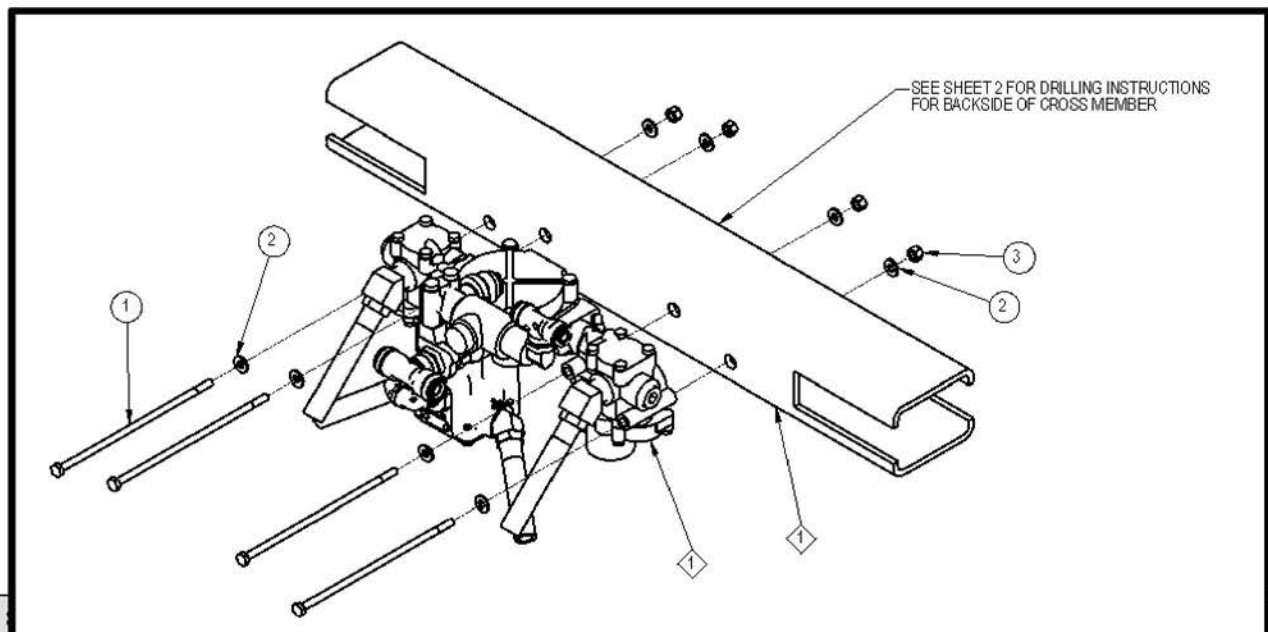

FIG. 2-2

to vehicles of specific nature in conjunction with industry standards. Professional Technicians should be appropriately trained on industry standards and have the tools and equipment to perform procedures safely and