



SERVICE BULLETIN

Classification: AT14-007b	Reference: NTB14-058b	Date: April 21, 2016
------------------------------	--------------------------	-------------------------

2014-2016 ROGUE; SHIFT SELECTOR KNOB REMOVAL AND INSTALLATION INCLUDING THE BLOCK-PULL AND SPRING

This bulletin has been amended. The APPLIED VEHICLES section has been revised. Please discard previous versions of this bulletin.

APPLIED VEHICLES: 2014-2016 Rogue (T32)

NOTE: Does not apply to Rogue Select (S35)

SERVICE INFORMATION

This bulletin contains the procedure to remove and/or install the shift selector knob. It also contains information for re-installing the block-pull and spring, if needed.

Removal

1. Apply the parking brake.
2. Pull DOWN the shift selector knob cover (chrome finisher).
3. Remove the retaining clip using a suitable tool.
4. Pull the shift selector knob UP to remove it.

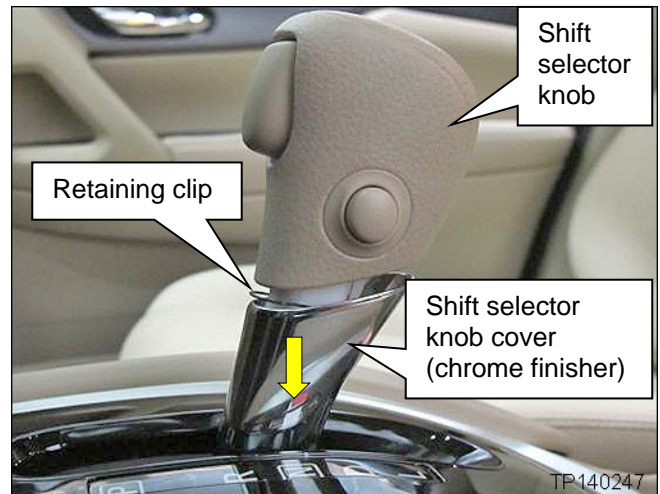

Figure 1

Nissan Bulletins are intended for use by qualified technicians, not 'do-it-yourselfers'. Qualified technicians are properly trained individuals who have the equipment, tools, safety instruction, and know-how to do a job properly and safely. NOTE: If you believe that a described condition may apply to a particular vehicle, DO NOT assume that it does. See your Nissan dealer to determine if this applies to your vehicle.

5. Install the retaining clip back into the shift selector knob.
6. Slide the chrome finisher back into place.
7. Set the shift selector knob aside until you are ready for installation.

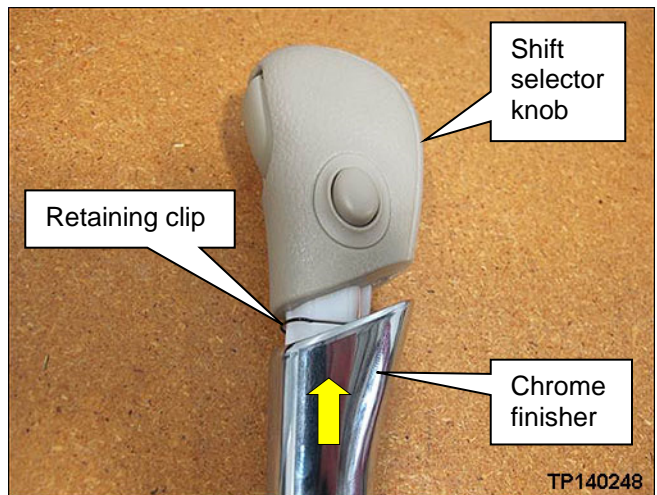

Figure 2

NOTE:

- See **Block-pull and Spring Installation** on the next page.
- The block-pull and spring are exposed when the shift selector knob is removed.

Installation

1. Use a pick tool to pull out the shift selector knob button, and hold it out.
2. While holding the button out, slide the shift selector knob onto the shift shaft until you feel it click into place.
3. Release the shift selector knob button.
4. Pull UP on the shift selector knob to make sure it is locked in place, and does not come off.

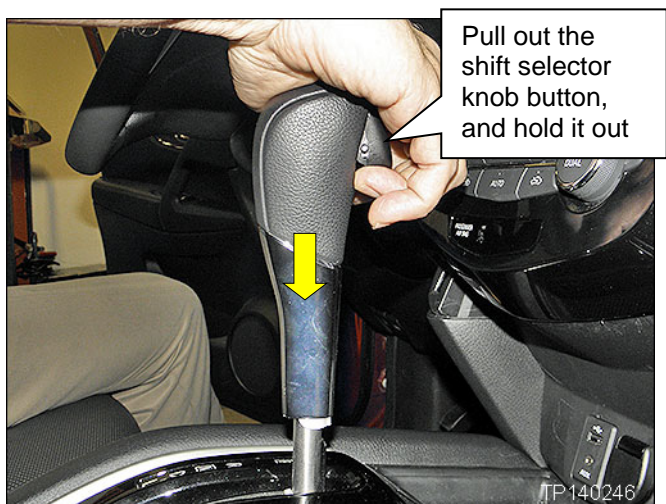

Figure 3

Block-pull and Spring Installation

With the shift selector knob removed, the block-pull and spring will be exposed.

If for any reason the block-pull and spring are removed as shown in Figure 5:

- **DO NOT** replace the entire shifter assembly if the block-pull and spring have been removed.
- Make sure they are reinstalled correctly, as shown in Figure 4.
- The opening at the bottom of the block-pull must be aligned with the slot on the shift shaft as shown in Figure 4.
- Figure 5 shows the block-pull and spring removed.

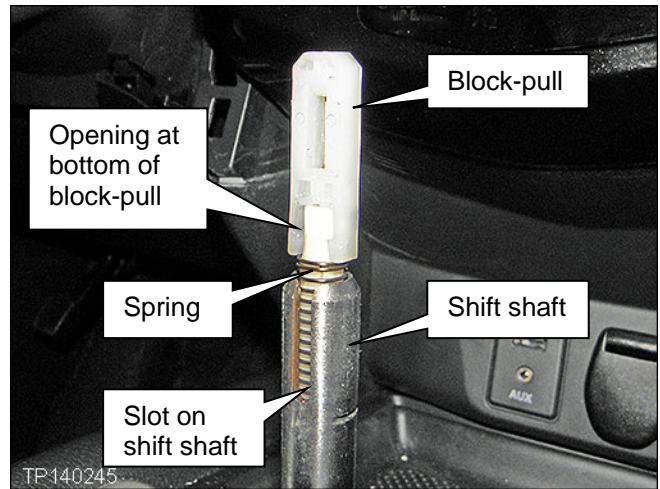

Figure 4

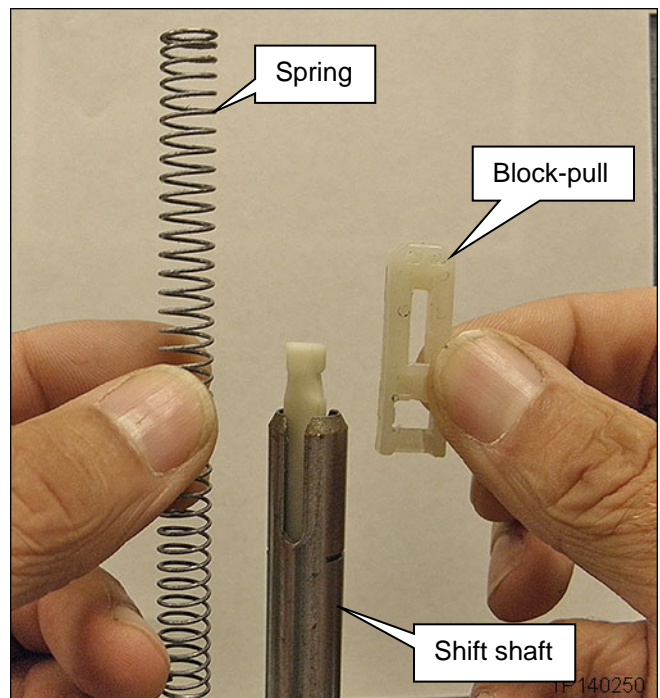

Figure 5