



© 2016 Mazda Motor of America, Inc.

Subject: FRONT POWER SEATS DO NOT SLIDE BACK AND FORTH	Bulletin No: 09-006/16
	Last Issued: 02/03/2016

BULLETIN NOTE

This bulletin supersedes the previously issued bulletin(s) listed below. The changes are noted in Red beside the change bars.

Previously Issued TSBs:
09-034/15

APPLICABLE MODEL(S)/VINS

2013-2016 CX-5 vehicles with VINs lower than JM3KE*****663237 (produced before May 1, 2015)

2014-2016 Mazda6 vehicles with VINs lower than JM1GJ*****430009 (produced before May 1, 2015)

DESCRIPTION

Some customers may complain that the front power (driver and/or passenger) seats do not slide back and forth properly or that they may be completely inoperative. This concern may be caused by a foreign object getting stuck under the power slide unit (below) while in operation. This can cause motor mounting bracket (A) deformation, resulting in motor cable (B) breakage.

CONSUMER NOTICE: The information and instructions in this bulletin are intended for use by skilled technicians. Mazda technicians utilize the proper tools/equipment and take training to correctly and safely maintain Mazda vehicles. These instructions should not be performed by "do-it-yourselfers." Customers should not assume this bulletin applies to their vehicle or that their vehicle will develop the described concern. To determine if the information applies, customers should contact their nearest authorized Mazda dealership. Mazda North American Operations reserves the right to alter the specifications and contents of this bulletin without obligation or advance notice. All rights reserved. No part of this bulletin may be reproduced in any form or by any means, electronic or mechanical---including photocopying and recording and the use of any kind of information storage and retrieval system ---without permission in writing.

Power Slide Unit

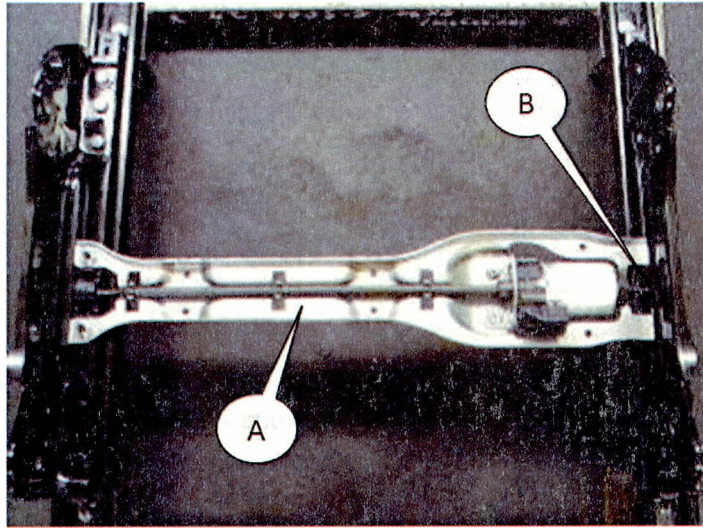

To eliminate this concern, the shape of the motor mounting bracket (A) has been modified to increase its strength.

Customers having this concern should have their vehicle repaired using the following repair procedure.

REPAIR PROCEDURE

1. Verify the customer concern.
2. Inspect the motor cable (short one) and the motor mounting bracket:
 - Is the motor cable broken?
 - Is the motor mounting bracket deformed?
3. If the results are "Yes" for either of the above inspections, replace the power side unit with a newly established modified service part according to the replacement procedure.

NOTE: The seat illustrations shown throughout this bulletin are CX-5 (LH), unless noted otherwise.

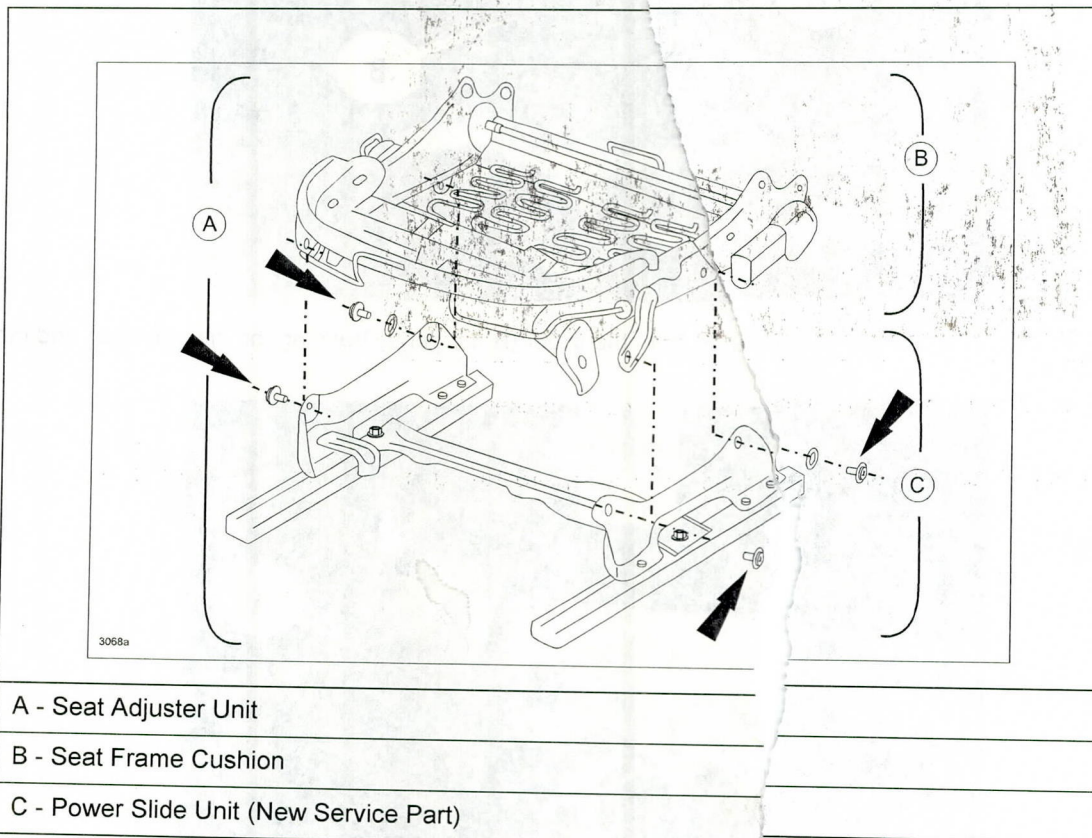

4. Remove the seat adjuster unit (A) according to MS3 Online or the workshop manual (section 09-13 FRONT SEAT ADJUSTER UNIT REMOVAL/INSTALLATION).

CAUTION: ALWAYS BE SURE TO USE THE PROPER TOOLS AND TECHNIQUES WHEN WORKING WITH FASTENERS, OTHERWISE, DAMAGE MAY OCCUR. SEAT FASTENERS ARE NOT SERVICED SEPARATELY AND ARE ONLY AVAILABLE WITH THE SEAT ADJUSTER UNIT.

Disassemble Seat Adjuster Unit:

1. Remove four (4) bolts securing the four (4) links (A) to the sliders (B).

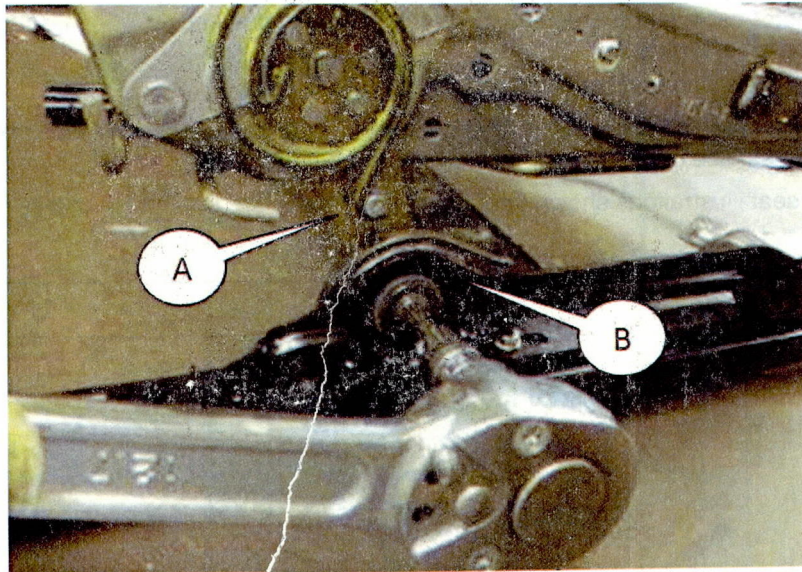

2. Remove the front link (A) (inner and outer) from the slider (B) by gently bending the slider inward and the link outward.

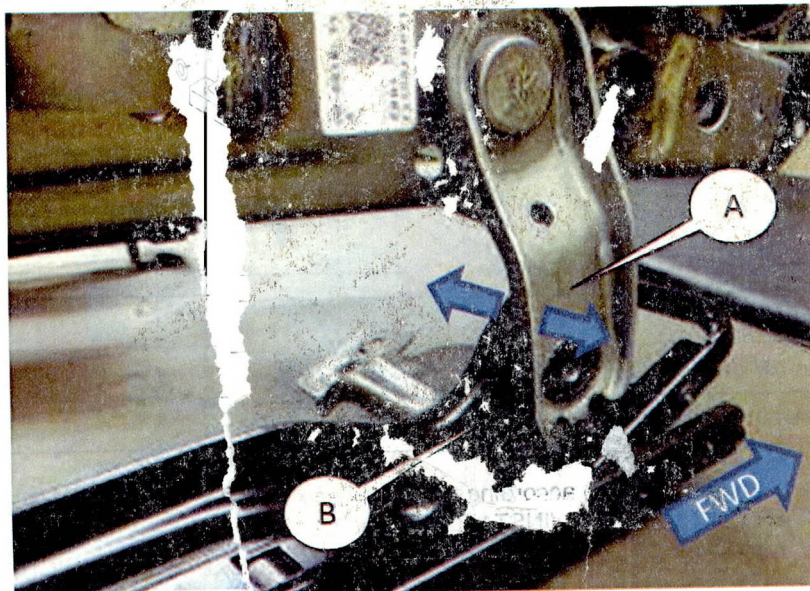

CAUTION: Be careful not to damage the link bushing (A) during removal.

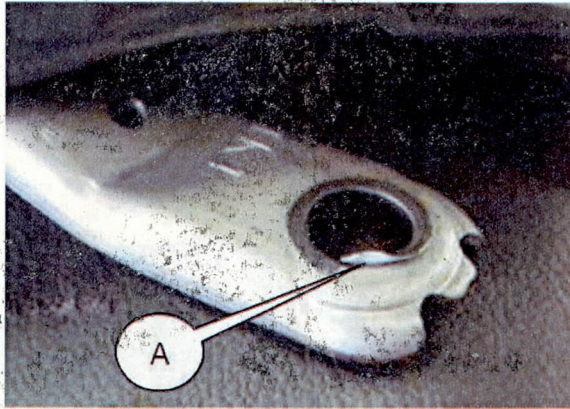

After Link Removal



NOTE: CX-5 Only: Some vehicles of specific production dates use a plastic washer (A) between the slider and the link. Discard the plastic washer as it will not be reused.

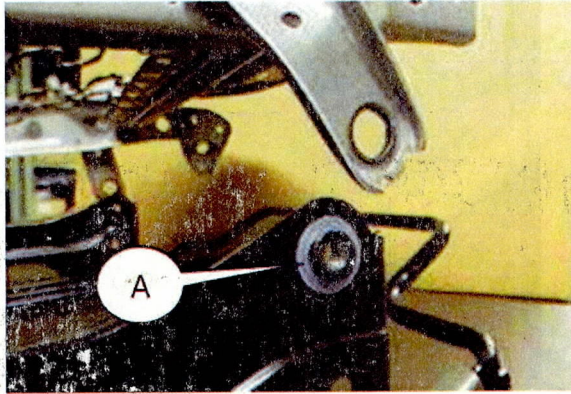

3. Remove the rear links (A) (inner and outer) from the sliders (B) by gently bending the slider outward and the link inward.

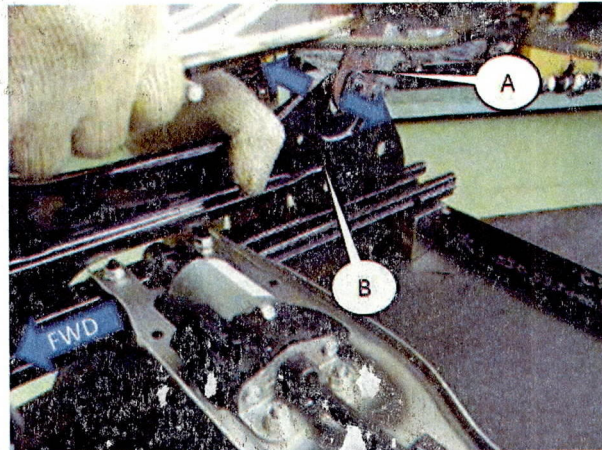

Assemble Seat Adjuster Unit Using a New Power Slide Unit:

1. Install the rear links (A) (inner and outer) to the sliders (B).

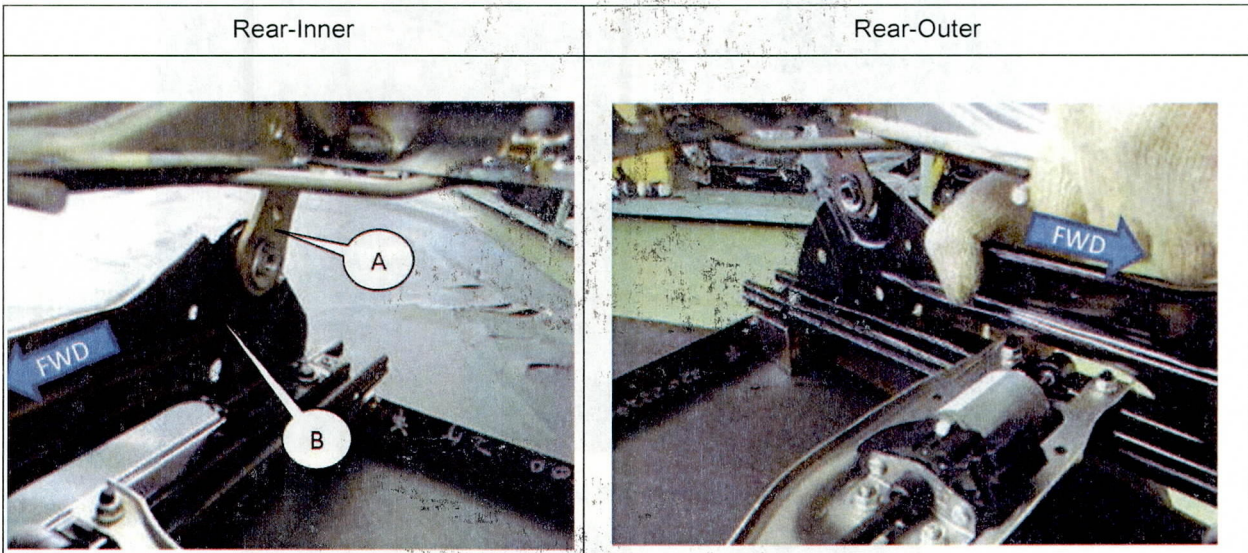

CAUTION: DO NOT bend the slider too much. It could become deformed, causing improper operation.

CAUTION: DO NOT damage the bushing (A) in the slider during link installation.

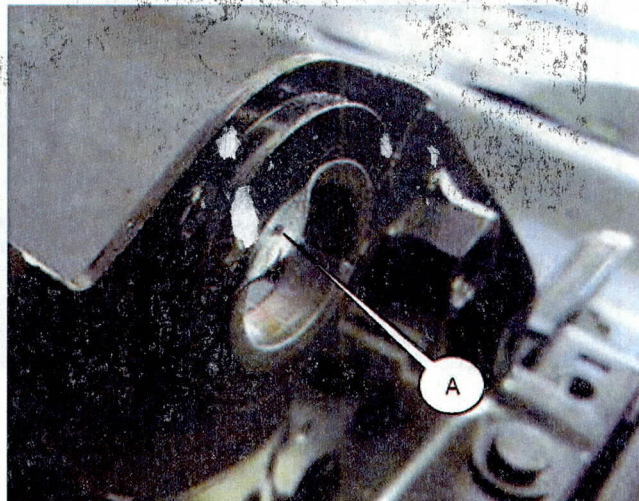

2. Install the front link (inner and outer) to the slider.

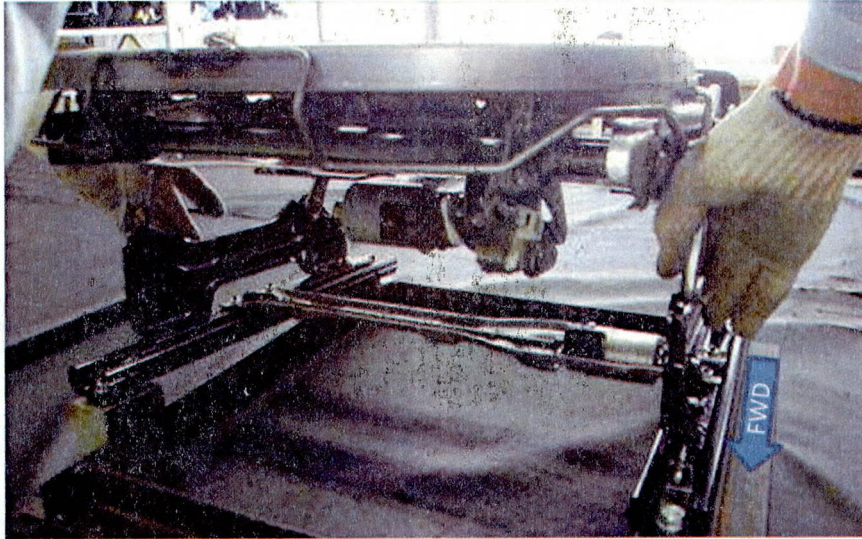

CAUTION: Pay close attention not to damage the bushing (A) during link installation.

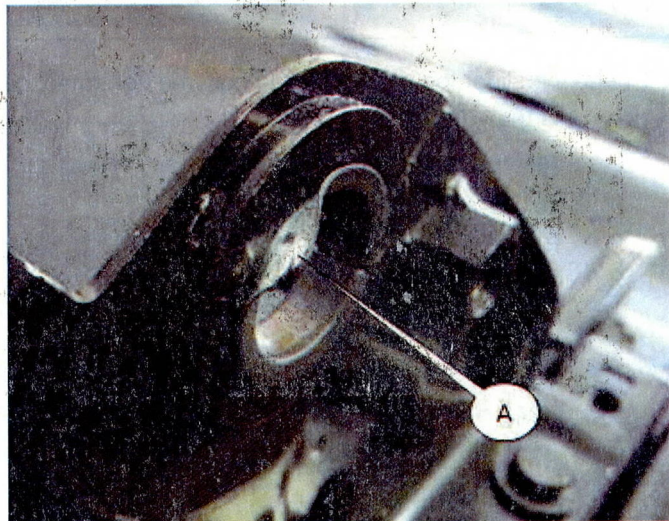

- Using a suitable pry tool, install the link until it is properly seated.

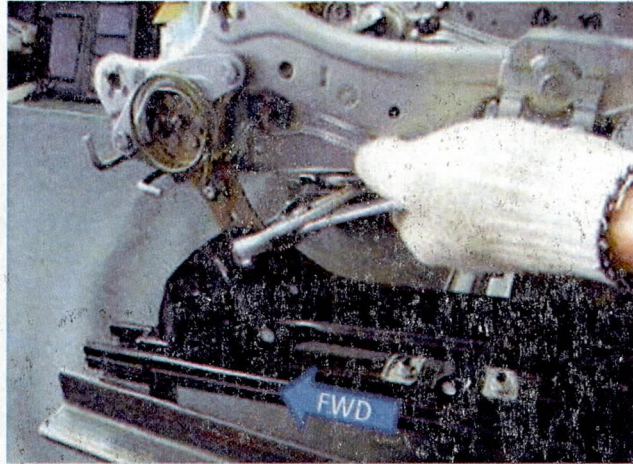

- Tighten the four (4) link-bolts as shown below.

Tightening Torque: 15.7-22.6 Nm {11.6-16.7 ft.-lbf., 1.6-2.3 kgf-m}



NOTE: Install the washer (A) for the rear link (B).

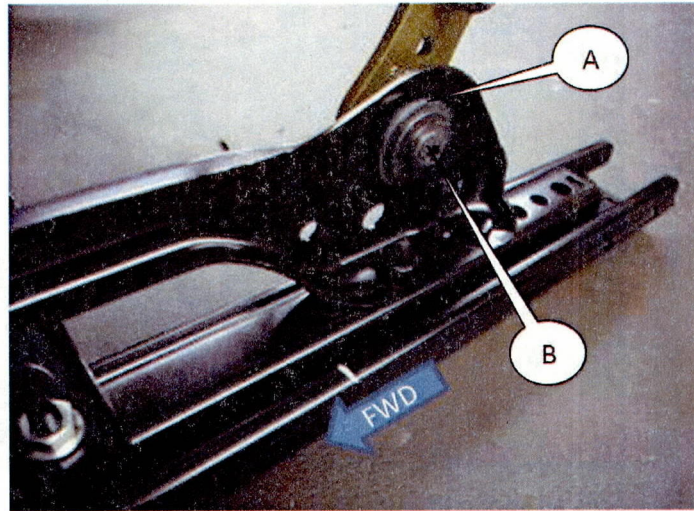

5. Remove the position sensor (A) (if installed) from the old power slide unit, then reinstall it to the new power slide unit.

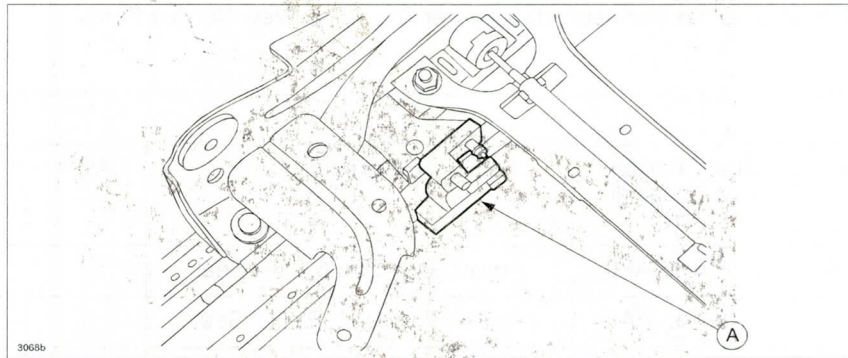

6. Remove the screw (A) then push the clip (B) to remove the position sensor.

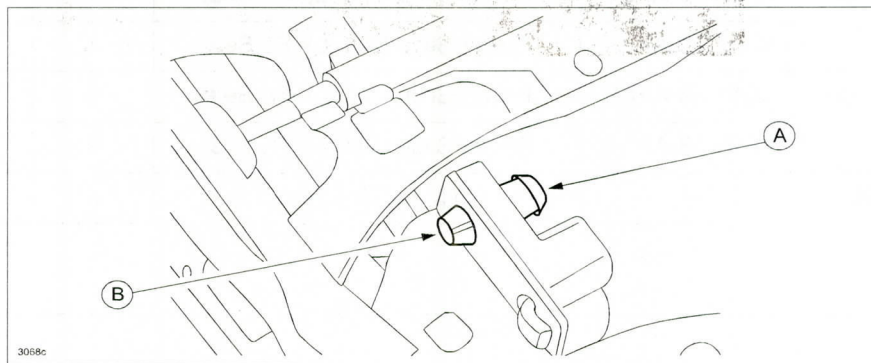

7. Install the seat adjuster unit according to MS3 Online or the workshop manual (section 09-13 FRONT SEAT ADJUSTER UNIT REMOVAL/INSTALLATION).
8. Verify the seat slides back and forth properly.

PART(S) INFORMATION

IMPORTANT: Confirm the part number of Seat Adjuster Unit (Original Part) for the subject VIN by checking the GEPC, then order the corresponding Power Slide Unit (New Service Part).

CX-5:				
Power Slide Unit (New Service Part)	Seat Adjuster Unit (Original Part)	Description	Qty.	Notes
KAYN-88-AF0	KA0N-88-AF0	Power Slide Unit (L), Fr. Seat	1	---
KAYP-88-AA0	KA5P-88-AA0	Power Slide Unit (R), Fr. Seat	1	---
KAYN-88-AA0	KA0N-88-AA0	Power Slide Unit (R), Fr. Seat	1	---
KDY6-88-AF0A	KD35-88-AF0A	Power Slide Unit (L), Fr. Seat	1	---
	KD37-88-AF0A	Power Slide Unit (L), Fr. Seat	1	---
KDY2-88-AF0A	KD51-88-AF0A	Power Slide Unit (L), Fr. Seat	1	---
	KF69-88-AF0A	Power Slide Unit (L), Fr. Seat	1	---
KD45-88-585	---	Clip (for side cover)	2	Replace Parts

Mazda6:				
Power Slide Unit (New Service Part)	Seat Adjuster Unit (Original Part)	Description	Qty.	Notes
GLY3-88-AF0	GLK3-88-AF0	Power Slide Unit (L), Fr. Seat	1	---
GJY3-88-AF0	GJS2-88-AF0	Power Slide Unit (L), Fr. Seat	1	---
GHY2-88-AF0	GHL2-88-AF0	Power Slide Unit (L), Fr. Seat	1	---
GLY5-88-AA0	GLK4-88-AA0	Power Slide Unit (R), Fr. Seat	1	---
GHY2-88-AA0	GHL2-88-AA0	Power Slide Unit (R), Fr. Seat	1	---
KD45-88-585	---	Clip (for side cover)	2	Replace Parts

WARRANTY INFORMATION

NOTE:

- This warranty information applies only to verified customer complaints on vehicles eligible for warranty repair.
- This repair will be covered under the New Vehicle Limited Warranty term.
- Additional diagnostic time cannot be claimed for this repair.

Warranty Type	A
Symptom Code	64
Damage Code	9A
Part Number Main Cause	(SEE PART(S) INFORMATION)
Quantity	1
Operation Number / Labor Hours	XXL53DRX / 0.8 Hrs. (Driver side only) XXL53ERX / 0.9 Hrs. (Passenger side only) XXL53FRX / 1.5 Hrs. (Both sides)

NOTE: For the passenger seat, the following labors are included:

- DTC INSPECTION [TWO-STEP DEPLOYMENT CONTROL SYSTEM]
- OCCUPANT CLASSIFICATION SENSOR CALIBRATION [TWO-STEP DEPLOYMENT CONTROL SYSTEM]