



## Service Bulletin 529

### Issue 1 - 03.2016

Subject: Immobiliser Antenna Cable				
Bulletin Number	Models Affected	VIN Range		Markets Affected
529	Street Twin	Up to	749243	All Markets
529	Bonneville T120	Up to	749243	All Markets
529	Bonneville T120 Black	Up to	749243	All Markets

#### Background Information

Internal investigations have identified a need to reroute and secure the immobiliser antenna cable in the headstock area to prevent potential cable damage.

Dealers are requested to reroute and secure the immobiliser antenna cable. Dealers must also inspect the immobiliser antenna cable for any damage. If the immobiliser antenna cable is damaged, dealers are requested to contact Triumph Warranty Technical Support for repair instructions.

#### Customer Contact Instructions

Motorcycles in the affected VIN range must be modified prior to delivery to the customer, or at the next visit to the dealership.

#### Identification of Affected Motorcycles

Street Twin, Bonneville T120 and Bonneville T120 Black models listed in the VIN ranges above.

#### Note:

- Some affected motorcycles listed in the VIN range will have been modified and repaired by Triumph prior to their release from the factory.
- The modified motorcycles can be identified by checking the 'Outstanding Service Bulletins' on Warranty Online.

#### Warranty Claim Instructions

Bulletin Number	Fault Code	Repair Code	Description	Repair Time Allowance
529	020740929	99529	Immobiliser antenna cable - reroute and secure.	0.03 hours

#### Genuine Parts Information

Bulletin Number	Part Number	Description	Quantity
529	T3700015	Cable Tie, 185.7 Long	1

---

## Parts Ordering Instructions

**For Triumph Subsidiary and Overseas Distributor dealers using Triumph Warranty On-Line with Parts Auto Ordering Flag switched on:** Order all repair parts by submitting a New Prior through the Warranty On-Line system. Entering the above repair code in a New Prior will automatically add the parts required and labour times for this Service Bulletin.

**For Overseas Distributor dealers NOT using Triumph Warranty On-Line or for Overseas Distributor dealers using Triumph Warranty On-Line with Parts Auto Ordering Flag switched off:** Orders should be placed using the normal parts ordering procedure.

## Genuine Parts Return Instructions

Not applicable

## Other Instructions

Before returning the motorcycle to the customer, download the latest tune to the engine control module using the current version of the Triumph diagnostic software.

Once completed, please mark the Service Record Book that the requirements of this bulletin have been complied with.

## Immobiliser Antenna Cable Adjustment Procedure

Reroute the immobiliser antenna cable and secure with a cable tie following the procedure described below. If the immobiliser antenna cable is damaged, contact Triumph Warranty Technical Support for repair instructions.

### Warning

Before starting work, ensure the motorcycle is stabilised and adequately supported. This will help prevent it from falling and causing injury to the operator or damage to the motorcycle.

1. Position the immobiliser antenna cable to the left hand side of the steering lock boss (when viewing the motorcycle from the rear).

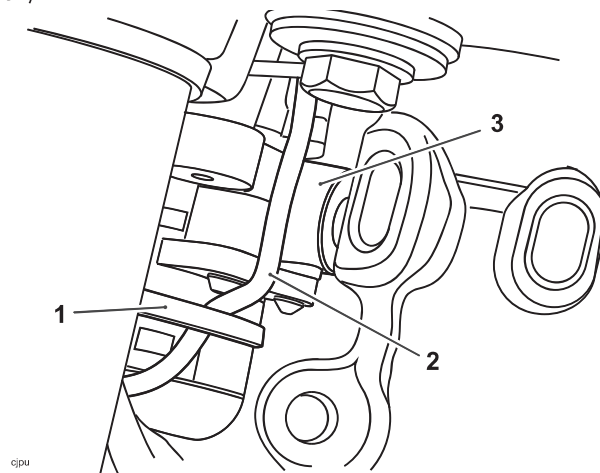

1. **Cable tie**
2. **Immobiliser antenna cable**
3. **Steering lock boss**

2. Below the steering lock, insert the cable tie between the headstock and ignition switch.
3. Wrap the cable tie round the ignition switch and immobiliser antenna cable. Make sure that the immobiliser antenna cable is held in the correct position and no other cables are tied in.

- 4. Any loose immobiliser antenna cable that is above the cable tie must be gently pulled down below the cable tie, as shown below.
- 5. Tighten the cable tie in position securely. Make sure that the cable tie is not over tightened as this may result in potential damage to the cable.

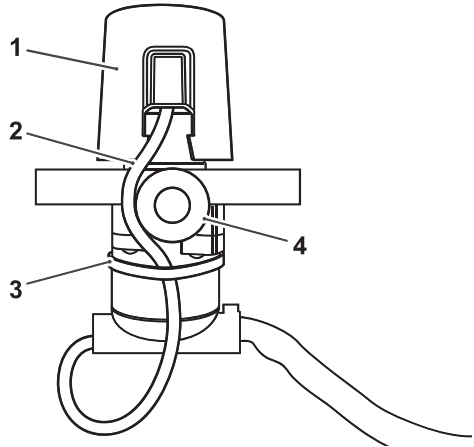

cjpa

- 1. Ignition switch
- 2. Immobiliser antenna cable
- 3. Cable tie
- 4. Steering lock boss

- 6. Carefully cut the remaining cable tie making sure not to cut or damage any other cables.

**Circulation**

Initial and date when read and return to central file holder

Service Manager	Parts Manager	Sales Manager	Workshop Supervisor	Technician 1	Technician 2