	GROUP ELE	MODEL 2015 MY K900 (KH)
	NUMBER 103	DATE May 2016
TECHNICAL SERVICE BULLETIN		
SUBJECT: SERVICE ACTION: START STOP BUTTON (SSB) INSPECTION AND REPLACEMENT (SA 228)		

This bulletin provides the procedure to inspect the start button switch cap and replace the start button switch assembly if necessary on certain 2015MY K900 (KH) vehicles, produced from December 18, 2013 through May 12, 2014. The SSB in certain vehicles may cause difficulty starting and or shutting off the vehicle due to a broken start button switch cap. Kia is requesting the completion of this Service Action on all affected vehicles, including dealer stock, prior to delivery. Before conducting the procedure, verify the vehicle is included in the list of affected VINs.



★ NOTICE

A Service Action is a repair program without customer notification that is performed during the warranty period. Any dealer requesting to perform this repair outside the warranty period will require DPSM approval.

Repair status for a VIN is provided on WebDCS (Service> Warranty Coverage> Warranty Coverage Inquiry> Campaign Information). Not completed Recall / Service Action reports are available on WebDCS (Consumer Affairs> Not Completed Recall> Recall VIN> Select Report), which includes a list of affected vehicles.

This issue number is SA 228.

File Under: <Electrical>

-
- Circulate To:** General Manager Service Manager Parts Manager
- Service Advisor(s) Technician(s) Body Shop Manager Fleet Repair

SUBJECT: SERVICE ACTION: START STOP BUTTON (SSB) INSPECTION AND REPLACEMENT (SA 228)

Inspection Procedure:

1. Record radio station presets. Disconnect the battery.
2. Use a Phillips head self-drilling screw (A), no more than 5/8" long, and carefully thread it into the center of the button cap.

CAUTION

Thread the screw into the center of the button enough to allow a pair of pliers to grip the head.



3. Use a pair of pliers to grip the screw and pull the SSB cap straight out.

CAUTION

Be careful to not strike any part of the interior of the vehicle.



4. Inspect the SSB cap for damage to the cap hooks (B).

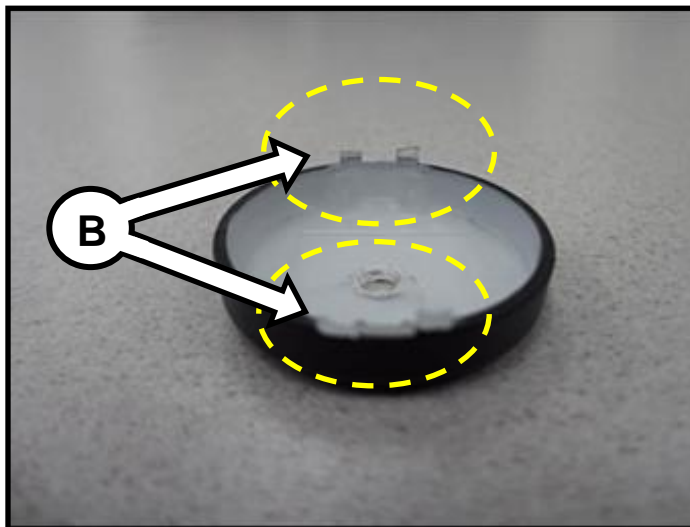

SUBJECT: SERVICE ACTION: START STOP BUTTON (SSB) INSPECTION AND REPLACEMENT (SA 228)

5. If the SSB cap hooks (B) are not broken replace the SSB cap only. See step 7. **“Replacement of Start Stop Button Cap”** below.

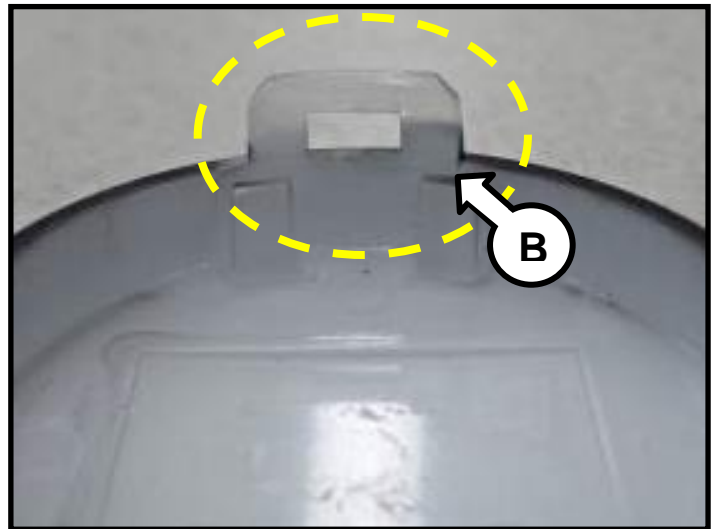

6. If the SSB cap hooks (B) are broken, follow the **“Service Procedure Replacement of SSB Switch”** on the next page to replace the SSB assembly.

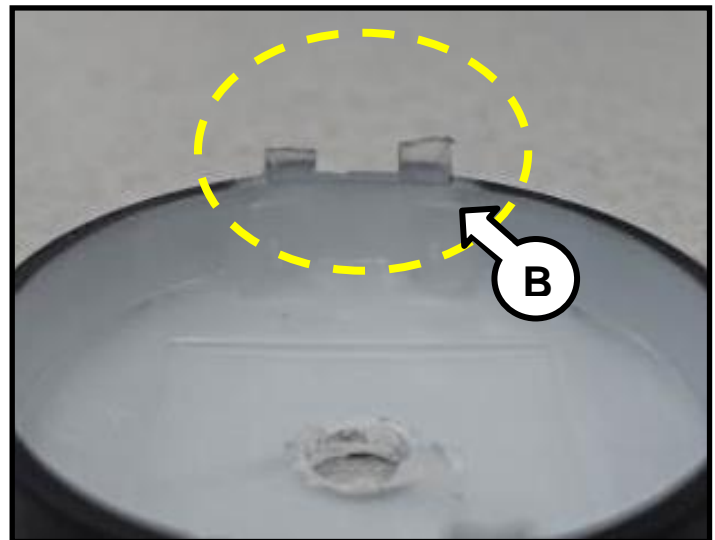

Replacement of Start Stop Button Cap:

7. Align the new cap on the existing switch with **“ENGINE START STOP”** text horizontally aligned and press cap straight in until a snap is felt.
8. Connect the battery.
9. Confirm proper operation of SSB. Program previously recorded radio presets.
(No further action required)



Service Procedure: Replacement of SSB Switch

1. With battery previously disconnected, remove weather strip from front area of door opening.



CAUTION

Be sure to wear disposable gloves throughout this procedure to avoid soiling interior trim panels.



2. Use a non-marring trim panel tool to remove the trim cover (A) from the side of the crash pad.



CAUTION

Use a non-marring trim removal tool (Such as Snap-on® Part Number PBN5 or equivalent) to avoid damaging trim pieces.

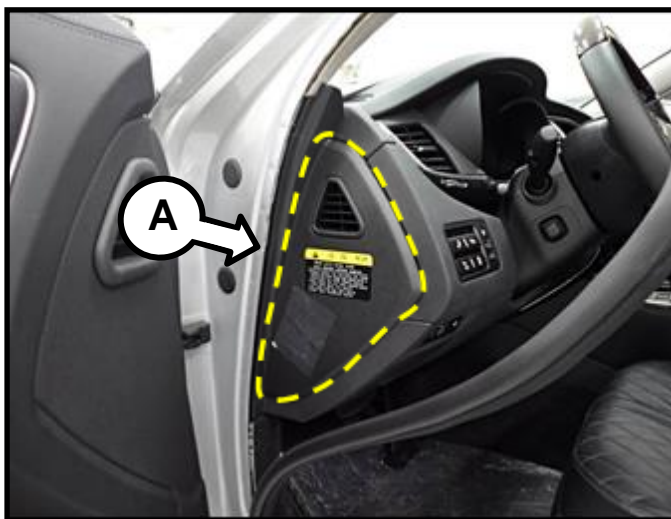

3. Use a non-marring trim panel tool to remove the LH front door scuff trim (B).

* NOTICE

Click on the link shown below, or scan the QR Code, for a video clip on replacing the SSB switch.

[SSB Switch Replacement](#)

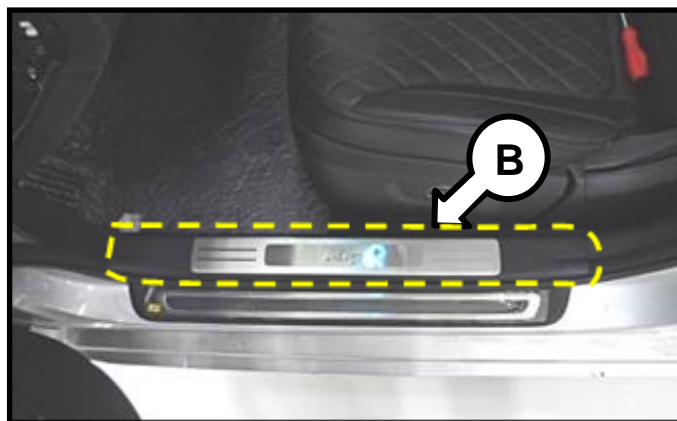

SUBJECT: SERVICE ACTION: START STOP BUTTON (SSB) INSPECTION AND REPLACEMENT (SA 228)

4. Disconnect the LH front door scuff trim lamp connector (C).

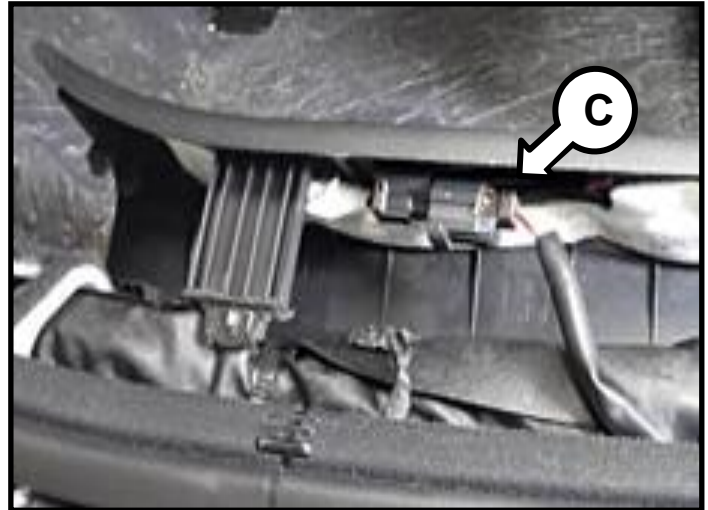

5. Remove the hood latch release handle (D) by first removing the screw then pull straight out.

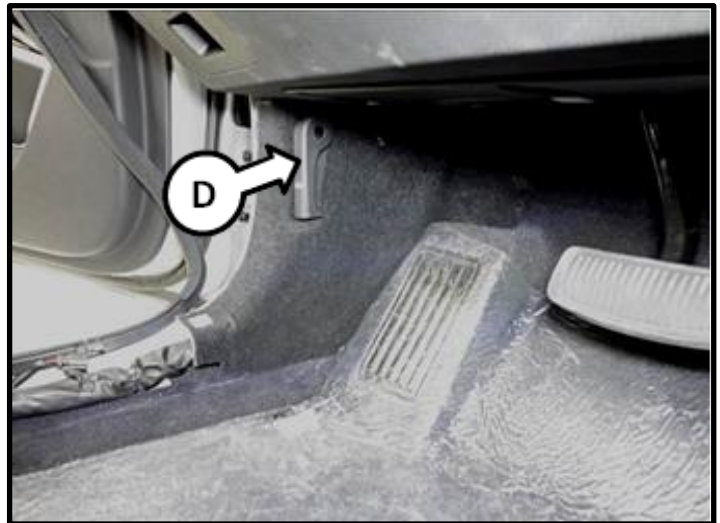

6. Remove the LH cowl side trim (E) (kick Panel).

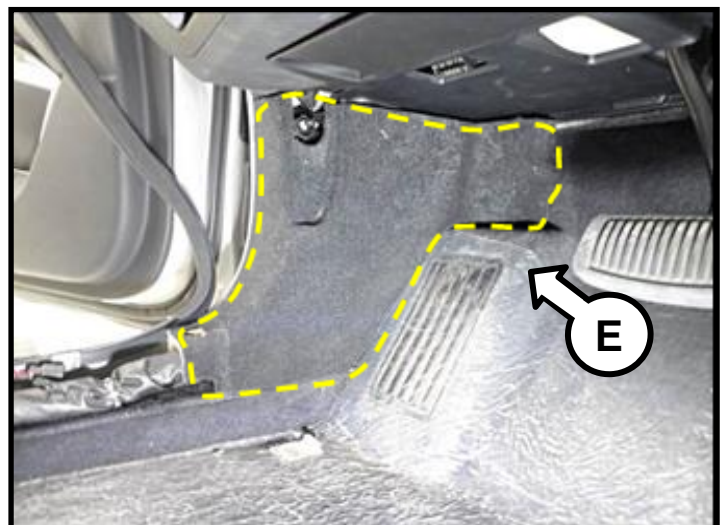

SUBJECT: SERVICE ACTION: START STOP BUTTON (SSB) INSPECTION AND REPLACEMENT (SA 228)

7. Remove the six screws securing the crash pad lower panel and remove the lower panel.

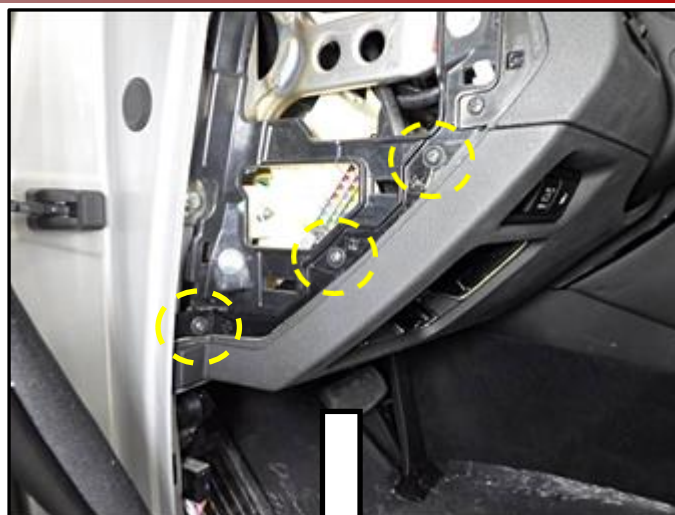

8. The lower crash panel is snapped into place and will need to be pulled away to remove. Then disconnect the connector from the lower crash panel pad switches.



SUBJECT: SERVICE ACTION: START STOP BUTTON (SSB) INSPECTION AND REPLACEMENT (SA 228)

9. Remove the lower crash pad bracket by removing the two bolts.

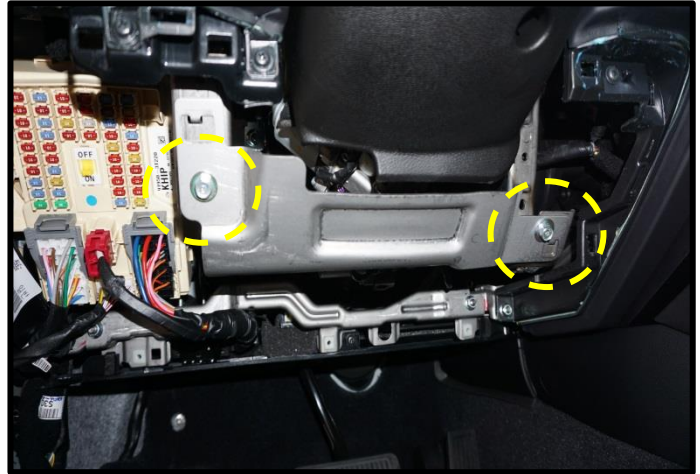

10. Locate the SSB connector behind the dash board at the back of the SSB.

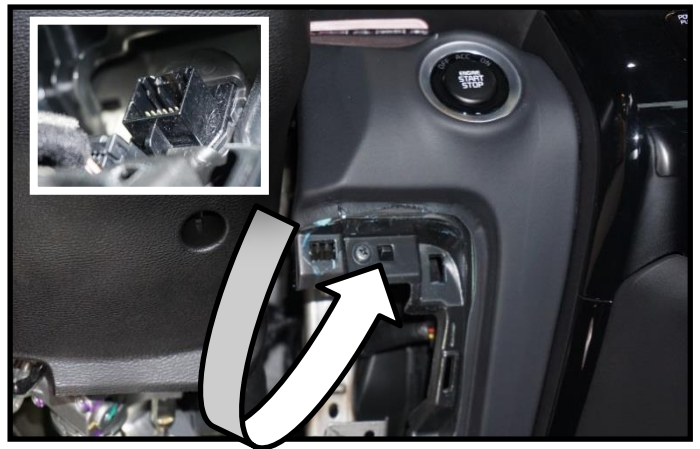

11. Press the release button on the top middle of the connector and pull connector out.

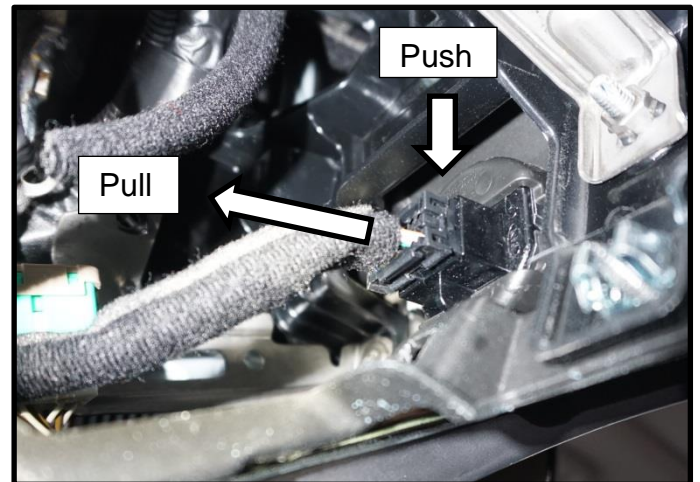

SUBJECT: SERVICE ACTION: START STOP BUTTON (SSB) INSPECTION AND REPLACEMENT (SA 228)

12. Mount the Button Start Remover Tool onto the SSB on the connector side at the back side of the crash pad. (It will only attach one way).

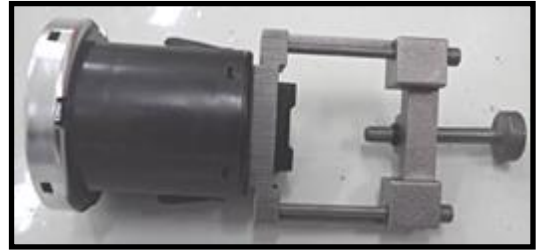

13. Engage the release fork to release the anchoring tabs of the switch.

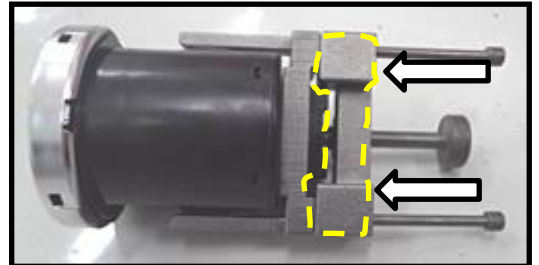

14. Press center plunger to eject the SSB assembly from the dash panel.

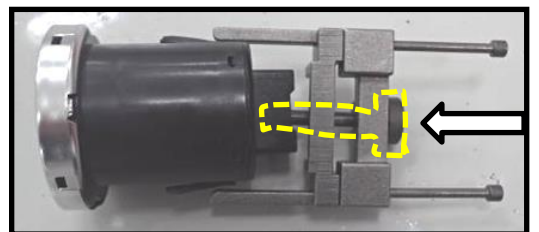

SUBJECT: SERVICE ACTION: START STOP BUTTON (SSB) INSPECTION AND REPLACEMENT (SA 228)

15. Push the SSB harness connector through the crash pad and connect to the improved SSB. Then insert the SSB into the crash pad. It will click into place and appear flush. See picture below.



16. Install all removed parts in reverse order of disassembly.

17. Connect battery. Test operation of new SSB. Program previously recorded radio presets.



SPECIAL SERVICE TOOL:



Tool Name	Part Number	Remark	Comments
Button Start Remover	0K954 3T100QQK		Auto-shipped to Dealer (For additional tools contact Snap-On Business Solutions at 888-542-1011)

AFFECTED VEHICLE PRODUCTION RANGE:

Model	Production Date Range
K900 (KH)	December 18, 2013 through May 12, 2014

SUBJECT: SERVICE ACTION: START STOP BUTTON (SSB) INSPECTION AND REPLACEMENT (SA 228)

PARTS INFORMATION:

Part Name	Part Number	Qty.	Figure
Start Stop Button Switch Assembly	95430 3T102QQK	1	
Start Stop Button Switch Cap	95431 3T100QQK	1	

WARRANTY INFORMATION:

N CODE: N99 C CODE: C99

Claim Type	Causal P/N	Qty.	Repair Description	Labor Op Code	Op Time	Replacement P/N	Qty.
V	95430 3T102	0	(SA 228) Inspect SSB cap for damage and replace SSB cap.	160021R0	0.2 M/H	95431 3T100QQK	1
			(SA 228) Inspect SSB cap for damage and replace SSB assembly.	160021R1	0.5 M/H	95430 3T102QQK	

*** NOTICE**

Current LTS shows labor at 1.5 hr to remove and replace the SSB following the service procedure outlined on KGIS. In this TSB, revised instructions have been provided along with a SST which simplifies the removal of the SSB. Removal of some parts and / or trim pieces, as posted on KGIS are not necessary to complete the removal of the SSB. The labor time has therefore been adjusted to 0.5 hr (includes inspection). This bulletin supersedes service information and labor time previously published.

*** NOTICE**

VIN inquiry data for this repair is provided for tracking purposes only. Kia retailers should reference SA 228 when accessing the WebDCS system.