



**SLINGSHOT**

Date: November 30, 2016  
Expiration Date: November 30, 2017

# TECHNICAL SERVICE BULLETIN

## Slingshot

Bulletin Number: T-16-04  
Model Years: 2015-2017

Safety Bulletin

Service Bulletin

Service Alert Fax

Distribution:  Owner/Principal  Service Manager  Sales Manager  Parts Manager  Technicians

*This Service Bulletin is located at [www.polarisdealers.com](http://www.polarisdealers.com)*

-Confidential and Proprietary-

**VERSION: R01 (November 30, 2016)**

## SUBJECT

### 2015-2017 Slingshot Steering Shaft Pinch Bolt and Set Screw Replacement

## PURPOSE

Polaris has determined that some Slingshot vehicles could have a steering shaft pinch bolt and set screw that do not meet Polaris quality standards. To improve the steering shaft fit and reduce steering wheel free-play, Polaris has completed validation of revised steering shaft hardware.

Refer to "Unit Inquiry" on the dealer website to ensure each vehicle is within the specified VIN range for this Service Bulletin. Refer to the repair procedure below for the proper steps to complete this bulletin.

Your service department **MUST** perform the following actions as directed by this Service Bulletin:

1. Each member of your service department team must review this Service Bulletin in its entirety.
2. Each member of your service department team must watch the training video prior to ordering **ANY** parts, completing **ANY** work, or submitting **ANY** warranty claim for this Service Bulletin.

## AFFECTED MODELS

MODEL YEAR	MODELS	MODEL NUMBERS	VEHICLE IDENTIFICATION NUMBER RANGE
2015	Slingshot	T15AASFAAC / BC / CC	Reference "Unit Inquiry" on the dealer website or the Service Bulletin list on the STOP site to lookup affected units.
	Slingshot SL	T15AAPFAAB / BB / CB	
	Slingshot LE	T15AAPFAAD / BD / CD	
2016	Slingshot	T16AASFAAA / AC / BA / BC / CA / CC	
	Slingshot SL	T16AAPFAAB / AH / AJ / BB / BH / BJ / CB / CH / CJ / EB / EH / EJ	
	Slingshot LE	T16AAPFAAF / AG / AK / BF / BG / BK / CF / CG / CK / EF / EG / EK	
2017	Slingshot	T17AASFAAA / BA / CA	
	Slingshot SL	T17AAPFAAF / AL / BF / BL / CF / CL	
	Slingshot SLR	T17AARFAAE / AM / BE / BM / CE / CM	

## CUSTOMER NOTIFICATION

Dealers are required to review their sales records and make arrangements with customers as needed. In addition to consumer units, dealers are required to correct any affected units in their inventory.

## WARRANTY CLAIM / PARTS INFORMATION

A single group claim may be submitted listing the complete (17-digit) Vehicle Identification Number for machines with the same model number. File claim type **SB (Service Bulletin)**. Do **NOT** put more than one model number on a claim.

<b>SERVICE BULLETIN #</b>	T-16-04
<b>CLAIM TYPE</b>	SB (Service Bulletin)
<b>LABOR ALLOWANCE</b>	0.6 hrs (36 minutes)
<b>PART NUMBER / DESCRIPTION</b>	2207074 (QTY 1) K-SLG, STEERING 7170107 (QTY 1) BULLETIN COMPLETION DECAL
<b>PARTS AVAILABILITY</b>	Available to order
<b>UNIVERSITY OF POLARIS VIDEO TRAINING REQUIREMENT</b>	YES*

\*Polaris requires one person from a dealership to be certified before parts ordering may occur and two people from a dealership to be certified before warranty claims may be processed.

### NOTE

Polaris requires dealers to maintain warranty records, including repair orders and supporting documentation for five years. All claims for additional labor, dealer transport/travel or part stock claims for T-16-04 are subject to audit and inspection. Infractions will result in chargebacks and fines in accordance with the Polaris Audit Policy.

## WARRANTY COVERAGE PERIOD

Warranty coverage for Service Bulletin T-16-04 will begin November 30, 2016. This bulletin expires November 30, 2017.

## DISPOSAL INFORMATION

Under no circumstances shall the parts removed in this repair be re-used, sold, or re-purposed for another application. It is your dealership / distributor's responsibility to make sure every part replaced (related to this bulletin) is taken out of circulation and disposed of properly.

## SERVICE BULLETIN COMPLETION DECAL

A Service Bulletin Completion Decal must be completed for this bulletin repair. Remove the hood and place the decal on an easily visible portion of vehicle. If you require more decals, order them through normal Polaris parts ordering channels.

Sincerely,



Doug Koch  
Technical Service and Warranty Manager

## IMPORTANT

Several steps of this procedure require an audit by another dealership representative other than the technician who is completing the repair. Completing these check backs is a critical component to ensuring the repair has been properly completed. An audit checklist will be provided with each kit. It must be completed and retained with the instruction sign-off and repair order.

### AUDIT CHECKLIST:

- Verify that the Alignment Sleeve is properly installed and mark with a paint pen.
- Verify that the Retaining Nut has been torqued using a torque wrench set to the correct specification and mark with a paint pen. Torque value: **32 ft-lbs (43 Nm)**
- Verify that the Check Gauge **DOES NOT** insert between the EPAS housing machined face and the face of the Steering Yoke. Mark with a paint pen.
- Verify a solid connection of the Intake Hose, Breather Hose and Air Temp Sensor. Verify the air temp sensor line is routed properly and the Intake Hose Clamps were torqued using a torque wrench set to the correct specification. Mark hose clamps and breather hose clamp with a paint pen. Torque value: **35 in-lbs (4 Nm)**
- Verify that the Jam Nut has been torqued using a torque wrench set to the correct specification and mark with a paint pen. Torque value: **60 in-lbs (7 Nm)**
- Verify that the Steering Wheel has no free play and mark steering shaft joint with a paint pen.
- Verify that the Negative Cable Eyelet Nut has been torqued using a torque wrench set to the correct specification and mark with a paint pen. Torque value: **60 in-lbs (7 Nm)**
- Verify that the EPAS Warning Lamp is not illuminated when the key is turned to the "ON" position.

### UNIVERSITY OF POLARIS VIDEO TRAINING REQUIREMENT

Each member of your service department team must watch the training video on University of Polaris prior to completing any work, or submitting ANY warranty claim for this Service Bulletin. You must watch the video through the University of Polaris in order to get credit for watching the video.

[www.universityofpolaris.com](http://www.universityofpolaris.com)

### FEEDBACK FORM

A feedback form has been created for the technician to provide POLARIS with an overall satisfaction rating for the instructions, provide comments on your experience or upload pictures/videos from a specific repair. This feedback form is viewable on a mobile device by scanning the QR code shown or by clicking [HERE](#) if viewing this document electronically.

#### FEEDBACK FORM



## KIT CONTENTS (P/N 2207074)

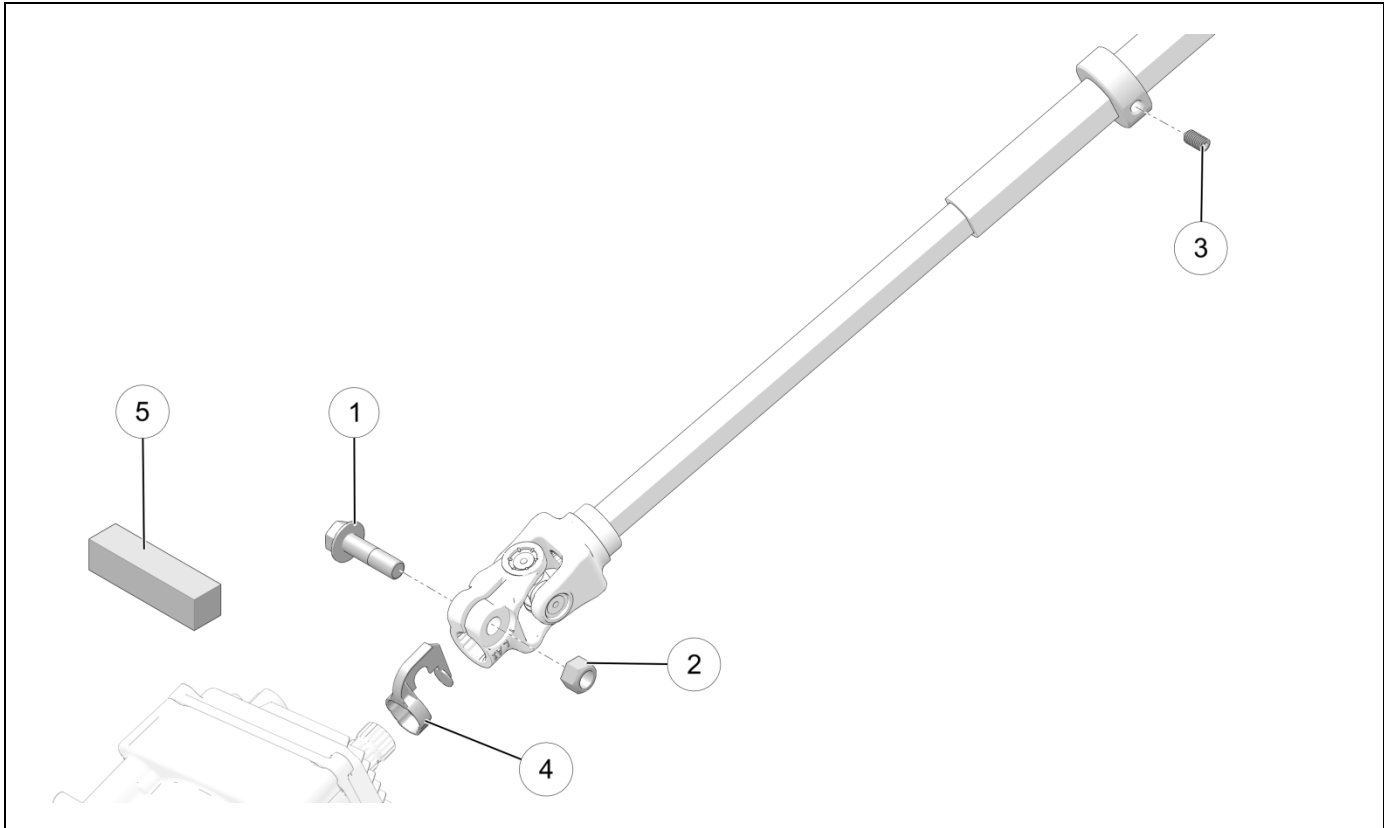

REF	PART DESCRIPTION	PART NUMBER	QTY
①	BOLT	7520722	1
②	NUT	7547039	1
③	SET SCREW	7520517	1
④	ALIGNMENT SLEEVE	5454206	1
⑤	NO-GO CHECK GAUGE	5141363	1
	INSTRUCTIONS (not shown)	9927911	1

## 2207074 - PART PROCEDURE

### STEERING SHAFT PARTS REPLACEMENT PROCEDURE

#### Tools Required:

- 4mm Allen Wrench
- 8mm, 10mm, 13mm, 15mm Socket
- Ratcheting Wrench
- Torque Wrench
- Short extension
- 15 mm open end wrench
- 17 mm open end wrench
- T40 Torx Bit & Driver
- Multi-function Pliers

#### REMOVAL

1. Park vehicle on a flat and level surface. Keep transmission in gear. Engage parking brake. Turn key to "OFF" position and remove from vehicle.
2. Remove the driver's side lower close out panel ① by removing the push rivets ② and T40 fasteners ③. Loosen and disconnect negative battery cable.

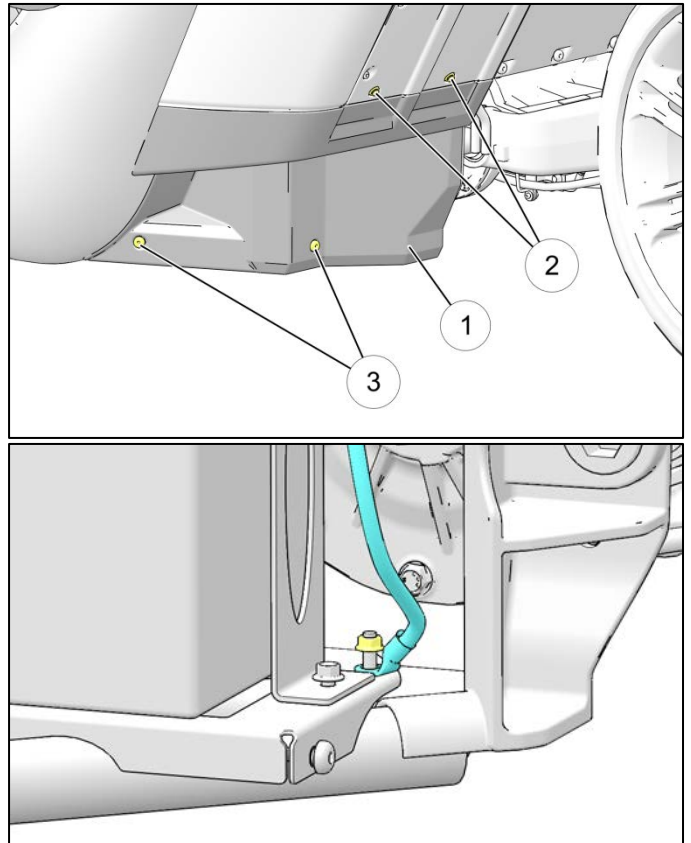

3. Access the jam nut from the footwell area on the driver's side. Remove the jam nut ④ from the steering shaft collar.

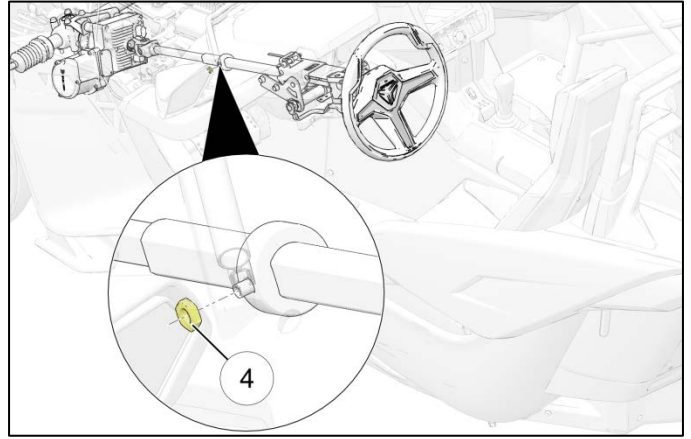

4. Remove set screw ⑤ and **DISCARD**.

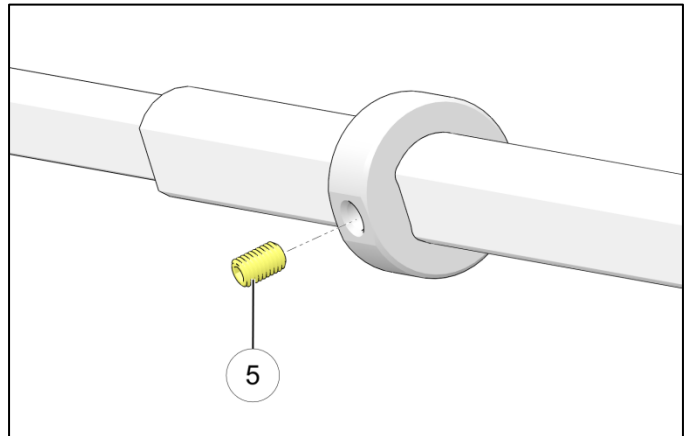

5. Open vehicle hood.

6. **Base and SL Models**

Loosen two hose clamps (6), Disconnect Air Temp Sensor (7) and Breather Hose (8). Remove Intake Hose to allow access to the Steering Shaft Pinch Bolt.

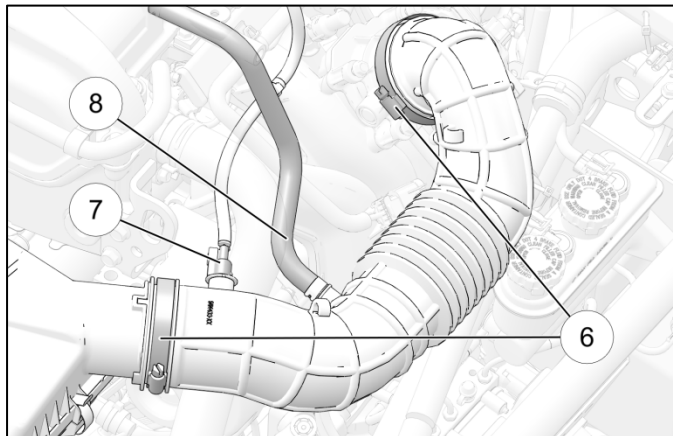

**SLR Models**

Loosen hose clamp (6), Disconnect Air Temp Sensor (7) and Breather Hose (8). Remove the fastener retaining the Intake Tube to the frame and the nut retaining the Air Filter to the frame. Remove Intake assembly to allow access to the Steering Shaft Pinch Bolt.

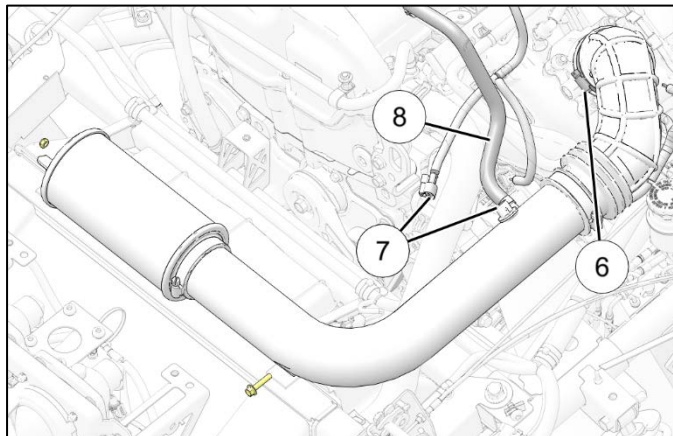

7. Cover Intake (9) to prevent debris from entering the engine.

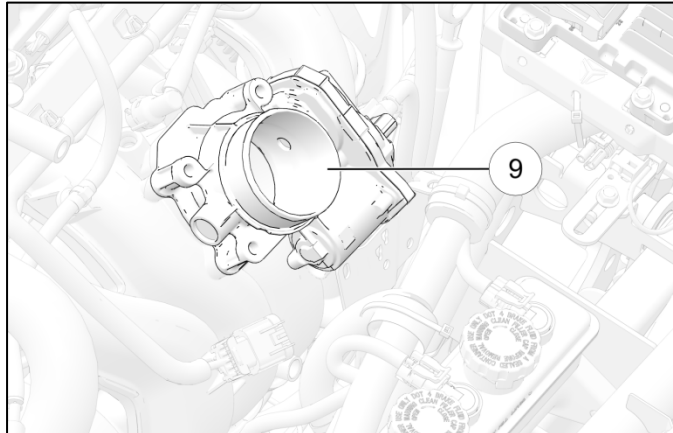

8. Position the steering wheel to align the wheels facing straight forward. Locate the steering shaft and pinch bolt from the driver side of the vehicle.

**NOTE**

For ease of access, orient the pinch bolt on top of steering shaft horizontally; adjust the steering wheel as needed.

**IMPORTANT**

Use a paint pen to mark clocking of the steering shaft to the EPAS shaft for reassembly.

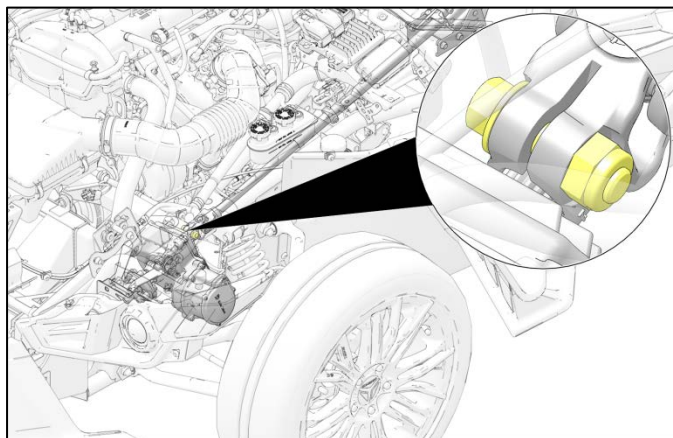

9. Disconnect EPAS electrical connector ⑩.

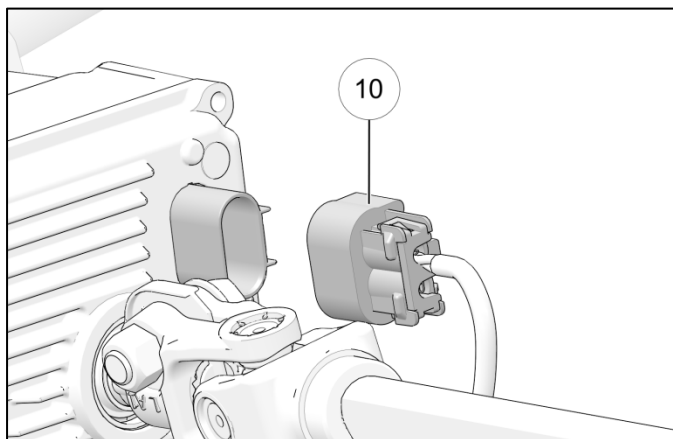

10. Remove the Pinch Bolt ⑪ and Nut ⑫ from the Steering Shaft and **DISCARD**.

**CAUTION**

Use care when loosening and removing Pinch Bolt and Retaining Nut to avoid damaging the brake lines.

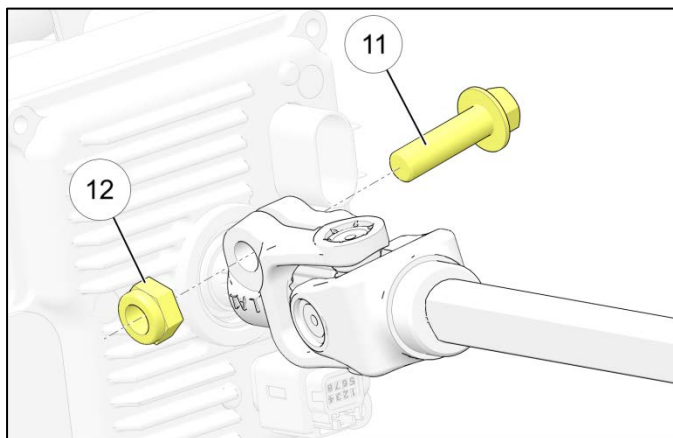



11. Slide Steering Shaft yoke up and off the EPAS shaft.

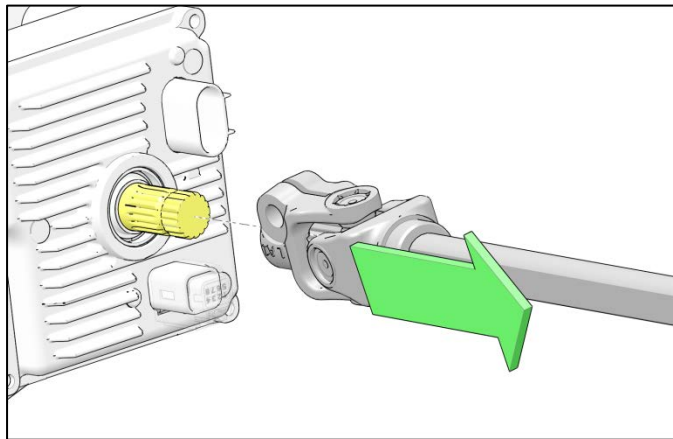

## INSTALLATION

1. Install alignment sleeve onto EPAS shaft until sleeve stop contacts the end of the EPAS shaft as shown.

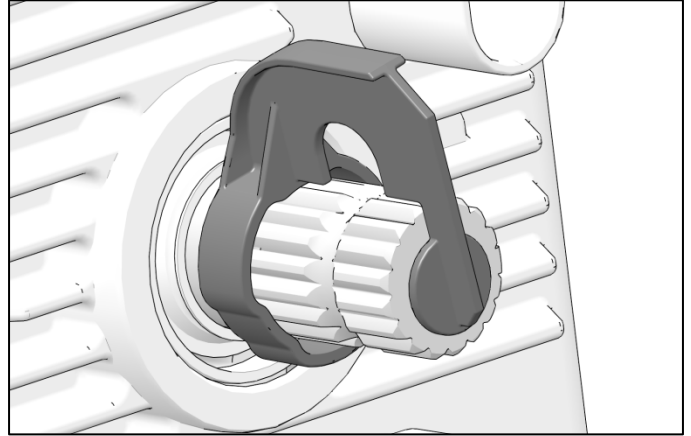

2. Align steering shaft yoke to alignment sleeve and install steering shaft yoke onto EPAS shaft until bottomed against alignment sleeve.

### NOTE

Align yoke to paint mark to ensure correct steering wheel clock orientation.

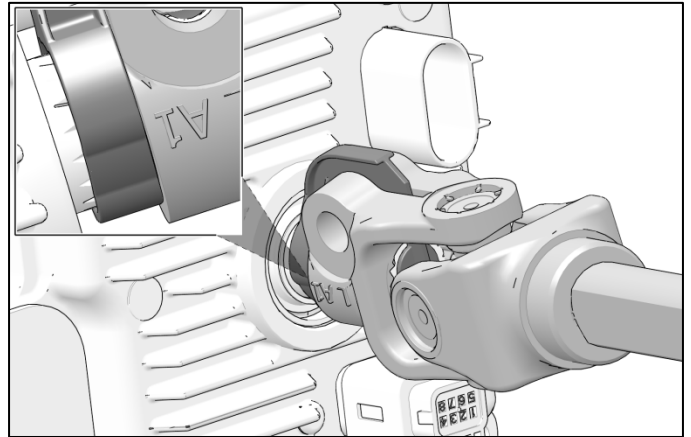

3. Install new Pinch Bolt (12) and Retaining Nut (13). Torque Retaining Nut to specification.

### TORQUE

Retaining Nut:  
32 ft-lbs (43 Nm)

### CAUTION

Bolt should install freely when properly aligned to the bolt retention groove in the EPAS shaft. **DO NOT** force bolt into the yoke.

Use care when tightening Retaining Nut to avoid damaging the brake lines.

### IMPORTANT – AUDIT STEP

A secondary dealer representative must verify that the alignment sleeve is properly installed. Mark the alignment sleeve with a paint pen.

### IMPORTANT – AUDIT STEP

A secondary dealer representative must verify that the Retaining Nut was torqued using a torque wrench set to the correct specification. Mark the nut with a paint pen to indicate the audit has been completed.

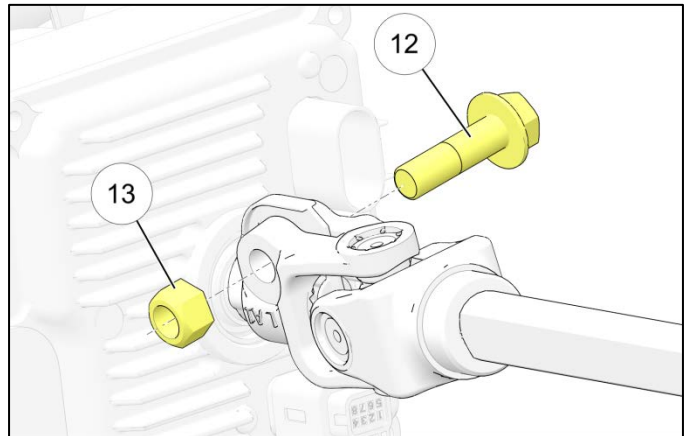

4. To verify that the steering shaft is in proper alignment, attempt to insert the NO-GO Check Gauge in between the EPAS housing machined face and the face of the Steering Yoke as shown.

### IMPORTANT

- If the Check Gauge **DOES NOT** insert between the EPAS housing machined face and the face of the Steering Yoke, continue to the next step.
- If the NO-GO Check Gauge **DOES** insert between the EPAS housing machined face and the face of the Steering Yoke, remove the steering shaft and start over at step 1 of the Installation procedure.

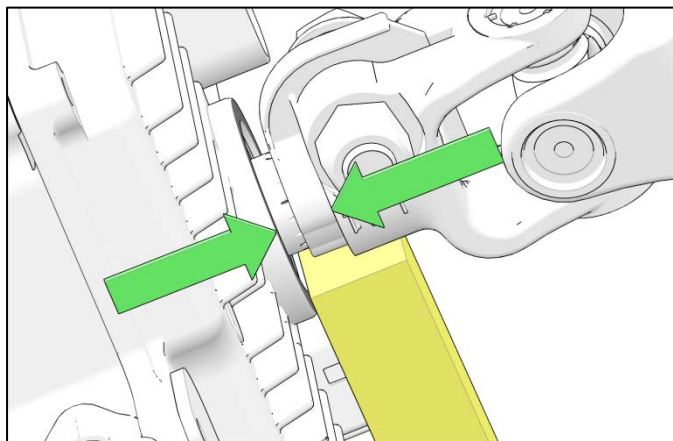

### IMPORTANT – AUDIT STEP

A secondary dealer representative must verify that the Check Gauge **DOES NOT** insert between the EPAS housing machined face and the face of the Steering Yoke. Mark the Steering Yoke with a paint pen to indicate the audit has been completed.

5. Turn steering wheel to point to wheels straight forward. Confirm that the steering wheel is correctly aligned to match the wheels.

### NOTE

If the steering wheel and wheels are not properly aligned, return to step 2 of the installation procedure to properly align shaft markings.

6. Connect EPAS electrical connector ⑪.

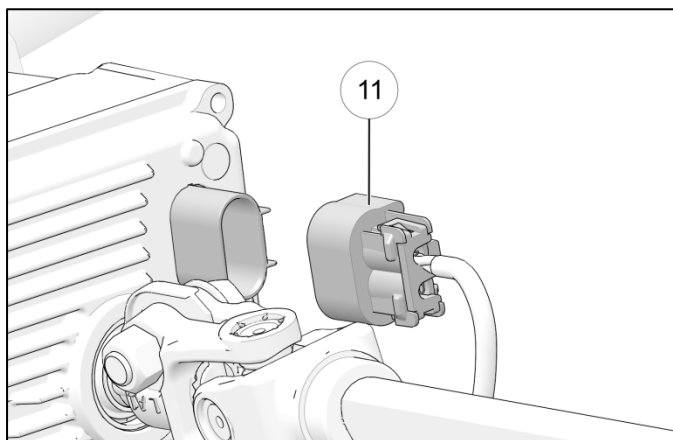

7. Uncover the engine intake ⑩.

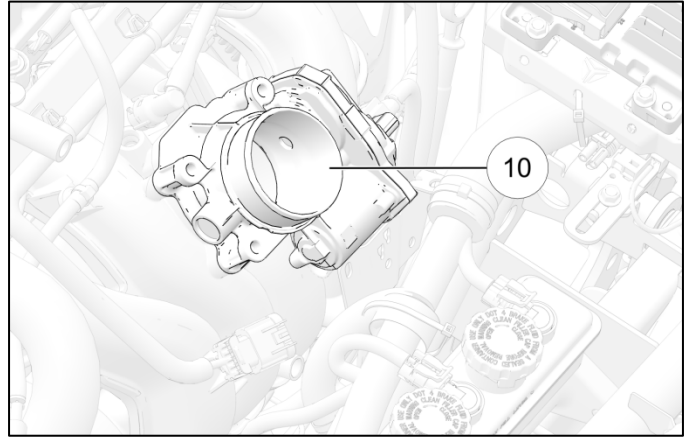

8. **Base and SL Models**

Reinstall Intake Hose. Connect two hose clamps ⑨, and breather hose ⑧. Torque hose clamps to specification.

**TORQUE**

Intake Hose Clamps:  
**35 in-lbs (4 Nm)**

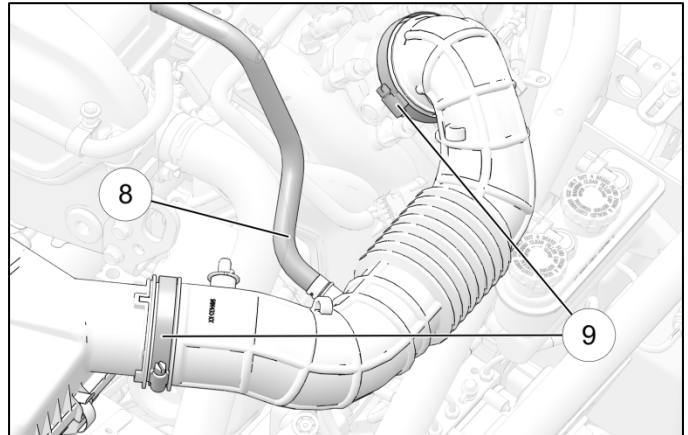

**SLR Models**

Reinstall Intake assembly. Connect hose clamp ⑨, and breather hose ⑧. Install the fastener retaining the Intake Tube to the frame and the nut retaining the Air Filter to the frame. Torque hose clamp, nut, and fastener to specification.

**TORQUE**

Intake Hose Clamp:  
**35 in-lbs (4 Nm)**

Air Filter Nut:  
**40 in-lbs (4 Nm)**

Intake Tube Fastener:  
**8 ft-lbs (11 Nm)**

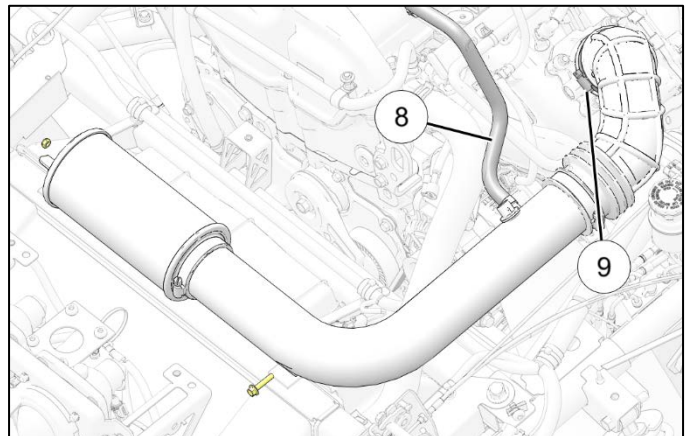

9. Connect air temp sensor ⑦.

**NOTE**

Make sure the air temp sensor is properly routed as shown and is properly secured ⑥.

**IMPORTANT – AUDIT STEP**

A secondary dealer representative must verify a solid connection of the Intake Hose, Breather Hose and Air Temp Sensor. Verify the air temp sensor line is routed properly and the Intake Hose Clamps have been torqued using a torque wrench set to the correct specification. Mark hose clamps and breather hose clamp with a paint pen to indicate the audit has been completed.

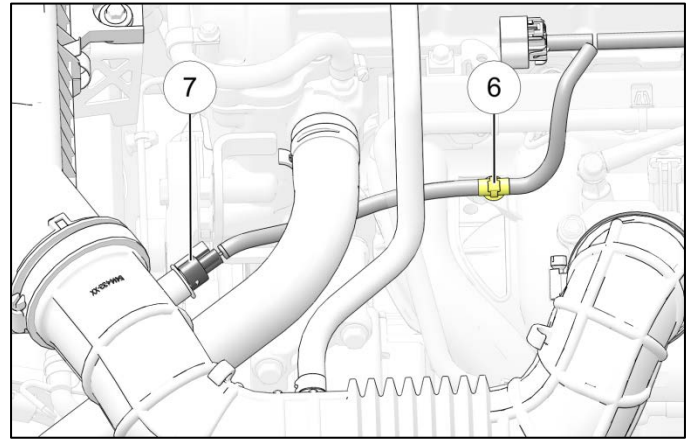

**Base and SL Models**

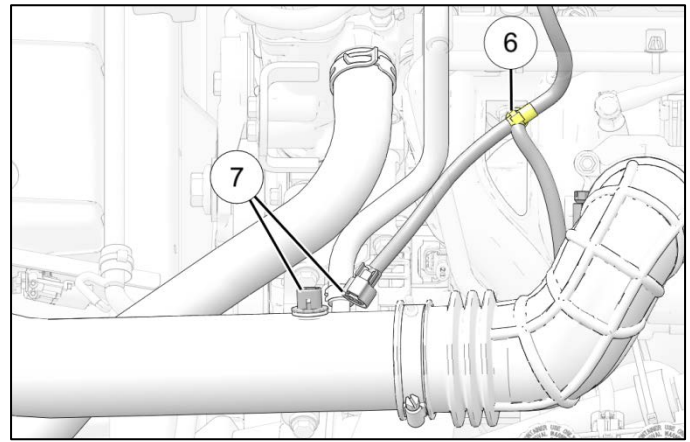

**SLR Models**

10. Loosely install new Set Screw ⑤.

**NOTE**

Rotate steering wheel to allow access to install Set Screw and Retaining Nut as required.

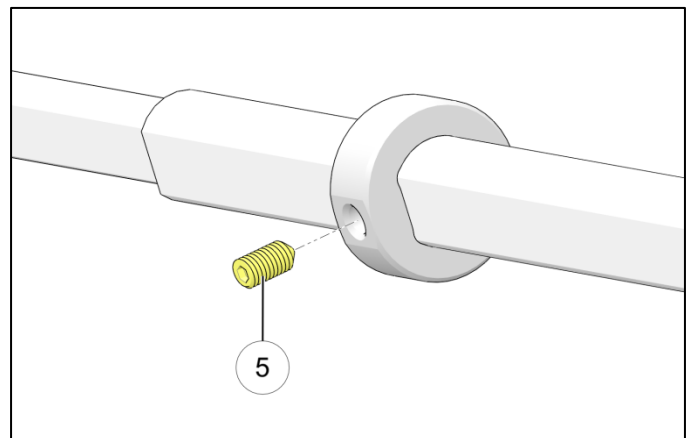

**IMPORTANT**

Make sure the NEW **Tapered Design** set screw is being installed.

**Flat Nosed Design**



**Tapered Design**

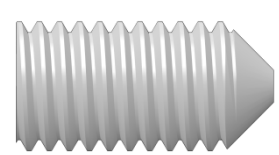

11. Have an assistant slightly move the steering wheel back and forth. Place one hand on the joint where the inner and outer steering shafts meet to feel for free play. Continue to tighten the set screw until the free play between the inner and outer steering shafts is gone.

**NOTE**

This step will require the help of an assistant.

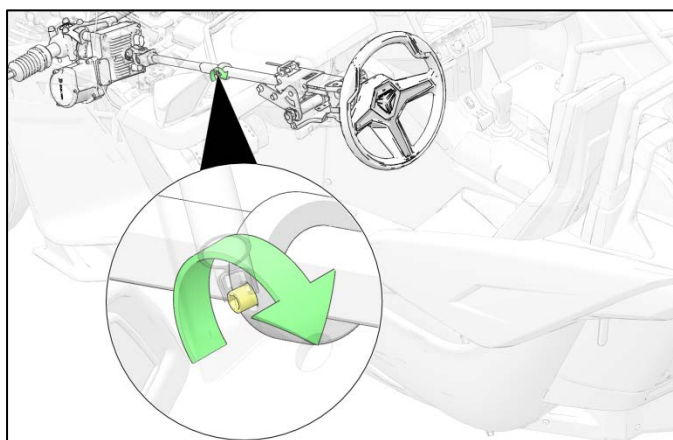
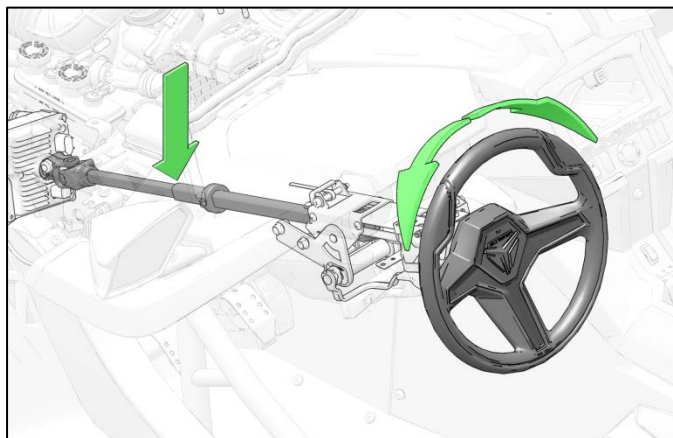

12. Tighten the set screw an additional 20°.

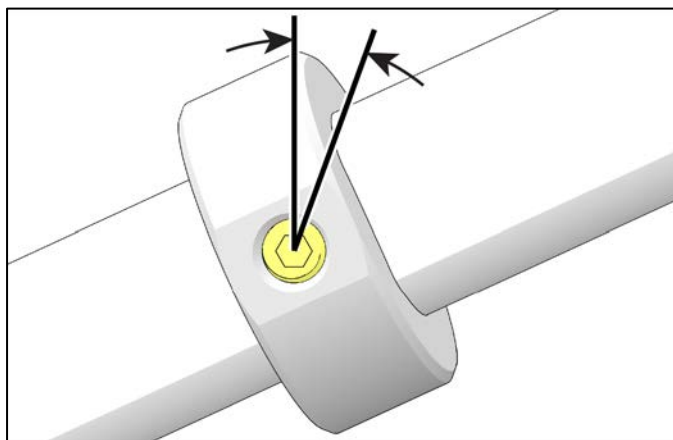

13. Reinstall jam nut ④ and torque to specification.

### TORQUE

Steering Shaft Jam Nut:  
**60 in-lbs (7 Nm)**

### IMPORTANT – AUDIT STEP

A secondary dealer representative must verify that the Jam Nut has been torqued using a torque wrench set to the correct specification. Mark the jam nut with a paint pen to indicate the audit has been completed.

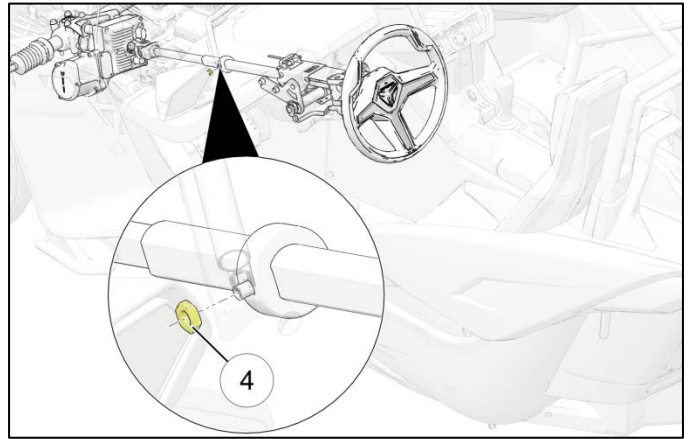

14. Confirm that no free play is felt at the steering wheel.

### IMPORTANT – AUDIT STEP

A secondary dealer representative must confirm the steering wheel has no free play. Mark the steering shaft joint with a paint pen to indicate the audit has been completed.

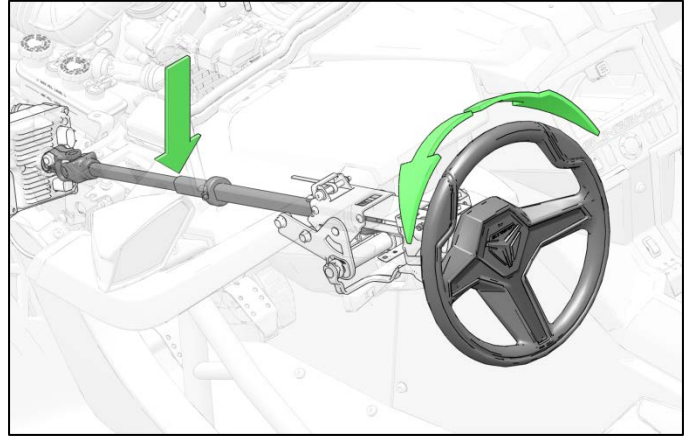

15. Turn steering wheel full lock counter clockwise and clockwise to confirm a full range of travel.

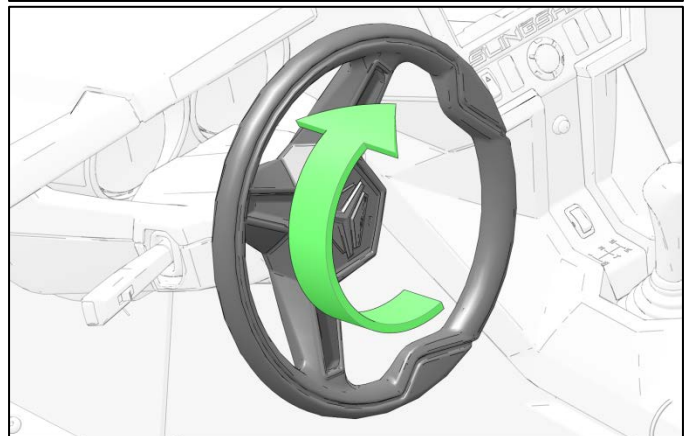
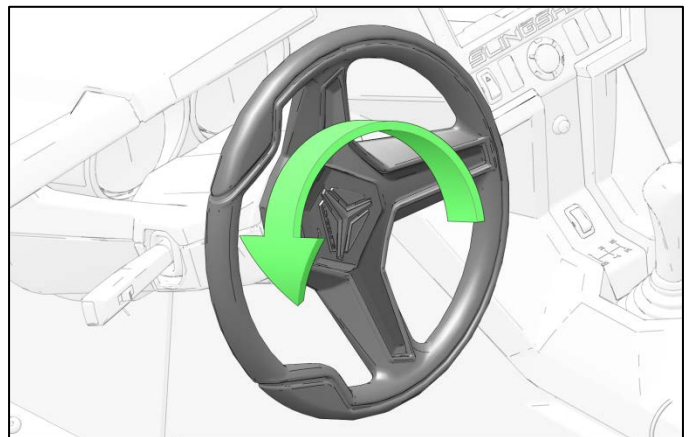

16. Connect ground (negative) cable eyelet to chassis stud.  
Torque to specification.

### TORQUE

Negative Cable Eyelet Nut:  
**60 in-lbs (7 Nm)**

### IMPORTANT – AUDIT STEP

A secondary dealer representative must confirm that the Negative Cable Eyelet Nut has been torqued using a torque wrench set to the correct specification. Mark the Nut with a paint pen to indicate the audit has been completed.

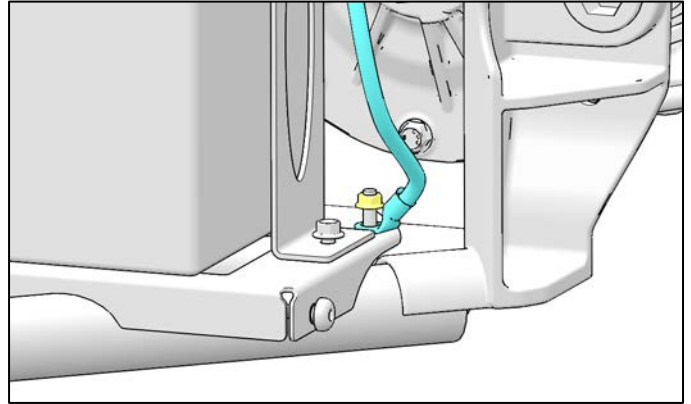

17. Install the driver's side lower close out panel (1) by installing the push rivets (2) and T40 fasteners (3).  
Torque fasteners to specification.

### TORQUE

Rear Body Panel Fasteners:  
**36 in-lbs (4 Nm)**

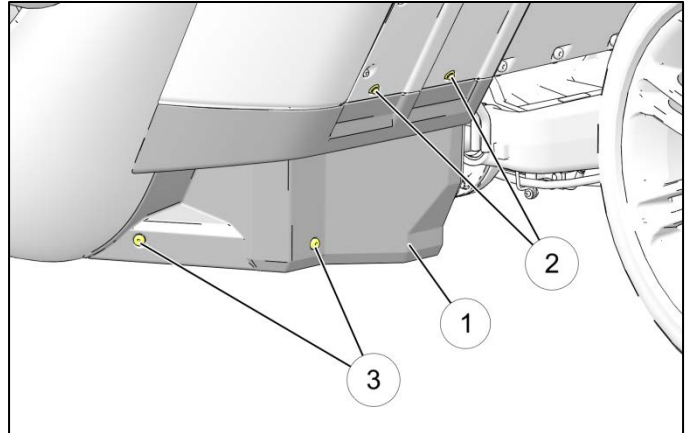

18. Turn the key to "ON" position and allow gauges to power up (wait 1 second after key ON). Look at the Tachometer display and confirm that the EPAS Warning Lamp symbol is **NOT** illuminated.

### IMPORTANT – AUDIT STEP

A secondary dealer representative must confirm that the EPAS Warning Lamp is not illuminated when the key is turned to the "ON" position.

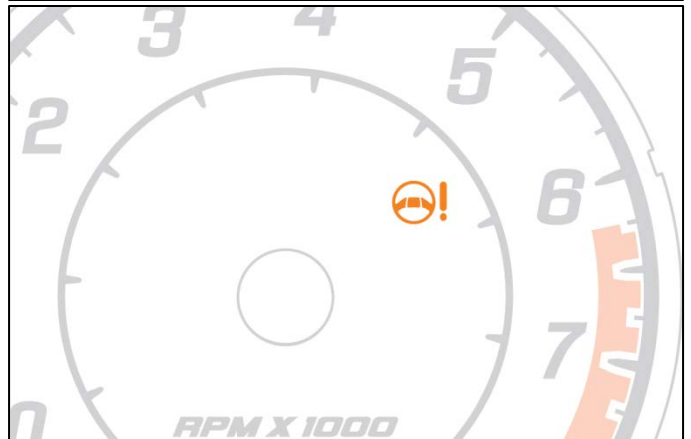

19. Install a completed Service Bulletin Completion Decal (7170107). Close the vehicle's hood.

