



NUMBER: 23-021-16 REV. A

GROUP: Body

DATE: June 15, 2016

This bulletin is supplied as technical information only and is not an authorization for repair. No part of this publication may be reproduced, stored in a retrieval system, or transmitted, in any form or by any means, electronic, mechanical, photocopying, or otherwise, without written permission of FCA US LLC.

THIS BULLETIN SUPERSEDES SERVICE BULLETIN 23-021-16, DATED MAY 26, 2016, WHICH SHOULD BE REMOVED FROM YOUR FILES. ALL REVISIONS ARE HIGHLIGHTED WITH **ASTERISKS**** AND INCLUDE AN ADDITIONAL REPAIR PROCEDURE STEP.**

SUBJECT:

Power Windows Work Intermittently

OVERVIEW:

This bulletin involves installing water shields, door harnesses and door modules due to water shorting the door module and possibly causing corrosion.

MODELS:

2015 (ZD) Dodge Viper

NOTE: This bulletin applies to vehicles within the following markets/countries: NAFTA and Middle East.

NOTE: This bulletin applies to vehicles built on or before February 11, 2016 (MDH 0211XX).

SYMPTOM/CONDITION:

Customers may experience intermittent loss of power window operation.

DIAGNOSIS:

If the customer describes the symptom/condition listed above, perform the Repair Procedure.

PARTS REQUIRED:

Qty.	Part No.	Description
1	05035333AB	Door Module Water Shield - Left
1	05035332AB	Door Module Water Shield - Right
1	05043059AB	Wiring, Front Door - Left
1	05043058AB	Wiring, Front Door - Right

PARTS REQUIRED - Continued:

Qty.	Part No.	Description
1	05035187AF	Module, Door - Left
1	05035186AF	Module, Door - Right
1	56020329	Foam Tape

REPAIR PROCEDURE:

CAUTION: Be careful to not damage door air bag (If Equipped).

NOTE: Right door shown, left door similar.

1. Remove the front hinge cover. Refer to the detailed service procedures available in DealerCONNECT> TechCONNECT under: Service Info> 23 - Body/Door - Front/Cover, Hinge/Removal.
2. Remove door panel. Refer to the detailed service procedures available in DealerCONNECT> TechCONNECT under: Service Info> 23 - Body/Door - Front/Panel, Door Trim/Removal.
3. Remove and discard door module. Refer to the detailed service procedures available in DealerCONNECT> TechCONNECT under: Service Info> 08 - Electrical/8E - Electronic Control Modules/Module, Door/Removal.
4. Remove and discard existing door module water shield (If Equipped).
5. Disconnect all remaining electrical connectors from door harness.
6. Remove door harness from door (Fig. 1).

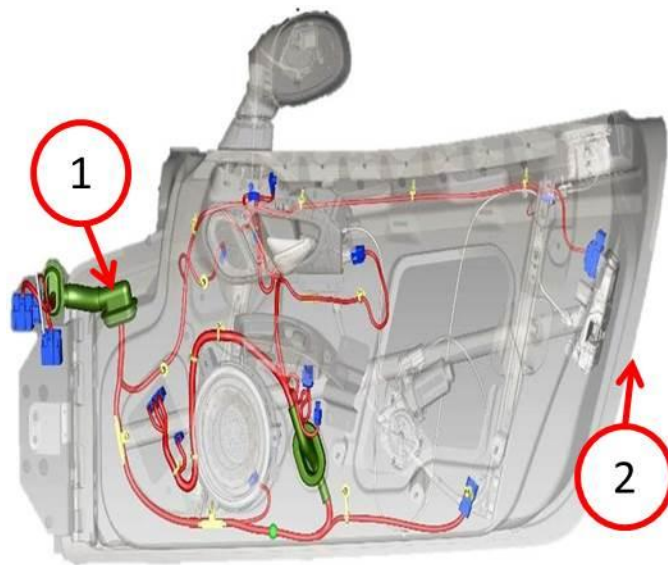

Fig. 1 Door Harness

1 - Door Harness

2 - Door

7. Disconnect the three electrical connectors at A pillar ([Fig. 2](#)).

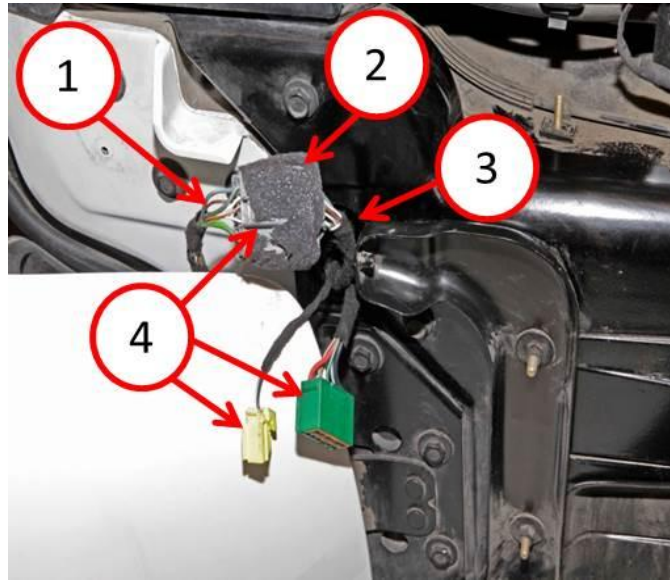

Fig. 2 A Pillar Connectors

- 1 - Door Harness
- 2 - Foam Tape
- 3 - A Pillar Opening
- 4 - Electrical Connectors

-
8. Remove door harness from vehicle and discard.
 9. Install new door harness on vehicle.
 10. Connect the three electrical connectors to door harness ([Fig. 2](#)).
 11. Install new foam tape on the three electrical connectors and push electrical connectors into A pillar opening ([Fig. 2](#)).
 12. Separate the door water shield from the module water shield with protective liner ([Fig. 3](#)).
 13. Remove and discard the water shield protective liner exposing butyl ([Fig. 3](#)).



Fig. 3 Water Shield

- 1 - Module Shield
 - 2 - Protective Liner
 - 3 - Door Water Shield
-

14. Install the door water shield to the door panel opening (Fig. 4).



Fig. 4 Door Water Shield

- 1 - Water Shield
 - 2 - Door Panel Opening
-

15. Install new door module with two screws (Fig. 5). Tighten the screws securely.

16. Connect the four door module electrical connectors (Fig. 5).

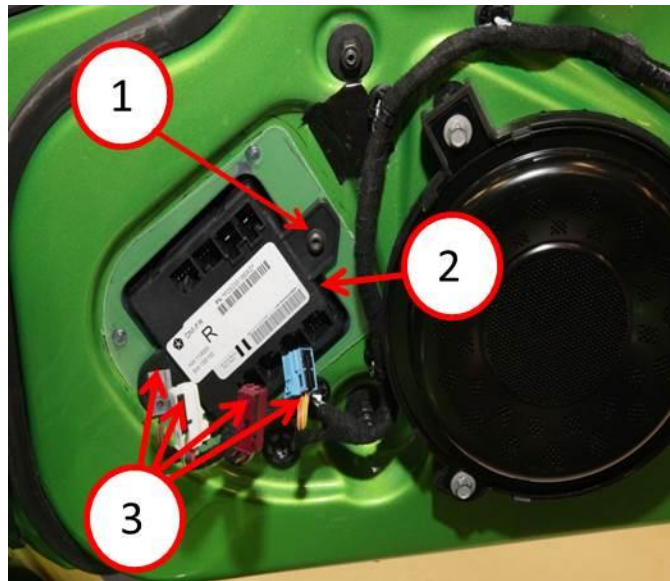

Fig. 5 Water Shield And Module

1 - Screw

2 - Module

3 - Connectors

17. Install the module water shield over the door module by pushing butyl firmly onto the door panel (Fig. 6).

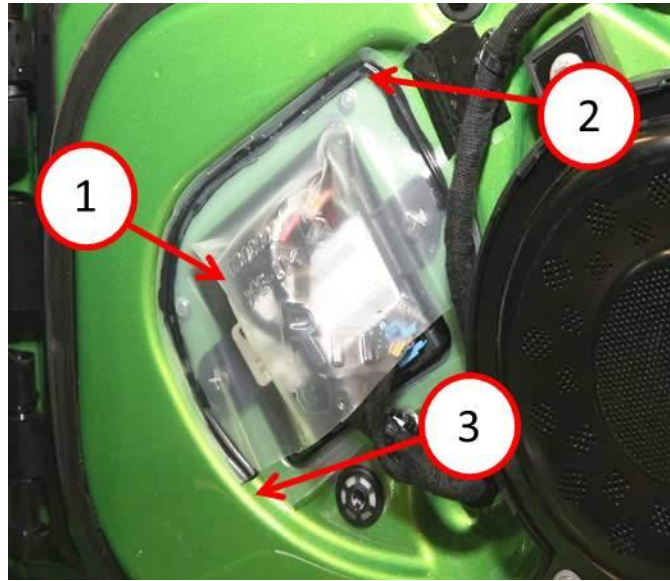

Fig. 6 Module Water Shield

- 1 - Module Water Shield
- 2 - Butyl
- 3 - Door Panel

-
18. Install the door panel. Refer to the detailed service procedures available in DealerCONNECT> TechCONNECT under: Service Info> 23 - Body/Door - Front/Panel, Door Trim/Installation.
 19. Install the front hinge cover. Refer to the detailed service procedures available in DealerCONNECT> TechCONNECT under: Service Info> 23 - Body/Door - Front/Cover, Hinge/Installation.

NOTE: **All doors must be completely closed before programming door module.

20. Program the door module. Refer to the detailed service procedures available in DealerCONNECT> TechCONNECT under: Service Info> 08 - Electrical/8E - Electronic Control Modules/Module, Door/Module Programming.**

POLICY:

Reimbursable within the provisions of the warranty.

TIME ALLOWANCE:

Labor Operation No:	Description	Skill Category	Amount
08-19-14-90	Replace Left & Right Front Door Control Modules, Door Wiring Harnesses and Install Water Shields (2 - Skilled)	6 - Electrical and Body Systems	3.4 Hrs.

FAILURE CODE:

ZZ	Service Action
----	----------------