

# Front License Plate & Mounting Bracket Installation

**Service Category** General

**Section** Pre-Delivery Service

**Market** USA

Lexus Supports  
ASE Certification 

## Applicability

YEAR(S)	MODEL(S)	ADDITIONAL INFORMATION
2017	RC F, RC200T, RC300, RC350	

## Introduction

The front license plate mounting bracket and 2 self-tapping screws for the 2017 model year RC 200t/300/350/F are placed in the luggage compartment of the vehicle at the assembly plant. For states that require a front license plate, install the bracket and bolts on the bumper cover during Pre-Delivery Service (PDS) according to the following procedure.

The RC 200t/300/350 (non-F Sport) models share the same installation procedure. The F Sport and F models require a different procedure (see page 4).

## Warranty Information

OP CODE	DESCRIPTION	TIME	OFF	T1	T2
N/A	Not Applicable to Warranty	–	–	–	–

## Front License Plate & Mounting Bracket Installation

### Installation Procedure for RC 200t/300/350 (non-F Sport)

1. Align holes "A" of the mounting bracket with the dimples on the front bumper cover.

**HINT**

- Holes "A" are used to install the front mounting bracket to the bumper cover.
- Holes "B" are used to install the front license plate to the mounting bracket.

**NOTICE**

Do NOT drill into the dimples on the radiator grill.

**Figure 1.**

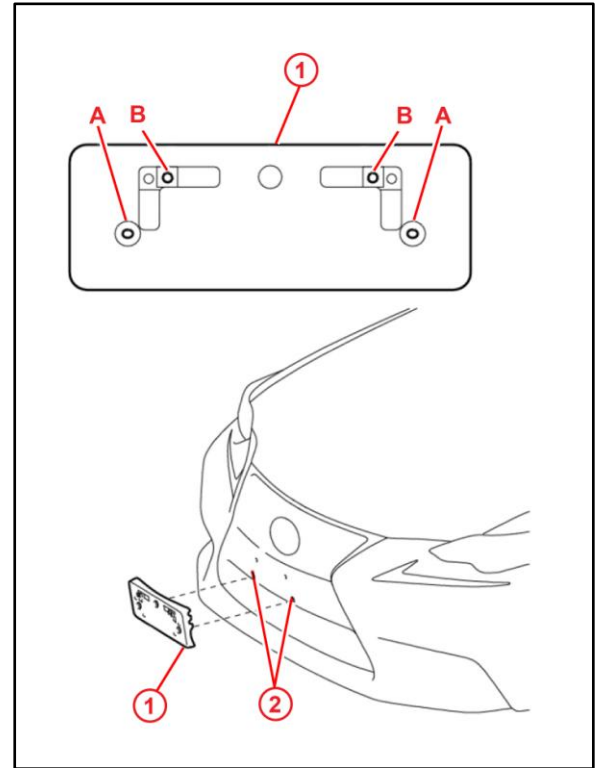

1	Mounting Bracket
2	Dimples

2. Install the mounting bracket to the front bumper cover at holes "A" using the 2 supplied self-tapping screws.

**NOTICE**

Do NOT over-tighten the self-tapping screws.

**Figure 2.**

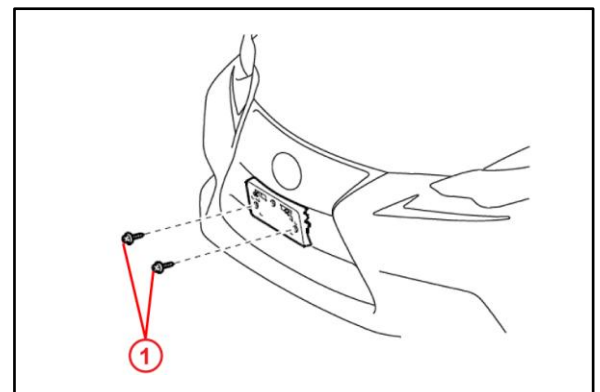

1	Self-Tapping Screws
---	---------------------

## Front License Plate & Mounting Bracket Installation

### Installation Procedure for RC 200t/300/350 (non-F Sport) (Continued)

3. Install the front license plate to the mounting bracket at holes "B" using 2 non-corroding bolts with the following dimensions:

**Nominal Length: 10.0 mm (0.39 in.)**

**Diameter: 6.0 mm (0.24 in.)**

**Figure 3.**

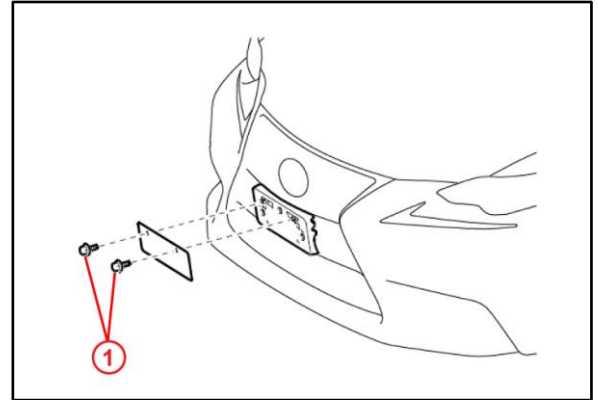

<b>1</b>	<b>Bolts</b>
----------	--------------

**Figure 4.**

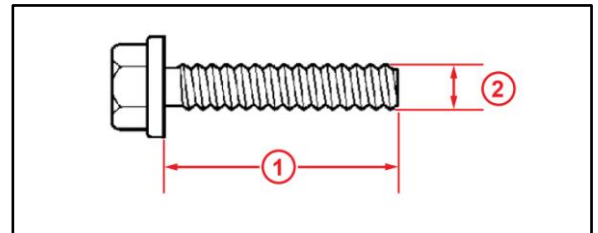

<b>1</b>	<b>Nominal Length</b>
<b>2</b>	<b>Diameter</b>

## Front License Plate & Mounting Bracket Installation

### Installation Procedure for F SPORT and RC F Models

1. Align holes "A" of the mounting bracket with the dimples (F Sport) or clips (RC F) on the radiator grill.

**NOTICE**

Do NOT drill into the dimples/clips on the radiator grill.

**HINT**

- Holes "A" are used to install the mounting bracket to the radiator grill.
- Holes "B" are used to install the front license plate to the mounting bracket.

2. Install the mounting bracket to the radiator grill using 2 self-tapping screws.

**NOTICE**

Do NOT over-tighten the self-tapping screws.

Figure 5.

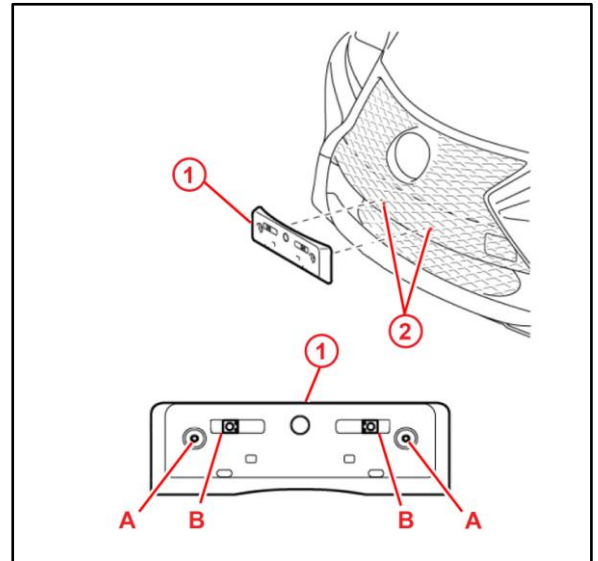

1	Mounting Bracket
2	Dimples (F Sport) Clips (RC F)

Figure 6.

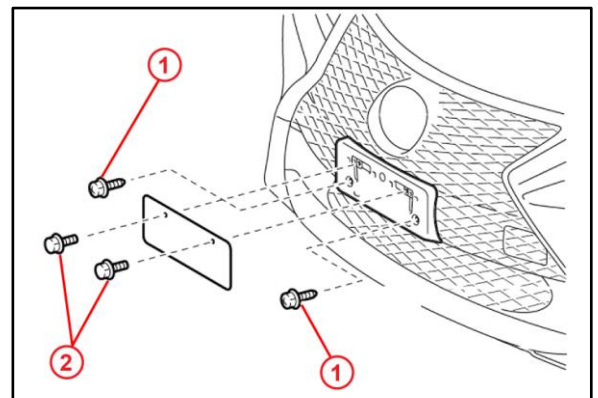

1	Self-Tapping Screws
2	Bolts

## Front License Plate & Mounting Bracket Installation

### Installation Procedure for F SPORT and RC F Models (Continued)

3. Install the front license plate to the mounting bracket using the 2 non-corroding bolts with the following dimensions:

**Nominal Length: 10.0 mm (0.39 in.)**

**Diameter: 6.0 mm (0.24 in.)**

**Figure 7.**

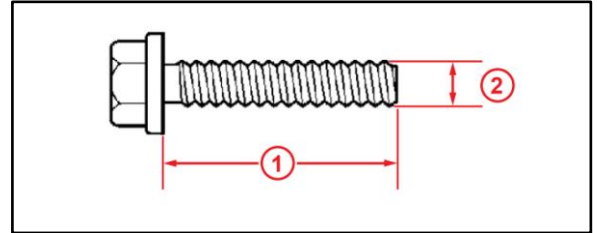

<b>1</b>	Nominal Length
<b>2</b>	Diameter