

For questions, comments, or to submit an inquiry, go to:
DDCSN.com > [Warranty](#) > [Warranty Applications](#) > [Inquiries](#) > [Submit an Inquiry](#)

Please distribute to:
Dealer Principal, Warranty Manager, Service Manager, Parts Manager, Sales Manager

- | | | |
|--|---|---|
| <input checked="" type="checkbox"/> Freightliner Dealers | <input checked="" type="checkbox"/> Thomas Built Bus Dealers | <input type="checkbox"/> Sales Terms (DTR) |
| <input checked="" type="checkbox"/> Western Star Dealers | <input checked="" type="checkbox"/> Direct Warranty Customers | <input checked="" type="checkbox"/> Used Product (DTR) |
| <input checked="" type="checkbox"/> Sterling Dealers | <input checked="" type="checkbox"/> Export | <input type="checkbox"/> Travel Centers of America/Petro:Lube |
| <input checked="" type="checkbox"/> FCCC Dealers | <input checked="" type="checkbox"/> DDC Distributors | |

IMPORTANT WARRANTY INFORMATION

REF **16-011**
 Effective 04/01/2016
 Release 03/28/2016
 SUBJECT New Detroit Camshaft Housing Seal Standard Repair Time

❖ **Overview**

In collaboration with the Warranty Joint Application Development (JAD) committee and to further support the service network and streamline the claims submittal process, DTNA is pleased to announce the creation of a new Standard Repair Time (SRT) for a Detroit Camshaft Housing Seal Replacement. Detroit created SRT 017010 to replace the Consolidated Labor Operation (CLO) #017010, which was released in Detroit Warranty Operation letter 14WO3.

❖ **New Labor Operation**

Detroit Labor Operation	
Labor Code	Description
017010	Camshaft Housing Seal Replacement/Assembly R&R

❖ **SRT Guidelines**

Effective for repair orders opened on or after April 1, 2016, CLO #017010 will no longer be active. SRT 017010 must be used for all camshaft housing seal repairs performed on engines installed in a chassis with a bumper to back of cab (BBC) distance *greater than or equal to 120 inches*. With a supporting narrative, in addition to SRT 017010, other labor operations may be claimed for tasks such as accessing components (e.g., bumper and rain tray) and/or repair validation.

The table below identifies common DTNA makes and models with a BBC distance greater than or equal to 120 inches.

Equipment Make	Equipment Model
Freightliner	Cascadia 125/SLPR/Class 8/Class 7
Freightliner	Coronado 122/132/Class 8/Class 7
Freightliner	Argosy/Class 8
Freightliner	CST 120
Freightliner	Columbia 120
Western Star	4800
Western Star	4900
Western Star	6900

IMPORTANT WARRANTY INFORMATION LETTER

Verify latest version online: [Warranty Operation Letters](#) are available at DDCSN.com > [Literature](#) > [Service Letters/Bulletins](#) > [Warranty Operations](#)

DISCLAIMER: The information contained in this letter supersedes and supplements any related policies and procedures in the Warranty Manual and/or previously released letters. Failure to read or distribute this letter will not exempt addressees from compliance with the information contained herein.

For questions, comments, or to submit an inquiry, go to:
DDCSN.com > [Warranty](#) > [Warranty Applications](#) > [Inquiries](#) > [Submit an Inquiry](#)

13400 Outer Drive West
 Detroit, MI 48239-4001

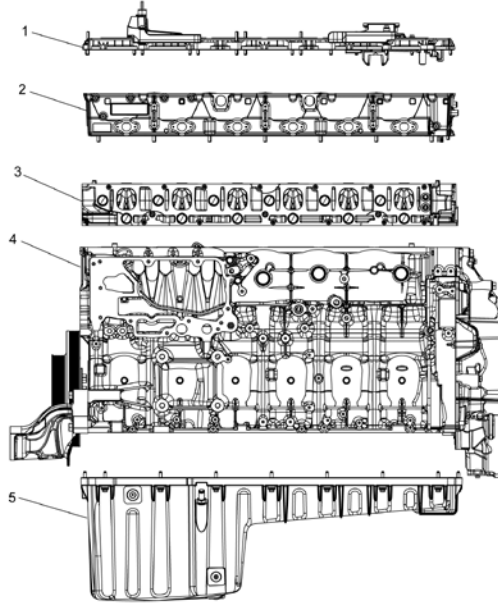

1.	Rocker Cover
2.	Camshaft Housing
3.	Cylinder Head
4.	Cylinder Block
5.	Oil Pan

❖ **New Camshaft Housing Seal SRT**

SRT Code	Description
017010	Camshaft Housing Seal Replacement/Assembly R&R
Summary: Includes removing and installing the camshaft housing assembly. The release of SIB 3 33-14 simplified the repair procedure so removing and installing the exhaust rocker arms assembly, intake rocker arm assembly, or the camshafts are no longer required.	

❖ **Units With BBC Distance Less Than 120 Inches**

Please note that camshaft housing seal leaks on units with a BBC distance *less than 120 inches* should continue to use the SRT below for camshaft housing seal repairs.

Labor Code	Description
017101	Camshaft Housing Seal Replacement/Assembly R&R

Some examples of chassis with a BBC distance less than 120 inches include:

Equipment Make	Equipment Model
Freightliner	Cascadia 113/SLPR/Class 8/Class 7
Freightliner	M2
Western Star	4700
Non-Captive Chassis	Pierce, MCI, Oshkosh, Terex, etc.

Repair times vary by chassis model and engine service model; please refer to the applicable Labor Time Guides (LTG) for appropriate times and included labor operations. The new SRT is available in the applicable LTG as well as at www.ddcsn.com > [Warranty](#) > [Warranty Applications](#) > [Warranty System](#) > [Labor](#) > [SRTs](#) > [SRT Search](#). Any questions regarding SRTs may be addressed through the [Warranty Support Center](#) > [Detroit Inquiries](#).

IMPORTANT WARRANTY INFORMATION LETTER

Verify latest version online: [Warranty Operation Letters](#) are available at DDCSN.com > [Literature](#) > [Service Letters/Bulletins](#) > [Warranty Operations](#)

DISCLAIMER: The information contained in this letter supersedes and supplements any related policies and procedures in the [Warranty Manual](#) and/or previously released letters. Failure to read or distribute this letter will not exempt addressees from compliance with the information contained herein.