



NUMBER: 23-040-16

GROUP: Body

DATE: August 30, 2016

This bulletin is supplied as technical information only and is not an authorization for repair. No part of this publication may be reproduced, stored in a retrieval system, or transmitted, in any form or by any means, electronic, mechanical, photocopying, or otherwise, without written permission of FCA US LLC.

SUBJECT:

Liftgate Tail Lamps Underflush To The Body Mounted Tail Lamps

OVERVIEW:

This bulletin involves adding washers behind the liftgate tail lamps to bring them flush to the body mounted tail lamps.

MODELS:

2015 - 2016 (KL) Jeep Cherokee

NOTE: This bulletin applies to vehicles within the following markets/countries:
NAFTA.

NOTE: This bulletin applies to vehicles built on or before December 22, 2015 (MDH 1222XX) or if the lift gate mounted tail lamps have part numbers 68102920AC and 68102921AC.

NOTE: This procedure does not apply to vehicles with lift gate mounted tail lamps with part numbers 68330344AA and 68330345AA.

SYMPTOM/CONDITION:

Liftgate tail lamps look underflush to body mounted tail lamps (Fig. 1).



Fig. 1 Underflush Tail Lamp

DIAGNOSIS:

If the customer describes the symptom/condition listed above, perform the Repair Procedure.

PARTS REQUIRED:

Qty.	Part No.	Description
4	05020548AA	Washers (2 per tail lamp)

REPAIR PROCEDURE:

1. Remove lift gate mounted inner tail lamps. Refer to the detailed service procedures available in DealerCONNECT> TechCONNECT under: Service Info>08 - Electrical/8L - Lamps and Lighting/Lamps/Lighting - Exterior/Lamp, Tail Stop Turn/Removal>Lamp>Inner.

2. Add 1 washer to each outboard stud of the lift gate mounted tail lamps (Fig. 2).

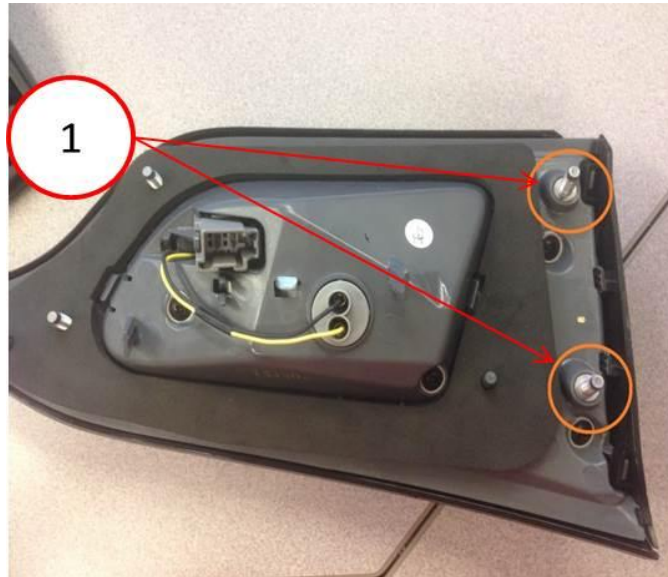

Fig. 2 Adding Washers To Studs

1 - Washers To Be Added To Outboard Studs

3. Install lift gate mounted inner tail lamps and secure to lift gate. Refer to the detailed service procedures available in DealerCONNECT> TechCONNECT under: Service Info>08 - Electrical/8L - Lamps and Lighting/Lamps/Lighting - Exterior/Lamp, Tail Stop Turn/Installation>Lamp>Inner.
4. Evaluate the lift gate mounted tails lamps to body mounted tail lamps for being flush.

POLICY:

Reimbursable within the provisions of the warranty.

TIME ALLOWANCE:

Labor Operation No:	Description	Skill Category	Amount
08-50- 85-9A	Install, Washers to Inner Tail Lamps (0 - Introduction)	6 - Electrical and Body Systems	0.3 Hrs.

FAILURE CODE:

ZZ	Service Action
----	----------------