



# Service Bulletin

## PRELIMINARY INFORMATION

**Subject:** Front Seat Cage Nut Spins - Unable To Remove Bolt

**Models:** 2010 - 2015 Chevrolet Camaro

*This PI was superseded to update model years. Please discard all copies of PIC5521A.*

The following diagnosis might be helpful if the vehicle exhibits the symptom(s) described in this PI.

### Condition/Concern

A technician may experience difficulty removing one of the front seats. He may comment that one of the bolts is spinning, but it will not come out of the floor pan. This could be caused by a cage nut that broke loose from the weld in the floor pan during removal of the bolt.

### Recommendation/Instructions

**Note:** It is strongly suggested that a Body Shop perform the following repairs:

1. To remove the seat you will need to cut or drill the head of the bolt off.
2. Remove the seat following published procedures and reposition the carpet as needed to allow the remainder of the steps to be completed
3. Cut a square hole 45 mm (W) X 35 mm (H) in the Seat Anchor Bracket containing the loose cage nut, as illustrated below.

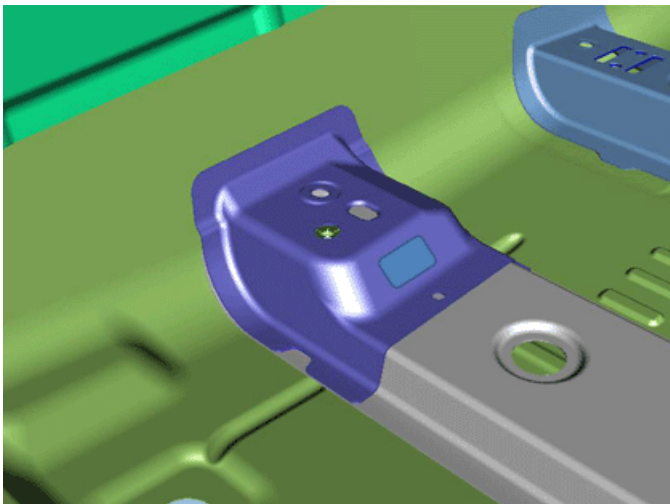

4. Remove the cage nut from the Seat Anchor Bracket and, using a vise and pliers, remove the remainder of the bolt from the nut. Clean the threads of the nut as necessary.
5. Drill two 5mm holes next to the bolt hole in the Seat Anchor Bracket. These holes should be 180 degrees opposite of each other. This will allow the nut to be tack welded back in place.

**Important:** It is critical that the nut be centered in the hole. If it is off to either side of the car, this will cause the seat track to bind.

**Note:** Use a long bolt or similar tool to hold the nut against the bottom of the bracket in the next step.

6. Holding the nut in the proper location, place two tack welds in the previously drilled holes to retain the nut to the bracket.
7. Clean the welds to allow proper fit of the seat adjuster to the floor pan.
8. Apply the anti-corrosion materials to the repair area and paint as necessary.

## Warranty Information

For vehicles repaired under warranty, use the following in addition to well documented straight time.

Labor Operation	Description	Labor Time
7020180	Driver or Passenger Seat Cushion Frame Replacement	Use Published Labor Operation Time *
	* Note: For additional labor involved with this repair use Other Labor Hours (OLH).	

Please follow this diagnostic or repair process thoroughly and complete each step. If the condition exhibited is resolved without completing every step, the remaining steps do not need to be performed.

GM bulletins are intended for use by professional technicians, NOT a "do-it-yourselfer". They are written to inform these technicians of conditions that may occur on some vehicles, or to provide information that could assist in the proper service of a vehicle. Properly trained technicians have the equipment, tools, safety instructions, and know-how to do a job properly and safely. If a condition is described, DO NOT assume that the bulletin applies to your vehicle, or that your vehicle will have that condition. See your GM dealer for information on whether your vehicle may benefit from the information.



WE SUPPORT VOLUNTARY TECHNICIAN CERTIFICATION