



Service Bulletin

File in Section: -

Bulletin No.: 16-NA-313

Date: September, 2016

INFORMATION

Subject: Diagnostic Tip for Power Steering Unit Fluid Leak

Brand:	Model:	Model Year:		VIN:		Engine:	Transmission:
		from	to	from	to		
Chevrolet	Low Cab Forward Medium Duty 3500-5500	2016	2017				

Involved Region or Country	North America
-----------------------------------	---------------

An investigation of returned power steering gear assemblies returned to the Warranty Parts Center has identified a common occurrence of units being replaced with “**no trouble found**” (NTF).

In order to better service the customer and stop the unnecessary replacement of these units, GM has provided the following service procedure to aid the technician in properly diagnosing power steering gear oil leaks.

Note: For warranty repairs, complete and keep a copy of this check sheet. If the power steering gear assembly is replaced under warranty and requested for return, this check sheet must accompany the part.

Step	Action	Yes	No
1	Clean of excess oil from the power steering system to make a potential leak more visible. Check the power steering fluid reservoir and add fluid if necessary. Go to Step 2.		
2	Start the engine and turn the steering wheel from lock to lock several times. Check the following areas for a leak 1. P/S Reservoir 2. P/S Pump 3. P/S Hoses and Pipes 4. P/S Gear Was the leak found at the P/S Gear?	Go to Step 3	Go to Step 5
3	Wipe off any fluid leakage residue from the power unit steering surface. Start the engine. Turn the steering wheel from lock-to-lock position approximately five (5) times. Inspect the following locations of the power steering gear (See check sheet and Figure 1):	Go to Step 4	Check for leaks from another source not related to the power steering.

Step	Action	Yes	No
	 <p style="text-align: right; margin-right: 50px;">4560544</p> <ol style="list-style-type: none"> 1. Stub Shaft Seal 2. Input Shaft Seal 3. Between Body and Housing 4. Taper Plug 5. Output Shaft Seal 6. Between Body and Side Cover 7. Between Side Cover and Nut <p>Complete the check sheet by marking the specific location that is leaking. May be more than one location. Was a leak found at one of these locations?</p>		
4	<p>Replace power steering gear. Refer to the appropriate service manual. Start the engine and turn the steering wheel from lock-to-lock position approximately five (5) times. Was the leak corrected?</p>	SYSTEM OK	Check for leaks from another source not related to the power steering
5	<p>Repair the leaking according to the appropriate service manual Run the engine and turn the steering wheel from lock-to-lock position approximately five (5) times Was the leak corrected?</p>	SYSTEM OK	Go to Step 2

Fluid Check Sheet	Y	N
(1) Stub Shaft Seal		
(2) Input Shaft Seal		
(3) Between the Body & Housing		
(4) Taper Plug		
(5) Output Shaft Seal		
(6) Between the Body & Side Cover		
(7) Between the Side Cover & Nut		

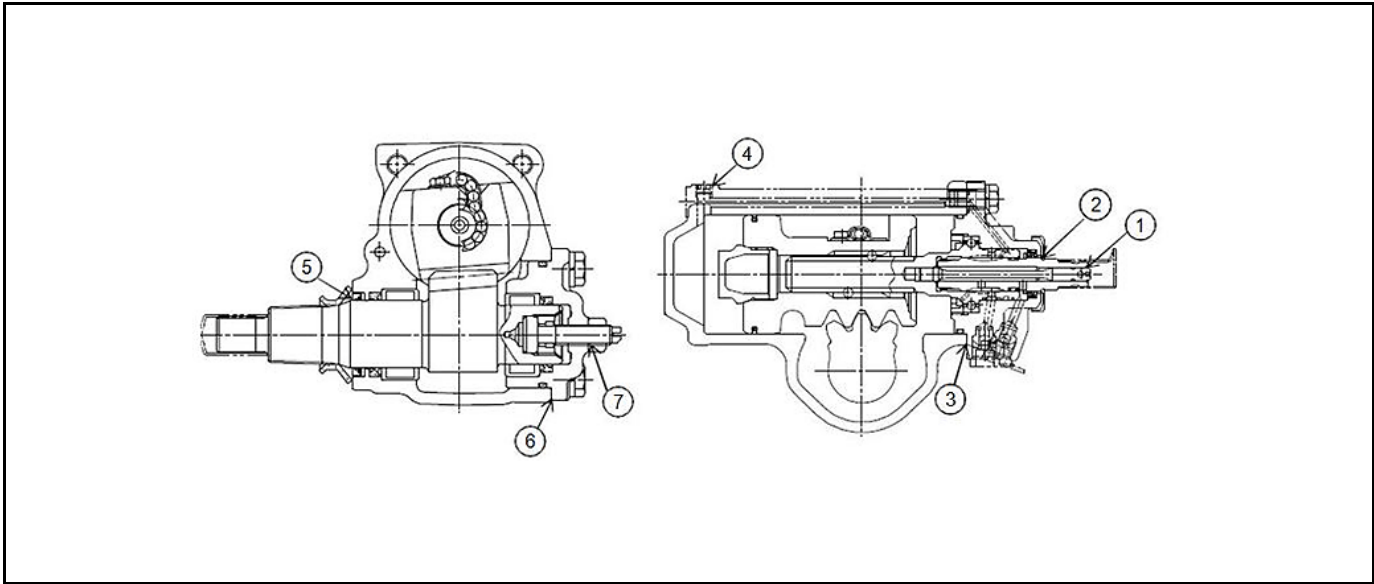

4560800

Figure 1 – Inspection Check Points

Version	1
Modified	

