



GROUP
BOD

MODEL
2017MY
Sorento (UMa)

NUMBER
159 (Rev 1, 12/20/16)

DATE
December 2016

TECHNICAL SERVICE BULLETIN

SUBJECT:

SERVICE ACTION: DRIVER'S WINDOW
RUN CHANNEL REPAIR (SA259)

* NOTICE

This bulletin has been revised to include additional information. New/revised sections of this bulletin are indicated by a black bar in the margin area.

This bulletin provides the procedure for inspecting and if necessary, repairing the driver's window run channel on some Sorento (UMa) vehicles, produced from April 4, 2016 to October 14, 2016, which may experience a wind noise at the driver's window. This concern is caused by a gap between the driver's window glass and window run channel. Follow the procedure outlined below to inspect and if necessary, install a foam pad on the window run weatherstrip. Kia is requesting the completion of this Service Action on all affected vehicles in dealer stock, prior to delivery. Before conducting the procedure, verify that the vehicle is included in the list of affected VINs.



* NOTICE

A Service Action is a repair program without customer notification that is performed during the warranty period. Any dealer requesting to perform this repair outside the warranty period will require DPSM approval.

Repair status for a VIN is provided on WebDCS (Service → Warranty Coverage → Warranty Coverage Inquiry → Campaign Information). Not completed Recall / Service Action reports are available on WebDCS (Consumer Affairs → Not Completed Recall → Recall VIN → Select Report), which includes a list of affected vehicles.

This issue number is SA259.

File Under: <Body>

Circulate To: General Manager Service Manager Parts Manager
 Service Advisors Technicians Body Shop Manager Fleet Repair

Inspection Procedure:

- Using the gap gauge supplied in the kit, inspect the gap between the window run channel (A) and the glass (B) by laying the gauge on the glass and sliding it towards the window run channel with light pressure.

If the gap gauge slides between the glass and window run channel, proceed to the next procedure.

If not, no further action is required.

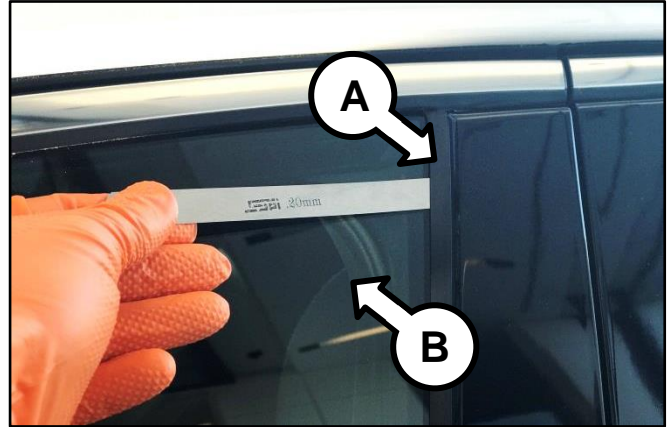
**Service Procedure:**

- With the window rolled down, pull out the window run weatherstrip (C) at the upper rear of the door frame garnish.



- Loosen the two (2) upper retaining screws on the door frame garnish.

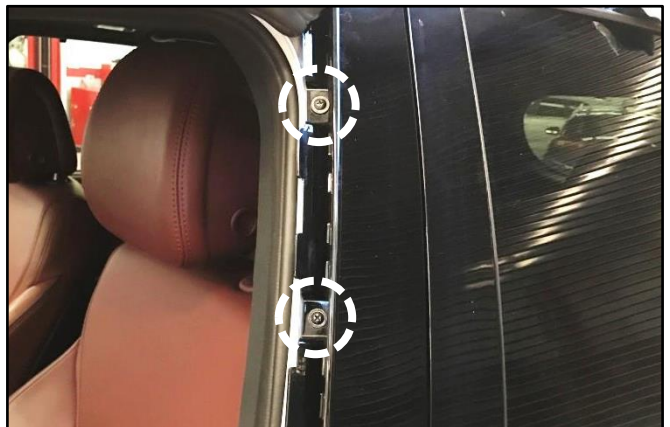

- Push the door frame garnish (D) towards the front of the vehicle and while holding the garnish in the pushed-in position, tighten the two (2) retaining screws.

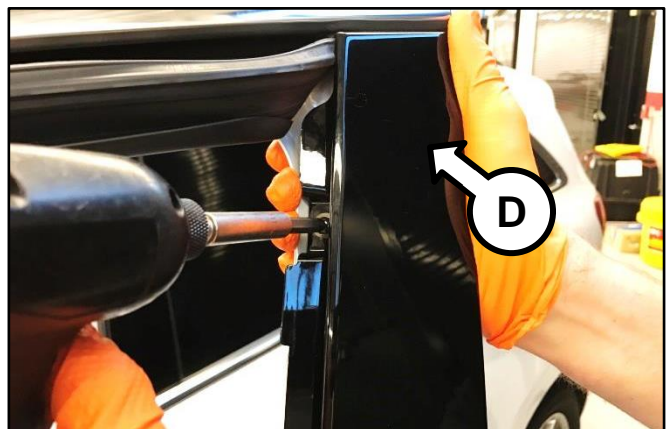

SUBJECT: DRIVER'S WINDOW RUN CHANNEL REPAIR (SA259)

4. Cut a 1.18in by 0.39in (30mm by 10mm) foam strip out of the foam pad provided.

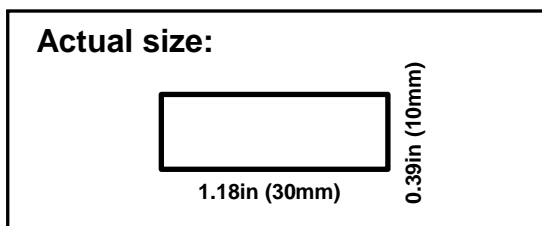

5. Apply the foam strip onto the window run weatherstrip, approximately 0.787in (20mm) from the top with slight gap (E) from the outer edge to prevent foam visibility after assembly.

*** NOTICE**

Ensure that the foam pad strip is not visible with the window rolled up.

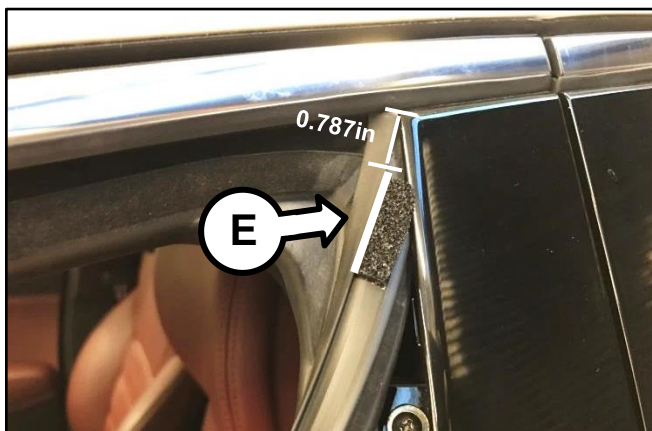

6. Reinstall the window run weatherstrip.
7. Verify proper installation of the window run weatherstrip from inside and outside the vehicle.
8. Confirm proper operation of driver's window.

SUBJECT:

DRIVER'S WINDOW RUN CHANNEL REPAIR (SA259)

AFFECTED VEHICLE RANGE:

Model	Production Date Range
Sorento (UMa)	April 4, 2016 to October 14, 2016

REQUIRED PART:

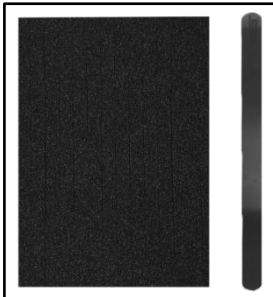
Part Name	Part Number	Figure	Comments
Foam Pad & Gap Gauge	82530 C5000QQK		Auto-shipped to dealers with affected in-stock inventory 1 foam pad in kit covers 24 vehicles

WARRANTY INFORMATION:

Claim Type	Causal P/N	Qty.	N Code	C Code	Repair Description	Labor Op Code	Op Time	Replacement P/N	Qty.
V	82530 C5000	0	N99	C99	(SA259) Driver's Window Run Gap Inspection	160A40R0	0.3 M/H	N/A	0
					(SA259) Driver's Window Run Inspection and Repair	160A40R1	0.4 M/H	82530 C5000QQK	See note below

Note: use sublet code X1 for reimbursement of foam pad and gap gauge kit (\$0.15 per vehicle)

*** NOTICE**

This is a dealer stock only Service Action. 100% of the parts needed have been automatically shipped to dealers with in-stock inventory. Due to limited availability, parts have been placed on manual allocation. If an additional kit is needed, place a normal parts order and open a Techline assistance case with the following information: VIN of vehicle involved in the Service Action, and the unique part order number.

*** NOTICE**

VIN inquiry data for this repair is provided for tracking purposes only. Kia retailers should reference SA259 when accessing the WebDCS system.