



Service Bulletin

TECHNICAL

Subject: Noise from Rear Leaf Spring Under Acceleration and High Loads (Replace Rear Leaf Spring Shackle)

Models: 2006-2016 Chevrolet Express
2006-2016 GMC Savana
Commercial Cutaway Vans - G33503, G33803, G33903

Attention: This Bulletin also applies to any of the above models that may be Export vehicles.

This Bulletin has been revised to add the 2013-2016 Model Years, update the part number and update the Labor Operation to the Global Labor Code (GLC). Please discard Corporate Bulletin Number 09-03-09-002A.

Condition

Some customers may comment on a noise from the rear of the vehicle. Upon Investigation, the technician may find the left and right shackle lower bushings are worn/ torn. This creates a metal to metal contact.

Correction

1. Verify the condition.
2. Raise and support the vehicle. Refer to *Lifting and Jacking the Vehicle* in SI.
3. Support the rear axle independently in order to relieve the tension on the leaf springs.

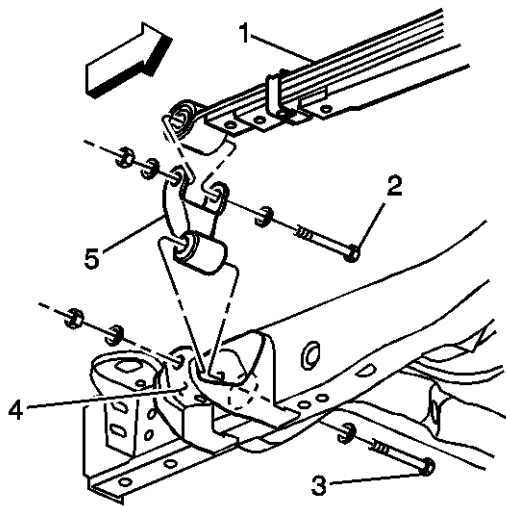

4. Remove the leaf spring (1) to the spring shackle (5) mounting bolt and nut (3). Replace the leaf spring shackle with GMP/N 23286143.
5. Install the leaf spring (1) to the spring shackle (5) mounting bolt and nut (3).
6. Tighten the spring shackle to frame mounting nut.

Tighten: Tighten the nut to 115 Y (85 lb ft).

7. Tighten the spring shackle to leaf spring mounting nut.

Tighten: Tighten the nut to 85 Y (63 lb ft).

8. Remove the rear axle support.
9. Repeat the same procedure for the other side.
10. Lower the vehicle.

Parts Information

Part Number	Description	Qty
23286143	SHACKLE ASM-RR SPR	2

Warranty Information

For vehicles repaired under warranty, use:

Labor Operation	Description	Labor Time
8080218*	Replace Rear Leaf Spring Shackle	1.0 hr

*This is a unique Labor Operation for Bulletin use only. It will not be published in the Labor Time Guide.

GM bulletins are intended for use by professional technicians, NOT a "do-it-yourselfer". They are written to inform these technicians of conditions that may occur on some vehicles, or to provide information that could assist in the proper service of a vehicle. Properly trained technicians have the equipment, tools, safety instructions, and know-how to do a job properly and safely. If a condition is described, DO NOT assume that the bulletin applies to your vehicle, or that your vehicle will have that condition. See your GM dealer for information on whether your vehicle may benefit from the information.



WE SUPPORT VOLUNTARY TECHNICIAN CERTIFICATION