



Service Bulletin

PRELIMINARY INFORMATION

Subject: Accessory Tri-Fold Tonneau Cover Prevents Endgate/Tailgate from Closing

Models: 2014 Chevrolet Silverado 1500
2015-2017 Chevrolet Colorado, Silverado
2014 GMC Sierra 1500
2015-2017 GMC Canyon, Sierra

Attention: This PI also applies to any of the above models that may be Export vehicles.

This PI has been revised to add the 2016 and 2017 Model Years. Please discard PI0998C.

Condition/Concern

Some customers may comment that the tailgate will not close with the tri-fold tonneau cover in the closed position.

This may be due to an early production condition caused by excessive twist in the rear rail of the tonneau cover, and the tailgate molding is not positioned flat or top of the tailgate.

Recommendation/Instructions

Improve the clearance from the rear rail to tailgate by conducting the following steps below.

Note: DO NOT replace the tonneau cover for this condition.

1. Open the tonneau cover.

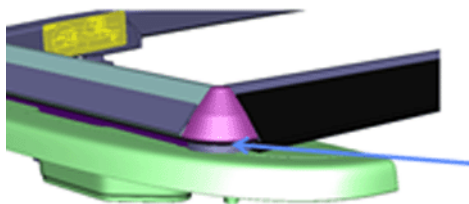

2. Remove the adhesive liner from the pad and attach to the rear current corner pads on the right and left side as shown in the illustration above.

Note: If additional clearance is required, add a second layer of corner pads to each side.

3. Close the cover and inspect fit and tailgate operation.

Note: The corner pads will take a compression set over time and should resolve any gaps present between the side seal and the pickup box top present immediately after installation.

Parts Information

Part Number	Description	Qty
22900409	Pad	As Needed

Warranty Information

For vehicles repaired under warranty, use:

Labor Operation	Description	Labor Time
0580018*	Adding Adhesive Pad To The Right And Left Rear Corner Pads	0.2 hr
*This is a unique Labor Operation for Bulletin use only. It will not be published in the Labor Time Guide.		

GM bulletins are intended for use by professional technicians, NOT a "do-it-yourselfer". They are written to inform these technicians of conditions that may occur on some vehicles, or to provide information that could assist in the proper service of a vehicle. Properly trained technicians have the equipment, tools, safety instructions, and know-how to do a job properly and safely. If a condition is described, DO NOT assume that the bulletin applies to your vehicle, or that your vehicle will have that condition. See your GM dealer for information on whether your vehicle may benefit from the information.



WE SUPPORT VOLUNTARY TECHNICIAN CERTIFICATION