



Service Bulletin

TECHNICAL

Subject: No Reverse, No Third, DTC P0716, P0717, P0776

Brand:	Model:	Model Year:		VIN:		Engine:	Transmission:
		from	to	from	to		
Buick	Enclave, LaCrosse, Regal	2016	2016			All	MH2, MHM, M7U, M7V, M7W, M7X
Cadillac	SRX, XTS						
Chevrolet	Equinox, Impala (VIN 1), Impala (VIN W), Traverse						
GMC	Acadia, Terrain						

Involved Region or Country	North America and NA Export
Condition	Some customers may comment on a condition of no Reverse. Some may also comment on no 3rd gear. Technicians may find an erratic input speed signal. DTCs P0716, P0717 and/or P0776 may be found as active or history DTCs.
Cause	This condition may be caused by the Input Shaft Speed Sensor Reluctor Ring Retainer Ring being out of the groove.

Correction

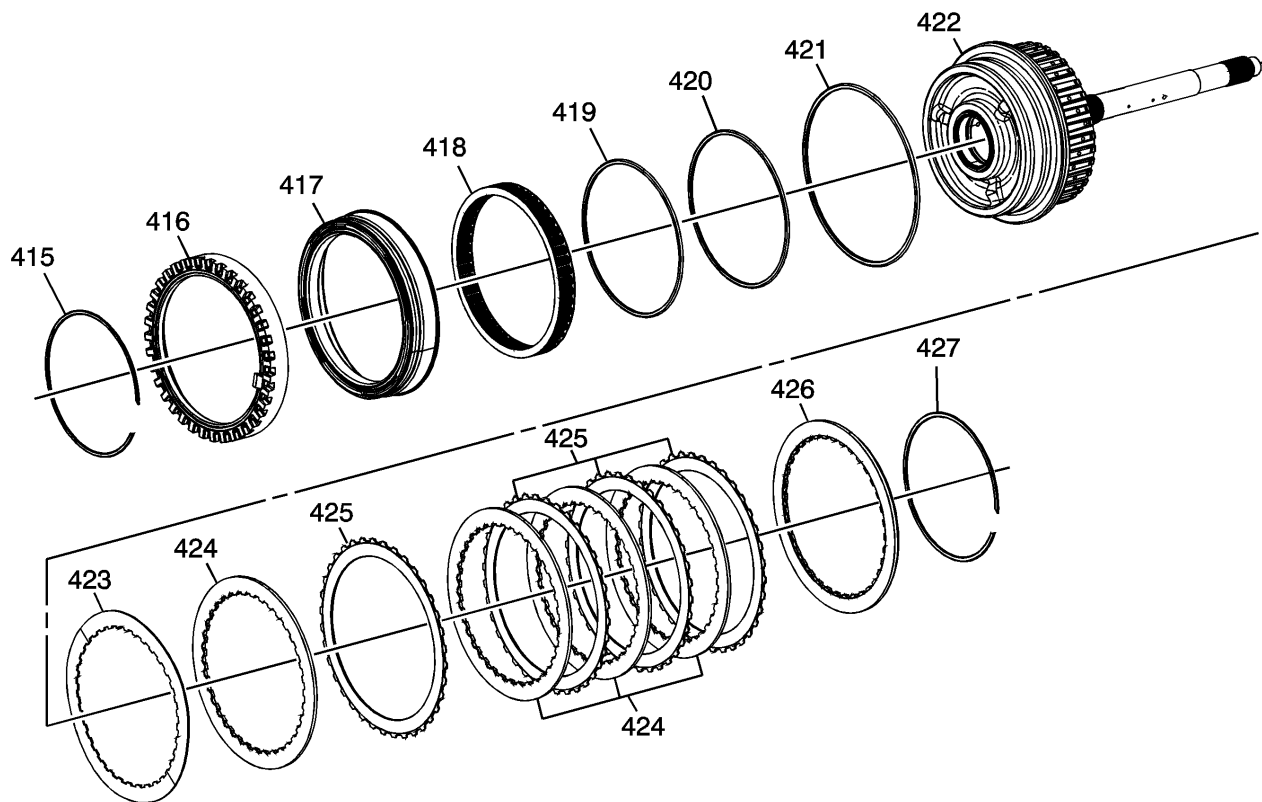

Important: All items noted below must be replaced during the repair. Failure to replace these parts may cause a repeat condition.

Replacement of the Retainer Ring (415), Input Shaft Speed Sensor Reluctor Wheel (416), 3-5-Reverse Clutch Piston (417) and 3-5-Reverse and 4-5-6 Clutch Housing Assembly (422). Inspect and replace other distressed parts as needed.

Service Procedure

Refer to *3-5-Reverse and 4-5-6 Clutch Housing Overhaul* in SI.

Warranty Information

For vehicles repaired under warranty, use:

Labor Operation	Description	Labor Time
8466450	3-5-Reverse Clutch Plate Replacement	Use Published Labor Operation Time

Version	2
Modified	May 3, 2016 – Added P0776 to Subject and Condition section and added Important statement to Correction.

GM bulletins are intended for use by professional technicians, NOT a "do-it-yourselfer". They are written to inform these technicians of conditions that may occur on some vehicles, or to provide information that could assist in the proper service of a vehicle. Properly trained technicians have the equipment, tools, safety instructions, and know-how to do a job properly and safely. If a condition is described, DO NOT assume that the bulletin applies to your vehicle, or that your vehicle will have that condition. See your GM dealer for information on whether your vehicle may benefit from the information.



WE SUPPORT VOLUNTARY TECHNICIAN CERTIFICATION