



Service Bulletin

PRELIMINARY INFORMATION

Subject: Service Park Assist Message At Start Up With DTC U0159 And/Or False Alerts

Models: 2015-2016 Cadillac Escalade Models
2014 Chevrolet Silverado 1500
2015-2016 Chevrolet Silverado, Suburban, Tahoe
2014 GMC Sierra 1500
2015-2016 GMC Sierra and Yukon Models
With Ultrasonic Park Assist System (RPO UD5 or UD7)

This PI was superseded to update the Recommendation with additional repair and parts information. Please discard PIT5507A.

The following diagnosis might be helpful if the vehicle exhibits the symptom(s) described in this PI.

Condition/Concern

Some owners may comment of any of the following Parking Assist System issues:

1. Unwanted/false alerts suggesting there is an object in front and/or behind the vehicle when there is nothing there. This issue is more prevalent when it is raining or snowing.
2. (This concern only applies to 2016 models) At times when the truck is first started, there is a "Service Parking Assist" message displayed. If the ignition is cycled off and back on, the message will be gone. When scanning for DTC's, a U0159 will be set in the IPC and/or BCM. This concern only occurs at start up and is very random.

Recommendation/Instructions

Engineering has developed updated Parking Assist Control Module (K41) calibrations to correct these concerns. Reprogram the K41 Parking Assist Control Module with the latest calibrations currently available in TIS2WEB.

Additional information for Condition 1

This information ONLY applies to the front park assist sensors on 2016 Silverado/Sierra 1500 models

The new calibration will greatly improve unwanted/false alerts.

If the issue continues, after the park assist module has been programmed with the new calibration, it is possible the front park assist sensor rings are incorrect.

If the front park assist sensor(s) have been replaced previously for any reason, some replacement park assist sensors were coming with the incorrect sensor ring.

The incorrect sensor rings did not have the scallops/reliefs molded into the ring, as shown below.

Remove the front park assist sensor(s) and inspect the sensor rings for scallops/reliefs molded into the ring.

If there are no scallops/reliefs molded into the ring, the wrong sensor ring(s) are installed. Replace the sensor ring(s) with GM part number 84075328, shown below.

It is imperative when installing the sensor rings to pay close attention that the sensor and ring are properly installed.

If the sensor and ring are not properly installed and there is binding/misalignment/etc. of the sensor/ring, it will continue to cause unwanted/false alerts.

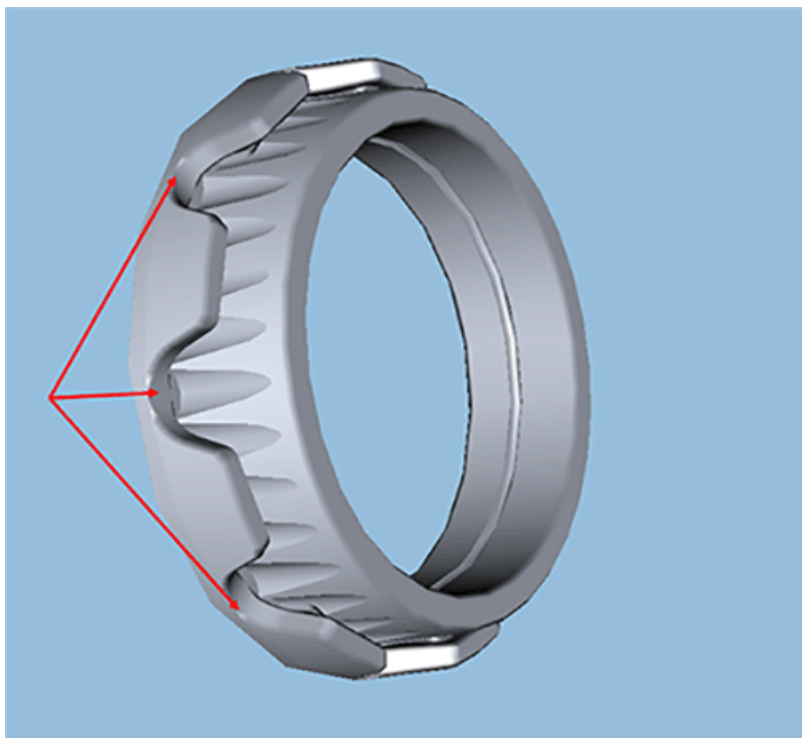

Parts Information

Part Number	Description	Qty
84075328*	Front Park Assist Sensor Ring	As Needed
*For use only on 2016 Silverado/Sierra 1500 Models.		

Please follow this diagnostic or repair process thoroughly and complete each step. If the condition exhibited is resolved without completing every step, the remaining steps do not need to be performed.

Warranty Information

For vehicles repaired under warranty use:

Labor Operation	Description	Labor Time
2810375	Parking Assist Control Module Reprogramming with SPS	Use Published Labor Time

Please follow this diagnostic or repair process thoroughly and complete each step. If the condition exhibited is resolved without completing every step, the remaining steps do not need to be performed.

GM bulletins are intended for use by professional technicians, NOT a "do-it-yourselfer". They are written to inform these technicians of conditions that may occur on some vehicles, or to provide information that could assist in the proper service of a vehicle. Properly trained technicians have the equipment, tools, safety instructions, and know-how to do a job properly and safely. If a condition is described, DO NOT assume that the bulletin applies to your vehicle, or that your vehicle will have that condition. See your GM dealer for information on whether your vehicle may benefit from the information.



WE SUPPORT VOLUNTARY TECHNICIAN CERTIFICATION