

# Initialization of Parking Assist Monitor System

**Service Category** General

**Section** Pre-Delivery Service

**Market** USA

Lexus Supports  
ASE Certification 

## Applicability

YEAR(S)	MODEL(S)	ADDITIONAL INFORMATION
2017	GX460	

## Introduction

The Parking Assist Monitor System assists the driver during parking and parallel parking by displaying an image of the area behind the vehicle.

When the short pin is removed or battery terminal is disconnected, the power source to the steering angle sensor is cut off. When the short pin is reinstalled or the battery terminal is reconnected, the rear view monitor will operate, but it cannot display guidelines to assist parking operation until the system has been initialized. Initialize the Parking Assist Monitor System after installing the short pin during Pre-Delivery Service (PDS).

### NOTE

**Anytime the battery terminal has been disconnected, the Parking Assist Monitor System MUST be initialized.**

## Warranty Information

OP CODE	DESCRIPTION	TIME	OFP	T1	T2
N/A	Not Applicable to Warranty	–	–	–	–

# Initialization of Parking Assist Monitor System

## Initialization Procedure

1. Start the engine.
2. Check if the Parking Assist Monitor System is operative by moving the shift lever to the “R” position. The rear view monitor will display “System is initializing.” as shown in Figures 1 and 2.

**Figure 1. Rear View (Before Initialization)**

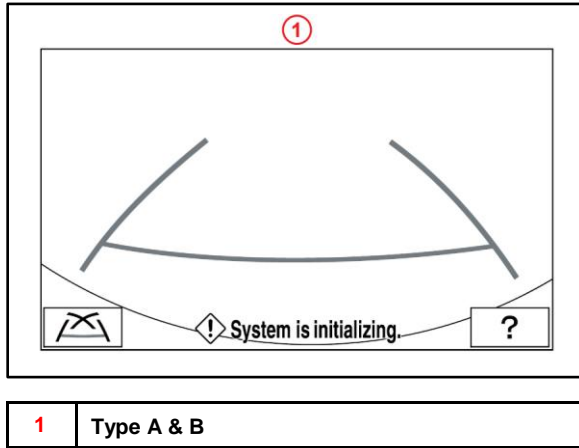

**Figure 2. Side View (Before Initialization)**

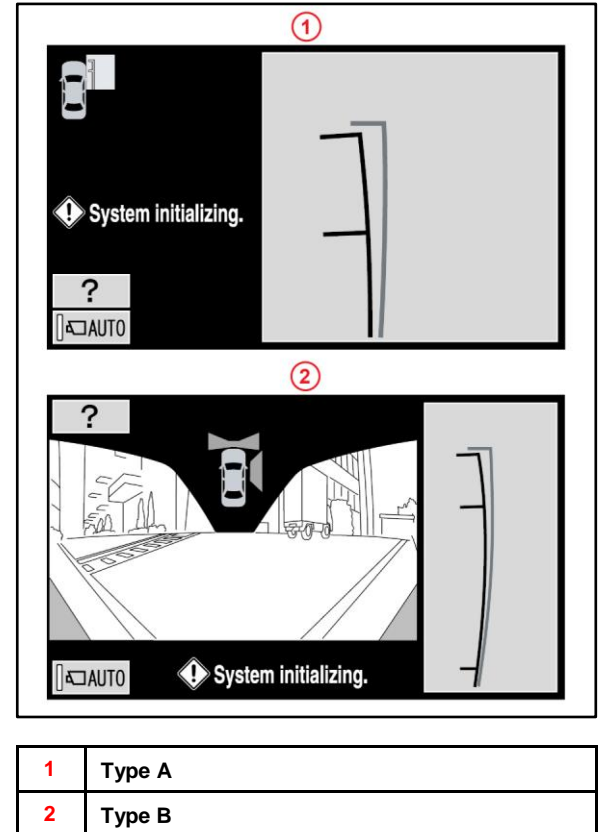

3. Move the shift lever to the “P” position and turn the steering wheel lock to lock.

# Initialization of Parking Assist Monitor System

## Initialization Procedure (Continued)

4. Move the shift lever to the "R" position.

When "Check surroundings for safety." appears on the rear view monitor as shown in Figures 3 and 4, the initialization of the Parking Assist Monitor System has been completed.

**Figure 3. Rear View (After Initialization)**

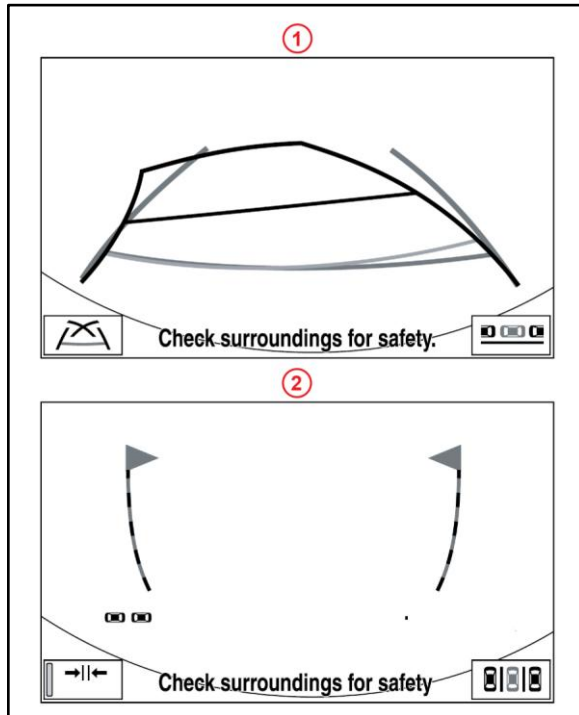

1	Type A
2	Type B

**Figure 4. Side View (After Initialization)**

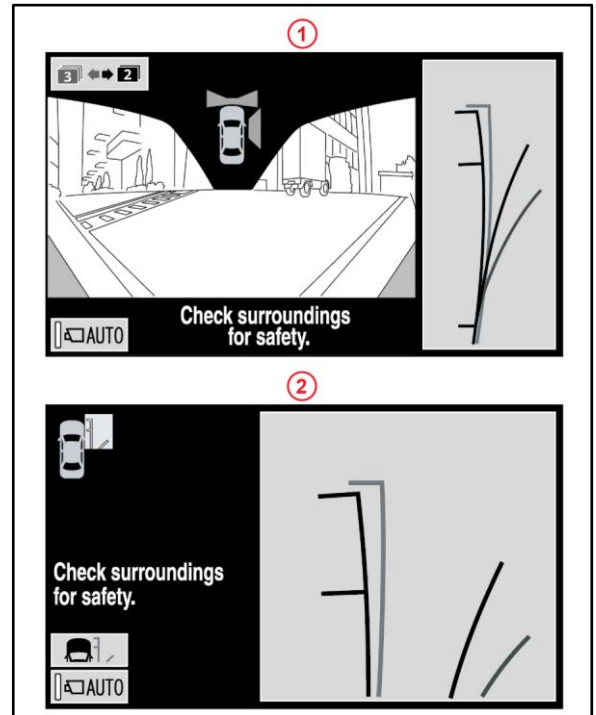

1	Type A
2	Type B