



# Technical Journal

TITLE:

**Front park assist sensor bracket, coming loose**

<b>REF NO:</b> TJ 29122.2.0	<b>ISSUING DEPARTMENT:</b> Technical Service	<b>CAR MARKET:</b> United States and Canada	
<b>PARTNER:</b> 3 US 7510 Volvo Car USA		<b>ISSUE DATE:</b> 2016-08-22	<b>STATUS DATE:</b> 2016-08-26
<b>FUNC GROUP:</b> 3871	<b>FUNC DESC:</b> Parking assistance	Page 1 of 6	

“Right first time in Time”

## Attachment

File Name	File Size
TJI-487847-1_1_0_en-US.pdf	0.7784 MB

## Vehicle Type

Type	Eng	Eng Desc	Sales	Body	Gear	Steer	Model Year	Plant	Chassis range	Struc Week Range
256							2016-2017		0000561-0117261	201505-201623

## CSC Customer Symptom Codes

Code	Description
U5	Bumper/Other bumper problems
KS	Front/rear park assist/Does not work

## VST Operation Number

VST Operation Number	Description
98610-2	PAS adjust console acc. to TJ29122

## DTC Diagnostic Trouble Codes

Rows beginning with \* are modified

Note! If using a printed copy of this Technical Journal, first check for the latest online version.



## **Text**

### **DESCRIPTION:**

\*Chassis range and function group updated.

The front park assist sensor bracket may come loose from the lower grill. The clamping force on the bracket in the lower grill may be too low.

### **SERVICE:**

In case of customer complaints of a loose park assist sensor bracket, follow the attached instruction to assemble a foam block on the bracket to increase the clamping force.

### **VEHICLE REPORT:**

Yes, please submit a Vehicle Report if the service solution described in this TJ has no effect. Use concern area "Vehicle Report" and sub concern area "Support Not Needed", use function group 3871.

**To view TJ attachment continue to next page. This TJ has one attachment.**



## Volvo Car Customer Service

TJ Instruction VCC-487847-1

<b>Title</b>	Parking assistance, front	<b>Page</b>	1 ( 4 )
<b>Action</b>	Adjustment	<b>Operation number:</b>	98610-2

Issue	Date	Reason
1	2015-09	First issue

### Affected vehicles

Model year	Model
2016-2017	XC90 (16-)

### Materials

Materials	Qty.	Part No.	Notes
Sealing	0.1	9124372	

### Equipment

Designation	Part No.
Interior trim remover	

## Orientation view

**Note! Removal steps in this procedure may contain installation details.**

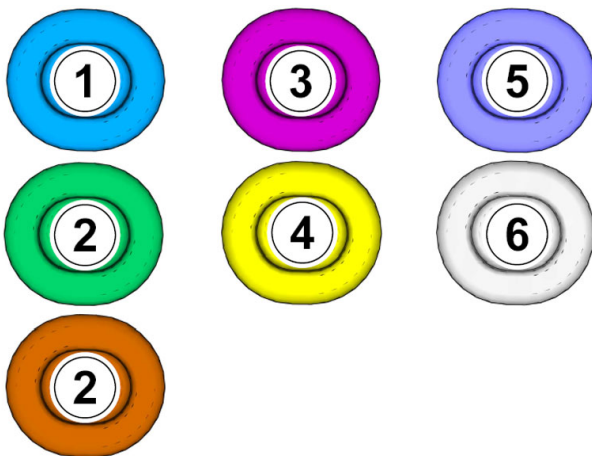
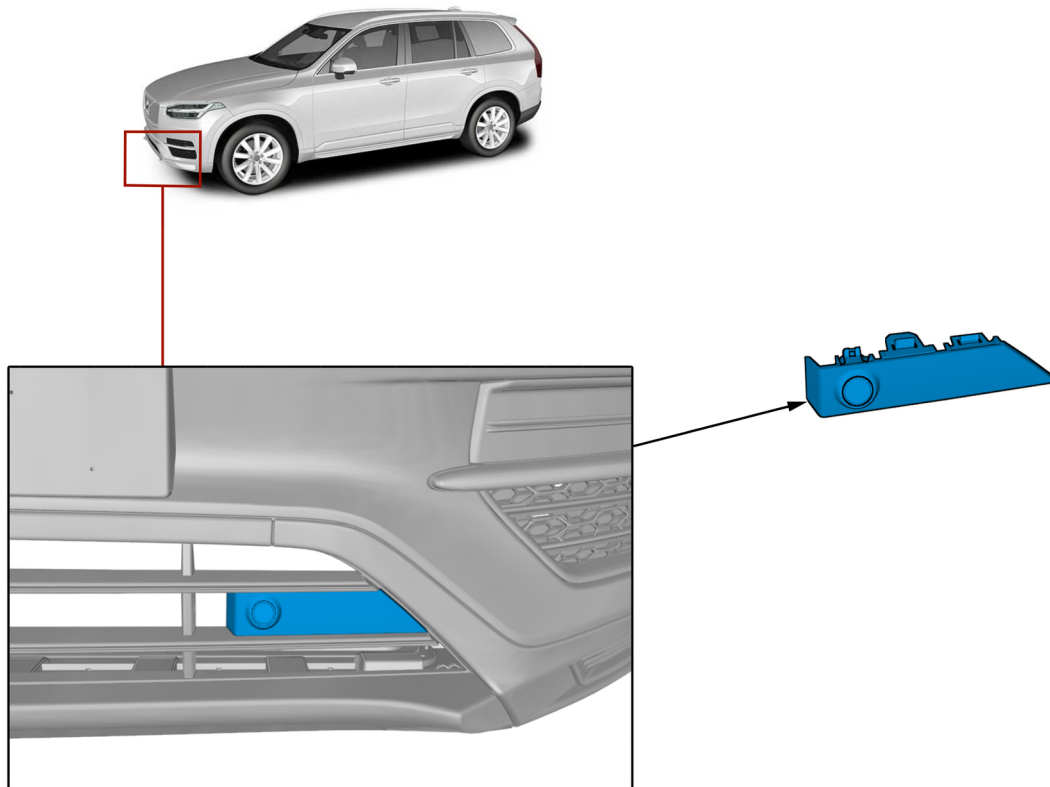

**Note! This colour chart displays (in colour print and electronic version) the importance of the different colours used in the images of the method steps.**

- 1 . Used for focused component, the component with which you will do something.
- 2 . Used as extra colors when you need to show or differentiate additional parts.
- 3 . Used for attachments that are to be removed/installed. May be screws, clips, connectors, etc.
- 4 . Used when the component is not fully removed from the vehicle but only hung to the side.
- 5 . Used as background color for vehicle components.

Removal

**Note! Removal steps in this procedure may contain installation details.**

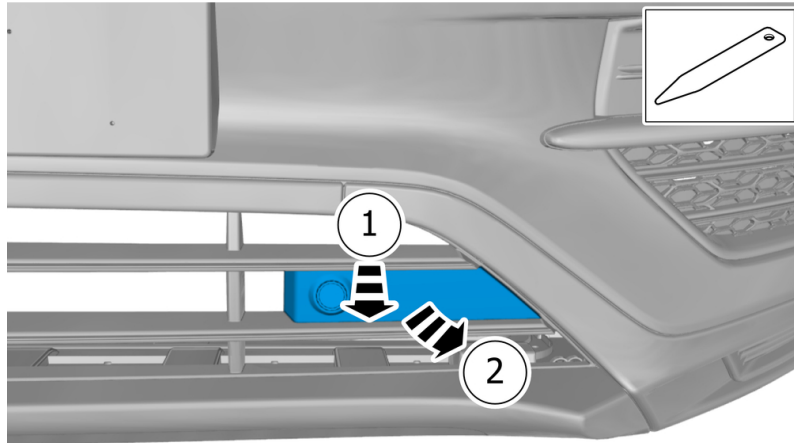

- 1 · **Use:** Interior trim remover
- 2 . Remove the marked part.

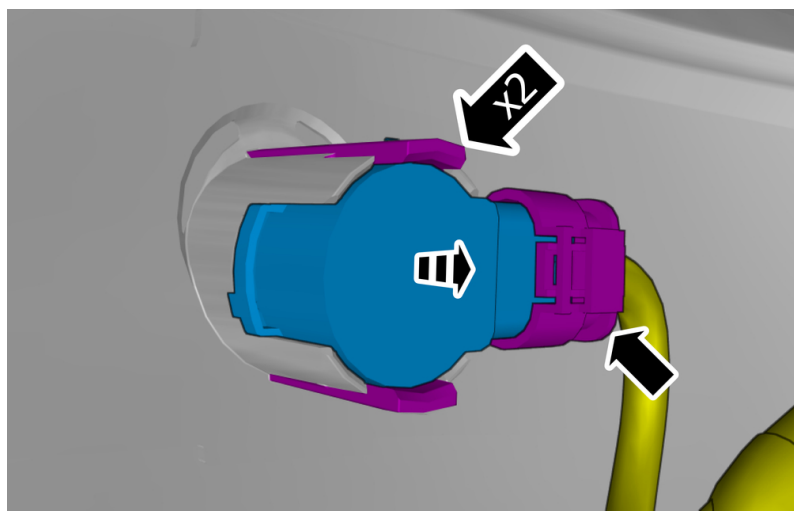

Disconnect the connector.  
Release the catches.  
Remove the marked part.

Cut following the dotted lines.

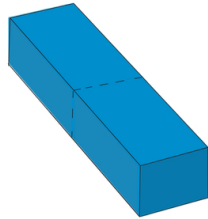
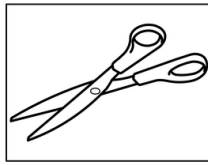

Remove the protective film.  
Place the component where indicated in the graphic.

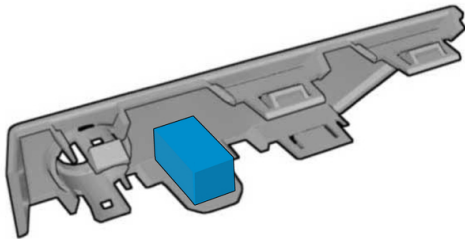

On both sides.

**Installation**

To install, reverse the removal procedure.

Check for correct operation.