

<b>REFERENCE:</b>	Nova Bus Manuals
<b>SECTION:</b>	09: Engine cooling package MKIII
<b>RS N°:</b>	MQR 7621-810
<b>EFFECTIVE IN PROD.:</b>	L937 (2016FE)

**APPLICATION DEADLINE:** 2017NO30  
**CLAIM REFERENCE NUMBER:** WB-3749

<b>SUBJECT:</b>	Radiator coolant level sensor
<b>JUSTIFICATION:</b>	Cummins coolant sensors equipped with the EPC connectors fail in service due to water infiltration.

LEVEL	DESCRIPTION	DIRECT CHARGES		TIME
		LABOUR	MATERIAL	
1	Contact your Cummins dealer to schedule the amended Campaign C1744 repair procedure to be performed on your affected vehicles.	Cummins	Cummins	–
2	Install a new wire kit, support bracket, VBEA programming and Actia programming on affected vehicles.	Nova Bus	Nova Bus	1.5h

\* The cost of the material will be reimbursed when claiming for this service document.

#### MATERIAL

QTY	PART N°	REV.	DESCRIPTION	REPLACES PART N°
<b>LEVEL 1</b>				
–	–	–	–	–
<b>LEVEL 2</b>				
1	N632000466	–	Wire harness	–
1	N84881	–	Support bracket	–
10	G50077996	–	Tie wrap	–
1	N75417	–	Heavy duty tie mount	–
1	N44886-02	C	M10 bolt	–
2	N38593	–	M6 Nylon lock flanged nut	–
1	N40492	A	M6 X 20 bolt	–
2	N57040	A	Stud-mounted high heat tie mount	–
1	N44881-03	A	M6 X 30 bolt	–
2	N84511-01	–	Deutsch connector holder clip	–

Materials will be available within 30 days. To order, please contact Prevost Parts by phone at 1-800-771-6682, by fax at 1-888-668-2555 or by email at [prevostparts.commandes@volvo.com](mailto:prevostparts.commandes@volvo.com). Specify document number, quantity of parts required and shipping address.

\* The material identified in Level 2 is to be ordered only for vehicles that meet the criteria defined in Level 1.

#### DISPOSAL OF PARTS

<b>REMOVED PARTS ARE:</b>	<b>DISCARDED *</b>	<b>RETAINED</b>	* Dispose of the unused parts and the defective parts in accordance with local environmental standards in effect.
	Yes	–	

#### REVISION HISTORY

REV.	DATE	CHANGE DESCRIPTION	WRITTEN BY
NR	2016SE29	Initial release	Luc Carignan

**APPROVED BY:**

PAGE 1 OF 13

CLIENT	ORDER	ROAD NUMBER		VIN (2NVY/4RKY...)		QTY
		FROM	TO	FROM	TO	
Austin - CMTA - Texas	L704	5051	5068	L82J7E4500471	L82J2E4500488	18
Barrie - Ontario	L878	1501	1504	L82JXF3001691	L82J6F3001719	4
BC Transit - BCT - British Columbia	L858	9447	9481	L82JXE3001401	L82J5F3001436	35
BC Transit - BCT - British Columbia	L891	—	—	L82J5F3001565	L82J2F3001569	5
Brampton - Ontario	L789	—	—	L82J4E3001216	L82J1E3001223	8
Brampton - Ontario	L816	—	—	L82J3E3001224	L82J9E3001230	7
Brampton - Ontario	L864	1501	1510	L82JXF3001500	L82J6F3001509	10
Brampton - Ontario	L865	1511	1519	L82JXF3001514	L82J9F3001522	9
Brampton - Ontario	L942	1601	1613	L82J6G3750070	L82J4G3750083	13
Brantford - Ontario	L775	10131	10132	L82U1D3000999	L82U2D3001000	2
Brantford - Ontario	L928	10151	10153	L82J7F3001793	L82J0F3001795	3
Burlington - Ontario	L887	7017-15	7025-15	L82J7F3001681	L82J8F3001723	9
Clemson Area Transit - South Carolina	L769	—	—	S92U1D4500418	S92U1D4500418	1
Cornwall Ontario	L935	—	—	L82J3F3001838	L82J5F3001839	2
CT Transit - Connecticut	L814	1462	1473	S92LXE4500717	S92L4E4500728	12
CT Transit - Connecticut	L815	1426	1426	S92L0E4500709	S92L0E4500712	4
Durham Region Transit - Ontario	L872	8551	8553	L82J0F3001523	L82J4F3001525	3
Durham Region Transit - Ontario	L888	8554	8559	L82J2F3001703	L82J1F3001708	6
Fredericton - New Brunswick	L774	8131	8131	L82U7D3000960	L82U7D3000960	1
Fredericton - New Brunswick	L812	—	—	L82J4E3001202	L82J4E3001202	1
Fredericton - New Brunswick	L836	8143	8143	L82J9E3001390	L82J9E3001390	1
Fredericton - New Brunswick	L901	8151	8151	L82J7F3001602	L82J7F3001602	1
Grande Prairie Alberta	L834	—	—	L82J7E3001386	L82J2E3001389	4
Guelph - Ontario	L767	237	239	L82UXD3000967	L82U3D3000969	3
Guelph - Ontario	L835	240	243	L82J0E3001391	L82J6E3001394	4
Guelph - Ontario	L927	244	247	L82J1F3001756	L82J9F3001763	4
Houston - Texas	L951	1915	1915	L82J0G9775203	L82J0G9775203	1
Kingston Ontario	L880	1502	1502	L82JXF3001786	L82JXF3001786	1
Kingston Ontario	L925	1504	1510	L82J5F3001808	L82J5F3001811	4
Lethbridge - Alberta	L868	—	—	L82J2F3001510	L82J2F3001510	1
LYNX - Florida	L785	—	—	S92L6E4500505	S92L8E4500506	2
MTD - Santa Barbara, California	L730	—	—	S92J8E4500567	S92J1E4500569	3
Niagara Falls - Ontario	L771	1396	1397	L82U9D3000958	L82U0D3000959	2
North Bay - Ontario	L895	784	785	L82J7F3001678	L82J9F3001679	2
Oakville - Ontario	L874	—	—	L82J6F3001526	L82JXF3001531	6
Oakville - Ontario	L881	—	—	L82J2F3001717	L82J8F3001740	5
Peterborough - Ontario	L770	55	60	L82U0D3000993	L82UXD3000998	6
Peterborough - Ontario	L870	61	63	L82JXF3001612	L82J3F3001614	3
Peterborough - Ontario	L919	64	66	L82J6F3001767	L82JXF3001769	3
Red Deer - Alberta	L766	1104	1105	L82U7D3001025	L82U9D3001026	2
Red Deer - Alberta	L772	1106	1108	L82J2E3001120	L82J6E3001122	3
Red Deer - Alberta	L813	10008	10009	L82J2E3001361	L82J4E3001362	2
Red Deer - Alberta	L869	—	—	L82J9F3001570	L82J0F3001571	2

CLIENT	ORDER	ROAD NUMBER		VIN (2NVY/4RKY...)		QTY
		FROM	TO	FROM	TO	
Red Deer - Alberta	L926			L82J2F3001796	L82J4F3001797	2
Regina - Saskatchewan	L776	663	669	L82U4D3001001	L82U5D3001007	7
Regina - Saskatchewan	L807	671	685	L82J8E3001137	L82J2E3001151	15
Regina - Saskatchewan	L892	686	691	L82J5F3001484	L82J4F3001489	6
Sarnia Ontario	L873	151	152	L82J0F3001599	L82J0F3001600	2
Sarnia Ontario	L883	153	153	L82J4G3750021	L82J4G3750021	1
Saskatoon - Saskatchewan	L831	1401	1405	L82J7E3001307	L82J9E3001311	5
Saskatoon - Saskatchewan	L894	1501	1510	L82J0F3001490	L82J7F3001499	10
Sault Ste. Marie Ontario	L934	—	—	L82JXG3750038	L82JXG3750038	1
St. Catharines Ontario	L879	1501	1504	L82J4F3001587	L82J4F3001590	4
St. Catharines Ontario	L898	1560	1560	S92J4F3001663	S92J4F3001663	1
St. John - New Brunswick	L871	40585	40586	L82J8F3001592	L82JXF3001593	2
St. John - New Brunswick	L939	40687	40687	L82J0G3750078	L82J0G3750078	1
St. John's - Newfoundland	L808	1415	1419	L82J4E3001152	L82J1E3001156	5
St. John's - Newfoundland	L875	1520	1525	L82JXF3001478	L82J3F3001483	6
St. John's - Newfoundland	L930	1626	1630	L82J7F3001826	L82J9F3001830	5
Stratford - Ontario	L893	—	—	L82J9F3001584	L82J0F3001585	2
Sudbury - Ontario	L890	851	855	L82JXF3001609	L82J6F3001641	5
Thunder Bay - Ontario	L806	—	—	L82J6E3001170	L82J8E3001171	2
Thunder Bay - Ontario	L863	—	—	L82J8F3001558	L82J6F3001560	3
Thunder Bay - Ontario	L944	—	—	L82J6G3750084	L82JXG3750086	3
Timmins - Ontario	L783	—	—	L82U8D3001017	L82UXD3001018	2
Timmins - Ontario	L839	—	—	L82J8E3001395	L82J8E3001395	1
University of Alabama - Alabama	L787	—	—	L82J2E4500507	L82J4E4500508	2
University of Alabama - Alabama	L902	7030	7030	L82J2F4500993	L82J4F4500994	2
Vancouver Airport Authority - YVR British Columbia	L912	173	178	L82L5F3001812	L82L4F3001817	6
Walt Disney World - Florida	L763	—	—	S92U0D3001019	S92U4D3001024	6
Welland Ontario	L866			L82J9F3001648	L82J9F3001648	1
Welland Ontario	L933	—	—	L82J1G3750011	L82J1G3750011	1
Whitehorse - Yukon	L784	43	43	L82U9D3001057	L82U9D3001057	1
Windsor - Ontario	L886	570	577	L82J8F3001818	L82J5F3001825	8
Woodstock - Ontario	L778	—	—	L82U2D3001014	L82U2D3001014	1
Woodstock - Ontario	L832	—	—	L82J9E3001342	L82J9E3001342	1
Woodstock - Ontario	L923	15-16	15-16	L82J9F3001746	L82J9F3001746	1
York Regional Transit - Ontario	L896	1501	1517	L82J2F3001619	L82JXF3001741	17
York Regional Transit - Ontario	L936	1518	1518	L82J3G3750012	L82J3G3750012	1

**WARNING**

Follow your internal safety procedures.

## PROCEDURE

### LEVEL 1: CUMMINS CAMPAIGN C1744

- 1.1. Cummins is to perform amended campaign C1744, which includes
  - 1.1.1. Replacement of the mid and lower coolant sensors by new N84555 sensor. See Figure 1.
  - 1.1.2. Modification of the radiator electric harness, by installing a wire splice kit to replace the two PKC-type connectors. See Figure 1.

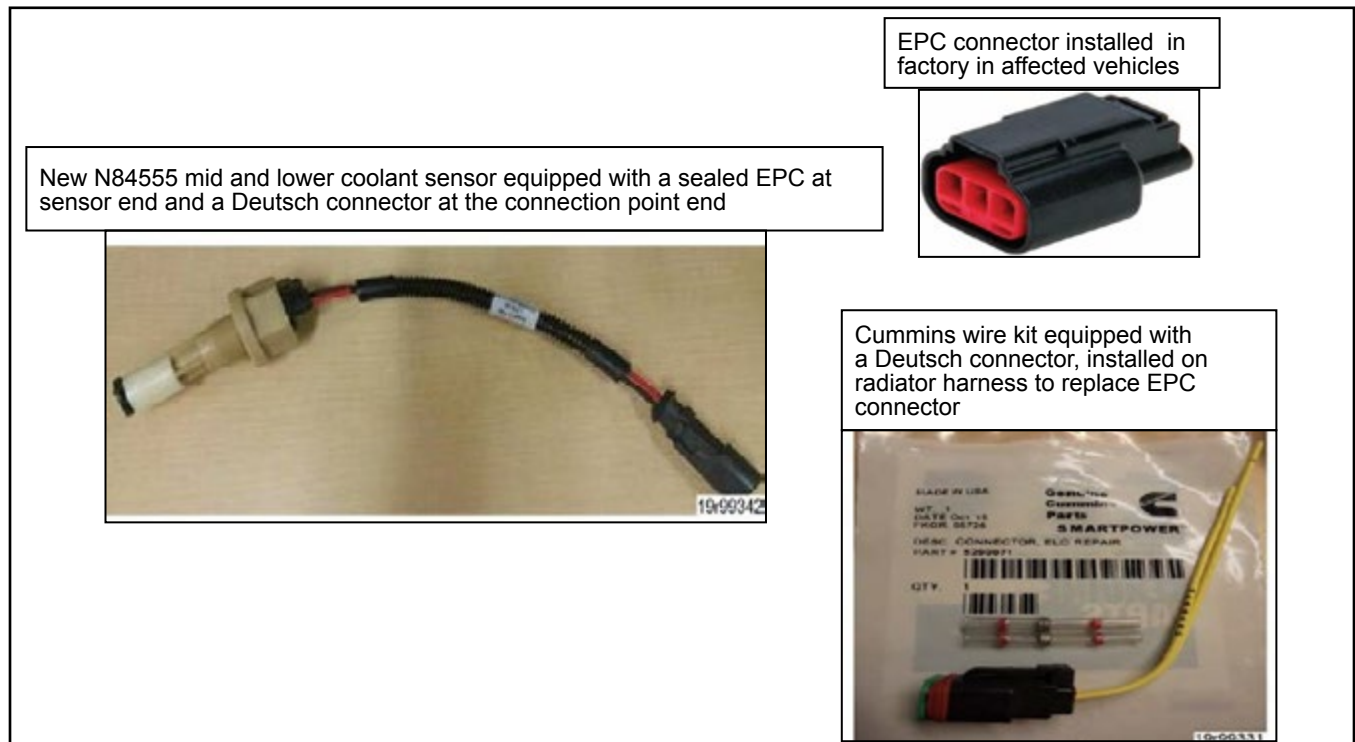

Figure 1 - Cummins Campaign C1744 Details

**LEVEL 2: INSTALL**

- 2.1. Build the N84881 support bracket sub-assembly. See Figure 2 for parts and details.
- 2.2. Open the radiator access door.
- 2.3. Install the N84881 support bracket and the heavy-duty tie mount on the radiator using the N44886-02 M10 bolt. See Figure 2.

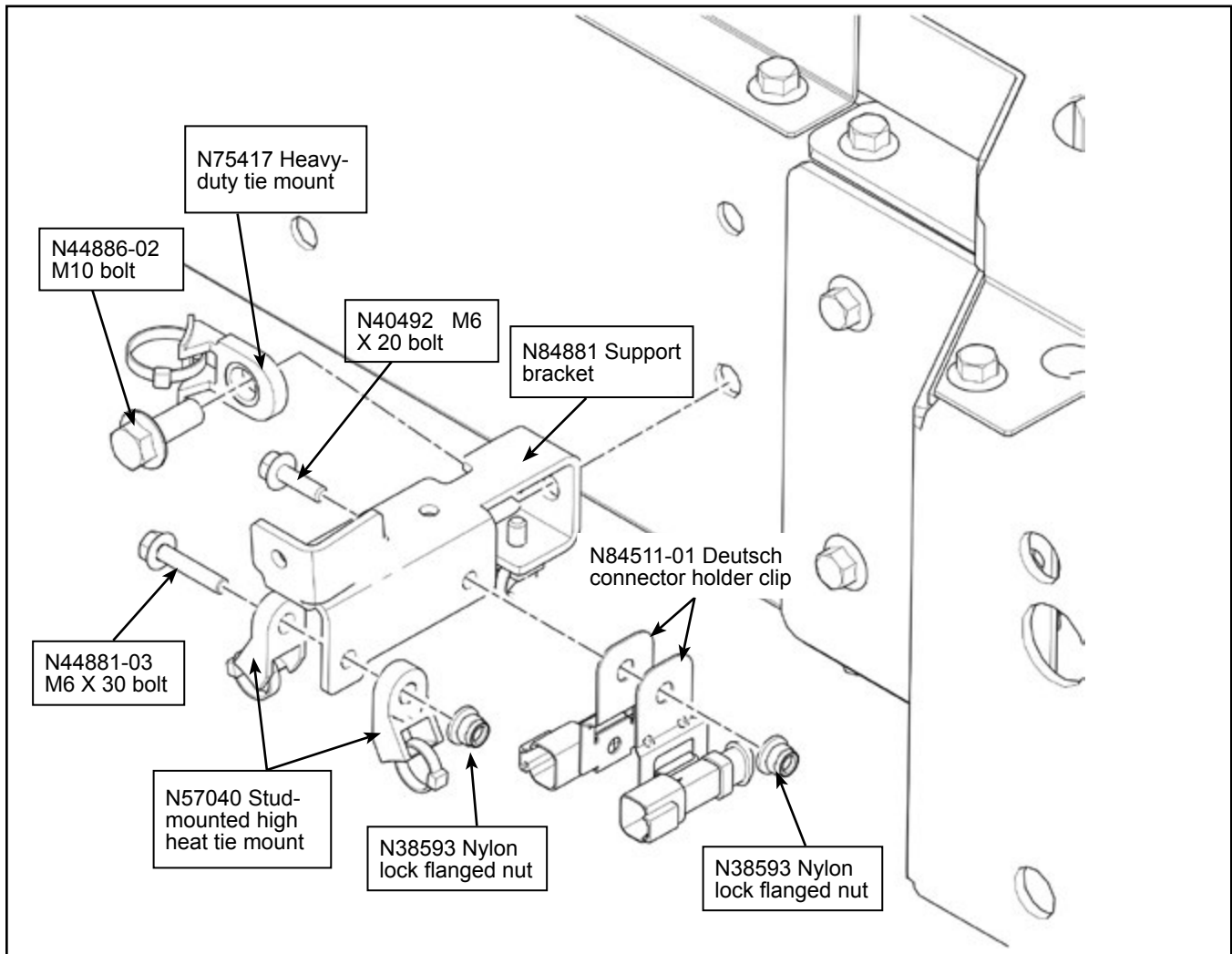

Figure 2 - Support Bracket Assembly

- 2.4. Disconnect radiator harness connectors **ER-X6475B**, **ER-X6475C**, **ER-X75SA** and **ER-X75WA**. Cut and tape back the wires of connectors **ER-X6475C**, **ER-X75SA** and **ER-X75WA** at their harness breakout point.
- 2.5. Remove, cut, and tape back the wires located in positions **1** and **3** on connector **ER-X6475B** of the radiator harness.
- 2.6. From the received N632000466 harness, connect the free white wire to position **1** on the radiator harness connector **ER-X6475B**. See Figure 3.
- 2.7. From the received N632000466 harness, connect the free black wire to position **3** on the radiator harness connector **ER-X6475B**. See Figure 3.

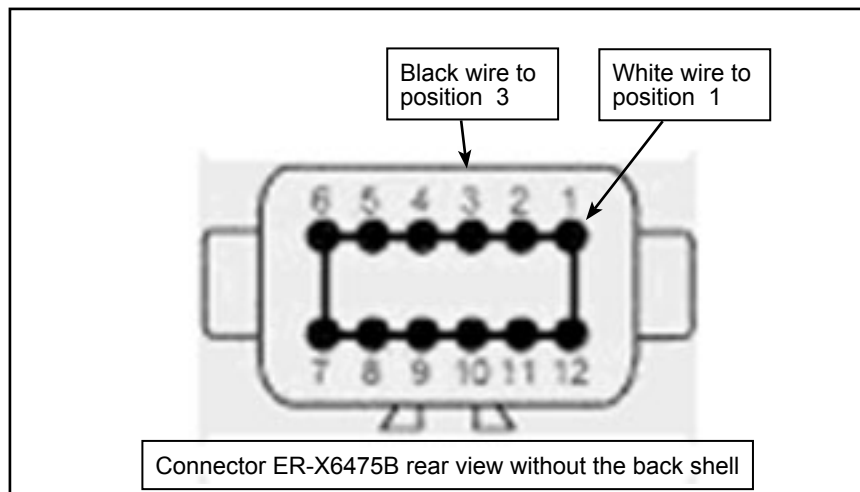

Figure 3 - ER-X6475B Back View Pin Out

- 2.8. Affix wire harness N632000466 to the original radiator harness using a G50077996 tie wrap.
- 2.9. Affix on N84555 2 wire pigtails to the heavy-duty tie mount using a G50077996 tie wrap. See Figure 5.
- 2.10. Connect **ER-X75SA** to the mid coolant sensor connector affix the Deutsch connector to the holder clip, and affix the harness to the tie mount using tie wraps. See Figure 5.
- 2.11. Connect **ER-X75WA** to the low coolant sensor connector and affix the Deutsch connector to the holder clips and affix the harness to the tie mount using tie wraps. See Figure 5.

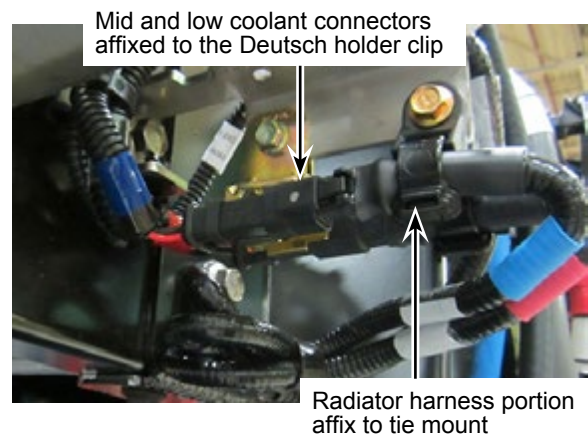

Figure 4 - Installation of Harnesses to the Support Bracket

- 2.12. Connect N632000466 wire harness connectors **ER-x6475B** and **ER-x6475c** to the vehicle harness.
- 2.13. Close the radiator access door.
- 2.14. Program the V-BEA system using the program and revision indicated in Annex A. See section 16: **V-BEA** (VOLVO BUS ELECTRONIC ARCHITECTURE) of the Nova LFS maintenance manual for the programming procedure.
- 2.15. Program the ACTIA system using the program and revision indicated in Annex B. See section 16: **V-BEA** (VOLVO BUS ELECTRONIC ARCHITECTURE) of the Nova LFS maintenance manual for the programming procedure. ❖

## ANNEX A

## LIST OF REQUIRED V-BEA PROGRAMS PER ORDER

INDICATED REVISIONS ARE THE MINIMUM REVISION REQUIREMENTS

CLIENT	ORDER	ROAD NUMBER		VIN (2NVY/4RKY...)		QTY	PROGRAM	REV.
		FROM	TO	FROM	TO			
Austin - CMTA - Texas	L704	5051	5068	L82J7E4500471	L82J2E4500488	18	AUS4DE__00	E
Barrie - Ontario	L878	1501	1504	L82JXF3001691	L82J6F3001719	4	BAR4DE__00	D
BC Transit - BCT - British Columbia	L858	9447	9481	L82JXE3001401	L82J5F3001436	35	BCT4DE__03	F
BC Transit - BCT - British Columbia	L891	—	—	L82J5F3001565	L82J2F3001569	5	BCT4DE__03	F
Brampton - Ontario	L789	—	—	L82J4E3001216	L82J1E3001223	8	BRM4DE__00	J
Brampton - Ontario	L816	—	—	L82J3E3001224	L82J9E3001230	7	BRM4DE__00	J
Brampton - Ontario	L864	1501	1510	L82JXF3001500	L82J6F3001509	10	BRM4DE__01	D
Brampton - Ontario	L865	1511	1519	L82JXF3001514	L82J9F3001522	9	BRM4DE__01	D
Brampton - Ontario	L942	1601	1613	L82J6G3750070	L82J4G3750083	13	BRM4DE__02	0
Brantford - Ontario	L775	10131	10132	L82U1D3000999	L82U2D3001000	2	BRT4DE__02	E
Brantford - Ontario	L928	10151	10153	L82J7F3001793	L82J0F3001795	3	BRT4DE__03	A
Burlington - Ontario	L887	7017-15	7025-15	L82J7F3001681	L82J8F3001723	9	BUR4DE__00	G
Clemson Area Transit - South Carolina	L769	—	—	S92U1D4500418	S92U1D4500418	1	#N/A	#N/A
Cornwall Ontario	L935	—	—	L82J3F3001838	L82J5F3001839	2	CWT4DE__00	A
CT Transit - Connecticut	L814	1462	1473	S92LXE4500717	S92L4E4500728	12	CON6HE__00	H
CT Transit - Connecticut	L815	1426	1426	S92L0E4500709	S92L0E4500712	4	CON6HE__00	H
Durham Region Transit - Ontario	L872	8551	8553	L82J0F3001523	L82J4F3001525	3	DRT4DE__00	L
Durham Region Transit - Ontario	L888	8554	8559	L82J2F3001703	L82J1F3001708	6	DRT4DE__00	L
Fredericton - New Brunswick	L774	8131	8131	L82U7D3000960	L82U7D3000960	1	FRE4DE__01	E
Fredericton - New Brunswick	L812	—	—	L82J4E3001202	L82J4E3001202	1	FRE4DE__02	G
Fredericton - New Brunswick	L836	8143	8143	L82J9E3001390	L82J9E3001390	1	FRE4DE__02	G
Fredericton - New Brunswick	L901	8151	8151	L82J7F3001602	L82J7F3001602	1	FRE4DE__02	G
Grande Prairie Alberta	L834	—	—	L82J7E3001386	L82J2E3001389	4	GPT4DE__00	C
Guelph - Ontario	L767	237	239	L82UXD3000967	L82U3D3000969	3	GUE4DE__02	D
Guelph - Ontario	L835	240	243	L82J0E3001391	L82J6E3001394	4	GUE4DE__03	D
Guelph - Ontario	L927	244	247	L82J1F3001756	L82J9F3001763	4	GUE4DE__04	B
Houston - Texas	L951	1915	1915	L82J0G9775203	L82J0G9775203	1	HOU4DE__00	E
Kingston Ontario	L880	1502	1502	L82JXF3001786	L82JXF3001786	1	KNG4DE__00	C
Kingston Ontario	L925	1504	1510	L82J5F3001808	L82J5F3001811	4	KNG4DE__00	C
Lethbridge - Alberta	L868	—	—	L82J2F3001510	L82J2F3001510	1	LET4DE__00	F



## ANNEX A

## LIST OF REQUIRED V-BEA PROGRAMS PER ORDER

INDICATED REVISIONS ARE THE MINIMUM REVISION REQUIREMENTS

CLIENT	ORDER	ROAD NUMBER		VIN (2NVY/4RKY...)		QTY	PROGRAM	REV.
		FROM	TO	FROM	TO			
LYNX - Florida	L785	—	—	S92L6E4500505	S92L8E4500506	2	LN6HE__01	G
MTD - Santa Barbara, California	L730	—	—	S92J8E4500567	S92J1E4500569	3	SBA6DE__00	D
Niagara Falls - Ontario	L771	1396	1397	L82U9D3000958	L82U0D3000959	2	NIA4DE__01	G
North Bay - Ontario	L895	784	785	L82J7F3001678	L82J9F3001679	2	NBT4DE__00	E
Oakville - Ontario	L874	—	—	L82J6F3001526	L82JXF3001531	6	OAK4DE__00	P
Oakville - Ontario	L881	—	—	L82J2F3001717	L82J8F3001740	5	OAK4DE__00	P
Peterborough - Ontario	L770	55	60	L82U0D3000993	L82UXD3000998	6	PET4DE__00	L
Peterborough - Ontario	L870	61	63	L82JXF3001612	L82J3F3001614	3	PET4DE__01	D
Peterborough - Ontario	L919	64	66	L82J6F3001767	L82JXF3001769	3	PET4DE__01	D
Red Deer - Alberta	L766	1104	1105	L82U7D3001025	L82U9D3001026	2	RDD4DE__01	H
Red Deer - Alberta	L772	1106	1108	L82J2E3001120	L82J6E3001122	3	RDD4DE__02	G
Red Deer - Alberta	L813	10008	10009	L82J2E3001361	L82J4E3001362	2	RDD4DE__03	E
Red Deer - Alberta	L869	—	—	L82J9F3001570	L82J0F3001571	2	RDD4DE__03	E
Red Deer - Alberta	L926	—	—	L82J2F3001796	L82J4F3001797	2	RDD4DE__03	E
Regina - Saskatchewan	L776	663	669	L82U4D3001001	L82U5D3001007	7	REG4DE__02	H
Regina - Saskatchewan	L807	671	685	L82J8E3001137	L82J2E3001151	15	REG4DE__03	H
Regina - Saskatchewan	L892	686	691	L82J5F3001484	L82J4F3001489	6	REG4DE__04	B
Sarnia Ontario	L873	151	152	L82J0F3001599	L82J0F3001600	2	SAR4DE__00	M
Sarnia Ontario	L883	153	153	L82J4G3750021	L82J4G3750021	1	SAR4DE__00	M
Saskatoon - Saskatchewan	L831	1401	1405	L82J7E3001307	L82J9E3001311	5	SAS4DE__01	C
Saskatoon - Saskatchewan	L894	1501	1510	L82J0F3001490	L82J7F3001499	10	SAS4DE__01	C
Sault Ste. Marie Ontario	L934	—	—	L82JXG3750038	L82JXG3750038	1	SSM4DE__01	B
St. Catharines Ontario	L879	1501	1504	L82J4F3001587	L82J4F3001590	4	SCT4DE__00	K
St. Catharines Ontario	L898	1560	1560	S92J4F3001663	S92J4F3001663	1	SCT6DE__00	D
St. John - New Brunswick	L871	40585	40586	L82J8F3001592	L82JXF3001593	2	SJT4DE__00	C
St. John - New Brunswick	L939	40687	40687	L82J0G3750078	L82J0G3750078	1	SJT4DE__00	C
St. John's - Newfoundland	L808	1415	1419	L82J4E3001152	L82J1E3001156	5	SJO4DE__02	H
St. John's - Newfoundland	L875	1520	1525	L82JXF3001478	L82J3F3001483	6	SJO4DE__03	B
St. John's - Newfoundland	L930	1626	1630	L82J7F3001826	L82J9F3001830	5	SJO4DE__04	C
Stratford - Ontario	L893	—	—	L82J9F3001584	L82J0F3001585	2	STD4DE__02	A
Sudbury - Ontario	L890	851	855	L82JXF3001609	L82J6F3001641	5	SUD4DE__02	A
Thunder Bay - Ontario	L806	—	—	L82J6E3001170	L82J8E3001171	2	THN4DE__02	F
Thunder Bay - Ontario	L863	—	—	L82J8F3001558	L82J6F3001560	3	THN4DE__02	F
Thunder Bay - Ontario	L944	—	—	L82J6G3750084	L82JXG3750086	3	THN4DE__03	E
Timmins - Ontario	L783	—	—	L82U8D3001017	L82UXD3001018	2	TIM4DE__02	F

## ANNEX A

## LIST OF REQUIRED V-BEA PROGRAMS PER ORDER

INDICATED REVISIONS ARE THE MINIMUM REVISION REQUIREMENTS

CLIENT	ORDER	ROAD NUMBER		VIN (2NVY/4RKY...)		QTY	PROGRAM	REV.
		FROM	TO	FROM	TO			
Timmins - Ontario	L839	—	—	L82J8E3001395	L82J8E3001395	1	TIM4DE__03	B
University of Alabama - Alabama	L787	—	—	L82J2E4500507	L82J4E4500508	2	UAL4DE__03	D
University of Alabama - Alabama	L902	7030	7030	L82J2F4500993	L82J4F4500994	2	UAL4DE__03	D
Vancouver Airport Authority - YVR British Columbia	L912	173	178	L82L5F3001812	L82L4F3001817	6	VIA4DE__00	F
Walt Disney World - Florida	L763	—	—	S92U0D3001019	S92U4D3001024	6	WDW6DE__00	F
Welland Ontario	L866			L82J9F3001648	L82J9F3001648	1	WEL4DE__00	G
Welland Ontario	L933	—	—	L82J1G3750011	L82J1G3750011	1	WEL4DE__00	G
Whitehorse - Yukon	L784	43	43	L82U9D3001057	L82U9D3001057	1	WHH4DE__0	J
Windsor - Ontario	L886	570	577	L82J8F3001818	L82J5F3001825	8	WDT4DE__00	D
Woodstock - Ontario	L778	—	—	L82U2D3001014	L82U2D3001014	1	WOO4DE__00	E
Woodstock - Ontario	L832	—	—	L82J9E3001342	L82J9E3001342	1	WOO4DE__01	C
Woodstock - Ontario	L923	15-16	15-16	L82J9F3001746	L82J9F3001746	1	WOO4DE__02	C
York Regional Transit - Ontario	L896	1501	1517	L82J2F3001619	L82JXF3001741	17	YRK4DE__00	J
York Regional Transit - Ontario	L936	1518	1518	L82J3G3750012	L82J3G3750012	1	YRK4DE__00	J

\* To obtain the software revision, contact your after sales representative.

**ANNEX B**  
**LIST OF REQUIRED ACTIA PROGRAMS PER ORDER**

CLIENT	ORDER	ROAD NUMBER		VIN (2NVY/4RKY...)		FRONT ACTIA GAUGE PROGRAM	REAR ACTIA GAUGE PROGRAM
		FROM	TO	FROM	TO		
Austin - CMTA - Texas	L704	5051	5068	L82J7E4500471	L82J2E4500488	116724v01__40	117130v01__09
Barrie - Ontario	L878	1501	1504	L82JXF3001691	L82J6F3001719	116724v01__40	117130v01__09
BC Transit - BCT - British Columbia	L858	9447	9481	L82JXE3001401	L82J5F3001436	116724v01__40	117130v01__09
BC Transit - BCT - British Columbia	L891	—	—	L82J5F3001565	L82J2F3001569	116724v01__40	117130v01__09
Brampton - Ontario	L789	—	—	L82J4E3001216	L82J1E3001223	116724v01__40	117130v01__09
Brampton - Ontario	L816	—	—	L82J3E3001224	L82J9E3001230	116724v01__40	117130v01__09
Brampton - Ontario	L864	1501	1510	L82JXF3001500	L82J6F3001509	116724v01__40	117130v01__09
Brampton - Ontario	L865	1511	1519	L82JXF3001514	L82J9F3001522	116724v01__40	117130v01__09
Brampton - Ontario	L942	1601	1613	L82J6G3750070	L82J4G3750083	116724v01__40	117130v01__09
Brantford - Ontario	L775	10131	10132	L82U1D3000999	L82U2D3001000	116724v01__40	117130v01__09
Brantford - Ontario	L928	10151	10153	L82J7F3001793	L82J0F3001795	116724v01__40	117130v01__09
Burlington - Ontario	L887	7017-15	7025-15	L82J7F3001681	L82J8F3001723	116724v01__40	117130v01__09
Clemson Area Transit - South Carolina	L769	—	—	S92U1D4500418	S92U1D4500418	116724v01__40	117130v01__09
Cornwall Ontario	L935	—	—	L82J3F3001838	L82J5F3001839	116724v01__40	117130v01__09
CT Transit - Connecticut	L814	1462	1473	S92LXE4500717	S92L4E4500728	116724v01__40	117130v01__09
CT Transit - Connecticut	L815	1426	1426	S92L0E4500709	S92L0E4500712	116724v01__40	117130v01__09
Durham Region Transit - Ontario	L872	8551	8553	L82J0F3001523	L82J4F3001525	116724v01__40	117130v01__09
Durham Region Transit - Ontario	L888	8554	8559	L82J2F3001703	L82J1F3001708	116724v01__40	117130v01__09
Fredericton - New Brunswick	L774	8131	8131	L82U7D3000960	L82U7D3000960	116724v01__40	117130v01__09
Fredericton - New Brunswick	L812	—	—	L82J4E3001202	L82J4E3001202	116724v01__40	117130v01__09
Fredericton - New Brunswick	L836	8143	8143	L82J9E3001390	L82J9E3001390	116724v01__40	117130v01__09
Fredericton - New Brunswick	L901	8151	8151	L82J7F3001602	L82J7F3001602	116724v01__40	117130v01__09
Grande Prairie Alberta	L834	—	—	L82J7E3001386	L82J2E3001389	116724v01__40	117130v01__09
Guelph - Ontario	L767	237	239	L82UXD3000967	L82U3D3000969	116724v01__40	117130v01__09
Guelph - Ontario	L835	240	243	L82J0E3001391	L82J6E3001394	116724v01__40	117130v01__09
Guelph - Ontario	L927	244	247	L82J1F3001756	L82J9F3001763	116724v01__40	117130v01__09
Houston - Texas	L951	1915	1915	L82J0G9775203	L82J0G9775203	116724v01__40	117130v01__09
Kingston Ontario	L880	1502	1502	L82JXF3001786	L82JXF3001786	116724v01__40	117130v01__09
Kingston Ontario	L925	1504	1510	L82J5F3001808	L82J5F3001811	116724v01__40	117130v01__09

## ANNEX B

## LIST OF REQUIRED ACTIA PROGRAMS PER ORDER

CLIENT	ORDER	ROAD NUMBER		VIN (2NVY/4RKY...)		FRONT ACTIA GAUGE PROGRAM	REAR ACTIA GAUGE PROGRAM
		FROM	TO	FROM	TO		
Lethbridge - Alberta	L868	—	—	L82J2F3001510	L82J2F3001510	116724v01__40	117130v01__09
LYNX - Florida	L785	—	—	S92L6E4500505	S92L8E4500506	116724v01__40	117130v01__09
MTD - Santa Barbara, California	L730	—	—	S92J8E4500567	S92J1E4500569	116724v01__40	117130v01__09
Niagara Falls - Ontario	L771	1396	1397	L82U9D3000958	L82U0D3000959	116724v01__40	117130v01__09
North Bay - Ontario	L895	784	785	L82J7F3001678	L82J9F3001679	116724v01__40	117130v01__09
Oakville - Ontario	L874	—	—	L82J6F3001526	L82JXF3001531	116724v01__40	117130v01__09
Oakville - Ontario	L881	—	—	L82J2F3001717	L82J8F3001740	116724v01__40	117130v01__09
Peterborough - Ontario	L770	55	60	L82U0D3000993	L82UXD3000998	116724v01__40	117130v01__09
Peterborough - Ontario	L870	61	63	L82JXF3001612	L82J3F3001614	116724v01__40	117130v01__09
Peterborough - Ontario	L919	64	66	L82J6F3001767	L82JXF3001769	116724v01__40	117130v01__09
Red Deer - Alberta	L766	1104	1105	L82U7D3001025	L82U9D3001026	116724v01__40	117130v01__09
Red Deer - Alberta	L772	1106	1108	L82J2E3001120	L82J6E3001122	116724v01__40	117130v01__09
Red Deer - Alberta	L813	10008	10009	L82J2E3001361	L82J4E3001362	116724v01__40	117130v01__09
Red Deer - Alberta	L869	—	—	L82J9F3001570	L82J0F3001571	116724v01__40	117130v01__09
Red Deer - Alberta	L926			L82J2F3001796	L82J4F3001797	116724v01__40	117130v01__09
Regina - Saskatchewan	L776	663	669	L82U4D3001001	L82U5D3001007	116724v01__40	117130v01__09
Regina - Saskatchewan	L807	671	685	L82J8E3001137	L82J2E3001151	116724v01__40	117130v01__09
Regina - Saskatchewan	L892	686	691	L82J5F3001484	L82J4F3001489	116724v01__40	117130v01__09
Sarnia Ontario	L873	151	152	L82J0F3001599	L82J0F3001600	116724v01__40	117130v01__09
Sarnia Ontario	L883	153	153	L82J4G3750021	L82J4G3750021	116724v01__40	117130v01__09
Saskatoon - Saskatchewan	L831	1401	1405	L82J7E3001307	L82J9E3001311	116724v01__40	117130v01__09
Saskatoon - Saskatchewan	L894	1501	1510	L82J0F3001490	L82J7F3001499	116724v01__40	117130v01__09
Sault Ste. Marie Ontario	L934	—	—	L82JXG3750038	L82JXG3750038	116724v01__40	117130v01__09
St. Catharines Ontario	L879	1501	1504	L82J4F3001587	L82J4F3001590	116724v01__40	117130v01__09
St. Catharines Ontario	L898	1560	1560	S92J4F3001663	S92J4F3001663	116724v01__40	117130v01__09
St. John - New Brunswick	L871	40585	40586	L82J8F3001592	L82JXF3001593	116724v01__40	117130v01__09
St. John - New Brunswick	L939	40687	40687	L82J0G3750078	L82J0G3750078	116724v01__40	117130v01__09
St. John's - Newfoundland	L808	1415	1419	L82J4E3001152	L82J1E3001156	116724v01__40	117130v01__09
St. John's - Newfoundland	L875	1520	1525	L82JXF3001478	L82J3F3001483	116724v01__40	117130v01__09
St. John's - Newfoundland	L930	1626	1630	L82J7F3001826	L82J9F3001830	116724v01__40	117130v01__09
Stratford - Ontario	L893	—	—	L82J9F3001584	L82J0F3001585	116724v01__40	117130v01__09
Sudbury - Ontario	L890	851	855	L82JXF3001609	L82J6F3001641	116724v01__40	117130v01__09

**ANNEX B**  
**LIST OF REQUIRED ACTIA PROGRAMS PER ORDER**

CLIENT	ORDER	ROAD NUMBER		VIN (2NVY/4RKY...)		FRONT ACTIA GAUGE PROGRAM	REAR ACTIA GAUGE PROGRAM
		FROM	TO	FROM	TO		
Thunder Bay - Ontario	L806	—	—	L82J6E3001170	L82J8E3001171	116724v01__40	117130v01__09
Thunder Bay - Ontario	L863	—	—	L82J8F3001558	L82J6F3001560	116724v01__40	117130v01__09
Thunder Bay - Ontario	L944	—	—	L82J6G3750084	L82JXG3750086	116724v01__40	117130v01__09
Timmins - Ontario	L783	—	—	L82U8D3001017	L82UXD3001018	116724v01__40	117130v01__09
Timmins - Ontario	L839	—	—	L82J8E3001395	L82J8E3001395	116724v01__40	117130v01__09
University of Alabama - Alabama	L787	—	—	L82J2E4500507	L82J4E4500508	116724v01__40	117130v01__09
University of Alabama - Alabama	L902	7030	7030	L82J2F4500993	L82J4F4500994	116724v01__40	117130v01__09
Vancouver Airport Authority - YVR British Columbia	L912	173	178	L82L5F3001812	L82L4F3001817	116724v01__40	117130v01__09
Walt Disney World - Florida	L763	—	—	S92U0D3001019	S92U4D3001024	116724v01__40	117130v01__09
Welland Ontario	L866			L82J9F3001648	L82J9F3001648	116724v01__40	117130v01__09
Welland Ontario	L933	—	—	L82J1G3750011	L82J1G3750011	116724v01__40	117130v01__09
Whitehorse - Yukon	L784	43	43	L82U9D3001057	L82U9D3001057	116724v01__40	117130v01__09
Windsor - Ontario	L886	570	577	L82J8F3001818	L82J5F3001825	116724v01__40	117130v01__09
Woodstock - Ontario	L778	—	—	L82U2D3001014	L82U2D3001014	116724v01__40	117130v01__09
Woodstock - Ontario	L832	—	—	L82J9E3001342	L82J9E3001342	116724v01__40	117130v01__09
Woodstock - Ontario	L923	15-16	15-16	L82J9F3001746	L82J9F3001746	116724v01__40	117130v01__09
York Regional Transit - Ontario	L896	1501	1517	L82J2F3001619	L82JXF3001741	116724v01__40	117130v01__09
York Regional Transit - Ontario	L936	1518	1518	L82J3G3750012	L82J3G3750012	116724v01__40	117130v01__09

\* To obtain the software revision, contact your after sales representative.