



INSTRUCTION TO SERVICE

ITS: 6185	
SECTION:	480 Mirrors
WRITTEN BY:	Scott Geier
SUBJECT:	Inspect SS Exterior Mirror Snap Bushing

ITS6185

THIS DOCUMENT AND THE CONTENTS DISCUSSED HEREIN ARE THE CONFIDENTIAL AND PROPRIETARY INFORMATION OF NEW FLYER INDUSTRIES CANADA ULC AND NEW FLYER OF AMERICA INC. AND ARE DISCLOSED BY NEW FLYER IN CONFIDENCE. THIS DOCUMENT AND THE CONTENTS HEREIN ARE NOT TO BE DISCLOSED BY THE INTENDED RECIPIENT WITHOUT THE PRIOR WRITTEN AUTHORIZATION OF NEW FLYER. ANY UNAUTHOIZED DISCLOSURE, REPRODUCTION OR OTHER DISTRIBUTION OF THIS DOCUMENT OR INFORMATION IS STRICTLY PROHIBITED AND MAY RESULT IN ACTION BEING TAKEN AGAINST THE PARTY MAKING THE UNAUTHORIZED DISCLOSURE. THIS DOCUMENT AND ALL COPIES HEREOF MUST BE RETURNED TO NEW FLYER UPON REQUEST.

NOTE: To inspect the SS snap bushing the SS exterior mirror must be removed.

PROCEDURE:

Mirror Assembly Removal / Re-Installation

1. Turn the main battery disconnect switch to the “OFF” position.
2. Locate the street side exterior mirror.
3. Disconnect mirror assembly electrical connection at the mirror mounting bracket.
See Figure 1
4. Loosen the three mirror assembly securement bolts located on the side of the mounting bracket then remove the mirror assembly (NF PN 565955) from the mounting bracket.
See Figure 1 (Item # 1)
5. Remove the two bolts (NF PN 21B06036) passing through the mounting bracket.
See Figure 1 (Item # 3). Do not discard bolts.
6. Using a utility knife carefully cut the sika adhesive around the perimeter of the mounting bracket and gasket.
7. Remove the mounting bracket (NF PN 551341). See Figure 1 (Item # 2)
8. Inspect the snap bushing (NF PN 053074) to see if it is missing or damage.
See Figure 1 (Item # 7) and pictures below.
If the snap bushing is missing or damage install a new snap bushing.

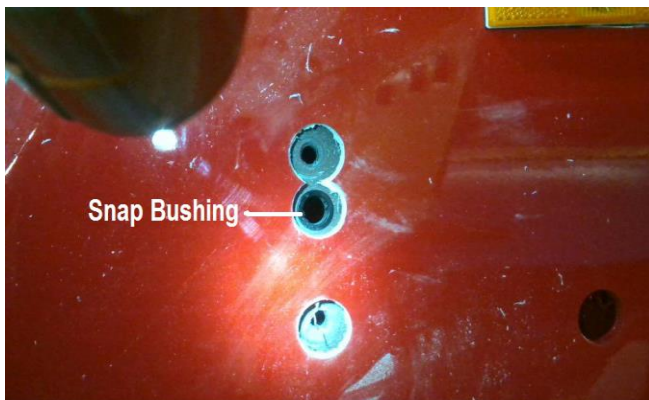

NOTE: When installing a new snap bushing it may be necessary to split the snap bushing in order to install around the harness

9. Clean all old sika adhesive from the fiberglass roof panel, mounting bracket and gasket.

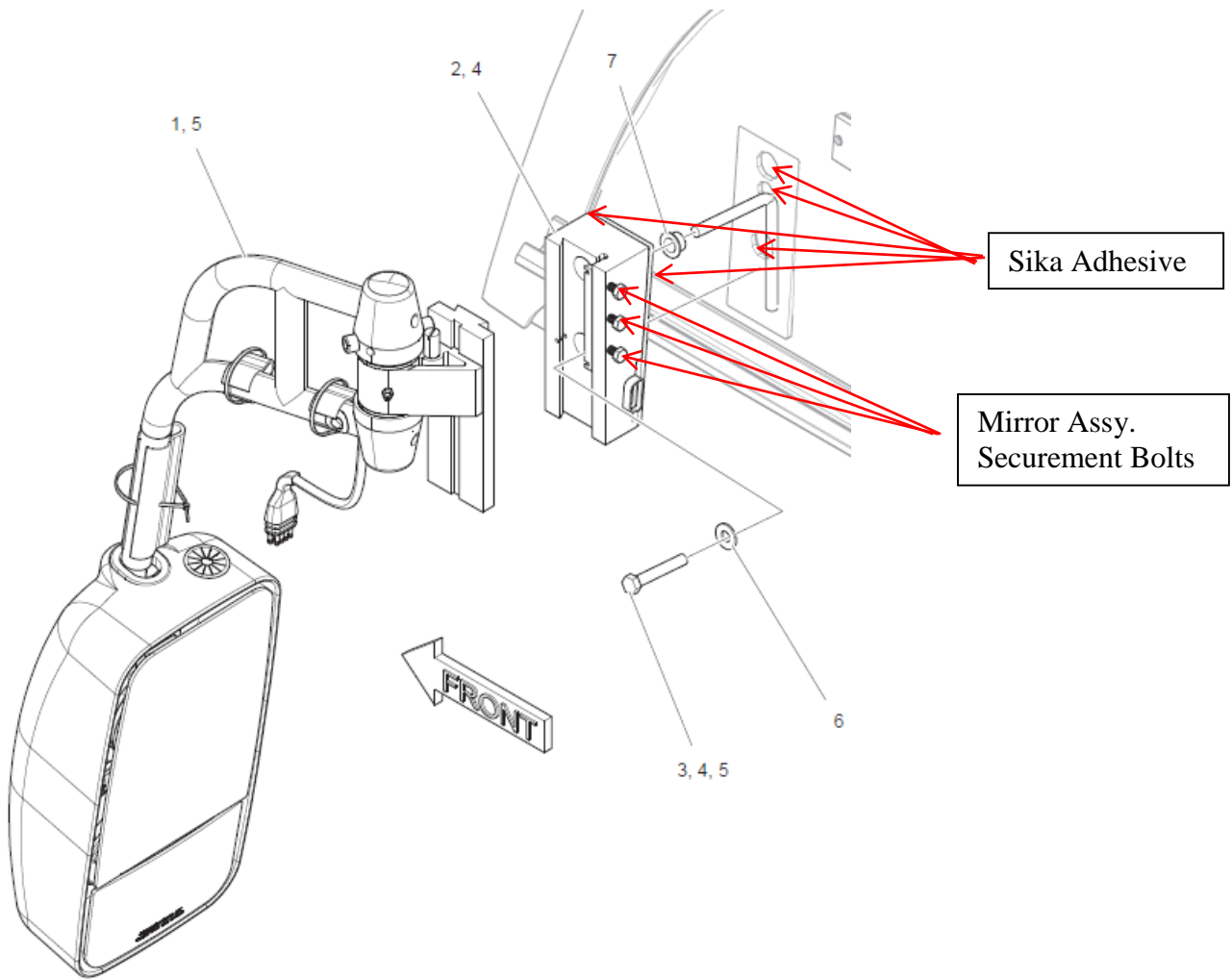

1	1	565955	Mirror Assembly, Driver's Side
2	1	551341	Bracket, Streetside Mounting
3	2	21B06036	Bolt, Hex SST 3/8" UNF x 2 1/4" Lg.
4	M/B	055701	Adhesive, SIKA 221 White
5	M/B	081034	Loctite, 243 Blue
6	2	50W06000	Washer, Flat SST 3/8"
7	1	053074	Bushing, Snap .625 O.D.

Figure 1: Street side mirror assembly install



Re-install Mirror Assembly

10. Apply sika adhesive (NF PN 055701) to perimeter of base, inside the fiberglass roof panel holes and inside the hole where electrical harness goes thru. See Figure 1
11. Install mounting bracket and gasket reusing two bolts (NF PN 21B06036). Apply Loctite (NF PN 081034) to the bolt threads. Torque bolts to 20 FT – LBS.
12. Apply sika adhesive (NF PN 055701) to perimeter of mounting bracket and gasket.
See Figure 1
13. Install mirror assembly to mounting bracket and tighten the three mirror assembly securement bolts (NF PN 604058) on the side of the mounting bracket.
Torque (48 – 72 IN-LBS)
14. Connect mirror assembly wiring connector to the mounting bracket connector.
15. Turn the main battery disconnect switch to the “ON” position.
16. Function test the mirror to ensure working order.



LABOUR ESTIMATE

	Operation	Men	Hours	Labour Time M X HR
1	Remove SS exterior mirror and inspect snap bushing	1	.25	0.25
2	Install snap ring as needed	1	.25	0.25
3	Reinstall SS exterior mirror	1	.5	0.5

Total: 1 HR.

PARTS REQUIRED

Item	Part Number	Description	Qty. per Coach	Units	Notes
1	053074	Bushing Snap	1	EA	
2	055701	SIKA 221 WHITE	0.5	EA	
3	081034	Loctite – 243 Medium	0.01	EA	