



# Special Tools Bulletin

TITLE:  
**Newsletter 69**

NO: <b>215</b>	ISSUE DATE: 2016-03-11	CAR MARKET: <b>United States and Canada</b>	Page 1 of 4
	STATUS DATE: 2016-04-22		

**“Right first time in Time”**

**Bosch Automotive Service Solutions**  
28635 Mound Road  
Warren, MI 48092  
Visit [volvodealersolutions.com](http://volvodealersolutions.com)  
Call 1-800-345-3399

**Overview of kit contents:**

33300277

33300043

9997455	Drift	C1
9997589	Holder	C1
9997590	Drift	C1
9997591	Drift	C1
9997592	Counterhold	C1
9997593	Counterhold	C1
9997594	Drift	C1
9997595	Drift	C1
33300047	Update Kit	C1-Electric XC90
9513035	TPMS Tool	C2
9997588	Support	C2-Electric

Service Personnel: Read and initial	SERVICE MANAGER	PARTS MANAGER	WORKSHOP FOREMAN	SERVICE TECHNICIANS									



## 9997455 Drift

Drift for mounting of front bushing in lateral link.  
Used together with Yoke 9997453.

<b>Tool standard</b>	C1
<b>Tool group</b>	65.0
<b>Tool bulletin</b>	387
<b>Model</b>	C30, C70 (06-), S40 (04-), V50, V40 (13-), V40 (13-) CC Standard and R-line
<b>Tool board</b>	65

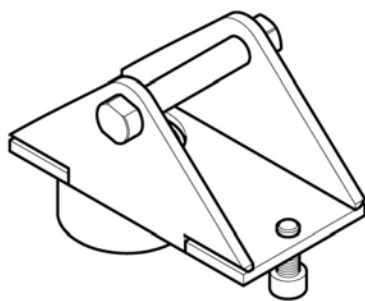

## 9997589 Holder

Holder for removal and mounting of the bushing on  
front link arm.  
Used together with Drift 9997590 and Drift 9997591.

<b>Tool standard</b>	C1
<b>Tool group</b>	61.0
<b>Tool bulletin</b>	387
<b>Model</b>	XC90 (16-)
<b>Tool board</b>	61



## 9997590 Drift

Drift for removal of the bushing on the front link arm.

<b>Tool standard</b>	C1
<b>Tool group</b>	61.0
<b>Tool bulletin</b>	387
<b>Model</b>	XC90 (16-)
<b>Tool board</b>	61

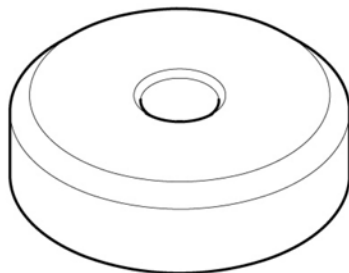

## 9997591 Drift

Drift for mounting of the bushing on the front link arm.

<b>Tool standard</b>	C1
<b>Tool group</b>	61.0
<b>Tool bulletin</b>	387
<b>Model</b>	XC90 (16-)
<b>Tool board</b>	61

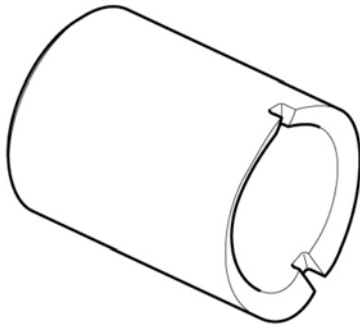

## 9997592 Counterhold

Counterhold for removal and mounting bushing on the front link arm.

<b>Tool standard</b>	C1
<b>Tool group</b>	61.0
<b>Tool bulletin</b>	387
<b>Model</b>	XC90 (16-)
<b>Tool board</b>	61

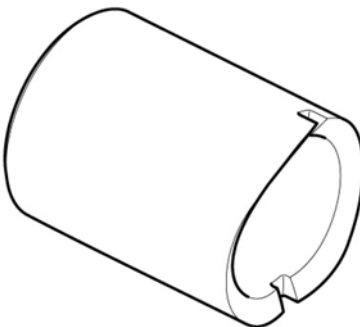

## 9997593 Counterhold

Counterhold for removal and mounting bushing on the front link arm.

<b>Tool standard</b>	C1
<b>Tool group</b>	61.0
<b>Tool bulletin</b>	387
<b>Model</b>	XC90 (16-)
<b>Tool board</b>	61



## 9997594 Drift

Drift for removal bushing on the front link arm.

<b>Tool standard</b>	C1
<b>Tool group</b>	61.0
<b>Tool bulletin</b>	387
<b>Model</b>	XC90 (16-)
<b>Tool board</b>	61



## 9997595 Drift

Drift for mounting bushing on the front link arm.

<b>Tool standard</b>	C1
<b>Tool group</b>	61.0
<b>Tool bulletin</b>	387
<b>Model</b>	XC90 (16-)
<b>Tool board</b>	61

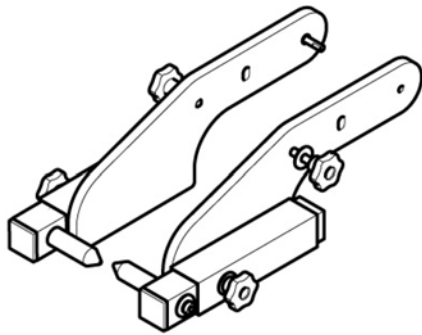

## 9997588 Support

Support to hold rear bracket in position when removing the rear subframe.

<b>Tool standard</b>	C2-Electric
<b>Tool group</b>	65.0
<b>Tool bulletin</b>	387
<b>Model</b>	XC90 (16-), Hybrid
<b>Tool board</b>	65

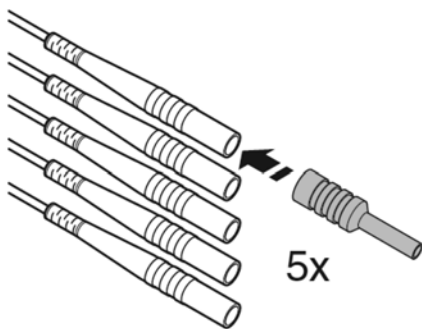

## 33300047 Update Kit for 9513091

For update Test Adapter 9513091. Updated to fit directly with Isolation Tester 9513038. Installation instruction included.

<b>Tool standard</b>	C1-Electric XC90
<b>Tool group</b>	
<b>Model</b>	
<b>Tool board</b>	

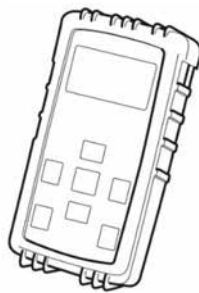

## 33300043 TPMS Tool (9513035)

Fits all models equipped with TPMS (Tire Pressure Monitoring System). The tool automatically tests Schraeder and Siemens TPM. Provides information on the type of sensor, frequency, TPM, battery status, the TPM accelerometer. The tool is also needed to change a spare part from the transport position. Shipping mode to user mode Park mode.

From new, this tool will need to be updated with the latest software, in order to support XC90 (16-) and newer vehicles. Please follow the steps in Service Product Journal 30099.

<b>Tool standard</b>	C2
<b>Tool group</b>	77
<b>Model</b>	XC90 (16-)
<b>Tool board</b>	70