



# ROADSTER 2016-3 Throttle Grip Assembly With Higher Friction\_130753\_WQC61Y016S07\_en

[Printable Version](#)

Rate This Article	(Average Rating: No Rating)	<a href="#">Version 1</a>	Rate This Article	(Average Rating: No Rating)	<a href="#">Version 1</a>	<a href="#">Language</a> English	<a href="#">Show Properties</a>	<a href="#">Language</a> English	<a href="#">Show Properties</a>
-------------------	-----------------------------	---------------------------	-------------------	-----------------------------	---------------------------	----------------------------------	---------------------------------	----------------------------------	---------------------------------

Product: **Roadster**

Bulletin type: **Quality**

Bulletin no: **2016-3** (rbg2016-003 en LG)

Revision no:

Revision date:

Campaign no.: **2015-0007**  
**2016-0004**

Publication date: **June 2016**

Subject: **Throttle Grip Assembly With Higher Friction**

YEAR	MODELS	SERIAL NUMBER
2015-2016	Spyder F3, RS, RT and ST Series	See warranty campaigns in Knowledge Center

## PROBLEM

Some throttle grips assembly may have tighter materials tolerances that may increase return time to original position.

## SOLUTION

Replace specified component by new improvement parts.

## PART REQUIRED

Order part through regular channel.

### RS, RT and ST Series

description	part number	qty	item
Back Plate (MY15 only)	710005158	1	1
End Piece (MY15 only)	709401800	1	2
Bushing (MY15 only)	709401801	1	3
RH Handlebar Tube	709401938	1	4
Spring	709401937	1	5

### F3 Series

description	part number	qty	item
-------------	-------------	-----	------

Back Plate (MY15 only)	710005158	1	1
End Piece (MY15 only)	709401800	1	2
Bushing (MY15 only)	709401801	1	3
RH Handlebar Tube	709401939	1	4
Spring	709401937	1	5

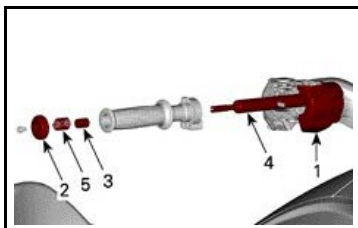

## PROCEDURE

Use the latest version of the shop manual available on Knowledge Center.

- Keyword(s): Shop manual directory
- Select: Roadster/ Year/ Model.

In the Table of Contents, select:

- Steering, DPS and Front wheels

## WARRANTY

Submit a warranty claim using the following information:

For claiming procedure, refer to the *DEALER/DISTRIBUTOR WARRANTY GUIDE*.

Click in the REPAIR BOX while completing your claim on BOSSWeb.



Campaign Number	2015-0007
Claim Type	Normal Warranty
Action	Repair
Flat Rate Time	0.4 hour
Expiry Date	June 2018

Campaign Number	2016-0004
Claim Type	Normal Warranty
Action	Repair
Flat Rate Time	0.4 hour
Expiry Date	June 2018

