

MULTI-MODEL BRAKE MASTER CYLINDER FLUID LEAK

When performing brake system maintenance or repairs, check the brake fluid level before proceeding. Fluid level may have been topped off during a previous service visit. If the brake fluid level is at MAX and brake system maintenance or repairs are performed, fluid may spill on body painted surfaces and/or other components causing damage.

Example

If the vehicle requires brake pad lining replacement and the brake master cylinder fluid level is at MAX or higher, fluid may spill when the brake caliper pistons are compressed.

Tech Tip

If fluid level is at MAX or higher, use a siphon to reduce the fluid level. This will prevent a fluid leak during maintenance or repair.

If brake fluid spills on painted surfaces, clean immediately.

If not cleaned, the following may occur:

- The brake system may be misdiagnosed at the next service visit (technician suspects a faulty brake master cylinder).
- Brake booster paint damage.
- Body surface paint damage.
- Electrical harness/component damage.

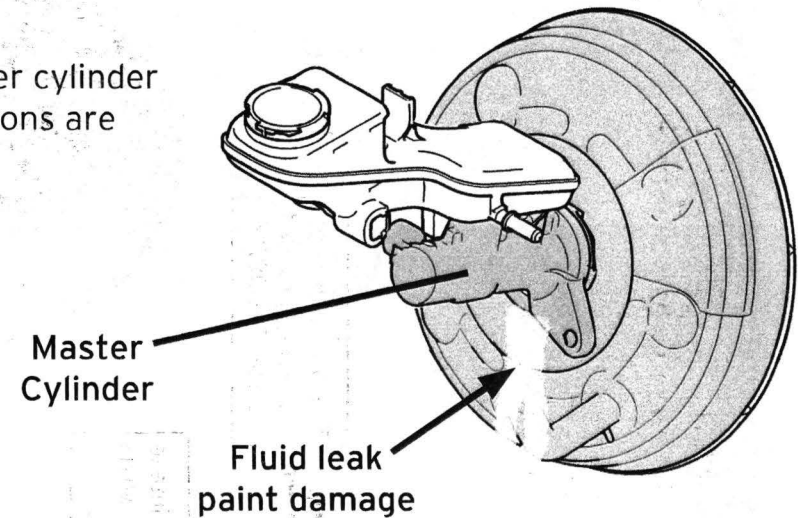

An editorial board comprised of MNAO service staff members generates, collects, and verifies information for this publication. © 2014 Mazda Motor of America, Inc.

To contribute repair tip ideas, send an e-mail to mtips@mazdausa.com or fax to (949) 442-6599. If we select your repair tip, you will receive 10,000 Reward Performance by Mazda (RPM) points for your efforts. All contributions become property of MNAO, which assumes permission to publish them without further consideration.

2014-2015 Mazda3/Mazda6, 2013-2015 CX-5 A/C COMPRESSOR SERVICE CAUTION

When replacing an A/C compressor, use the specified torque in the Workshop Manual "A/C COMPRESSOR REMOVAL / INSTALLATION".

Improper tightening torque of the mounting bolts may cause poor sealing at the center gasket of the compressor and result in a refrigerant leak.

Caution:

Apply the specified torque.
Do NOT over tighten.

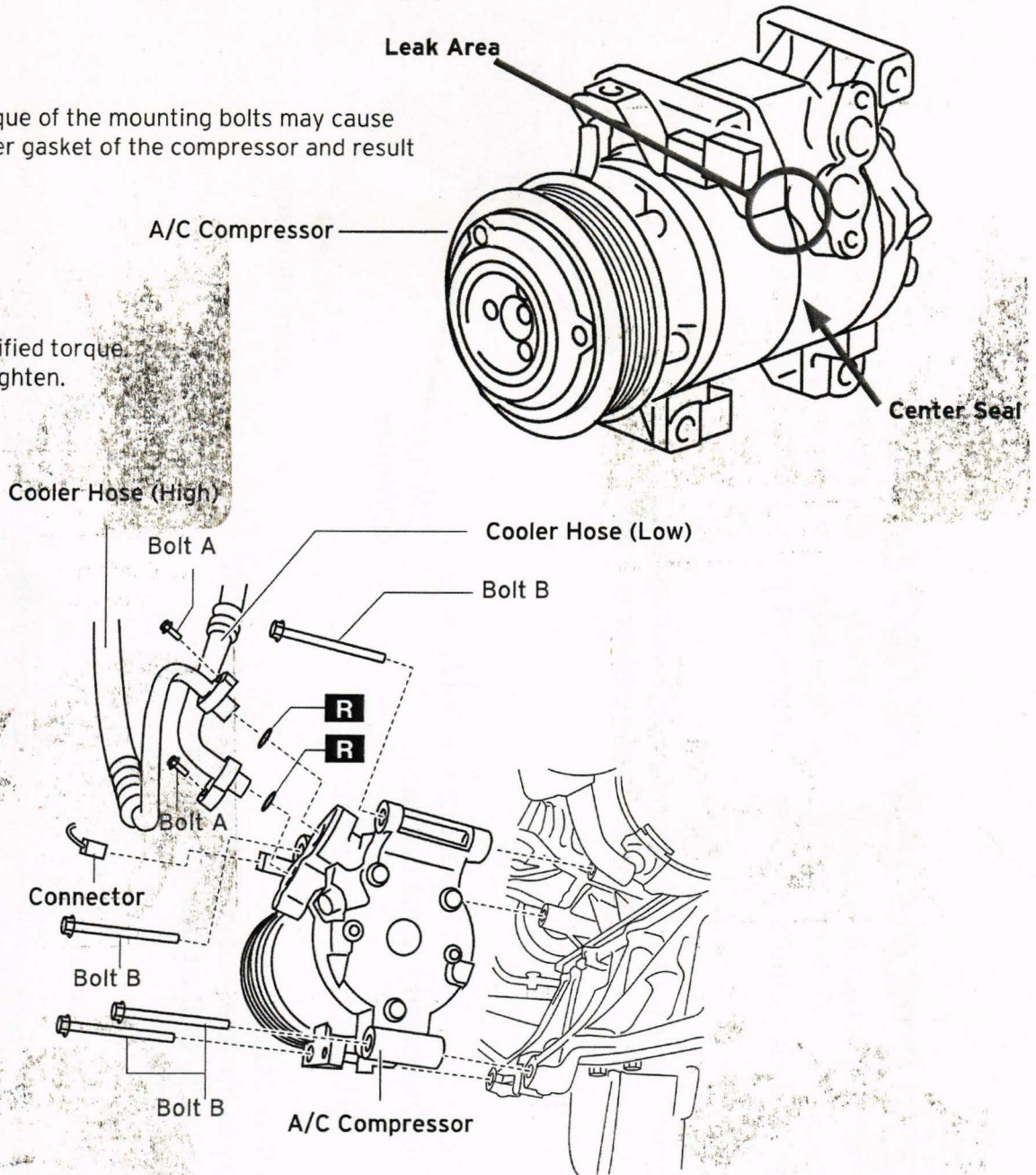

Specified torque

Bolt A: 8-10 Nm {82-101 kgf cm, 71-88 in lbf}

Bolt B: 19-25 Nm {2.0-2.5 kgf m, 15-18 ft lbf}

R : Replace

An editorial board comprised of MNAO service staff members generates, collects, and verifies information for this publication. © 2014 Mazda Motor of America, Inc.

To contribute repair tip ideas, send an e-mail to mtips@mazdausa.com or fax to (949) 442-6599. If we select your repair tip, you will receive 10,000 Reward Performance by Mazda (RPM) points for your efforts. All contributions become property of MNAO, which assumes permission to publish them without further consideration.