

**TECHNICAL BULLETIN**  
**JTB00435NAS1**  
**28 SEP 2015**



© Jaguar Land Rover North America, LLC

NOTE: The information in Technical Bulletins is intended for use by trained, professional Technicians with the knowledge, tools, and equipment required to do the job properly and safely. It informs these Technicians of conditions that may occur on some vehicles, or provides information that could assist in proper vehicle service. The procedures should not be performed by 'do-it-yourselfers'. If you are not a Retailer, do not assume that a condition described affects your vehicle. Contact an authorized Jaguar service facility to determine whether this bulletin applies to a specific vehicle.

**SECTION: 417-00**

**Front / Rear Bumper Harness Protective Sleeve**

**AFFECTED VEHICLE RANGE:**

**XF (X250)**

**Model Year:** 2009-2015  
**VIN:** R00001-U88785  
**Manufacturing Plant:** Castle Bromwich

**XJ Range (X351)**

**Model Year:** 2010 Onwards  
**VIN:** V00001 Onwards  
**Manufacturing Plant:** Castle Bromwich

**MARKETS:**

NAS

**CONDITION SUMMARY:**

**Situation:** The front and/or rear Parking Aid system may be inoperative.

**Cause:** This may be caused by a corroded wiring harness at the front and/or rear bumper harnesses.

**Action:** Should a customer express this concern, follow the Service Instruction below.

**PARTS:**



**NOTE: \*refer to ADDITIONAL PARTS INFORMATION section for the quantity of harness sleeves required for the repair.**

C2D49034	Harness sleeve - up to 9 mm diameter	Quantity: *
C2D49035	Harness sleeve - 10-16 mm diameter	Quantity: *
C2D49036	Harness sleeve - 17-22 mm diameter	Quantity: *
C2D49037	Harness sleeve - 23-31 mm diameter	Quantity: *

**TOOLS:**

Refer to Workshop Manual for any required special tools.  
 SECTION: 417-00

**WARRANTY:**

**NOTE: Repair procedures are under constant review, and therefore times are subject to change; those quoted here must be taken as guidance only. Always refer to TOPIx to obtain the latest repair time.**

**NOTE: DDW requires the use of causal part numbers. Labor only claims must show the causal part number with a quantity of zero.**

DESCRIPTION	SRO	TIME (HOURS)	CONDITION CODE	CAUSAL PART
Wiring harness protection - Front - XF (X250)	<b>86.94.90</b>	1.4	42	C2Z28534
Wiring harness protection - Rear - XJ (X250)	<b>86.94.89</b>	1.6	42	C2Z28749
Wiring harness protection - Front - XJ (X351)	<b>86.94.90</b>	1.7	42	C2D26557
Wiring harness protection - Rear - XJ (X351)	<b>86.94.89</b>	1.8	42	C2D17086

**NOTE: Normal Warranty procedures apply.**

**ADDITIONAL PARTS INFORMATION**

The tables below list the part number, size, and quantity of protective sleeves that are required for each repair.

**XF (X250) - Front bumper harness repair**

Harness Sleeve Part No.	Size	Qty.
C2D49034	>9 mm	1
C2D49036	17-22mm	3

**XF (X250) - Rear bumper harness repair**

Harness Sleeve Part No.	Size	Qty.
C2D49034	>9 mm	1
C2D49036	17-22mm	2

**XJ (X351) - Front bumper harness repair**

Harness Sleeve Part No.	Size	Qty.
C2D49034	>9 mm	1
C2D49036	17-22 mm	2

**(X351) - Rear bumper harness repair**

Harness Sleeve Part No.	Size	Qty.
C2D49034	>9 mm	4
C2D49035	10-16 mm	2
C2D49036	17-22mm	2

1Service information on the installation of the protective sleeves.

- The protective sleeve is to be cut to the required length for installation.
- The protective sleeve is to be installed up to the electrical connector.
- The protective sleeve is to be secured at either end with insulation tape unless being installed up to a connector. When installing a sleeve up to a connector the end should be left open to allow for harness movement (1).
- When installing the protective sleeve at a Park assist sensor breakout the sleeve should be secured with insulation tape as shown (2).

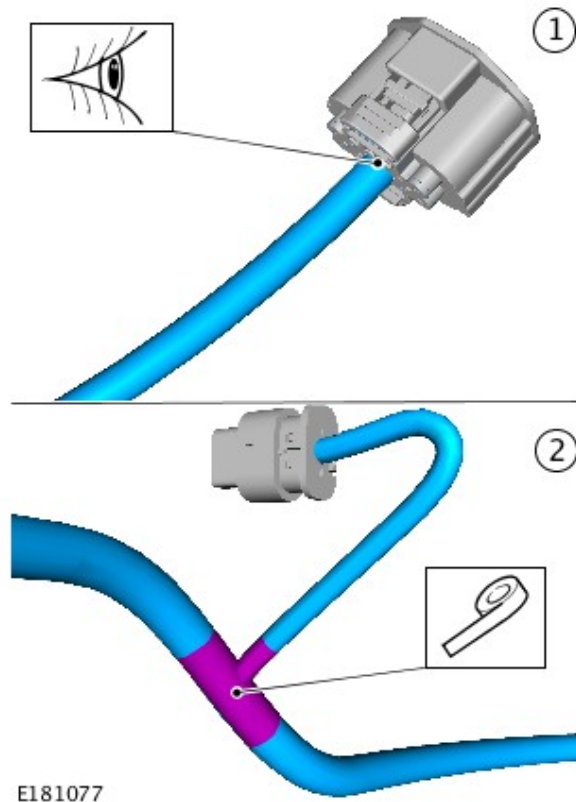

E181077

**SERVICE INSTRUCTION:**

**NOTE:** if there are any corroded or damaged wires in the wiring harness, these should be repaired using the harness repair kit prior to this repair procedure (see TOPIx Workshop Manual, Section 418-02 for additional information on harness repair). This Service Instruction is intended as a separate, additional repair, and should be carried out as a separate claim.

1 Remove the bumper cover as required (see TOPIx Workshop Manual, Section 501-19).

2 

**NOTE:**  
XF  
(X250)  
front  
bumper  
cover  
shown;  
other  
bumper  
covers  
similar.

Remove  
the  
bumper  
cover  
electrical  
wiring  
harness.

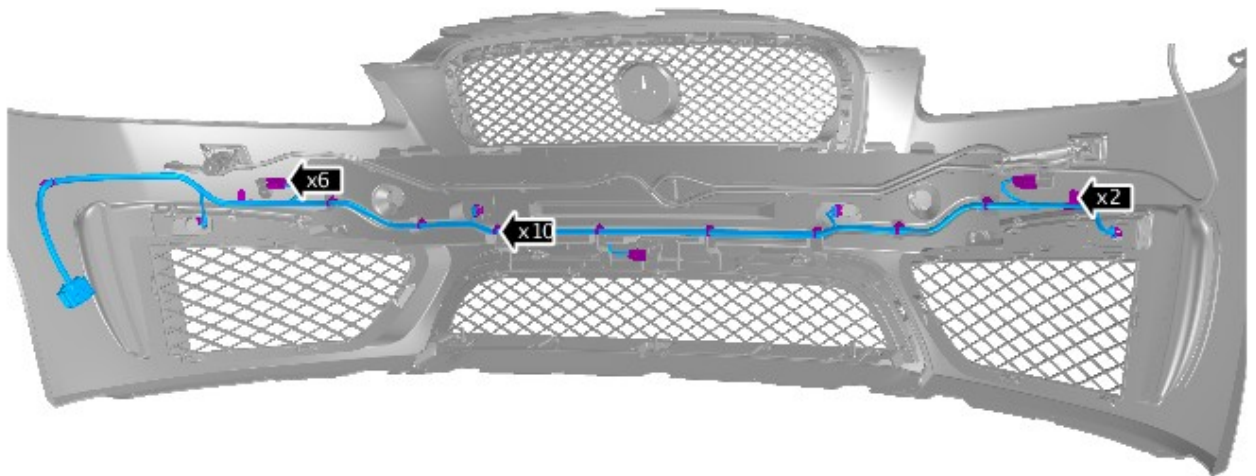

E181069

**3** Install a suitable diameter protective sleeve to any exposed or unprotected wiring on the bumper cover electrical wiring harness.

- Remove the backing from the self-adhesive tape and wrap the sleeve around the bumper cover electrical wiring harness.

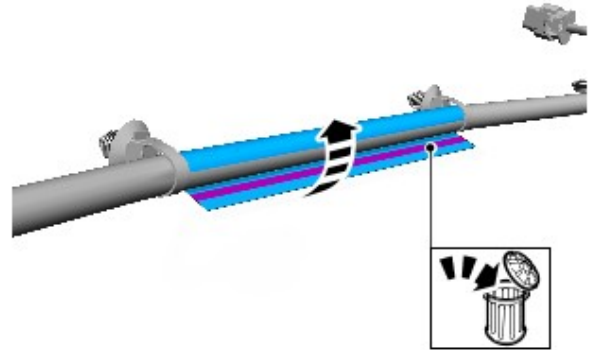

E181070

**4** If due to the thickness of the bumper cover electrical wiring harness the diameter of the sleeve does not wrap the loom completely, secure the sleeve with insulation tape.

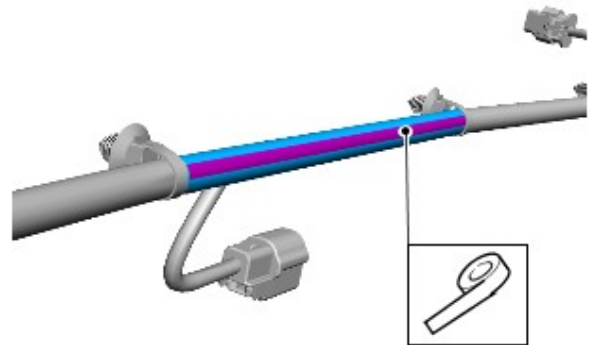

E181071

**5** Secure the protective sleeve at either end with insulation tape.

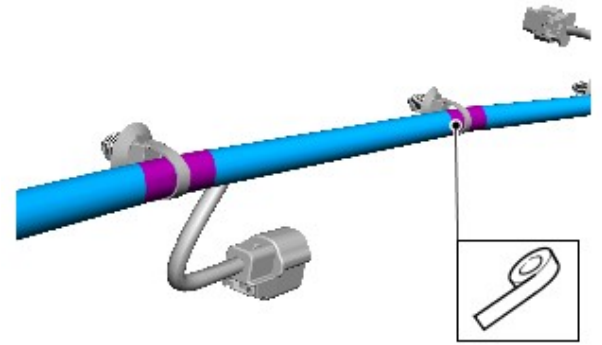

E181072

6  **NOTE:**

Install the bumper cover electrical wiring harness.

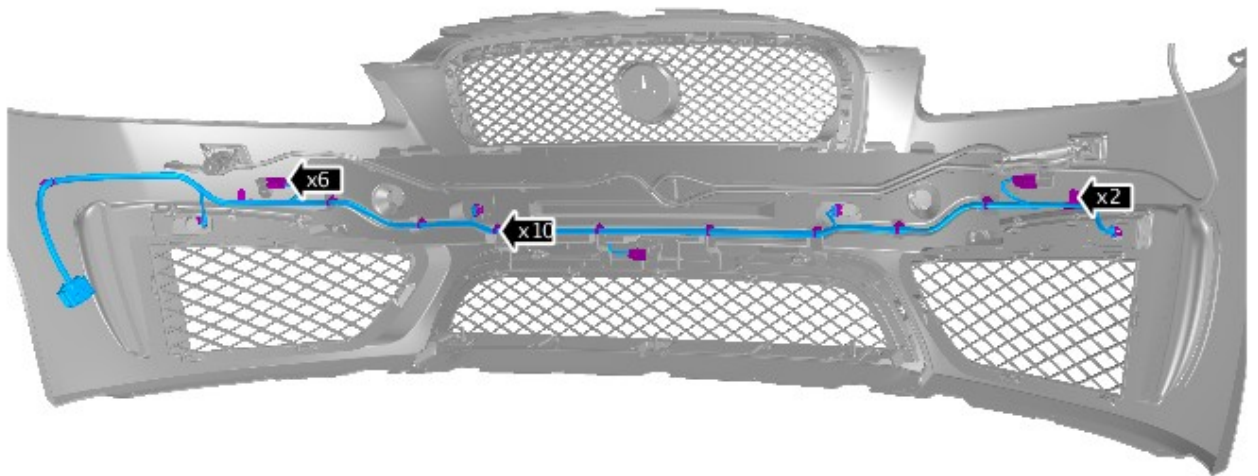

E181069

**7** Install the bumper cover (see TOPIx Workshop Manual, Section 501-19).