

**ATTENTION:**  
 GENERAL MANAGER   
 PARTS MANAGER   
 CLAIMS PERSONNEL   
 SERVICE MANAGER

IMPORTANT - All Service Personnel Should Read and Initial in the boxes provided, right.

© 2014 Subaru of America, Inc. All rights reserved.



QUALITY DRIVEN® SERVICE

**SERVICE BULLETIN**

**APPLICABILITY:** 2014-15MY Forester Models Equipped with EyeSight **NUMBER:** 07-97-15  
**SUBJECT:** Procedure Change when EyeSight Stereo Camera Cover Finish Is Peeling **DATE:** 08/10/15

**INTRODUCTION**

There have been a small number of reports stating the finish of the EyeSight stereo camera trim cover is peeling. This bulletin announces a change to the paint material to eliminate the condition and instructions for ordering the replacement parts.

**PRODUCTION CHANGE INFORMATION:**

The new components were incorporated into production in October, 2014 starting with VIN F\*525699.

**PART INFORMATION**

DESCRIPTION	PART NUMBER
Stereo Camera Cover ASSY	87505SG030LO
CAP ETC	87507SG010LO

**IMPORTANT:** When ordering a replacement cover or cap for a vehicle with a VIN PRIOR to the production change listed above, both parts in the table above must be ordered / replaced as a set to insure proper color match.

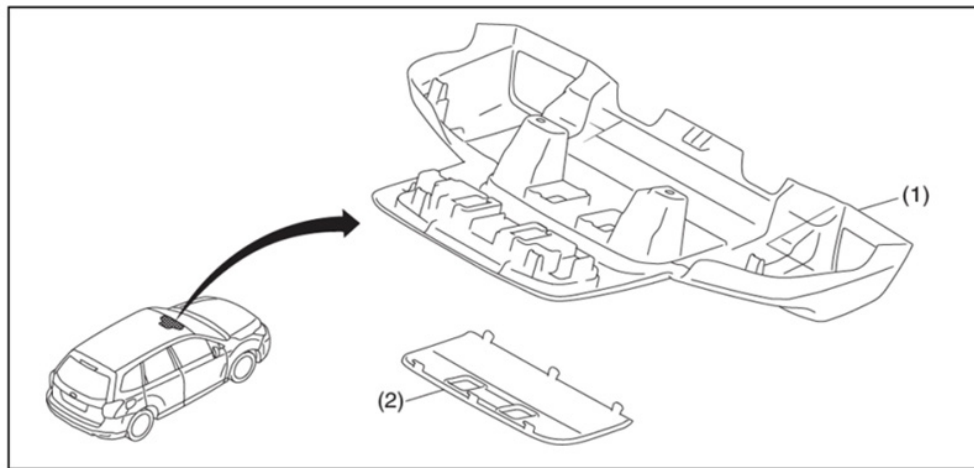

(1) Stereo camera cover ASSY (2) Cap ETC

*Continued...*

**CAUTION: VEHICLE SERVICING PERFORMED BY UNTRAINED PERSONS COULD RESULT IN SERIOUS INJURY TO THOSE PERSONS OR TO OTHERS.**

Subaru Service Bulletins are intended for use by professional technicians ONLY. They are written to inform those technicians of conditions that may occur in some vehicles, or to provide information that could assist in the proper servicing of the vehicle. Properly trained technicians have the equipment, tools, safety instructions, and know-how to do the job correctly and safely. If a condition is described, DO NOT assume that this Service Bulletin applies to your vehicle, or that your vehicle will have that condition.

**SUBARU OF AMERICA, INC. IS ISO 14001 COMPLIANT**

ISO 14001 is the international standard for excellence in Environmental Management Systems. Please recycle or dispose of automotive products in a manner that is friendly to our environment and in accordance with all local, state and federal laws and regulations.

## SERVICE PROCEDURE / INFORMATION

After the condition as described has been verified, **CAREFULLY** follow the procedure in the applicable Service Manual for replacement of the stereo camera cover and cap.

### REMINDERS:

- **ALWAYS** take the proper precautions to protect the interior trim, head liner and surrounding components from damage.
- Attach protective tape with weak adhesive (e.g. masking or Painter's tape) to the cover assembly before removal and replacement part installation to avoid contact / damage (most importantly, fingerprints) to the stereo camera lenses as shown in the illustration below.
- **NEVER** attempt to clean the lenses of the EyeSight stereo camera.

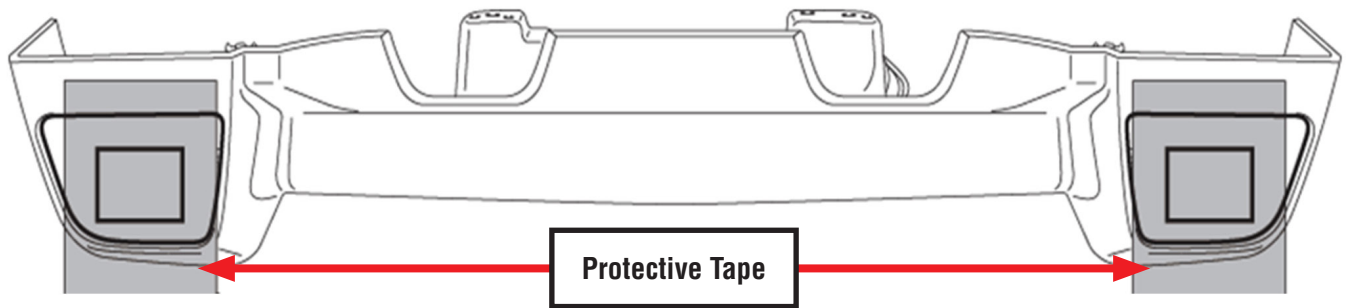

## WARRANTY / CLAIM INFORMATION

For vehicles within the Basic New Car Limited Warranty period or with an active Added Security Classic or Gold Service Agreement, this repair may be claimed using the following information:

LABOR DESCRIPTION	LABOR OPERATION #	FAIL CODE	LABOR TIME
Stereo Camera Cover R&R	A067-710	ZFX-64	0.2

**REMINDER:** SOA strongly discourages the printing and/or local storage of service information as previously released information and electronic publications may be updated at any time.

**Always refer to STIS for the latest service information before performing any repairs.**